

LATITUDE 39°25'00"

LATITUDE 39°27'30"

11,307' TO BOTTOM HOLE

7,784' TO BOTTOM HOLE

14,767'

LONGITUDE 80°52'30"

LONGITUDE 80°55'00"

Antero Resources Corporation
Well No. Copper John Unit 3H

AS DRILLED DATA:
WELL 3H TOP HOLE INFORMATION:
 N: 337,460ft E: 1,598,075ft
 LAT: 39°25'04.04" LON: 80°55'21.72"
BOTTOM HOLE INFORMATION:
 N: 329,234ft E: 1,600,119ft
 LAT: 39°23'43.07" LON: 80°54'54.03"
 WEST VIRGINIA COORDINATE SYSTEM OF 1927 NORTH ZONE
 MEASUREMENTS TAKEN WITH TRIMBLE GEOXT SUBMETER MAPPING GRADE GPS UNIT.
 PLAT ORIENTATION, CORNER, AND WELL REFERENCE TIE LINES ARE BASED ON GRID NORTH.

(NAD) 83 (UTM) ZONE 17 COORDS:
WELL 3H TOP HOLE INFORMATION:
 N: 4,363,152m E: 506,669m
BOTTOM HOLE INFORMATION:
 N: 4,360,657m E: 507,333m

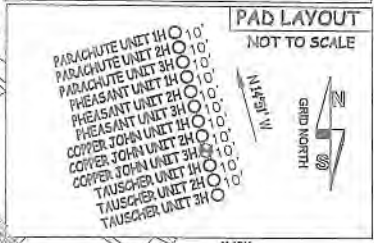

WV NORTH ZONE GRID NORTH

JOB # 16-048WA
 DRAWING # COPPERJOHN3HAD
 SCALE 1" = 1000'
 MINIMUM DEGREE OF ACCURACY SUBMETER
 PROVEN SOURCE OF ELEV. SUBMETER MAPPING GRADE GPS
 STATE OF WEST VIRGINIA DEPARTMENT OF ENERGY DIVISION OF OIL AND GAS

LEGEND
 - - - Surface Owner Boundary Lines +/-
 - - - Interior Surface Tracts +/-
 O - - - Proposed Well Path
 O - - - As Drilled Well Path

DOUGLAS R. ROWE P.S. 2202
 DATE 03/06/19

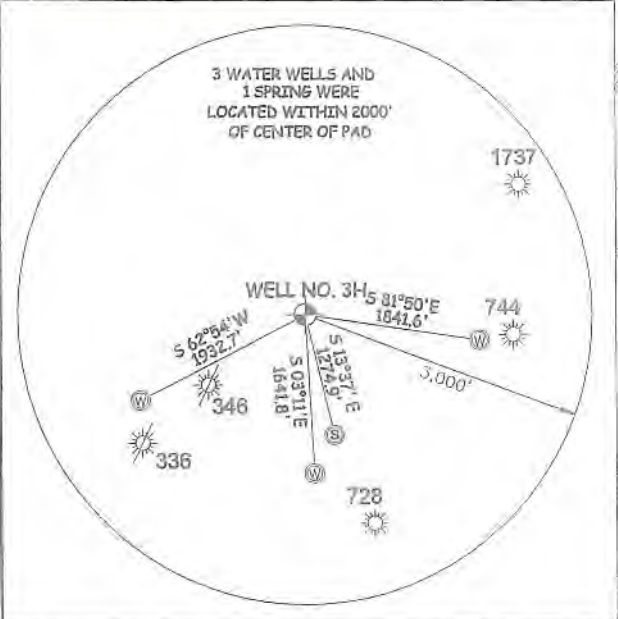

I, THE UNDERSIGNED, HEREBY CERTIFY THAT THIS PLAT IS CORRECT TO THE BEST OF MY KNOWLEDGE AND BELIEF AND SHOWS ALL THE INFORMATION REQUIRED BY LAW AND THE RULES ISSUED AND PERSCRIBED BY THE DEPARTMENT OF ENVIRONMENTAL PROTECTION.



STATE OF WEST VIRGINIA, DIVISION OF ENVIRONMENTAL PROTECTION, OFFICE OF OIL AND GAS
 WILLOW LAND SURVEYING PLLC
 220 MASONIC AVE. PENNSBORO WEST VIRGINIA 26415

- NOTES**
1. NO OCCUPIED DWELLINGS OR BUILDINGS TWO THOUSAND FIVE HUNDRED (2,500) SQUARE FEET OR LARGER USED TO HOUSE OR SHELTER DAIRY CATTLE OR POULTRY HUSBANDRY ARE LOCATED WITHIN SIX HUNDRED TWENTY-FIVE (625) FEET OF THE CENTER OF THE WELL PAD.
 2. TOP HOLE DATA SHOWN HEREON WAS PROVIDED BY ALLEGHENY SURVEYS, INC.
 3. AS DRILLED DATA WAS PROVIDED BY ANTERO RESOURCES CORPORATION.
 4. WLS IS NOT CERTIFYING THE DATA AND INFORMATION PROVIDED LISTED IN NOTES 2 AND 3, ONLY THE RELATIONSHIP TO THE DATA AND INFORMATION PROVIDED TO THE LEASE BOUNDARIES.
 5. WLS IS BY NO MEANS RESPONSIBLE FOR ANY ERRORS OR INACCURACIES WITH THE DATA AND INFORMATION THAT HAS BEEN PROVIDED.

WELL TYPE: OIL <input type="checkbox"/> GAS <input checked="" type="checkbox"/> LIQUID INJECTION <input type="checkbox"/> WASTE DISPOSAL <input type="checkbox"/>	OPERATOR'S WELL#	COPPER JOHN UNIT 3H	COUNTY
(IF "GAS") PRODUCTION <input type="checkbox"/> STORAGE <input type="checkbox"/> DEEP <input type="checkbox"/> SHALLOW <input checked="" type="checkbox"/>	47 - 095 - 02406		TYLER
LOCATION: ELEVATION 922' AS BUILT	STATE	COUNTY	PERMIT
WATERSHED OUTLET MIDDLE ISLAND CREEK			
QUADRANGLE MIDDLEBOURNE 7.5'	DISTRICT	CENTERVILLE	
SURFACE OWNER STEVEN MCPEEK ET AL	ACREAGE	123.5 ACRES +/-	
OIL & GAS ROYALTY OWNER KEITH F. FREELAND; DAVID A. DARNELL; RONALD FLETCHER ET UX;	LEASE ACREAGE	123.5 AC±; 88.33 AC±; 93 AC±;	
RONALD P. FLETCHER ET AL; DENISEL FERRELL ET UX; HERBERT DARNELL; E. G. BEEM; ROBERT FERRELL ET UX; FRANK GRASS ET AL		27.88 AC±; 248 AC±; 51 AC±; 317 AC±; 29.12 AC±; 431.29 AC±	
PROPOSED WORK: DRILL <input type="checkbox"/> CONVERT <input type="checkbox"/> DRILL DEEPER <input type="checkbox"/> REDRILL <input type="checkbox"/> FRACTURE OR STIMULATE <input type="checkbox"/>	ESTIMATED DEPTH	6,371' TVD 14,907' MD	
PLUG OFF OLD FORMATION <input type="checkbox"/> PERFORATE NEW FORMATION <input type="checkbox"/> OTHER PHYSICAL CHANGE IN WELL <input type="checkbox"/>	DESIGNATED AGENT	DIANNA STAMPER - CT CORPORATION SYSTEM	
(SPECIFY) AS DRILLED	ADDRESS	5400 D BIG TYLER ROAD	
TARGET FORMATION MARCELLUS	ADDRESS	CHARLESTON, WV 25313	
WELL OPERATOR ANTERO RESOURCES CORP.			
ADDRESS 1615 WYNKOOP ST.			
FORM WW-6 DENVER, CO 80202			

