

- NOTES:**
1. NO OCCUPIED DWELLINGS OR BUILDINGS TWO THOUSAND FIVE HUNDRED (2,500) SQUARE FEET OR LARGER USED TO HOUSE OR SHELTER DAIRY CATTLE OR POULTRY HUSBANDRY ARE LOCATED WITHIN SIX HUNDRED TWENTY-FIVE (625) FEET OF THE CENTER OF THE WELL PAD.
 2. TOP HOLE DATA SWIN HELSON WAS PROVIDED BY ANTERO RESOURCES CORPORATION.
 3. AS DRILLED DATA WAS PROVIDED BY ANTERO RESOURCES CORPORATION.
 4. WLS IS NOT CERTIFYING THE DATA AND INFORMATION PROVIDED LISTED IN NOTES 2 AND 3, ONLY THE RELATIONSHIP TO THE DATA AND INFORMATION PROVIDED TO THE LEASE BOUNDARIES.
 5. WLS IS BY NO MEANS RESPONSIBLE FOR ANY ERRORS OR INACCURACIES WITH THE DATA AND INFORMATION THAT HAS BEEN PROVIDED.

NOTES:

WELL 3H TOP HOLE INFORMATION:
 N: 338,901ft E: 1,593,872ft
 LAT: 39°25'17.62" LON: 80°56'15.56"

BOTTOM HOLE INFORMATION:
 N: 350,167ft E: 1,590,714ft
 LAT: 39°27'08.47" LON: 80°56'58.11"

WEST VIRGINIA COORDINATE SYSTEM OF 1927 NORTH ZONE. ZONE WAS DERIVED FROM MEASUREMENTS TAKEN WITH TRIMBLE GEOXT SUBMETER MAPPING GRADE GPS UNIT. PLAT ORIENTATION, CORNER, AND WELL REFERENCE TIE LINES ARE BASED ON GRID NORTH.

(NAD) 83 (UTM) ZONE 17 COORDS:
WELL 3H TOP HOLE INFORMATION:
 N: 4,363,570m E: 505,381m
BOTTOM HOLE INFORMATION:
 N: 4,366,986m E: 504,361m

I, THE UNDERSIGNED, HEREBY CERTIFY THAT THIS PLAT IS CORRECT TO THE BEST OF MY KNOWLEDGE AND BELIEF AND SHOWS ALL THE INFORMATION REQUIRED BY LAW AND THE RULES ISSUED AND PERSCRIBED BY THE DEPARTMENT OF ENVIRONMENTAL PROTECTION.



STATE OF WEST VIRGINIA, DIVISION OF ENVIRONMENTAL PROTECTION, OFFICE OF OIL AND GAS

WILLOW LAND SURVEYING PLLC
 220 MASONIC AVE. PENNSBORO WEST VIRGINIA 26415

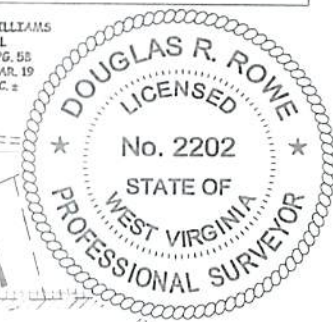
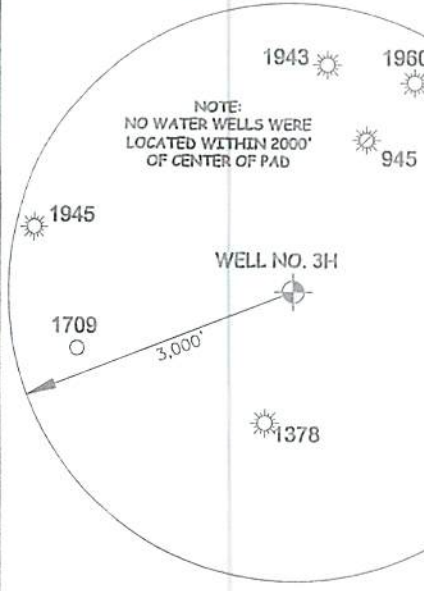

47 STATE 095 COUNTY 02463 PERMIT

JOB # 17-020WA
 DRAWING # JACK3HAD
 SCALE 1" = 1000'
 MINIMUM DEGREE OF ACCURACY SUBMETER
 PROVEN SOURCE OF ELEV. SUBMETER MAPPING GRADE GPS
 STATE OF WEST VIRGINIA DEPARTMENT OF ENERGY DIVISION OF OIL AND GAS

LEGEND

- Surface Owner Boundary Lines +/-
- Interior Surface Tracts +/-
- Proposed Well Path
- As Drilled Well Path

DOUGLAS R. ROWE P.S. 2202
 DATE 06/04/19
 OPERATOR'S WELL# JACK UNIT #3H

WELL TYPE: OIL GAS LIQUID INJECTION WASTE DISPOSAL
 (IF "GAS") PRODUCTION STORAGE DEEP SHALLOW
 LOCATION: ELEVATION 1,005' - AS BUILT WATERSHED OUTLET MIDDLE ISLAND CREEK
 QUADRANGLE MIDDLEBOURNE 7.5' DISTRICT MEADE COUNTY TYLER
 SURFACE OWNER ROGER R. WEESE ACREAGE 177.31 ACRES +/-
 OIL & GAS ROYALTY OWNER ROGER R. WEESE; JENNIFER LYNN LEASE ACREAGE 166.709 AC +/-; 77 AC +/-;
 GARLAND ET AL; THE FISHER OIL COMPANY; ROY HADLEY ET UX; WANDA D. SPENCER; 110 AC +/-; 200.06 AC +/-; 209.721 AC +/-;
 ROY D. HADLEY ET UX; RONALD P. MILLER; CATHY D. POST; DALE V. HADLEY; KIMBERLY RUBLE; 32.85 AC +/-; 8 AC +/-; 4.27 AC +/-; 10.5 AC +/-; 5 AC +/-
 PROPOSED WORK: DRILL CONVERT DRILL DEEPER REDRILL FRACTURE OR STIMULATE
 PLUG OFF OLD FORMATION PERFORATE NEW FORMATION OTHER PHYSICAL CHANGE IN WELL (SPECIFY) AS DRILLED PLUG & ABANDON CLEAN OUT & REPLUG
 TARGET FORMATION MARCELLUS ESTIMATED DEPTH 6,241' TVD 18,178' MD
 WELL OPERATOR ANTERO RESOURCES CORP. DESIGNATED AGENT DIANNA STAMPER - CT CORPORATION SYSTEM
 ADDRESS 1615 WYNKOOP STREET ADDRESS 5400 D BIG TYLER ROAD
 DENVER, CO 80202 CHARLESTON, WV 25313