

LATITUDE 39°25'00"

8,210'

5,476' TO BOTTOM HOLE
LATITUDE 39°22'30"

LONGITUDE 80°52'30"

6,011'
LONGITUDE 80°52'30"

Antero Resources Corporation
Well No. Beem Unit 1H

LOREN BAGLEY
W.B. 30 PG. 755
T.M. 11 PAR. 03
207.77 AC.±

LOREN BAGLEY
LEASE

WELL NO. 1H

N76°30' E
1883.7'

1H BOTTOM HOLE

16" CHESTNUT
OAK

FRANK GRASS ET AL
D.B. 279 PG. 226
T.M. 11 PAR. 05
43.78 AC.±

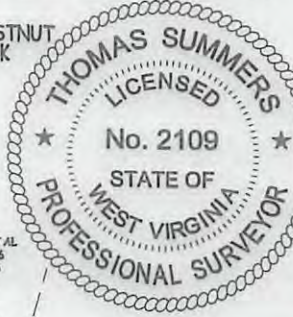

NOTES:
WELL 1H TOP HOLE INFORMATION:
N: 330,959ft E: 1,603,243ft
LAT: 39°24'00.60" LON: 80°54'14.59"
BOTTOM HOLE INFORMATION:
N: 320,688ft E: 1,605,819ft
LAT: 39°22'19.49" LON: 80°53'39.73"
WEST VIRGINIA COORDINATE
SYSTEM OF 1927 NORTH ZONE.
ZONE WAS DERIVED FROM
MEASUREMENTS TAKEN WITH
TRIMBLE GEOXT SUBMETER
MAPPING GRADE GPS UNIT.
PLAT ORIENTATION, CORNER,
AND WELL REFERENCE TIE LINES
ARE BASED ON GRID NORTH.

(NAD 83 (UTM) ZONE 17 COORDS:
WELL 1H TOP HOLE INFORMATION:
N: 4,361,198m E: 608,276m
BOTTOM HOLE INFORMATION:
N: 4,358,082m E: 609,113m

(NAD 27 (UTM) ZONE 17 COORDS:
WELL 1H TOP HOLE INFORMATION:
N: 14,307,650ft E: 1,667,521ft
POINT OF ENTRY INFORMATION:
N: 14,307,206ft E: 1,666,755ft
BOTTOM HOLE INFORMATION:
N: 14,297,427ft E: 1,670,268ft

NOTE:
NO OCCUPIED DWELLINGS OR BUILDINGS TWO THOUSAND
FIVE (2,000) SQUARE FEET OR LARGER USED TO
HOUSE OR SHELTER DAIRY CATTLE OR POULTRY
HAZARDOUS ARE LOCATED WITHIN SIX HUNDRED
TWENTY-FIVE (625) FEET OF THE CENTER OF THE WELL PAD.

WV NORTH ZONE
GRID NORTH

ROBERT FERRELL ET AL
D.B. 336 PG. 502
T.M. 11 PAR. 09
29.12 AC.±

FRANK GRASS
D.B. 279 PG. 226
T.M. 11 PAR. 14
81 AC.±

MARY ADKINS
W.B. 43 PG. 491
T.M. 11 PAR. 14.5
17.9 AC.±

JOSEPH E. HESS ET UX
LEASE
TERRY HEINTZMAN
D.B. 321 PG. 163
T.M. 11 PAR. 13
38 AC.±

PATRICIA HEINTZMAN
W.B. 36 PG. 549
T.M. 11 PAR. 16.1
31.75 AC.±

PATRICIA HEINTZMAN
LEASE
W.B. 36 PG. 549
T.M. 11 PAR. 16
48.13 AC.±

PATRICIA HEINTZMAN
W.B. 36 PG. 549
T.M. 11 PAR. 22
149.5 AC.±

JUDITH PHELPS
D.B. 337 PG. 5
T.M. 11 PAR. 10.1
44 AC.±

LINDA D. BURG-JETT
LEASE
GENE HOSKINS ET AL
D.B. 293 PG. 189
T.M. 11 PAR. 23
101.71 AC.±

BRYAN KLANDE
D.B. 308 PG. 438
T.M. 11 PAR. 17
65.81 AC.±

GARY DAWSON
D.B. 274 PG. 114
T.M. 12 PAR. 25
59 AC.±

GENE HOSKINS
ET AL
D.B. 294 PG. 192
T.M. 11 PAR. 24
19 AC.±

GENE HOSKINS
D.B. 291 PG. 50
T.M. 14 PAR. 2.1
14.06 AC.±

JERRY EDWIN STONEKING
LEASE

GENE HOSKINS
D.B. 291 PG. 50
T.M. 14 PAR. 3
18 AC.±

HAESSLY LAND
& TIMBER, LLC
D.B. 349 PG. 133
T.M. 14 PAR. 4
26.75 AC.±

HAESSLY LAND
& TIMBER, LLC
D.B. 349 PG. 133
T.M. 14 PAR. 6
63 AC.±



THOMAS SUMMERS P.S. 2109
DATE 08/24/17
OPERATOR'S WELL # BEEMUNIT1H

I THE UNDERSIGNED, HEREBY CERTIFY THAT THIS PLAT IS CORRECT
TO THE BEST OF MY KNOWLEDGE AND BELIEF AND SHOWS ALL THE
INFORMATION REQUIRED BY LAW AND THE RULES ISSUED AND
PERSCRIBED BY THE DEPARTMENT OF ENVIRONMENTAL PROTECTION.



STATE OF WEST VIRGINIA, DIVISION
OF ENVIRONMENTAL PROTECTION,
OFFICE OF OIL AND GAS

WILLOW LAND SURVEYING PLLC
220 MASONIC AVE. PENNSBORO
WEST VIRGINIA 26415

JOB # 17-033WA
DRAWING # BEEM1H
SCALE 1" = 1000'
MINIMUM DEGREE OF
ACCURACY SUBMETER
PROVEN SOURCE OF ELEV.
SUBMETER MAPPING GRADE GPS

47 - 095 - 02472
STATE COUNTY PERMIT
STATE OF WEST VIRGINIA
DEPARTMENT OF ENERGY
DIVISION OF OIL AND GAS

WELL TYPE: OIL GAS X LIQUID INJECTION WASTE DISPOSAL
(IF "GAS") PRODUCTION X STORAGE DEEP SHALLOW X
LOCATION: ELEVATION 1,142' - ORIGINAL 1,115' - PROPOSED WATERSHED OUTLET MIDDLE ISLAND CREEK
QUADRANGLE MIDDLEBOURNE 7.5 (TH) PENNSBORO 7.5 (RH) DISTRICT CENTERTVILLE COUNTY TYLER
SURFACE OWNER TYRONEL BEEM ET AL ACREAGE 300 AC ±
OIL & GAS ROYALTY OWNER E. G. BEEM; LOREN BAGLEY; JOSEPH E. HESS ET UX; PATRICIA HEINTZMAN;
LINDA D. BURG-JETT; CARL W. ASH; JERRY EDWIN STONEKING; L. GENE HOSKINS ET UX; LINDA D. BURG-JETT

LEASE ACREAGE 317 AC±; 207.77 AC±; 38 AC±; 323.76 AC±; 101.7 AC±; 43.5 AC±; 18 AC±; 87 AC±; 85 AC±
TARGET FORMATION MARCELLUS ESTIMATED DEPTH 6,800' TVD 17,400' MD
WELL OPERATOR ANTERO RESOURCES CORP. DESIGNATED AGENT DIANNA STAMPER - CT CORPORATION SYSTEM
ADDRESS 1615 WYKHOOP STREET ADDRESS 5400 D BIG TYLER ROAD
FORM WW-6 DENVER, CO 80202 CHARLESTON, WV 25313

REFERENCES



10/27/2017

COUNTY NAME PERMIT

