

LATITUDE 39°25'00"

11,303'

LATITUDE 39°25'00"

586' LONGITUDE 80°55'00"

10,837' TO BOTTOM HOLE

NO OCCUPIED DWELLINGS OR BUILDINGS TWO THOUSAND (TWO THOUSAND FEET) FROM THE CENTER OF THE WELL PAD. NO HOUSE OR BARN OR OTHER BUILDING LOCATED WITHIN FIVE (5) FEET OF THE CENTER OF THE WELL PAD.

JANIE DENOON TRUST LEASE

Antero Resources Corporation Well No. Remington Unit 1H

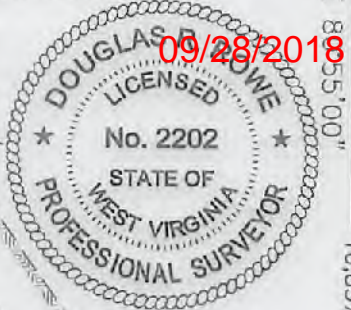

09/28/2018

NOTES: WELL 1H TOP HOLE INFORMATION: N: 336,619ft E: 1,588,462ft LAT: 39°24'54.21" LON: 80°57'24.02" BOTTOM HOLE INFORMATION: N: 326,324ft E: 1,591,119ft LAT: 39°23'12.89" LON: 80°56'48.07" WEST VIRGINIA COORDINATE SYSTEM OF 1927 NORTH ZONE. ZONE WAS DERIVED FROM MEASUREMENTS TAKEN WITH TRIMBLE GEOXT SUBMETER MAPPING GRADE GPS UNIT, PLAT ORIENTATION, CORNER, AND WELL REFERENCE TIE LINES ARE BASED ON GRID NORTH.

(NAD) 83 (UTM) ZONE 17 COORDS: WELL 1H TOP HOLE INFORMATION: N: 4,362,847m E: 503,744m BOTTOM HOLE INFORMATION: N: 4,359,724m E: 504,606m

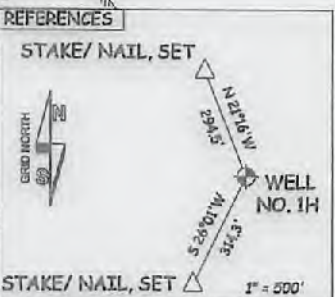
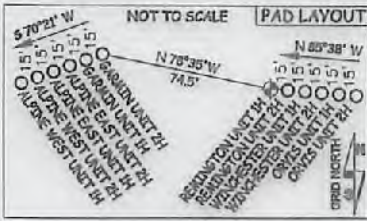

(NAD) 27 (UTM) ZONE 17 COORDS: WELL 1H TOP HOLE INFORMATION: N: 14,313,061ft E: 1,652,654ft POINT OF ENTRY INFORMATION: N: 14,312,810ft E: 1,651,900ft BOTTOM HOLE INFORMATION: N: 14,302,815ft E: 1,655,430ft

NOTE: 7 WATER WELLS WERE LOCATED WITHIN 2000' OF CENTER OF PAD

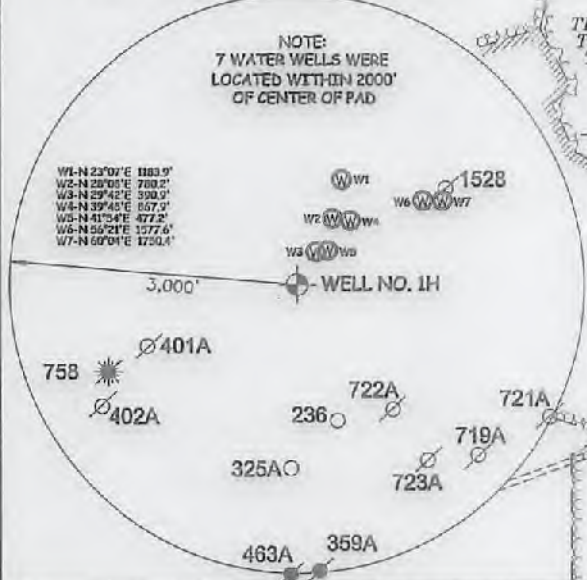

I, THE UNDERSIGNED, HEREBY CERTIFY THAT THIS PLAT IS CORRECT TO THE BEST OF MY KNOWLEDGE AND BELIEF AND SHOWS ALL THE INFORMATION REQUIRED BY LAW AND THE RULES ISSUED AND PRESCRIBED BY THE DEPARTMENT OF ENVIRONMENTAL PROTECTION.



STATE OF WEST VIRGINIA, DIVISION OF ENVIRONMENTAL PROTECTION, OFFICE OF OIL AND GAS

WILLOW LAND SURVEYING PLLC 220 MASONIC AVE. PENNSBORO WEST VIRGINIA 26415

JOB # 17-001WA DRAWING # REMINGTON1HGOR2 SCALE 1" = 1000' MINIMUM DEGREE OF ACCURACY SUBMETER PROVEN SOURCE OF ELEV. SUBMETER MAPPING GRADE GPS STATE OF WEST VIRGINIA DEPARTMENT OF ENERGY DIVISION OF OIL AND GAS

LEGEND: Surface Owner Boundary Lines +/- Interior Surface Tracts +/- Existing Fence Found monument, as noted. Signature: Douglas R. Rowe P.S. 2202 DATE 06/07/18 OPERATOR'S WELL # REMINGTON UNIT #1H 47 - 095 - 02533 STATE COUNTY PERMIT

WELL TYPE: OIL GAS X LIQUID INJECTION WASTE DISPOSAL (IF "GAS") PRODUCTION X STORAGE DEEP SHALLOW X LOCATION: ELEVATION 799' AS BUILT WATERSHED OUTLET MIDDLE ISLAND CREEK QUADRANGLE MIDDLEBOURNE 7.5' DISTRICT MEADE COUNTY TYLER SURFACE OWNER JAMES SINE ET AL ACREAGE 32.395 ACRES +/- OIL & GAS ROYALTY OWNER JAMES SINE ET UX; MARK KARL; JANIE DENOON TRUST LEASE ACREAGE 51.74 AC; 73 AC; 05.3 AC; THELMA HADLEY TESTAMENTARY TRUST; THOMAS MOORE ET AL; CARL JACK WILCOX; THE JOE LYNN FAMILY PRESERVATION TRUST; THE JOE LYNN FAMILY PRESERVATION TRUST; GARY BARNARD ET UX 44.28 AC; 175.07 AC; 129.86 AC; 20 AC; 200 AC; 91.56 AC

PROPOSED WORK: DRILL X CONVERT DRILL DEEPER REDRILL FRACTURE OR STIMULATE X PLUG OFF OLD FORMATION PERFORATE NEW FORMATION X OTHER PHYSICAL CHANGE IN WELL (SPECIFY) PLUG & ABANDON CLEAN OUT & REPLUG TARGET FORMATION MARCELLUS ESTIMATED DEPTH 6,600' TVD 18,400' MD WELL OPERATOR ANTERO RESOURCES CORP. DESIGNATED AGENT DIANNA STAMPER - CT CORPORATION SYSTEM ADDRESS 1615 WYNKOOP STREET ADDRESS 5400 D BIG TYLER ROAD DENVER, CO 80202 CHARLESTON, WV 25313

09/28/2018

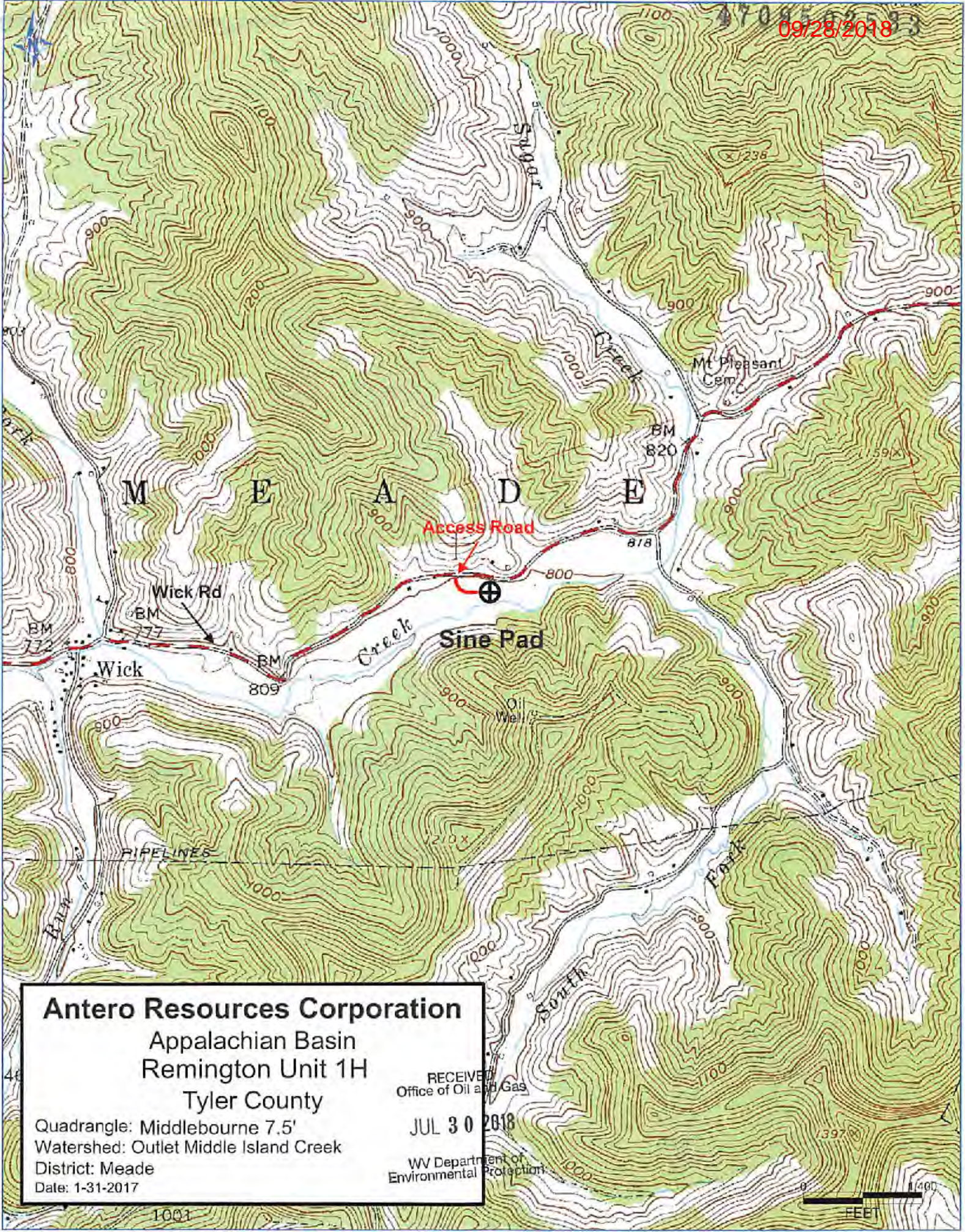

Antero Resources Corporation
 Appalachian Basin
 Remington Unit 1H
 Tyler County

Quadrangle: Middlebourne 7.5'
 Watershed: Outlet Middle Island Creek
 District: Meade
 Date: 1-31-2017

RECEIVED
 Office of Oil and Gas
 JUL 30 2018
 WV Department of
 Environmental Protection

1400
 FEET