

10,354 to Bottom Hole

4,625' to Top Hole

BOTTOM LATITUDE 39 - 32 - 30
TOP LATITUDE 39 - 30 - 00

LONGITUDE 80 - 55 - 00

13,326' to Top Hole

14,533' to Bottom Hole

Antero Resources
Well No. Houser Unit 2H
Antero Resources Corporation

(+) Denotes
Location of Well on
United States
Topographic Maps

Leases:

- A. Karl E. Rine, et ux
- B. David T. Cox
- C. Carol J. Cox
- D. Jerry A. & Nancy J. Haught, et al
- E. Stanley M. LeMasters, et ux
- F. Carol J. Cox
- G. John P. Bucher, et ux
- H. Jerald J. Sawinski
- I. James E. Barnhart
- J. Rebecca A. Haught
- K. Carolyn J. Davis
- L. Richard G. Thomas



	TM-Par.	Bk/Pg	Acres	Owner(s)
1	19-37.1	307/354	32.858	Michael Haught
2	19-41.1	137/354	1.50	June Kempner
3	19-41.2	293/628	5.00	Karl E. & Judith K. Rine
4	19-41.5	422/759	1.80	Derrick K. & Heather B. Rine
5	p/o 19-41	293/627	4.28	Karl E. & Judith K. Rine
6	19-41.3	274/173	1.28	Stanley M. Lemasters
7	19-41.4	293/625	5.64	Karl E. & Judith K. Rine
8	p/o 19-41	293/627	4.28	Karl E. & Judith K. Rine
9	19-40	334/298	14.10	Carol J. Cox
10	19-39	334/298	4.50	Carol J. Cox
11	19-38	300/609	5.80	David T. Cox
12	p/o 19-37	307/354	32.892	Jerry A. & Nancy J. Haught
13	19-33.2	317/466	3.10	James E. Barnhart
14	19-2	342/582	6.50	John P. & Bonnie B. Bucher
15	19-33.1	468/818	1.42	Amos L. Archer
16	19-43	352/435	32.53	Don L. Hissam
17	13-10	383/761	96.82	Eldon J. & Ruth A. Helman
18	19-42	334/298	142.0	Carol J. Cox
19	13-9	190/9	58.38	Chauncy P. & Ruth Archer
20	19-33.3	253/44	29.8	Chauncy P. & Ruth Archer

Well Location References
(Not to Scale)



I, the undersigned, hereby certify that this plat is correct to the best of my knowledge and belief and shows all the information required by law and the rules issued and prescribed by the Department of Environmental Protection.

Bradley D. Miller, P.S. 2167

Notes:
West Virginia Coordinate System of 1927, North Zone based upon Differential GPS Measurements.
Well No. Houser Unit 2H Top Hole coordinates are
N: 354,046.68' Latitude: 39°27'47.58"
E: 1,595,626.94' Longitude: 80°55'56.28"
Bottom Hole coordinates are
N: 368,013.89' Latitude: 39°30'04.74"
E: 1,590,137.50' Longitude: 80°57'09.15"
UTM Zone 17, NAD 1983
Top Hole Coordinates N: 4,368,193.104m E: 505,838.408m
Bottom Hole Coordinates N: 4,372,420.250m E: 504,094.992m
Plat orientation and corner and well references are based upon the grid north meridian. Well location references are based upon the magnetic meridian.

	Bearing	Dist.
L1	S 27°19' E	1,037.4'
L2	S 28°01' W	1614.9'
L3	S 47°59' W	1,896.6'
L4	N 46°02' E	674.7'
L5	S 72°48' W	909.0'

Legend

- ⊙ Proposed gas well
- ⊛ Found corner, as noted
- ⊙ Existing Well, as noted
- - - - - Creek or Drain
- - - - - Existing Road
- Surface boundary (approx.)
- - - - - Interior surface tracts (approx.)

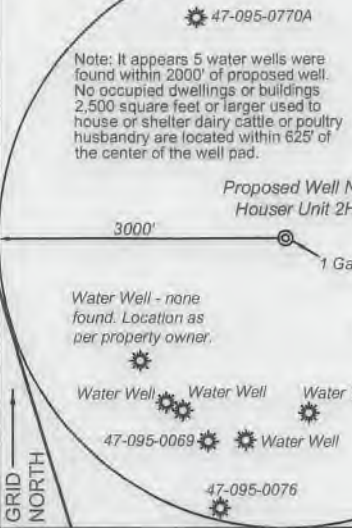

FILE NO: 218-54-E-16
DRAWING NO: Houser 2H-A Well Plat
SCALE: 1" = 2000'
MINIMUM DEGREE OF ACCURACY: Submeter
PROVEN SOURCE OF ELEVATION: WVDOT, Harrisville, WV

STATE OF WEST VIRGINIA
DEPARTMENT OF ENVIRONMENTAL PROTECTION
OIL AND GAS DIVISION

DATE: October 5 20 18
OPERATOR'S WELL NO. Houser Unit 2H
API WELL NO
47 - 095 - 02555
STATE COUNTY PERMIT

WELL TYPE: OIL GAS LIQUID INJECTION WASTE DISPOSAL
(IF GAS) PRODUCTION: STORAGE DEEP SHALLOW

LOCATION: ELEVATION: As-Built 912' WATERSHED: Outlet Middle Island Creek QUADRANGLE: Middlebourne 125.93; 81.66; 34.3; 97.5; 88.18; 4.5; 95.6; 7.3; 16.72; 100; 21; 65.388; 21; 189.3625; 291.5; 75; 100; 202

DISTRICT: Meade & Ellsworth SURFACE OWNER: Kirk L. Hadley ROYALTY OWNER: Kirk Hadley, Alfred Lonzo Eddy, Carol J. Cox (2); David T. Cox; Karl E. Rine, et ux; LEASE NO: ACREAGE: 162

PROPOSED WORK: DRILL CONVERT DRILL DEEPER FRACTURE OR STIMULATE PLUG OFF OLD FORMATION PERFORATE NEW FORMATION OTHER PHYSICAL CHANGE IN WELL (SPECIFY) _____ ESTIMATED DEPTH: 23,000' MD

PLUG AND ABANDON CLEAN OUT AND REPLUG TARGET FORMATION: Marcellus Shale

WELL OPERATOR: Antero Resources Corporation DESIGNATED AGENT: Dianna Stamper - CT Corporation System
ADDRESS: 1615 Wynkoop Street ADDRESS: 5400 D Big Tyler Road
Denver, CO 80202 Charleston, WV 25313

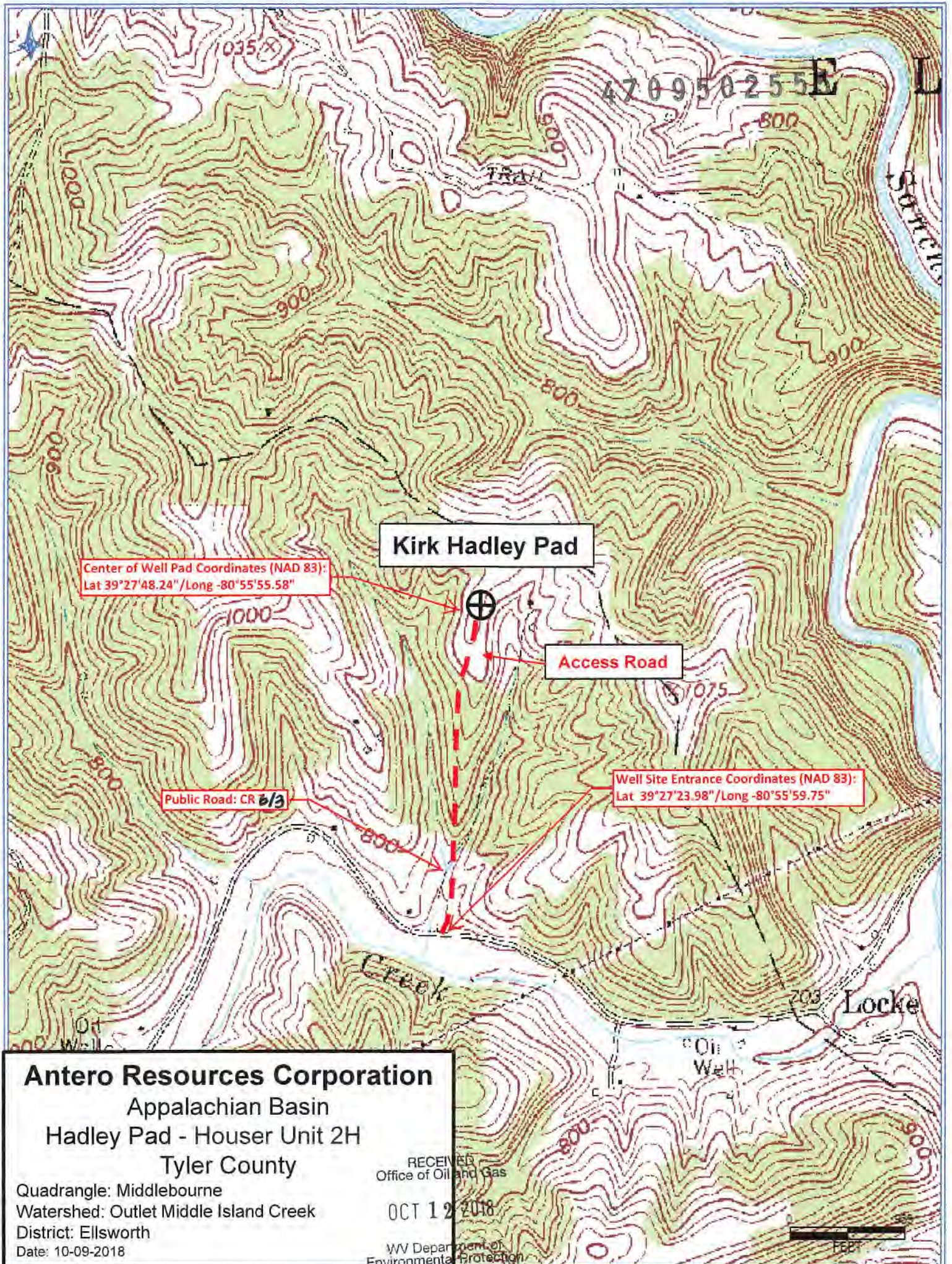

Center of Well Pad Coordinates (NAD 83):
Lat 39°27'48.24"/Long -80°55'55.58"

Kirk Hadley Pad

Access Road

Public Road: CR 613

Well Site Entrance Coordinates (NAD 83):
Lat 39°27'23.98"/Long -80°55'59.75"

Antero Resources Corporation
Appalachian Basin
Hadley Pad - Houser Unit 2H
Tyler County

Quadrangle: Middlebourne
Watershed: Outlet Middle Island Creek
District: Ellsworth
Date: 10-09-2018

RECEIVED
Office of Oil and Gas

OCT 12 2018

WV Department of
Environmental Protection

