

Antero Resources
Well No. Treasury Unit 1H
As-Drilled
Antero Resources Corporation

(+) Denotes
 Location of Well on
 United States
 Topographic Maps

PAGE 1 of 2

8,023' to Bottom Hole

4,617' to Top Hole

BOTTOM LATITUDE 39 - 32 - 30
TOP LATITUDE 39 - 30 - 00

LONGITUDE 80 - 55 - 00

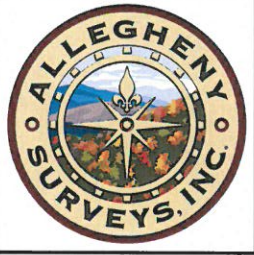

I, the undersigned, hereby certify that this plat is correct to the best of my knowledge and belief and shows all the information required by law and the rules issued and prescribed by the Department of Environmental Protection.

Bradley D. Miller
Bradley D. Miller, P.S. 2167

Lease Owner Table

A.	Lisa D. Beaver Lease
B.	Marshall J. Dalrymple Lease
C.	Phyllis Roth Tobias Lease
D.	Harry W. Pixler Lease
E.	p/o CHK-MAC, LLC Lease

- Wellhead Layout**
 Detail Not to Scale
- Dierkes Unit 3H
 - Dierkes Unit 2H 47-095-02551
 - Dierkes Unit 1H 47-095-02550
 - Kirk Hadley Unit 2H
 - Kirk Hadley Unit 1H 47-095-02554
 - Treasury Unit 2H 47-095-02557
 - **As-Drilled Treasury Unit 1H 47-095-02556**
 - Weese Unit 2H 47-095-02553
 - Weese Unit 1H 47-095-02552
 - Houser Unit 3H
 - Houser Unit 2H 47-095-02555
 - Houser Unit 1H 47-095-02480
 - Kirk Hadley 8 47-095-02031

Notes:
 West Virginia Coordinate System of 1927, North Zone based upon Differential GPS Measurements.
 Well No. Treasury Unit 1H Top Hole coordinates are
 N: 354,086.09' Latitude: 39°27'47.97"
 E: 1,595,634.37' Longitude: 80°55'56.20"
 Bottom Hole coordinates are
 N: 368,755.66' Latitude: 39°30'12.44"
 E: 1,592,468.36' Longitude: 80°56'39.57"

Bearing	Dist.
L1 N 44°10' E	707.8'
L2 S 28°43' E	1,006.1'
L3 S 28°27' W	1,576.6'
L4 S 48°44' W	1,864.9'

Top Hole Coordinates, As-drilled data, and information was provided by Antero Resources Corporation. Allegheny Surveys Inc. (ASI) is not certifying the data and information provided. ASI is not responsible for any errors or inaccuracies with the data and information that has been provided.

UTM Zone 17, NAD 1983
 Top Hole Coordinates Bottom Hole Coordinates
 N: 4,368,205.093m N: 4,372,658.110m
 E: 505,840.471m E: 504,801.329m

Plat orientation and corner and well references are based upon the grid north meridian. Well location references are based upon the magnetic meridian.

Legend

- Proposed gas well
- Found corner, as noted
- ⊙ Existing Well, as noted
- ⊙ Digitized Well
- Creek or Drain
- Existing Road
- Surface boundary (approx.)
- Interior surface tracts (approx.)

Note: It appears 5 water wells were found within 2000' of proposed well. No occupied dwellings or buildings 2,500 square feet or larger used to house or shelter dairy cattle or poultry husbandry are located within 625' of the center of the well pad.

FILE NO: 101-54-E-18
 DRAWING NO: Treasury 1H As-Drilled
 SCALE: 1" = 2000'
 MINIMUM DEGREE OF ACCURACY: Submeter
 PROVEN SOURCE OF ELEVATION: WVDOT, Harrisville, WV

STATE OF WEST VIRGINIA
 DEPARTMENT OF ENVIRONMENTAL PROTECTION
OIL AND GAS DIVISION

DATE: April 23 20 20
 OPERATOR'S WELL NO. Treasury Unit 1H
 API WELL NO
 47 - 095 - 02556
 STATE COUNTY PERMIT

WELL TYPE: OIL GAS LIQUID INJECTION WASTE DISPOSAL
 (IF GAS) PRODUCTION: STORAGE DEEP SHALLOW

LOCATION: ELEVATION: As-Built 912' WATERSHED: Outlet Middle Island Creek QUADRANGLE: Middlebourne
 DISTRICT: Meade, Ellsworth, Lincoln COUNTY: Tyler 34.3; 21.48; 127.39; 95.6; 189.3625; 14;
 SURFACE OWNER: Kirk L. Hadley Mark & Ellen VanDyne; Leon D. Ammons, et ux; Ruth E. Moore, widow; Robert Earl Pitts; Donna Smith; Phyllis Roth Tobias; West Virginia Division of Natural Resources (2); Susan G. & John Fritz; Ridgetop Capital, IV, LP.; Carolyn J. Davis; 33.11; 35.11; 64.48;
 ROYALTY OWNER: Kirk Hadley; Richard L. Clark (2); Joseph L. & Glenna Crowe; James Moore; LEASE NO: _____ ACREAGE: 162 56.98; 140; 100; 202; 8.62; 61.25; 66.84;

PROPOSED WORK: DRILL CONVERT DRILL DEEPER FRACTURE OR STIMULATE PLUG OFF OLD FORMATION
 PERFORATE NEW FORMATION OTHER PHYSICAL CHANGE IN WELL (SPECIFY) As-Drilled
 PLUG AND ABANDON CLEAN OUT AND REPLUG TARGET FORMATION: Marcellus Shale ESTIMATED DEPTH: 21,584' MD 6,180' TVD

WELL OPERATOR: Antero Resources Corporation DESIGNATED AGENT: Dianna Stamper - CT Corporation System
 ADDRESS: 1615 Wynkoop Street ADDRESS: 5400 D Big Tyler Road
Denver, CO 80202 Charleston, WV 25313

No.	TM - Par.	Bk / Pg	Acres	Owner(s)	District
54	13 - 3.4	415 / 733	7.505	Justin L. & Jessica Carpenter	Ellsworth District
53	13 - 5	393 / 473	78.00	Mildred Scales	
52	13 - 7	387 / 671	6.04	Robert D. & Sherry A. Ball	
51	13 - 8	WB43 / 425	56.98	Larry Moore & James Moore	
50	13 - 8.1	371 / 36	35.11	Leon B. & Deanna N. Ammons	Ellsworth District
49	13 - 6	387 / 671	21.42	Robert D. & Sherry A. Ball	
48	19 - 4	388 / 250	1.20	Harry Wayne Pixler	
47	19 - 56	390 / 553	23.56	Mark L. & Ellen W. VanDyne	
46	19 - 33	308 / 18	60.12	Mark L. & Ellen W. VanDyne	Ellsworth District
45	19 - 55	333 / 208	9.55	Mark & Ellen VanDyne	
44	19 - 5	471 / 812	0.89	Ruth A. McDonald	
43	20 - 1	210 / 37	126.90	Mark L. & Ellen W. VanDyne	
42	19 - 29	39 / 506	0.39	Gloria L. Lowther	Ellsworth District
41	19 - 28	39 / 506	0.083	Gloria L. Lowther	
40	19 - 27	39 / 506	0.08	Gloria L. Lowther	
39	19 - 6	245 / 651	8.05	Jerry E. & Jessie K. Tracy	
38	19 - 7	337 / 653	0.77	Jerry E. & Jessie K. Tracy	Ellsworth District
37	19 - 26	326 / 86	0.60	Jack & Margaret M. Henthorn	
36	19 - 9	355 / 675	0.23	Kimberly L. Billings	
35	19 - 10	355 / 675	0.35	Kimberly L. Billings	
34	19 - 11	355 / 675	0.23	Kimberly L. Billings	Ellsworth District
33	19 - 12	255 / 334	0.35	Beverly J. Welch	
32	19 - 13	255 / 334	0.80	Beverly J. Welch	
31	19 - 25.1	303 / 105	1.288	Bill & Patricia Lemasters	
30	19 - 13.1	355 / 782	0.03	Gloria L. Lowther	Ellsworth District
29	19 - 14	355 / 782	0.39	Gloria L. Lowther	
28	19 - 15	355 / 782	0.39	Gloria L. Lowther	
27	19 - 16	329 / 47	0.79	Donald R. Thompson	
26	19 - 25	329 / 47	1.241	Donald R. Thompson	Ellsworth District
25	19 - 25.3	334 / 117	0.631	Keith & Barbara Frum	
24	19 - 25.2	334 / 117	0.631	Keith & Barbara Frum	
23	19 - 21	312 / 141	0.30	Jerry Michael & Anna Arlene Cooper	
22	19 - 17	312 / 141	0.51	Jerry Michael & Anna Arlene Cooper	Ellsworth District
21	19 - 20	312 / 141	0.22	Jerry Michael & Anna Arlene Cooper	
20	19 - 18	312 / 141	0.06	Jerry Michael & Anna Arlene Cooper	
19	19 - 19	226 / 266	2.308	Keith V. & Barbara Frum	
18	20 - 34	344 / 268	7.75	Michael P. & Deborah G. Haught	Ellsworth District
17	19 - 31	334 / 603	0.25	WV Department of Highways	
16	19 - 32	147 / 426	4.41	Mary J. Smith	
15	19 - 52.1	369 / 434	1.00	Hope Fellowship in Christ's Church	
14	19 - 34	318 / 636	95.60	Chauncy P. & Ruth Archer	Ellsworth District
13	19 - 35	WB30 / 315	29.00	Rebecca Haught	
12	19 - 52	WB43 / 425	188.36	Larry Moore, et al	
11	20 - 35	181 / 376	140.00	Robert C. Sellers, et al	
10	20 - 98	247 / 7	74.231	John P. L. Hennessy	Ellsworth District
9	20 - 97	314 / 699	66.84	Dennis J. & Connie S. Moore	
8	26 - 3	448 / 216	63.02	Dennis James Moore, et al	
7	26 - 9	404 / 352	28.021	JB Exploration I, LLC	
6	26 - 2	314 / 701	63.40	Larry G. & Besty E. Moore	Ellsworth District
5	26 - 1	448 / 216	61.78	Dennis James Moore, et al	
4	19 - 54	WB36 / 738	100.00	Deborah Susan Reed	
3	25 - 2	333 / 188	75.00	Angela K. & James A. Long Jr.	
2	26 - 11	321 / 842	40.00	Kirk L. Hadley	Ellsworth District
1	26 - 12	213 / 74	162.00	Kirk L. Hadley	

No.	TM - Par.	Bk / Pg	Acres	Owner(s)
72	2 - 15.1	333 / 188	23.70	Angela K. & James A. Long Jr.
71	2 - 5	392 / 712	69.50	Robert L. & Nancy C. Donaghy, et al
70	2 - 5.1	204 / 309	54.24	Donald R. & Shirley D. Fletcher
69	2 - 15	333 / 188	100.00	Angela K. & James A. Long Jr.
68	3 - 1.2	309 / 598	41.25	William Kent & Deborah Lee Snyder
67	15 - 13	174 / 412	140.00	B.F., Ben H., & Ida M. Kile
66	15 - 16.1	339 / 706	1.00	Richard G. Thomas
65	15 - 16	WB30 / 1	81.67	Everett Glen Thomas
64	15 - 17	191 / 12	127.39	Earl & Donna Smith
63	15 - 17.1	327 / 758	6.35	Lisa D. Beaver
62	19 - 30	WB30 / 315	5.40	Rebecca A. Haught
61	19 - 8	357 / 127	0.60	Robert G. & Pamela R. Gorby
60	13 - 3.1	350 / 388	13.919	Earnley H. & Donna J. Owens
59	13 - 3.2	342 / 509	2.433	Marshal J. & Peggy S. Dalrymple
58	13 - 4	267 / 209	1.03	Marshal J. Dalrymple
57	13 - 3	387 / 671	8.62	Robert D. & Sherry A. Ball
56	13 - 3.5	406 / 668	17.648	Lisa M. Beane
55	13 - 3.3	349 / 563	70.509	Richard J. Mathisen

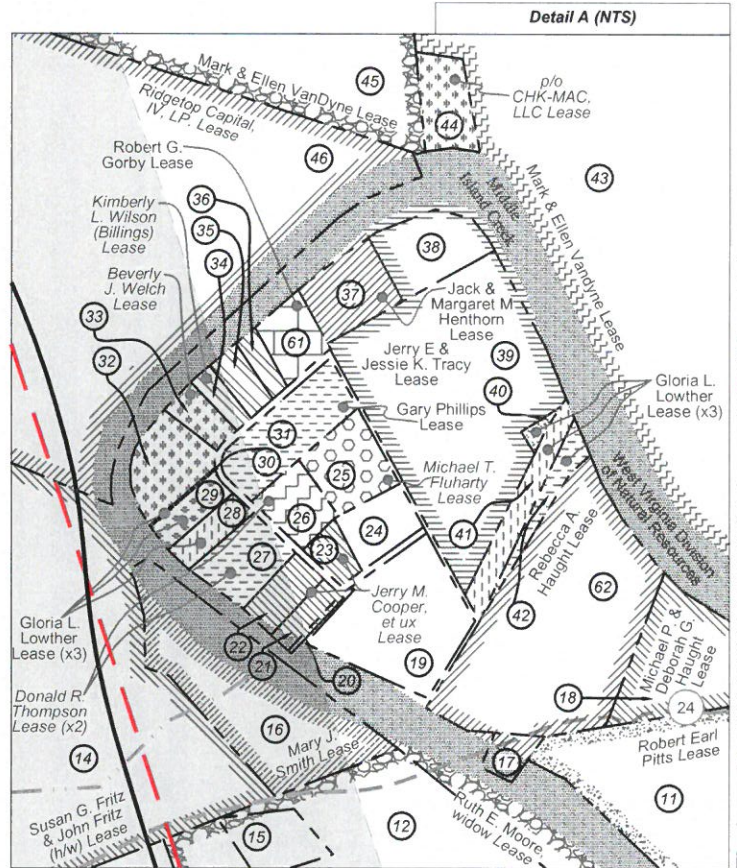

FILE NO: 101-54-E-18
 DRAWING NO: Treasury 1H As-Drilled
 SCALE: 1" = 2000'
 MINIMUM DEGREE OF ACCURACY:
 Submeter
 PROVEN SOURCE OF ELEVATION:
 WVDOT, Harrisville, WV

STATE OF WEST VIRGINIA
 DEPARTMENT OF ENVIRONMENTAL PROTECTION
OIL AND GAS DIVISION

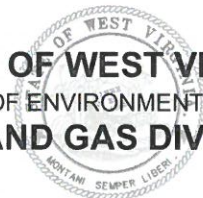

DATE: April 23 20 20
 OPERATOR'S WELL NO. Treasury Unit 1H
 API WELL NO
 47 - 095 - 02556
 STATE COUNTY PERMIT

WELL TYPE: OIL GAS LIQUID INJECTION WASTE DISPOSAL
 (IF GAS) PRODUCTION: STORAGE DEEP SHALLOW
 LOCATION: ELEVATION: As-Built 912' WATERSHED: Outlet Middle Island Creek QUADRANGLE: Middlebourne
 DISTRICT: Meade, Ellsworth, Lincoln COUNTY: Tyler 34.3; 21.48; 127.39;
 SURFACE OWNER: Kirk L. Hadley Mark & Ellen VanDyne; Leon D. Ammons, et ux; Ruth E. Moore, widow; Robert Earl Pitts; Donna Smith; Phyllis Roth Tobias; West Virginia Division of Natural Resources (2); Susan G. & John Fritz; Ridgetop Capital, IV, LP.; Carolyn J. Davis; 95.6; 189.3625; 14;
 ROYALTY OWNER: Kirk Hadley; Richard L. Clark (2); Joseph L. & Glenna Crowe; James Moore; LEASE NO: ACREAGE: 162 33.11; 35.11; 64.48;
 PROPOSED WORK: DRILL CONVERT DRILL DEEPER FRACTURE OR STIMULATE PLUG OFF OLD FORMATION 56.98; 140; 100; 202;
 PERFORATE NEW FORMATION OTHER PHYSICAL CHANGE IN WELL (SPECIFY) As-Drilled 8.62; 61.25; 66.84;
 PLUG AND ABANDON CLEAN OUT AND REPLUG TARGET FORMATION: Marcellus Shale ESTIMATED DEPTH: 21,584' MD 6,180' TVD

WELL OPERATOR: Antero Resources Corporation DESIGNATED AGENT: Dianna Stamper - CT Corporation System
 ADDRESS: 1615 Wynkoop Street ADDRESS: 5400 D Big Tyler Road
 Denver, CO 80202 Charleston, WV 25313