

2,673' to Bottom Hole

672' to Top Hole

LATITUDE 39 - 30 - 00

LONGITUDE 80 - 55 - 00

Antero Resources Well No. Remo Unit 1H

Antero Resources Corporation

No.	TM - Par.	Bk / Pg	Acres	Owner(s)
1	20 - 102	575/69	203.59	Antero Midstream, LLC
2	26 - 3	448 / 216	63.02	Dennis James Moore, et al
3	26 - 2	314 / 701	63.40	Larry G. & Betsy E. Moore
4	26 - 1	448 / 216	61.78	Dennis James Moore, et al
5	20 - 97	314 / 699	66.84	Dennis J. & Connie S. Moore
6	20 - 98	247 / 7	74.231	John P.L. Hennessy

I, the undersigned, hereby certify that this plat is correct to the best of my knowledge and belief and shows all the information required by law and the rules issued and prescribed by the Department of Environmental Protection.

Bradley D. Miller
Bradley D. Miller, P.S. 2167

Tag	Lease Owner(s)
A	The Swan Living Trust
B	Larry R. Henthorn, et ux
C	
D	Richard L. Clark
E	
F	John P.L. Hennessy
G	Richard L. Clark

Well Location References

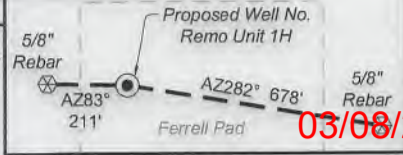

Legend

- Proposed gas well
- Monument, as noted
- Existing Well, as noted
- Creek or Drain
- Roads
- Surface boundary (approx.)
- Interior surface tracts (approx.)

	Bearing	Dist.	Monument
L1	N 85°35' E	1,894.6'	5/8" Rebar
L2	S 48°11' W	2,903.9'	5/8" Rebar
L3	N 58°03' W	2,667.8'	3/4" Rebar
L4	N 51°28' W	1,589.7'	W.O.
L5	S 47°02' E	1,736.8'	Spring
L6	S 75°34' W	1,575.6'	POE



Note: 1 spring was found within 2000' of proposed well. No occupied dwellings or buildings 2,500 square feet or larger used to house or shelter dairy cattle or poultry husbandry are located within 625' of the center of the well pad. There were no gas wells found or documented within 3000' of the proposed well.

Wellhead Layout (NTS)

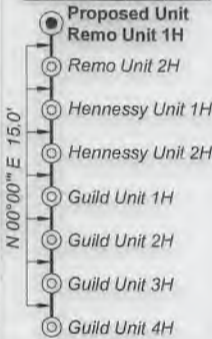

Notes:
Well No. Remo Unit 1H
UTM Zone 17, NAD 1927
Top Hole Coordinates
N: 14,333,968.68"
E: 1,663,419.96"
Point of Entry Coordinates
N: 14,333,550.78"
E: 1,661,901.37"
Bottom Hole Coordinates
N: 14,335,003.14"
E: 1,661,402.05"

Notes:
West Virginia Coordinate System of 1927, North Zone based upon Differential GPS Measurements.
Well No. Remo Unit 1H Top Hole coordinates are
N: 357,351.47' Latitude: 39°28'20.86"
E: 1,599,579.92' Longitude: 80°55'06.55"
Bottom Hole coordinates are
N: 358,419.84' Latitude: 39°28'31.10"
E: 1,597,578.87' Longitude: 80°55'32.28"
UTM Zone 17, NAD 1983
Top Hole Coordinates Bottom Hole Coordinates
N: 4,369,220.004m N: 4,369,535.293m
E: 507,025.883m E: 506,410.824m
Plat orientation and corner and well references are based upon the grid north meridian.
Well location references are based upon the magnetic meridian.

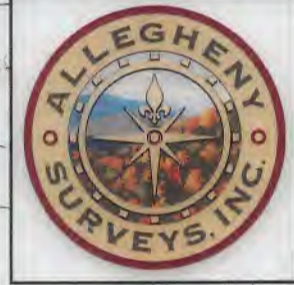

FILE NO: 17-54-E-17
DRAWING NO: Remo 1H Well Plat_Shorty
SCALE: 1" = 1500'
MINIMUM DEGREE OF ACCURACY: Submeter
PROVEN SOURCE OF ELEVATION: WVDOT, Harrisville, WV

STATE OF WEST VIRGINIA
DEPARTMENT OF ENVIRONMENTAL PROTECTION
OIL AND GAS DIVISION

DATE: December 18 2018
OPERATOR'S WELL NO. Remo Unit 1H
API WELL NO
47 - 095 - 02578
STATE COUNTY PERMIT

WELL TYPE: OIL GAS LIQUID INJECTION WASTE DISPOSAL
(IF GAS) PRODUCTION: STORAGE DEEP SHALLOW
LOCATION: ELEVATION: Proposed Elev. 757' Existing Elev. 770' WATERSHED: Outlet Middle Island Creek QUADRANGLE: Middlebourne
DISTRICT: Ellsworth COUNTY: Tyler
SURFACE OWNER: Antero Midstream, LLC ACREAGE: 203.59 66.84; 61.71875;
ROYALTY OWNER: Larry R. Henthorn, et ux; Richard L. Clark (3); LEASE NO: ACREAGE: 63.02; 63.4
PROPOSED WORK: DRILL CONVERT DRILL DEEPER FRACTURE OR STIMULATE PLUG OFF OLD FORMATION
 PERFORATE NEW FORMATION OTHER PHYSICAL CHANGE IN WELL (SPECIFY) _____ 6,500' TVD
 PLUG AND ABANDON CLEAN OUT AND REPLUG TARGET FORMATION: Marcellus Shale ESTIMATED DEPTH: 10,200' MD

WELL OPERATOR: Antero Resources Corporation DESIGNATED AGENT: Dianna Stamper - CT Corporation System
ADDRESS: 1615 Wynkoop Street ADDRESS: 5400 D Big Tyler Road
Denver, CO 80202 Charleston, WV 25313

10,021' to Top Hole

8,953' to Bottom Hole

03/08/2019

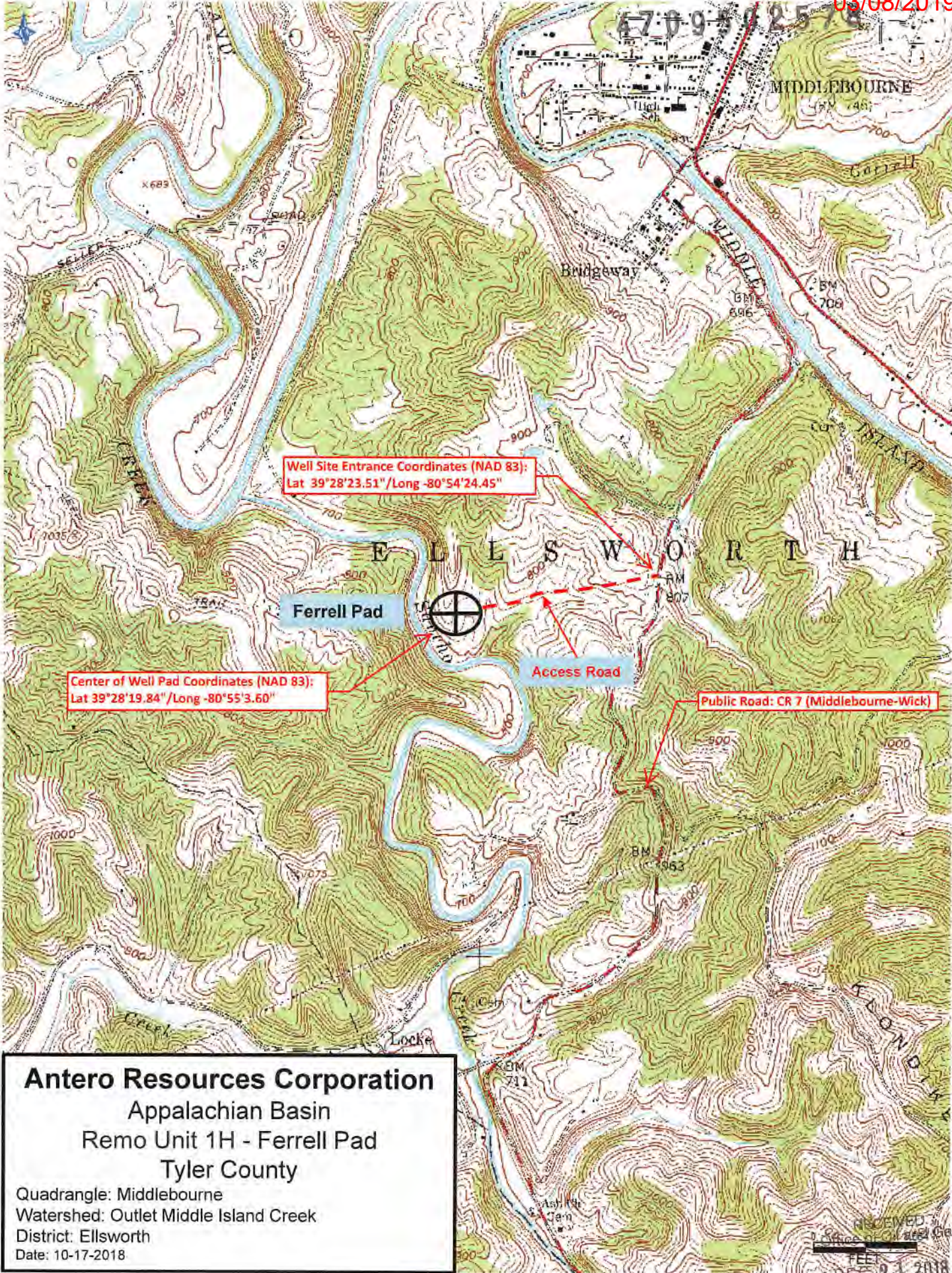

Well Site Entrance Coordinates (NAD 83):
 Lat 39°28'23.51"/Long -80°54'24.45"

Center of Well Pad Coordinates (NAD 83):
 Lat 39°28'19.84"/Long -80°55'3.60"

Public Road: CR 7 (Middlebourne-Wick)

Antero Resources Corporation
 Appalachian Basin
 Remo Unit 1H - Ferrell Pad
 Tyler County

Quadrangle: Middlebourne
 Watershed: Outlet Middle Island Creek
 District: Ellsworth
 Date: 10-17-2018

RECEIVED BY
 State of West Virginia
 DEPT. OF ENVIRONMENTAL PROTECTION
 DEC 21 2018