

Antero Resources
Well No. Wick Unit 2H
Antero Resources Corporation

Well Location References (NTS)

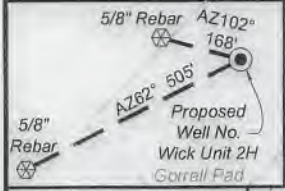

Wellhead Layout (NTS)

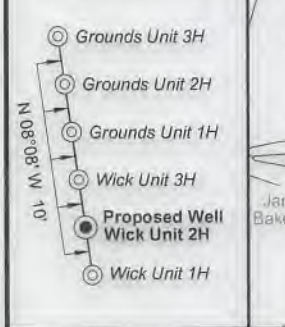

I, the undersigned, hereby certify that this plat is correct to the best of my knowledge and belief and shows all the information required by law and the rules issued and prescribed by the Department of Environmental Protection.

Bradley D. Miller
Bradley D. Miller, P.S. 2167



Notes:
West Virginia Coordinate System of 1927, North Zone based upon Differential GPS Measurements.
Well No. Wick Unit 2H Top Hole coordinates are N: 338,028.92' Latitude: 39°25'06.60" E: 1,578,960.25' Longitude: 80°59'25.38"
Bottom Hole coordinates are N: 327,642.11' Latitude: 39°23'24.43" E: 1,581,915.79' Longitude: 80°58'45.54"
UTM Zone 17, NAD 1983
Top Hole Coordinates Bottom Hole Coordinates
N: 4,363,228.273m N: 4,360,078.962m
E: 500,842.352m E: 501,795.599m
Plat orientation and corner and well references are based upon the grid north meridian.
Well location references are based upon the magnetic meridian.

Notes:
Well No. Wick Unit 2H UTM Zone 17, NAD 1927
Top Hole Coordinates
N: 14,314,311.39' E: 1,643,132.75'
Point of Entry Coordinates
N: 14,313,990.14' E: 1,642,660.66'
Bottom Hole Coordinates
N: 14,303,978.97' E: 1,646,260.20'



Legend

- Proposed gas well
- Monument, as noted
- Existing Well, as noted
- Creek or Drain
- Surface boundary (approx.)
- Interior surface tracts (approx.)

Lease

A	Vickie Gorrell, et al
B	Roy & Leona M. Ankrom
C	Gaston Family Investments, LLC
D	Patricia G. Mason
E	F & R Farms
F	Mark Layne & Lori Helmick
G	Ann W. Clutter
H	J. Bradford Wells
J	Kevin Andrew Yeater
K	Ross A. & Allana D. Paden
L	James Dean Ankrom

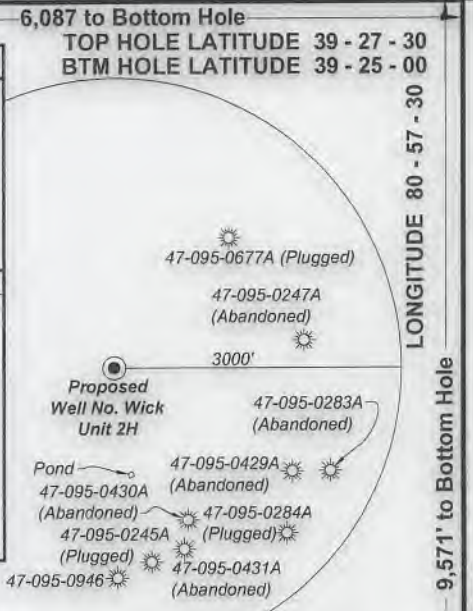

Note: It appears 0 water wells and a pond were found within 2000' of proposed well. No occupied dwellings and no buildings 2,500 square feet or larger used to house or shelter dairy cattle or poultry husbandry are located within 625' of the center of the well pad.

	Bearing	Dist.
L1	N 80°57' E	547.2'
L2	S 31°03' E	2,194.7'
L3	N 43°55' W	2,525.9'
L4	N 00°26' E	2,281.9'
L5	S 56°43' W	571.2'

ID	TM/Par	Owner	Bk/Pg	Acres
41	10/20	Jackson, et al	348/697	56.88
40	11/30	Shea, et ux	356/33	60.00
39	11/31	Shea Jr., et al	481/185	11.07
38	11/32.1	Shea Jr., et al	481/185	2.22
37	11/32	Hall, et ux	338/287	153.11
36	11/28	Kasper	309/500	8.21
35	11/28.1	Hendrickson Jr., et ux	261/272	1.00
34	11/29	Hendrickson Jr., et ux	261/272	10.00
33	10/14	Hendrickson Jr., et ux	261/272	38.50
32	10/15	F&R Farm, LLC	343/331	47.17
31	10/16	Jackson, et al	355/311	71.18
30	10/9	McGowan, et al	348/320	61.51
29	10/10	Helmick, et ux	262/135	42.81
28	11/2	Grim, et al	333/675	35.00
27	11/36	Mossor	230/255	0.94
26	11/38	Reed, et ux	343/196	1.063
25	11/37	Hendrickson Jr., et ux	255/100	0.343
24	10/13	Hendrickson Jr., et ux	234/71	2.13
23	11/1	Shields	493/423	1.76
22	11/1.1	Shields	324/287	0.23
21	11/3	Shields	324/287	1.84
20	11/4.1	Forrester, et al	275/76	1.82
19	11/4	Forrester	285/111	7.37
18	10/12	Serafine, et ux	352/624	32.00
17	8/46	Snider, et ux	376/614	49.03
16	8/42	Brisendine	353/369	49.03
15	10/11	Tartal, et al	342/109	80.32
14	7/25	Ankrom	380/447	0.43
13	7/20.1	Ankrom	303/61	0.75
12	7/26.1	Glover, et ux	347/492	4.36
11	7/26	Freeland, et ux	348/231	5.64
10	7/20	Ankrom	357/397	62.25
9	7/15.1	Paden, et al	369/11	7.76
8	7/24	Grimes, et ux	335/304	50.00
7	7/13	Smith, et ux	328/867	6.00
6	7/14	Smith	121/11	50.00
5	7/9	Smith	263/615	66.85
4	7/5	Coastal Forest Resources Co.	301/131	74.30
3	7/10	Fritzsimmons, et al	336/764	161.63
2	7/16	Seven Spirits Farms, LLC	381/67	175.11
1	7/15	Gorrell	321/360	242.50

FILE NO: 53-54-M-17
DRAWING NO: Wick 2H Well Plat
SCALE: 1" = 2000'
MINIMUM DEGREE OF ACCURACY: Submeter
PROVEN SOURCE OF ELEVATION: WVDOT, Harrisville, WV

STATE OF WEST VIRGINIA
DEPARTMENT OF ENVIRONMENTAL PROTECTION
OIL AND GAS DIVISION

DATE: January 10 20 19
OPERATOR'S WELL NO. Wick Unit 2H
API WELL NO
47 - 095 - 02514
STATE COUNTY PERMIT

WELL TYPE: OIL GAS LIQUID INJECTION WASTE DISPOSAL
(IF GAS) PRODUCTION: STORAGE DEEP SHALLOW
Proposed Elev. 1045'
LOCATION: ELEVATION: Existing Elev. 1066' WATERSHED: Outlet Middle Island Creek QUADRANGLE: Middlebourne
DISTRICT: Meade COUNTY: Tyler
SURFACE OWNER: Elizabeth Gorrell F & R Farms; Roy & Leona M. Ankrom; Gaston Family Investments, LLC; ACREAGE: 242.5 234.74; 74.3; 63.50; 80; 47.16875;
ROYALTY OWNER: Wilma Jane Benefield; Elizabeth Gorrell, et al; Janet Sue Baker; LEASE NO: ACREAGE:
PROPOSED WORK: DRILL CONVERT DRILL DEEPER FRACTURE OR STIMULATE PLUG OFF OLD FORMATION
 PERFORATE NEW FORMATION OTHER PHYSICAL CHANGE IN WELL (SPECIFY)
 PLUG AND ABANDON CLEAN OUT AND REPLUG TARGET FORMATION: Marcellus Shale ESTIMATED DEPTH: 6,700' TVD 18,400' MD

WELL OPERATOR: Antero Resources Corporation DESIGNATED AGENT: Dianna Stamper - CT Corporation System
ADDRESS: 1615 Wynkoop Street ADDRESS: 5400 D Big Tyler Road
Denver, CO 80202 Charleston, WV 25313

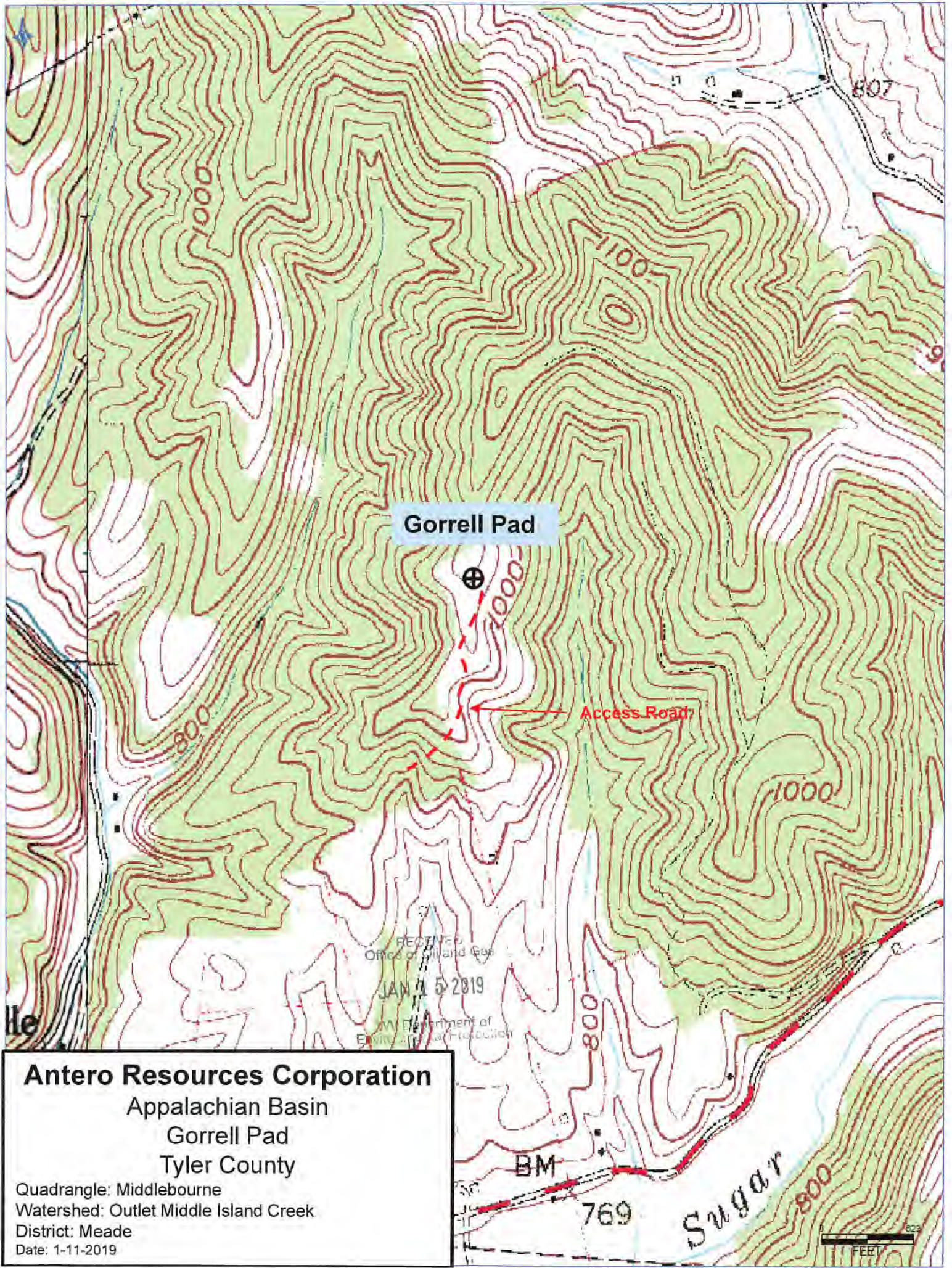

Gorrell Pad

Access Road

RECEIVED
Office of Oil and Gas
JAN 15 2019
WV Department of
Environmental Protection

Antero Resources Corporation
Appalachian Basin
Gorrell Pad
Tyler County

Quadrangle: Middlebourne
Watershed: Outlet Middle Island Creek
District: Meade
Date: 1-11-2019

BM

769

Sugar

0 200
FEET