

	Bearing	Dist.
L1	S 56°16' W	2,974.1'
L2	N 78°03' W	3,441.8'
L3	N 59°24' E	2,688.0'
L4	N 66°59' E	3,854.5'
L5	N 16°38' E	1,234.0'

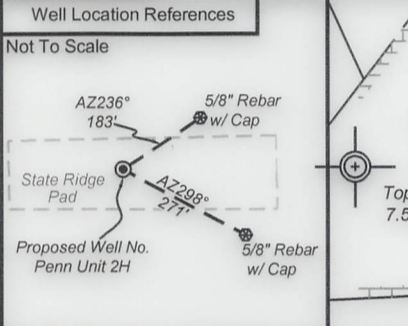

ID	TM/Par	Owner	Bk/Pg	Acres
1	10/62	Haessley Land & Timber, LLC	334/833	268.91
2	15/1	Martin L. Blair Jr. & Ronald K. Blair Sr.	WB18/361	47.00
3	15/37	John D. Mendenhall & Jeffrey A. Davis	444/531	154.17
4	15/3	John W. Eddy Estate	77/319	40.33
5	15/16	Robert M. Feldmeier	330/109	52.37
6	15/18	John W. Eddy Estate	398/670	26.18
7	15/17	David Mendenhall, et al	288/662	85.71
8	15/22	Donald Jr. & Marlene A. MacNaughtan	366/289	99.56
9	15/23	David Mendenhall, et al	326/13	97.25
10	15/15	David Mendenhall, et al	289/4	50.00
11	15/25	Charles Loy Jr., et al	358/610	20.00
12	15/24	Charles & Wilda Lee Fruner	300/342	97.50
13	21/2	Donald K. Baker	WB36/545	130.45
14	21/3	Douglas O. & Monna K. Cooper	287/390	60.46
15	21/5	Michael & Bente H. Biddle	294/537	223.77
16	15/34	Michael & Bente H. Biddle	294/537	82.34
17	21/6	Carl E. & Elsie M. Taylor	391/181	63.50
18	21/18	Ridgetop Capital II, LP	385/781	83.68
19	21/19	Ridgetop Capital II, LP	385/781	20.00
20	21/5.2	Alfred B. & Elizabeth J. Briddle	319/408	6.582
21	21/5.1	Alfred B. & Elizabeth J. Briddle	319/408	1.062
22	21/4	Martha E. & Timothy Ruble	274/236	1.036
23	21/20	Charles O. Conaway	WB17/354	95.50
24	21/44	Tyler County Home	77/672	189.36

Note: 0 water wells or springs were found within 2000' of proposed well. No occupied dwellings or buildings 2,500 square feet or larger used to house or shelter dairy cattle or poultry husbandry are located within 625' of the center of the well pad.

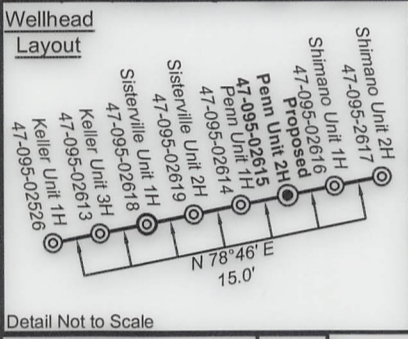
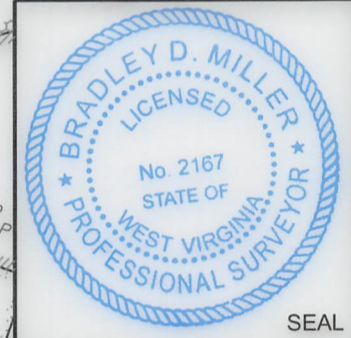

I, the undersigned, hereby certify that this plat is correct to the best of my knowledge and belief and shows all the information required by law and the rules issued and prescribed by the Department of Environmental Protection.

Bradley D. Miller
Bradley D. Miller, P.S. 2167

FILE NO: 05-54-E-16
DRAWING NO: Penn 2H Well Plat
SCALE: 1" = 1500'
MINIMUM DEGREE OF ACCURACY: Submeter
PROVEN SOURCE OF ELEVATION: WVDOT, Harrisville, WV

STATE OF WEST VIRGINIA
DEPARTMENT OF ENVIRONMENTAL PROTECTION
OIL AND GAS DIVISION

DATE: January 8 2020
OPERATOR'S WELL NO. Penn Unit 2H
API WELL NO
47 - 095 - 02615
STATE COUNTY PERMIT

WELL TYPE: OIL GAS LIQUID INJECTION WASTE DISPOSAL
(IF GAS) PRODUCTION: STORAGE DEEP SHALLOW
LOCATION: ELEVATION: Proposed 1,064' Existing 1,090' WATERSHED: Outlet Middle Island Creek QUADRANGLE: Paden City/Porter Falls
DISTRICT: Ellsworth COUNTY: Tyler
SURFACE OWNER: John D. Mendenhall & Jeffrey A. Davis; Agnes C. Smith; Cliff & Virginia Perkins Irrevocable Trust; ACREAGE: 154.17 154.17; 97.25; 20; 97.5; 63.5; 231.42344
ROYALTY OWNER: Dianne T. Carpenter; Gina Pastors; Piney Holdings Inc.; Carl E. Taylor, et ux; LEASE NO: ACREAGE:
PROPOSED WORK: DRILL CONVERT DRILL DEEPER FRACTURE OR STIMULATE PLUG OFF OLD FORMATION
 PERFORATE NEW FORMATION OTHER PHYSICAL CHANGE IN WELL (SPECIFY) BHL MOD
 PLUG AND ABANDON CLEAN OUT AND REPLUG TARGET FORMATION: Marcellus Shale ESTIMATED DEPTH: 17,800' MD 7,000' TVD

WELL OPERATOR: Antero Resources Corporation DESIGNATED AGENT: Dianna Stamper - CT Corporation System
ADDRESS: 1615 Wynkoop Street ADDRESS: 5400 D Big Tyler Road
Denver, CO 80202 Charleston, WV 25313