

**Antero Resources**  
Well No. Shimano Unit 2H  
As-Drilled  
Antero Resources Corporation

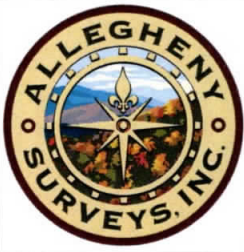

**Legend**

- Proposed gas well
- ⊙ Found corner, as noted
- ⊙ Existing Well, as noted
- ⊙ Digitized Well
- Creek or Drain
- Existing Road
- Surface boundary (approx.)
- Interior surface tracts (approx.)

**Wellhead Layout**

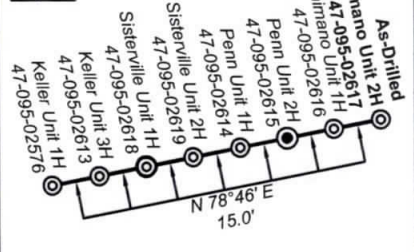

Detail Not to Scale

Top Hole Coordinates, As-drilled data, and information was provided by Antero Resources Corporation. Allegheny Surveys Inc. (ASI) is not certifying the data and information provided. ASI is not responsible for any errors or inaccuracies with the data and information that has been provided.

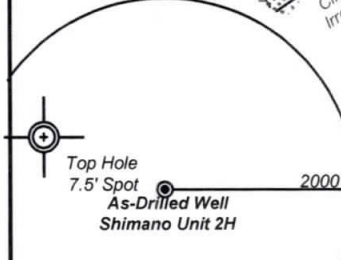

ID	TM/Par	Owner	Bk/Pg	Acres
1	10/62	Haessley Land & Timber, LLC	334/833	268.91
2	15/1	Martin L. Blair Jr. & Ronald K. Blair Sr.	WB18/361	47.00
3	15/2	John W. Eddy Estate	71/13	49.00
4	15/14	John W. & Leah D. Starkey	345/93	50.75
5	15/3	John W. Eddy Estate	77/319	40.33
6	15/37	John D. Mendenhall & Jeffrey A. Davis	444/531	154.17
7	15/17	David Mendenhall, et al	288/662	85.71
8	15/16	Robert M. Feldmeier	330/109	52.37
9	15/15	David Mendenhall, et al	289/4	50.00
10	15/23	David Mendenhall, et al	326/13	97.25
11	15/25	Charles Loy Jr., et al	358/610	20.00
12	15/27	Ronald & Martha J. Greathouse	217/571	26.00
13	15/30	Thomas C. & Jauudean L. Grinage	458/73	124.08
14	15/24	Charles & Wilda Lee Fruner	300/342	97.50
15	21/5	Michael & Bente H. Biddle	294/537	223.77
16	15/34	Michael & Bente H. Biddle	294/537	82.34
17	15/34.1	Randy & Pamela L. Lancaster	370/776	11.417
18	15/33	Roger D. Blizard & Ruth E. Spencer	340/170	102.62
19	21/6	Carl E. & Elsie M. Taylor	391/181	63.50
20	21/3	Douglas O. & Monna K. Cooper	287/390	60.46
21	21/5.2	Alfred B. & Elizabeth J. Bridle	319/408	6.582
22	21/19	Ridgetop Capital II, LP	385/781	20.00
23	21/18	Ridgetop Capital II, LP	385/781	83.68
24	21/17	Stephanie & Joseph W. Havranek	254/153	10.38
25	21/16	Stephanie & Joseph W. Havranek	254/153	4.50
26	21/14	Carl E. & Elsie M. Taylor	391/181	67.91
27	21/15	Stephanie & Joseph W. Havranek	254/153	45.48

Note: 0 water wells or springs were found within 2000' of proposed well. No occupied dwellings or buildings 2,500 square feet or larger used to house or shelter dairy cattle or poultry husbandry are located within 625' of the center of the well pad.

**I, the undersigned, hereby certify that this plat is correct to the best of my knowledge and belief and shows all the information required by law and the rules issued and prescribed by the Department of Environmental Protection.**

*Bradley D. Miller*  
**Bradley D. Miller, P.S. 2167**

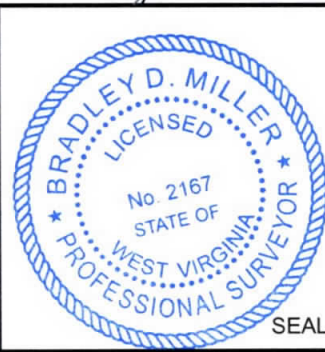

FILE NO: 38-54-E-16  
DRAWING NO: Shimano 2H Well Plat  
SCALE: 1" = 1500'  
MINIMUM DEGREE OF ACCURACY: Submeter  
PROVEN SOURCE OF ELEVATION: WVDOT, Harrisville, WV

**STATE OF WEST VIRGINIA**  
DEPARTMENT OF ENVIRONMENTAL PROTECTION  
**OIL AND GAS DIVISION**

DATE: July 28 2020  
OPERATOR'S WELL NO. Shimano Unit 2H  
API WELL NO  
47 - 095 - 02617  
STATE COUNTY PERMIT

WELL TYPE:  OIL  GAS  LIQUID INJECTION  WASTE DISPOSAL  
(IF GAS) PRODUCTION:  STORAGE  DEEP  SHALLOW  
LOCATION: ELEVATION: As-Built 1,064' WATERSHED: Outlet Middle Island Creek QUADRANGLE: Shirley/Porter Falls  
DISTRICT: Ellsworth COUNTY: Tyler  
SURFACE OWNER: John D. Mendenhall & Jeffrey A. Davis Cliff & Virginia Perkins Irrevocable Trust (2); Karen F. Quinn; B. Fred Hill, Jr.; Carl E. Taylor, et ux; ACREAGE: 154.17 154.17; 40.33; 93.757; 52; 130;  
ROYALTY OWNER: Dianne T. Carpenter; Herbert Stephenson Boreman Jr.; Michael A. Eddy LEASE NO: ACREAGE: 231.42344; 63.5  
PROPOSED WORK:  DRILL  CONVERT  DRILL DEEPER  FRACTURE OR STIMULATE  PLUG OFF OLD FORMATION  
 PERFORATE NEW FORMATION  OTHER PHYSICAL CHANGE IN WELL (SPECIFY) As-Drilled 6,545' TVD  
 PLUG AND ABANDON  CLEAN OUT AND REPLUG TARGET FORMATION: Marcellus Shale ESTIMATED DEPTH: 15,440' MD

WELL OPERATOR: Antero Resources Corporation DESIGNATED AGENT: Dianna Stamper - CT Corporation System  
ADDRESS: 1615 Wynkoop Street ADDRESS: 5400 D Big Tyler Road  
Denver, CO 80202 Charleston, WV 25313

