

3,058' to Bottom Hole

3,323' to Top Hole

LATITUDE 39 - 32 - 30.3

LONGITUDE 80 - 52 - 52.3

8,444' to Bottom Hole

11,573' to Top Hole

### Antero Resources Well No. Maggie Unit 2H

Antero Resources Corporation



Notes:  
Well No. Maggie Unit 2H  
UTM Zone 17, NAD 1927

Top Hole Coordinates  
N: 14,347,558.19'  
E: 1,672,528.79'

Point of Entry Coordinates  
N: 14,348,048.38'  
E: 1,673,645.87'

Bottom Hole Coordinates  
N: 14,350,690.17'  
E: 1,672,740.80'

Notes:  
West Virginia Coordinate System of 1927, North Zone  
based upon Differential GPS Measurements.

Well No. Maggie Unit 2H Top Hole coordinates are  
N: 370,791.64' Latitude: 39°30'35.13"  
E: 1,608,917.53' Longitude: 80°53'10.13"

Bottom Hole coordinates are  
N: 373,920.71' Latitude: 39°31'06.09"  
E: 1,609,181.88' Longitude: 80°53'07.37"

UTM Zone 17, NAD 1983

Top Hole Coordinates Bottom Hole Coordinates  
N: 4,373,362.185m N: 4,374,316.824m  
E: 509,802.285m E: 509,866.935m

Plat orientation and corner and well references  
are based upon the grid north meridian.

Well location references are based upon the magnetic  
meridian.

	Bearing	Dist.
L1	N 01°55' W	1,471.3'
L2	N 57°58' E	2,802.9'
L3	S 63°32' E	2,084.3'
L4	S 30°32' E	1,068.1'
L5	N 67°16' E	1,220.3'

Maggie Unit 2H  
Bottom Hole

#### Wellhead Layout (NTS)

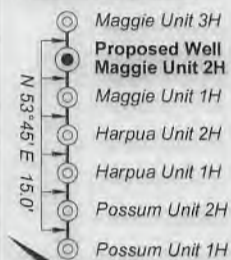

#### Well Location References

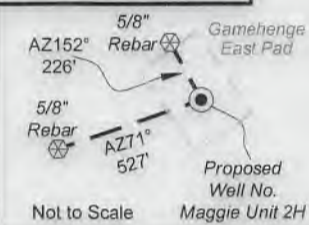

Note: 1 water well and 2 springs were found within 2000' of proposed well. No occupied dwellings or buildings 2,500 square feet or larger used to house or shelter dairy cattle or poultry husbandry are located within 625' of the center of the well pad.

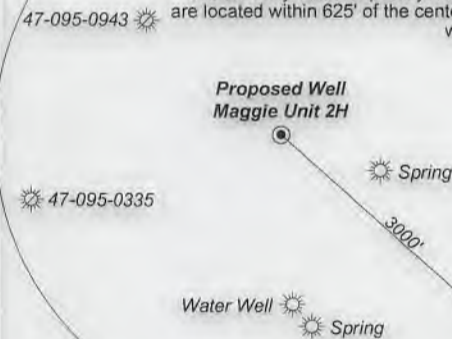

Legend	
	Proposed gas well
	Existing Well, as noted
	Found corner, as noted
	Digitized Well
	Creek or Drain
	Existing Road
	Surface boundary (approx.)
	Interior surface tracts (approx.)



I, the undersigned, hereby certify that this plat is correct to the best of my knowledge and belief and shows all the information required by law and the rules issued and prescribed by the Department of Environmental Protection.

*Bradley D. Miller*  
Bradley D. Miller, P.S. 2167

FILE NO: 283-54-E-17  
DRAWING NO: Maggie 2H Well Plat  
SCALE: 1" = 1000'  
MINIMUM DEGREE OF ACCURACY:  
Submeter  
PROVEN SOURCE OF ELEVATION:  
WVDOT, Harrisville, WV

## STATE OF WEST VIRGINIA DEPARTMENT OF ENVIRONMENTAL PROTECTION OIL AND GAS DIVISION

DATE: June 24 2019  
OPERATOR'S WELL NO. Maggie Unit 2H  
API WELL NO. ~~464~~  
47 - 095 - 02638  
STATE COUNTY PERMIT

WELL TYPE:  OIL  GAS  LIQUID INJECTION  WASTE DISPOSAL  
(IF GAS) PRODUCTION:  STORAGE  DEEP  SHALLOW

LOCATION: ELEVATION: Proposed 1061' Existing 1072' WATERSHED: Outlet Middle Island Creek QUADRANGLE: Paden City  
DISTRICT: Ellsworth COUNTY: Tyler  
SURFACE OWNER: Barbara Kay Turner ACREAGE: 26.18  
ROYALTY OWNER: Dianne T. Carpenter; Jack Russell Folger, et ux; Linda L. Newbrough; Darla S. Colombo; LEASE NO: ACREAGE: 85.71; 62.84375; 154.17; 45; 113.725;

PROPOSED WORK:  DRILL  CONVERT  DRILL DEEPER  FRACTURE OR STIMULATE  PLUG OFF OLD FORMATION  
 PERFORATE NEW FORMATION  OTHER PHYSICAL CHANGE IN WELL (SPECIFY) \_\_\_\_\_ 7,000' TVD  
 PLUG AND ABANDON  CLEAN OUT AND REPLUG TARGET FORMATION: Marcellus Shale ESTIMATED DEPTH: 11,500' MD

WELL OPERATOR: Antero Resources Corporation DESIGNATED AGENT: Dianna Stamper - CT Corporation System  
ADDRESS: 1615 Wynkoop Street ADDRESS: 5400 D Big Tyler Road  
Denver, CO 80202 Charleston, WV 25313



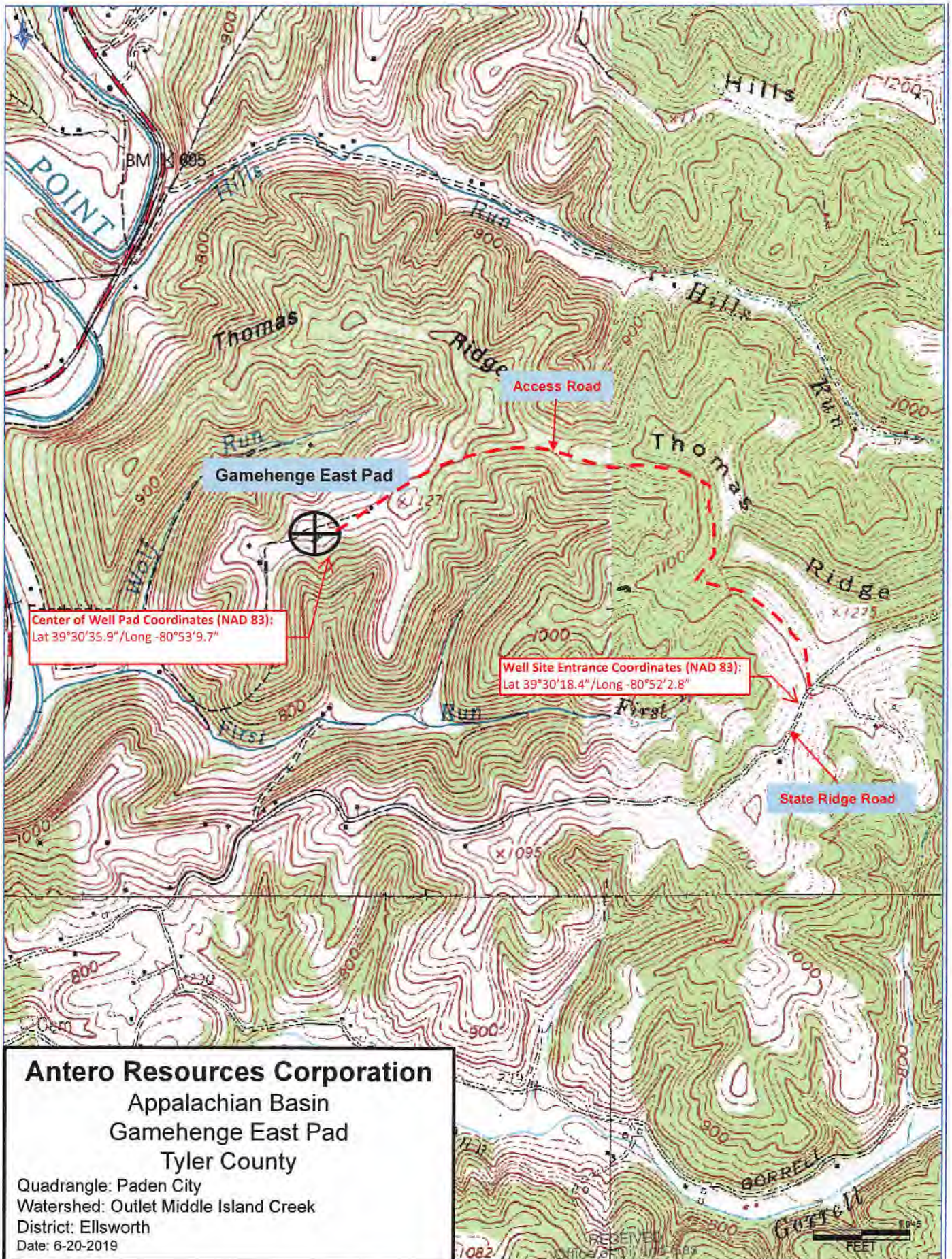

**Antero Resources Corporation**  
 Appalachian Basin  
 Gamehenge East Pad  
 Tyler County

Quadrangle: Paden City  
 Watershed: Outlet Middle Island Creek  
 District: Ellsworth  
 Date: 6-20-2019

JUL 11 2019