

**Antero Resources**  
**Well No. Maggie Unit 2H**  
 BHL MOD  
 Antero Resources Corporation



Page 1 of 3

TOP HOLE LAT 39 - 32 - 30  
 BTM HOLE LAT 39 - 35 - 00

**Legend**

- Proposed gas well
- Existing Well, as noted
- Found corner, as noted
- Digitized Well
- Creek or Drain
- Existing Road
- Surface boundary (approx.)
- Interior surface tracts (approx.)

**Notes:**  
 Well No. Maggie Unit 2H  
 UTM Zone 17, NAD 1927

**Top Hole Coordinates**  
 N: 14,347,558.19'  
 E: 1,672,528.79'

**Point of Entry Coordinates**  
 N: 14,348,048.38'  
 E: 1,673,645.87'

**Bottom Hole Coordinates**  
 N: 14,362,990.19'  
 E: 1,668,526.82'

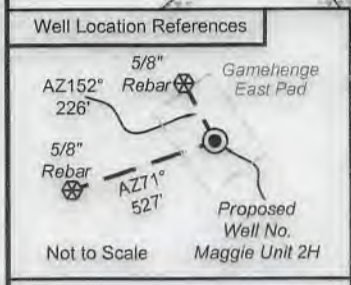

I, the undersigned, hereby certify that this plat is correct to the best of my knowledge and belief and shows all the information required by law and the rules issued and prescribed by the Department of Environmental Protection.

*Bradley D. Miller*  
 Bradley D. Miller, P.S. 2167

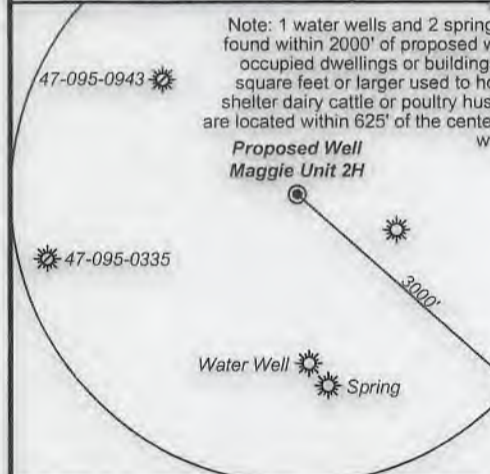

**Notes:**  
 West Virginia Coordinate System of 1927, North Zone based upon Differential GPS Measurements.  
 Well No. Maggie Unit 2H Top Hole coordinates are  
 N: 370,791.64' Latitude: 39°30'35.13"  
 E: 1,608,917.53' Longitude: 80°53'10.13"  
 Bottom Hole coordinates are  
 N: 386,293.58' Latitude: 39°33'07.75"  
 E: 1,605,172.46' Longitude: 80°54'00.99"  
 UTM Zone 17, NAD 1983

**Top Hole Coordinates**    **Bottom Hole Coordinates**  
 N: 4,373,362.185m    N: 4,378,065.878m  
 E: 509,802.285m    E: 508,582.629m

Plat orientation and corner and well references are based upon the grid north meridian.  
 Well location references are based upon the magnetic meridian.

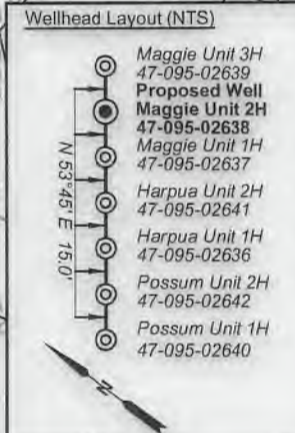

	Bearing	Dist.
L1	N 01°55' W	1,471.3'
L2	N 57°58' E	2,802.9'
L3	S 63°32' E	2,084.3'
L4	S 30°32' E	1,068.1'
L5	N 67°16' E	1,220.3'

FILE NO: 283-54-E-17  
 DRAWING NO: Maggie 2H Well Plat  
 SCALE: 1" = 2000'  
 MINIMUM DEGREE OF ACCURACY:  
 Submeter  
 PROVEN SOURCE OF ELEVATION:  
 WVDOT, Harrisville, WV

**STATE OF WEST VIRGINIA**  
 DEPARTMENT OF ENVIRONMENTAL PROTECTION  
**OIL AND GAS DIVISION**

DATE: November 7 2019  
 OPERATOR'S WELL NO. Maggie Unit 2H  
 API WELL NO *mod*  
 47 - 095 - 02638  
 STATE COUNTY PERMIT

WELL TYPE:  OIL  GAS  LIQUID INJECTION  WASTE DISPOSAL  
 (IF GAS) PRODUCTION:  STORAGE  DEEP  SHALLOW  
 LOCATION: ELEVATION: Proposed 1061' Existing 1072' WATERSHED: Outlet Middle Island Creek QUADRANGLE: Paden City 62,84375; 45; 154.17; 85.71; 113.725; 195.47; 46.13; 19; 13.3;  
 DISTRICT: Ellsworth / Lincoln COUNTY: Tyler 81.3; 17.4; 48.78; 76.998; 22.67; 60;  
 SURFACE OWNER: Barbara Kay Turner ACREAGE: 26.18 285.00625; 64  
 ROYALTY OWNER: Linda L. Newbrough; Jack Russell Folger, et ux; Dianne T. Carpenter; Darla S. Colombo; LEASE NO: \_\_\_\_\_  
 PROPOSED WORK:  DRILL  CONVERT  DRILL DEEPER  FRACTURE OR STIMULATE  PLUG OFF OLD FORMATION  
 PERFORATE NEW FORMATION  OTHER PHYSICAL CHANGE IN WELL (SPECIFY) BHL MOD 7,000' TVD  
 PLUG AND ABANDON  CLEAN OUT AND REPLUG TARGET FORMATION: Marcellus Shale ESTIMATED DEPTH: 24,500' MD

WELL OPERATOR: Antero Resources Corporation DESIGNATED AGENT: Dianna Stamper - CT Corporation System  
 ADDRESS: 1615 Wynkoop Street ADDRESS: 5400 D Big Tyler Road  
 Denver, CO 80202 Charleston, WV 25313



FILE NO: 283-54-E-17  
 DRAWING NO: Maggie 2H Well Plat  
 SCALE: 1" = 2000'  
 MINIMUM DEGREE OF ACCURACY:  
 Submeter  
 PROVEN SOURCE OF ELEVATION:  
 WVDOT, Harrisville, WV

**STATE OF WEST VIRGINIA**  
 DEPARTMENT OF ENVIRONMENTAL PROTECTION  
**OIL AND GAS DIVISION**

DATE: November 7 2019  
 OPERATOR'S WELL NO. Maggie Unit 2H  
 API WELL NO  
 47 - 095 - 02638  
 STATE COUNTY PERMIT

WELL TYPE:  OIL  GAS  LIQUID INJECTION  WASTE DISPOSAL  
 (IF GAS) PRODUCTION:  STORAGE  DEEP  SHALLOW  
 LOCATION: ELEVATION: Proposed 1061' Existing 1072' WATERSHED: Outlet Middle Island Creek QUADRANGLE: Paden City 62.84375; 45; 154.17; 85.71;  
 DISTRICT: Ellsworth / Lincoln COUNTY: Tyler 113.725; 195.47;  
 SURFACE OWNER: Barbara Kay Turner ACREAGE: 26.18 46.13; 19; 13.3;  
 ROYALTY OWNER: Linda L. Newbrough; Jack Russell Folger, et ux; Dianne T. Carpenter; Darla S. Colombo; LEASE NO: ACREAGE: 285.00625; 64 81.3; 17.4; 48.78;  
 PROPOSED WORK:  DRILL  CONVERT  DRILL DEEPER  FRACTURE OR STIMULATE  PLUG OFF OLD FORMATION 76.998; 22.67; 60;  
 PERFORATE NEW FORMATION  OTHER PHYSICAL CHANGE IN WELL (SPECIFY) BHL MOD ESTIMATED DEPTH: 24.500' MD 285.00625; 64  
 PLUG AND ABANDON  CLEAN OUT AND REPLUG TARGET FORMATION: Marcellus Shale ESTIMATED DEPTH: 24.500' MD 7,000' TVD

WELL OPERATOR: Antero Resources Corporation DESIGNATED AGENT: Dianna Stamper - CT Corporation System  
 ADDRESS: 1615 Wynkoop Street ADDRESS: 5400 D Big Tyler Road  
 Denver, CO 80202 Charleston, WV 25313

