

2,083' to Bottom Hole

3,311' to Top Hole

LATITUDE 39 - 32 - 30

LONGITUDE 80 - 52 - 30

8,821' to Bottom Hole

11,564' to Top Hole

Antero Resources
Well No. Maggie Unit 3H



Notes:
Well No. Maggie Unit 3H
UTM Zone 17, NAD 1927
Top Hole Coordinates
N: 14,347,567.26'
E: 1,672,540.74'
Point of Entry Coordinates
N: 14,348,288.84'
E: 1,674,421.93'
Bottom Hole Coordinates
N: 14,350,328.84'
E: 1,673,722.07'

Notes:
West Virginia Coordinate System of 1927, North Zone based upon Differential GPS Measurements.
Well No. Maggie Unit 3H Top Hole coordinates are
N: 370,800.51' Latitude: 39°30'35.22"
E: 1,608,929.63' Longitude: 80°53'09.98"
Bottom Hole coordinates are
N: 373,542.92' Latitude: 39°31'02.50"
E: 1,610,157.32' Longitude: 80°52'54.85"
UTM Zone 17, NAD 1983
Top Hole Coordinates Bottom Hole Coordinates
N: 4,373,364.949m N: 4,374,206.697m
E: 509,805.926m E: 510,166.024m
Plat orientation and corner and well references are based upon the grid north meridian.
Well location references are based upon the magnetic meridian.

	Bearing	Dist.
L1	N 01°26' W	1,479.8'
L2	N 57°57' E	2,817.9'
L3	S 63°54' E	2,091.2'
L4	S 31°20' E	1,066.7'
L5	N 72°40' E	2,011.1'

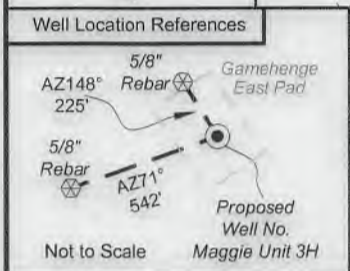
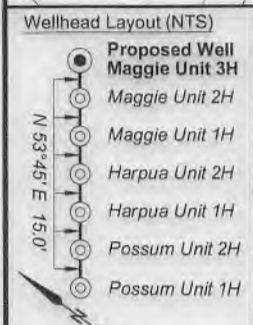

- Legend**
- Proposed gas well
 - Existing Well, as noted
 - Found corner, as noted
 - Digitized Well
 - Creek or Drain
 - Existing Road
 - Surface boundary (approx.)
 - Interior surface tracts (approx.)

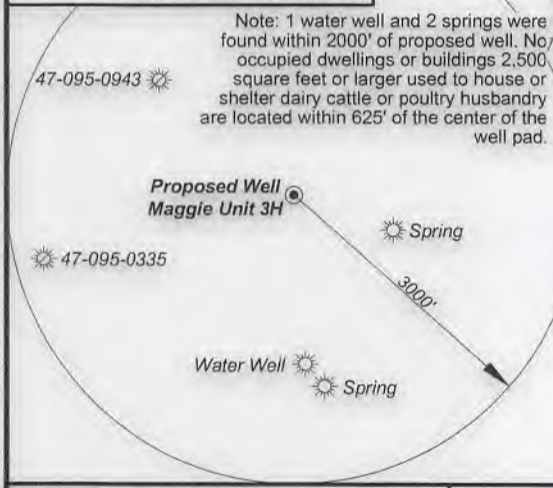

FILE NO: 283-54-E-17
DRAWING NO: Maggie 3H Well Plat
SCALE: 1" = 1000'
MINIMUM DEGREE OF ACCURACY: Submeter
PROVEN SOURCE OF ELEVATION: WVDOT, Harrisville, WV

STATE OF WEST VIRGINIA
DEPARTMENT OF ENVIRONMENTAL PROTECTION
OIL AND GAS DIVISION

DATE: June 24 2019
OPERATOR'S WELL NO. Maggie Unit 3H
API WELL NO. 47-095-02639
STATE COUNTY PERMIT

WELL TYPE: OIL GAS LIQUID INJECTION WASTE DISPOSAL
(IF GAS) PRODUCTION: STORAGE DEEP SHALLOW
LOCATION: ELEVATION: Proposed 1061' Existing 1072' WATERSHED: Outlet Middle Island Creek QUADRANGLE: Paden City
DISTRICT: Ellsworth COUNTY: Tyler
SURFACE OWNER: Barbara Kay Turner ACREAGE: 26.18
ROYALTY OWNER: Jack Russell Folger, et ux; Darla S. Colombo; Linda L. Newbrough; Dianne T. Carpenter LEASE NO: ACREAGE: 62.84375; 45; 85.71; 154.17;
PROPOSED WORK: DRILL CONVERT DRILL DEEPER FRACTURE OR STIMULATE PLUG OFF OLD FORMATION
 PERFORATE NEW FORMATION OTHER PHYSICAL CHANGE IN WELL (SPECIFY) _____ 7,000' TVD
 PLUG AND ABANDON CLEAN OUT AND REPLUG TARGET FORMATION: Marcellus Shale ESTIMATED DEPTH: 11,700' MD

WELL OPERATOR: Antero Resources Corporation DESIGNATED AGENT: Dianna Stamper - CT Corporation System
ADDRESS: 1615 Wynkoop Street ADDRESS: 5400 D Big Tyler Road
Denver, CO 80202 Charleston, WV 25313



I, the undersigned, hereby certify that this plat is correct to the best of my knowledge and belief and shows all the information required by law and the rules issued and prescribed by the Department of Environmental Protection.

Bradley D. Miller
Bradley D. Miller, P.S. 2167

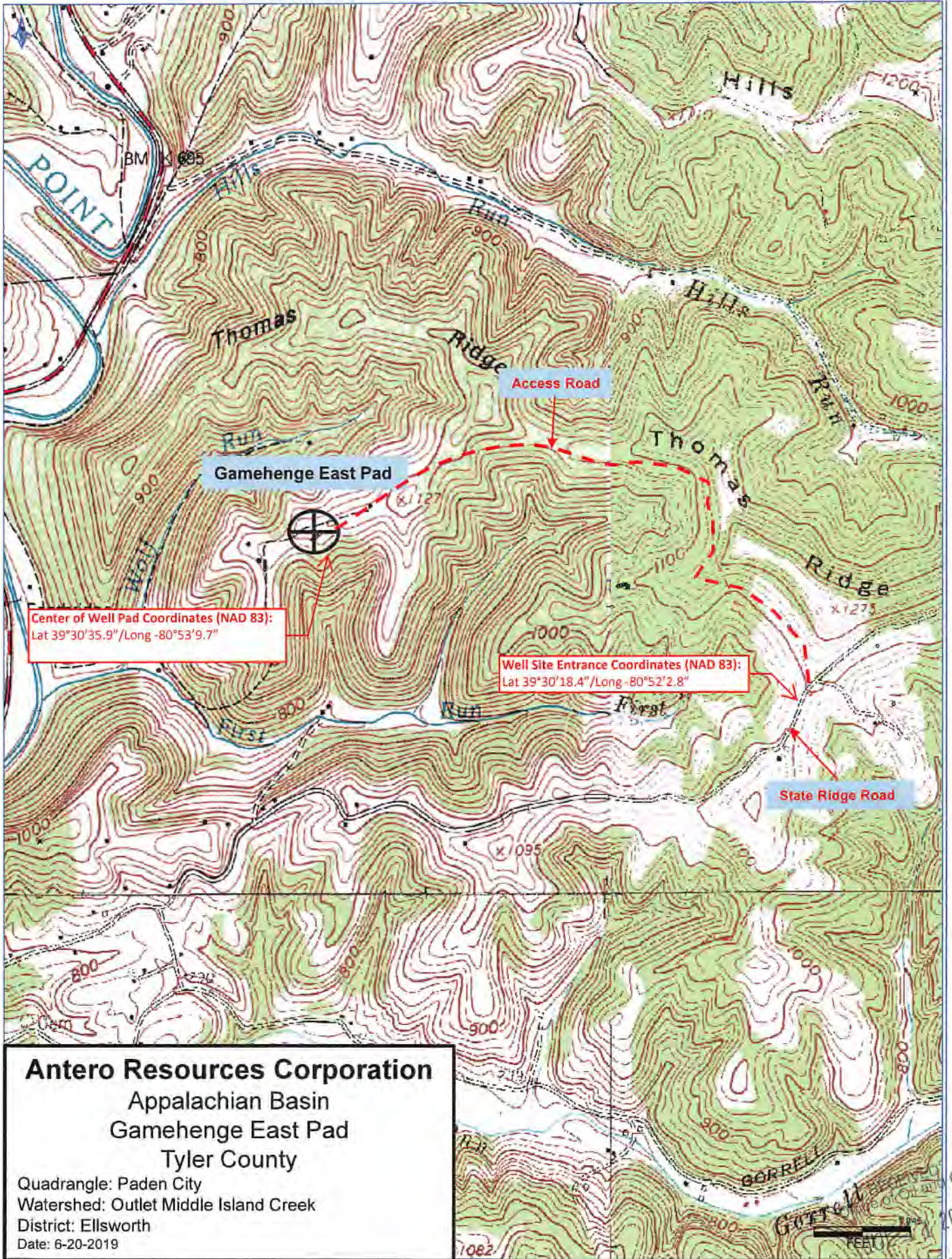

Antero Resources Corporation
 Appalachian Basin
 Gamehenge East Pad
 Tyler County

Quadrangle: Paden City
 Watershed: Outlet Middle Island Creek
 District: Ellsworth
 Date: 6-20-2019