

Antero Resources
Well No. Possum Unit 1H

Antero Resources Corporation



	Bearing	Dist.
L1	N 04°24' W	1,430.4'
L2	N 58°06' E	2,728.1'
L3	S 61°40' E	2,051.0'
L4	S 26°34' E	1,078.1'
L5	S 78°25' W	2,899.1'

Wellhead Layout (NTS)

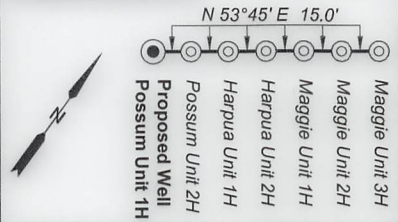

9,057' to Bottom Hole

3,383' to Top Hole

LATITUDE 39 - 32 - 30

ID	TM/Par	Owner	Bk/Pg	Acres
1	15-18	Barbara Kay Turner	398/670	26.18
2	15-19	David Mendenhall, et al	282/723	45.00
3	14-27	Ridgetop Capital LP	372/299	64.96
4	14-60.2	Douglas & Tricia Long	333/872	24.47
5	14-60	James A. Jr. & Angela K. Long	333/188	23.99
6	14-58	Linda Newbrough	WB 36/617	10.31
7	14-57	Danny Eugene Cochran	344/251	40.30
8	14-56.1	Boyd M. & Patricia L. Parr	358/643	35.33
9	14A-29	Victor A. & Lorraine Weekley	299/300	13.00
10	14A-29.1	Mensore J.C. Distributors	285/213	1.00
11	14-23	Jackie R. Brookover II	321/749	6.88
12	14-20.1	Jackie R. Brookover II	346/29	13.46
13	14-24	Ridgetop Capital LP	372/299	124.76
14	14-26	Barbara Kay Turner	398/670	26.34
15	114-25	Stanley M. & Irene E. Koterba, et al	331/32	126.05
16	14-18	Terry W. & Carolyn Sue Tracy	193/473	37.00
17	14-9	Robert L. Keller	299/379	116.90
18	14-8	Christine Connell, et al	---/--	37.00
19	14-25.2	Andrew B. & Angela M. Negie	489/577	3.00
20	14-25.1	Roy F. Gorrell	447/180	2.00
21	14-10	Sarah A. Midcap	342/568	40.00
22	14-9.1	John W. & Ida L. Murner	338/162	6.00
23	9-36.2	Ron & Charlene Vancamp	296/390	28.79
24	9-39	Tyler County Board of Education	290/88	65.00
25	9-40.1	Tyler County Board of Education	290/88	9.17
26	9-40	Sarah A. Midcap	168/3	16.83
27	9-31	Sarah A. Midcap	168/3	74.00
28	9-30	Heartwood Forestland Fund II LP	326/547	144.31
29	9-15	Heartwood Forestland Fund II LP	326/547	225.64
30	9-20	Heartwood Forestland Fund II LP	326/547	57.61
31	9-14	Leroy Kent Morris, et al	480/311	93.63

LONGITUDE 80 - 52 - 30

11,617' to Top Hole

3,438' to Bottom Hole

Notes:

West Virginia Coordinate System of 1927, North Zone based upon Differential GPS Measurements. Well No. Possum Unit 1H Top Hole coordinates are N: 370,747.29' Latitude: 39°30'34.68" E: 1,608,857.05' Longitude: 80°53'10.89" Bottom Hole coordinates are N: 378,926.27' Latitude: 39°31'54.64" E: 1,603,183.49' Longitude: 80°54'24.91" UTM Zone 17, NAD 1983 Top Hole Coordinates Bottom Hole Coordinates N: 4,373,348.366m N: 4,375,811.244m E: 509,784.085m E: 508,014.087m Plat orientation and corner and well references are based upon the grid north meridian. Well location references are based upon the magnetic meridian.

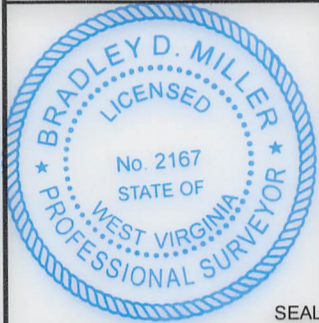

SEAL

I, the undersigned, hereby certify that this plat is correct to the best of my knowledge and belief and shows all the information required by law and the rules issued and prescribed by the Department of Environmental Protection.

Bradley D. Miller, P.S. 2167

Note: It appears 1 water well and 2 springs were found within 2000' of proposed well. No occupied dwellings or buildings 2,500 square feet or larger used to house or shelter dairy cattle or poultry husbandry are located within 625' of the center of the well pad.

47-095-0943

Proposed Well Possum Unit 1H

3000'

47-095-0335

Spring

Water Well Spring

Notes:
Well No. Possum Unit 1H UTM Zone 17, NAD 1927
Top Hole Coordinates
N: 14,347,512.86'
E: 1,672,469.08'
Point of Entry Coordinates
N: 14,346,883.30'
E: 1,669,640.13'
Bottom Hole Coordinates
N: 14,355,593.23'
E: 1,666,661.76'

Legend

- Proposed gas well
- Monument, as noted
- Existing Well, as noted
- Digitized Well, as noted
- Creek or Drain
- Surface boundary (approx.)
- Interior surface tracts (approx.)
- Open lease

Well Location References (NTS)

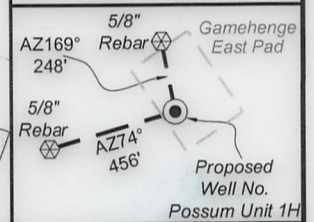

	Lessor
A	Linda L. Newbrough
B	Jack Russell Folger, et ux
C	Naomi V. Beagle
D	Douglas H. Long, et ux
E	James A. Long, Jr., et ux
F	Linda L. Newbrough
G	Nathaniel Hendricks
H	Scott Denomme, et ux
I	Scott Denomme, et ux
J	Stanley M. & Irene E. Koterba
K	Sarah A. Midcap
L	Sarah A. Midcap
M	David E. Bowyer
N	Waco Oil & Gas Co. Inc.
O	BRC Appalachian Minerals I, LLC
P	Marylin S. Parkinson
Q	Sandra L. Baumgardner

FILE NO: 39-54-E-16

DRAWING NO: Possum 1H Well Plat

SCALE: 1" = 2000'

MINIMUM DEGREE OF ACCURACY:
Submeter

PROVEN SOURCE OF ELEVATION:
WVDOT, Harrisville, WV

STATE OF WEST VIRGINIA
DEPARTMENT OF ENVIRONMENTAL PROTECTION
OIL AND GAS DIVISION

DATE: June 24 20 19

OPERATOR'S WELL NO. Possum Unit 1H

API WELL NO

47 - 095 - 02640
STATE COUNTY PERMIT

WELL TYPE: OIL GAS LIQUID INJECTION WASTE DISPOSAL
(IF GAS) PRODUCTION: STORAGE DEEP SHALLOW
Proposed 1061'

LOCATION: ELEVATION: Existing 1072' WATERSHED: Outlet Middle Island Creek QUADRANGLE: Paden City

DISTRICT: Elsworth

COUNTY: Tyler

SURFACE OWNER: Barbara Kay Turner Sarah A. Midcap (2); David E. Bowyer;

ACREAGE: 26.18

ROYALTY OWNER: Linda L. Newbrough; Naomi V. Beagle; Scott Denomme, et ux

LEASE NO: ACREAGE: 91.831; 74.169;

PROPOSED WORK: DRILL CONVERT DRILL DEEPER FRACTURE OR STIMULATE PLUG OFF OLD FORMATION
 PERFORATE NEW FORMATION OTHER PHYSICAL CHANGE IN WELL (SPECIFY)

PLUG AND ABANDON CLEAN OUT AND REPLUG TARGET FORMATION: Marcellus Shale ESTIMATED DEPTH: 7,000' TVD 19,600' MD

WELL OPERATOR: Antero Resources Corporation

DESIGNATED AGENT: Dianna Stamper - CT Corporation System

ADDRESS: 1615 Wynkoop Street
Denver, CO 80202

ADDRESS: 5400 D Big Tyler Road
Charleston, WV 25313

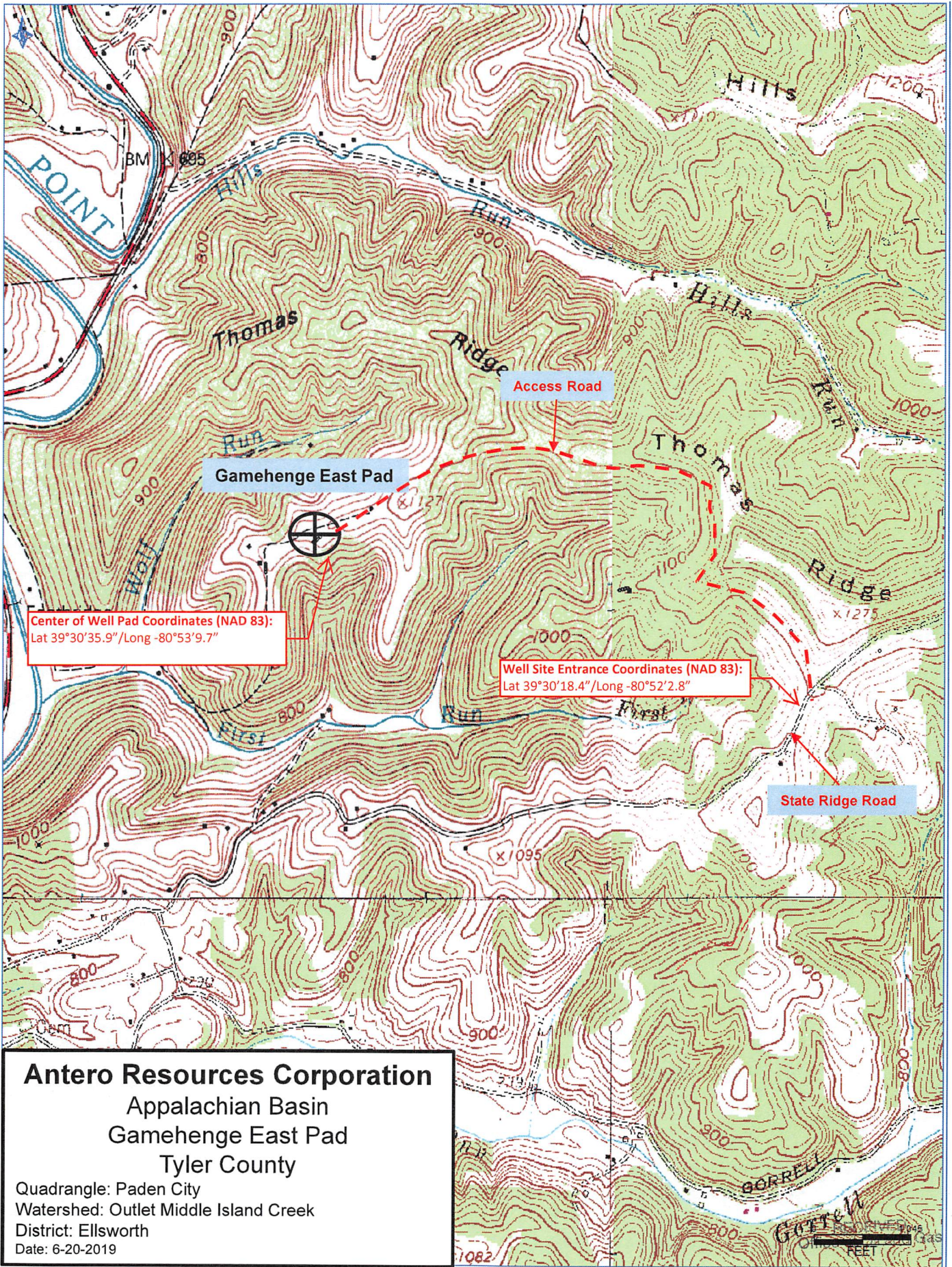

Center of Well Pad Coordinates (NAD 83):
 Lat 39°30'35.9" / Long -80°53'9.7"

Well Site Entrance Coordinates (NAD 83):
 Lat 39°30'18.4" / Long -80°52'2.8"

Antero Resources Corporation
 Appalachian Basin
 Gamehenge East Pad
 Tyler County

Quadrangle: Paden City
 Watershed: Outlet Middle Island Creek
 District: Ellsworth
 Date: 6-20-2019

JUL 11 2019