

Antero Resources
Well No. Harpua Unit 2H
Antero Resources Corporation

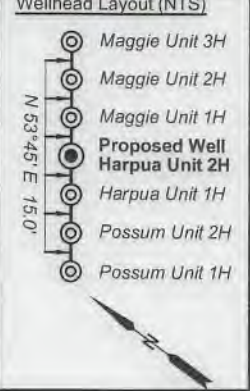

	Bearing	Dist.
L1	S 62°59' E	2,066.3'
L2	S 30°45' E	1,044.1'
L3	N 02°14' W	1,494.3'
L4	N 57°30' E	2,807.5'
L5	N 88°14' W	473.7'

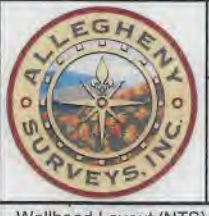
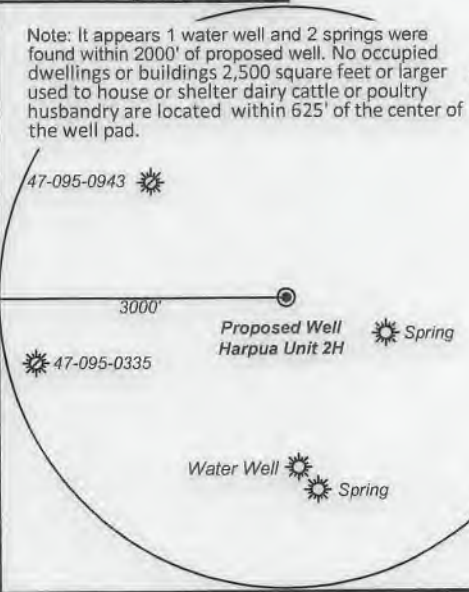
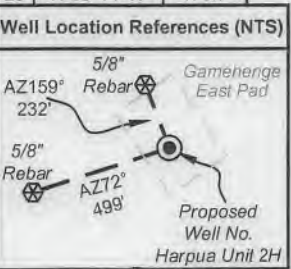

Notes:
Well No. Harpua Unit 2H
UTM Zone 17, NAD 1927
Top Hole Coordinates
N: 14,347,540.06'
E: 1,672,504.91'
Point of Entry Coordinates
N: 14,347,587.49'
E: 1,672,046.11'
Bottom Hole Coordinates
N: 14,349,987.17'
E: 1,671,222.17'

Notes:
West Virginia Coordinate System of 1927, North Zone
based upon Differential GPS Measurements.
Well No. Harpua Unit 2H Top Hole coordinates are
N: 370,773.90' Latitude: 39°30'34.95"
E: 1,608,893.34' Longitude: 80°53'10.44"
Bottom Hole coordinates are
N: 373,242.93' Latitude: 39°30'59.16"
E: 1,607,651.21' Longitude: 80°53'26.77"
UTM Zone 17, NAD 1983
Top Hole Coordinates Bottom Hole Coordinates
N: 4,373,356.657m N: 4,374,102.536m
E: 509,795.006m E: 509,404.051m
Plat orientation and corner and well references are based upon the grid north meridian.
Well location references are based upon the magnetic meridian.

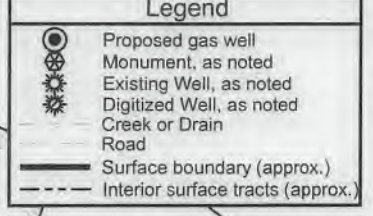

FILE NO: 34-54-E-16
DRAWING NO: Harpua 2H Well Plat
SCALE: 1" = 1000'
MINIMUM DEGREE OF ACCURACY: Submeter
PROVEN SOURCE OF ELEVATION: WVDOT, Harrisville, WV

STATE OF WEST VIRGINIA
DEPARTMENT OF ENVIRONMENTAL PROTECTION
OIL AND GAS DIVISION

DATE: June 28 20 19
OPERATOR'S WELL NO. Harpua Unit 2H
API WELL NO **HGA**
47 - 095 - **02641**
STATE COUNTY PERMIT

WELL TYPE: OIL GAS LIQUID INJECTION WASTE DISPOSAL
(IF GAS) PRODUCTION: STORAGE DEEP SHALLOW
Proposed 1061'
LOCATION: ELEVATION: Existing 1072' WATERSHED: Outlet Middle Island Creek QUADRANGLE: Paden City
DISTRICT: Ellsworth COUNTY: Tyler
SURFACE OWNER: Barbara Kay Turner ACREAGE: 26.18 64.18; 45; 113.725;
ROYALTY OWNER: Linda L. Newbrough; Naomi V. Beagle; Stanley M. & Irene E. Koterba; LEASE NO: ACREAGE: 62.84375;
PROPOSED WORK: DRILL CONVERT DRILL DEEPER FRACTURE OR STIMULATE PLUG OFF OLD FORMATION
 PERFORATE NEW FORMATION OTHER PHYSICAL CHANGE IN WELL (SPECIFY) _____ 7,000' TVD
 PLUG AND ABANDON CLEAN OUT AND REPLUG TARGET FORMATION: Marcellus Shale ESTIMATED DEPTH: 10,500' MD

WELL OPERATOR: Antero Resources Corporation DESIGNATED AGENT: Dianna Stamper - CT Corporation System
ADDRESS: 1615 Wynkoop Street ADDRESS: 5400 D Big Tyler Road
Denver, CO 80202 Charleston, WV 25313



I, the undersigned, hereby certify that this plat is correct to the best of my knowledge and belief and shows all the information required by law and the rules issued and prescribed by the Department of Environmental Protection.
Bradley D. Miller, P.S. 2167

LONGITUDE 80 - 52 - 30
11,590' to Top Hole
9,121' to Bottom Hole

4,589' to Bottom Hole
3,347' to Top Hole

LATITUDE 39 - 32 - 30

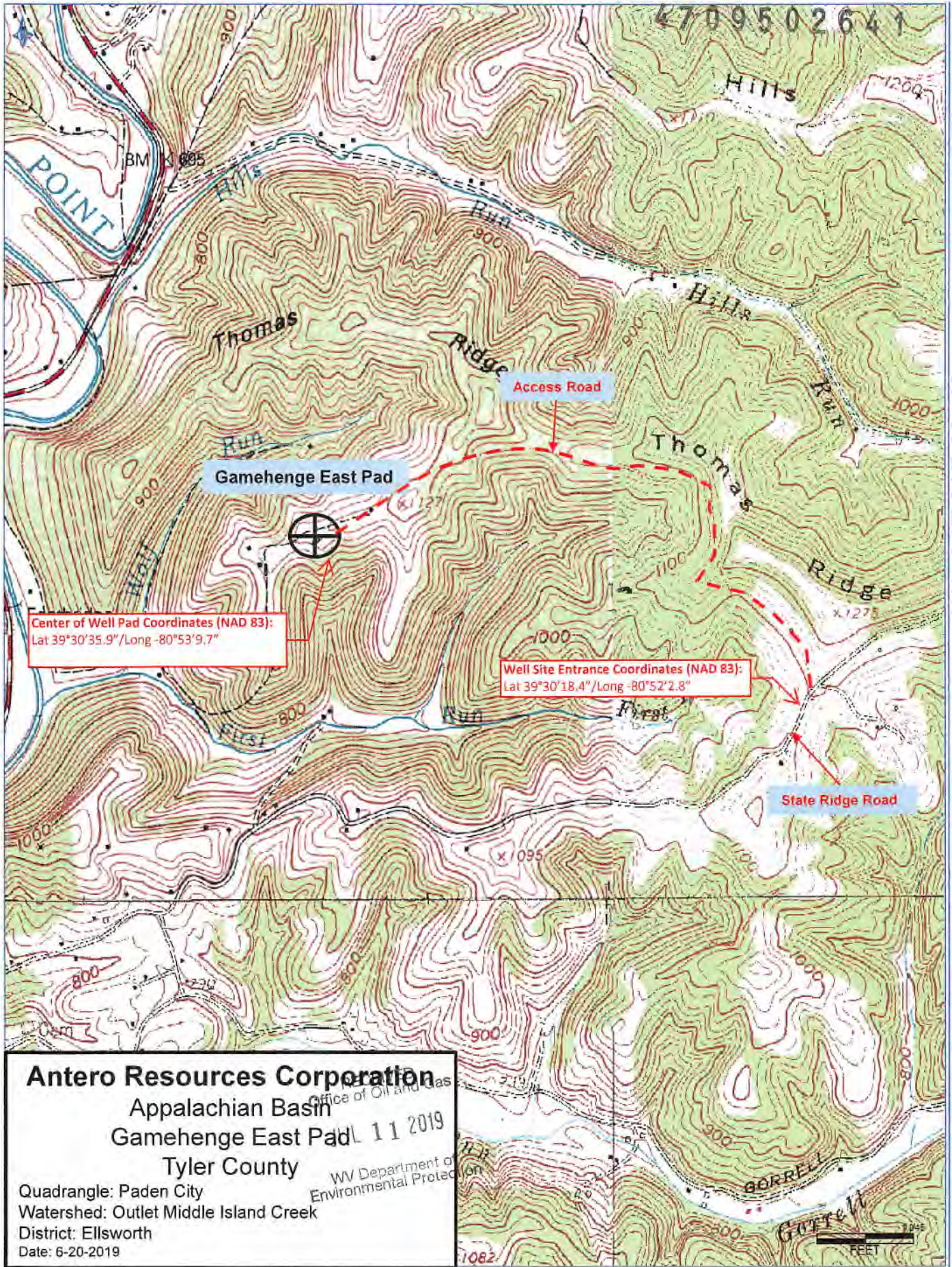

Antero Resources Corporation
 Appalachian Basin
 Gamehenge East Pad
 Tyler County

Office of Oil and Gas
 WV Department of
 Environmental Protection

11 2019

Quadrangle: Paden City
 Watershed: Outlet Middle Island Creek
 District: Ellsworth
 Date: 6-20-2019