

Antero Resources
Well No. Possum Unit 2H
 As-Drilled
 Antero Resources Corporation

10,519' to Bottom Hole

3,371' to Top Hole
 TOP HOLE LATITUDE 39 - 32 - 30
 BTM HOLE LATITUDE 39 - 35 - 00



	Bearing	Dist.
L1	N 03°51' W	1,437.3'
L2	N 58°06' E	2,743.7'
L3	S 62°03' E	2,059.1'
L4	S 27°24' E	1,077.2'

Notes:
 West Virginia Coordinate System of 1927, North Zone based upon Differential GPS Measurements.
 Well No. Possum Unit 2H Top Hole coordinates are
 N: 370,755.16' Latitude: 39°30'34.76"
 E: 1,608,870.49' Longitude: 80°53'10.72"
 Bottom Hole coordinates are
 N: 385,350.17' Latitude: 39°32'57.93"
 E: 1,601,953.15' Longitude: 80°54'41.90"
 UTM Zone 17, NAD 1983
 Top Hole Coordinates Bottom Hole Coordinates
 N: 4,373,350.832m N: 4,377,762.061m
 E: 509,788.139m E: 507,606.640m
 Plat orientation and corner and well references are based upon the grid north meridian.
 Well location references are based upon the magnetic meridian.

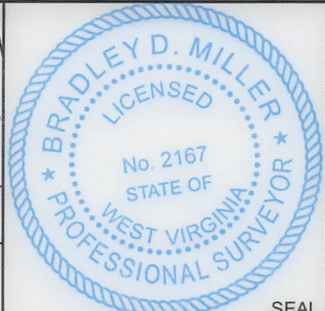

I, the undersigned, hereby certify that this plat is correct to the best of my knowledge and belief and shows all the information required by law and the rules issued and prescribed by the Department of Environmental Protection.
 Bradley D. Miller, P.S. 2167

Legend

- Proposed gas well
- Monument, as noted
- Existing Well, as noted
- Digitized Well, as noted
- Creek or Drain
- Surface boundary (approx.)
- Interior surface tracts (approx.)

Wellhead Layout (NTS)

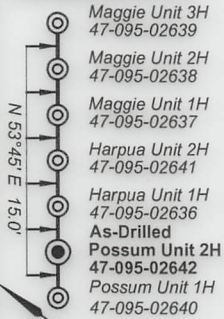

Note: 1 water wells and 2 springs were found within 2000' of proposed well. No occupied dwellings or buildings 2,500 square feet or larger used to house or shelter dairy cattle or poultry husbandry are located within 625' of the center of the well pad.



Top Hole Coordinates, As-drilled data, and information was provided by Antero Resources Corporation. Allegany Surveys Inc. (ASI) is not certifying the data and information provided. ASI is not responsible for any errors or inaccuracies with the data and information that has been provided.

FILE NO: 39-54-E-16
 DRAWING NO: Possum 2H Well Plat
 SCALE: 1" = 2000'
 MINIMUM DEGREE OF ACCURACY: Submeter
 PROVEN SOURCE OF ELEVATION: WVDOT, Harrisville, WV

STATE OF WEST VIRGINIA
 DEPARTMENT OF ENVIRONMENTAL PROTECTION
OIL AND GAS DIVISION

DATE: March 29 20 23
 OPERATOR'S WELL NO. Possum 2H
 API WELL NO
 47 - 095 - 02642
 STATE COUNTY PERMIT

WELL TYPE: OIL GAS LIQUID INJECTION WASTE DISPOSAL
 (IF GAS) PRODUCTION: STORAGE DEEP SHALLOW

LOCATION: ELEVATION: As-Drilled 1,061' WATERSHED: Outlet Middle Island Creek QUADRANGLE: Paden City
 DISTRICT: Ellsworth/Lincoln Sandra L. Baumgardner; Jean Cline; Diane W. Kestle; Kathryn L. Watkins; COUNTY: Boone
 SURFACE OWNER: Barbara Kay Turner Scott Denomme, et ux; David E. Bowyer; Michael D. Reynolds; ACREAGE: 26.18 62.84375; 64.18; 93.63; 74.47; 25.5;
 ROYALTY OWNER: Naomi V. Beagle; Linda L. Newbrough; Sarah A. Midcap (2); LEASE NO: ACREAGE: 109.48; 46.43;

PROPOSED WORK: DRILL CONVERT DRILL DEEPER FRACTURE OR STIMULATE PLUG OFF OLD FORMATION
 PERFORATE NEW FORMATION OTHER PHYSICAL CHANGE IN WELL (SPECIFY) As-Drilled 6,334' TVD
 PLUG AND ABANDON CLEAN OUT AND REPLUG TARGET FORMATION: Marcellus Shale ESTIMATED DEPTH: 22,845' MD

WELL OPERATOR: Antero Resources Corporation DESIGNATED AGENT: Dianna Stamper - CT Corporation System
 ADDRESS: 1615 Wynkoop Street ADDRESS: 5400 D Big Tyler Road
 Denver, CO 80202 Charleston, WV 25313

ID	TM/Par	Owner	Bk/Pg	Acres
1	15-18	Barbara Kay Turner	398/670	26.18
2	15-19	David Mendenhall, et al	282/723	45.00
3	14-27	Ridgetop Capital LP	372/299	64.96
4	14-60.2	Douglas & Tricia Long	333/872	24.47
5	14-60	James A. Jr. & Angela K. Long	333/188	23.99
6	14-58	Linda Newbrough	WB 36/617	10.31
7	14-57	Danny Eugene Cochran	344/251	40.30
8	14-56.1	Boyd M. & Patricia L. Parr	358/643	35.33
9	14A-29	Victor A. & Lorraine Weekley	299/300	13.00
10	14A-29.1	Mensore J.C. Distributors	285/213	1.00
11	14-23	Jackie R. Brookover II	321/749	6.88
12	14-20.1	Jackie R. Brookover II	346/29	13.46
13	14-24	Ridgetop Capital LP	372/299	124.76
14	14-26	Barbara Kay Turner	398/670	26.34
15	14-25	Stanley M. & Irene E. Koterba, et al	331/32	126.05
16	14-18	Terry W. & Carolyn Sue Tracy	193/473	37.00
17	14-9	Robert L. Keller	299/379	116.90
18	14-8	Christine Connell, et al	---/---	37.00
19	14-25.2	Andrew B. & Angela M. Negie	489/577	3.00
20	14-25.1	Roy F. Gorrell	447/180	2.00
21	14-10	Sarah A. Midcap	342/568	40.00
22	14-9.1	John W. & Ida L. Murner	338/162	6.00
23	9-36.2	Ron & Charlene Vancamp	296/390	28.79
24	9-39	Tyler County Board of Education	290/88	65.00
25	9-40.1	Tyler County Board of Education	290/88	9.17
26	9-40	Sarah A. Midcap	168/3	16.83
27	9-31	Sarah A. Midcap	168/3	74.00
28	9-30	Heartwood Forestland Fund II LP	326/547	144.31
29	9-15	Heartwood Forestland Fund II LP	326/547	225.64
30	9-20	Heartwood Forestland Fund II LP	326/547	57.61
31	9-14	Leroy Kent Morris, et al	480/311	93.63
32	13-8	D.H. Jr., & Janice K. Lancaster	351/288	52.84
33	13-3	Mark E. Heintzman	221/635	51.96
34	13-4	William Franklin Ferrell	207/417	10.75
35	9-44	Diane W. Clark	WB 39/544	40.68
36	9-1	Linda L. Stemple	369/9	24.24
37	9-2	William & Margaret Garrett	284/41	22.19
38	9-36	Diane W. Clark	WB 39/544	59.00
39	9-28	Constance Heintzman	WB 43/505	104.50
40	9-29	Russell D. & Mary A. Adams	190/300	1.00
41	9-28.1	Ervin L. & Betty M. Bassett	299/158	4.35
42	9-30	Ervin L. & Betty M. Bassett	309/391	19.57
43	9-30.4	Ervin L. & Betty M. Bassett	337/119	0.34
44	9-30.5	Georgeanna & Scott Michael	414/470	1.53
45	9-30.6	Georgeanna & Scott Michael	423/709	0.58
46	9-30.3	Ervin L. & Betty M. Bassett	337/119	0.23
47	9-30.2	Mark B. Hubbard, Jr.	309/388	1.27
48	9-30.1	Mark B. Hubbard, Jr.	423/709	1.38
49	9-35	Mark E. Heintzman	246/532	19.75
50	9-31.2	Ralph & Sylvia Harter	347/178	4.57
51	9-31	Russell L. & Mary E. Myers	347/263	31.45
52	9-27	Robert Livio Bolner	226/593	59.00
53	9-31.1	Russell L. & Mary E. Myers	340/654	38.04
54	9-24	Ethan A. & Marsha L. Riffle	299/26	82.00
55	9-19	Russell L. & Mary E. Myers	337/26	93.17

Lessor	
A	Linda L. Newbrough
B	Jack Russell Folger, et ux
C	Naomi V. Beagle
D	Douglas H. Long, et ux
E	James A. Long, Jr., et ux
F	Linda L. Newbrough
G	Nathaniel Hendricks
H	Scott Denomme, et ux
I	Scott Denomme, et ux
J	Stanley M. & Irene E. Koterba
K	Sarah A. Midcap
L	Sarah A. Midcap
M	David E. Bowyer
N	Waco Oil & Gas Co. Inc.
O	BRC Appalachian Minerals I, LLC
P	Marilyn S. Parkinson
Q	Sandra L. Baumgardner
R	Donald Lancaster, Jr., et ux
S	Thomas Goodwin, et ux
T	Kathryn L. Watkins
U	Diane W. Kestle
V	Melodee Matheny
W	BRC Appalachian Minerals I, LLC
X	Jean Cline
Y	Mark E. Heintzman
Z	Martha Hayes, et vir
AA	Richard L. Clark
AB	Michael D. Reynolds
AC	Timothy L. Vancamp



FILE NO: 39-54-E-16
 DRAWING NO: Possum 2H Well Plat
 SCALE: 1" = 2000'
 MINIMUM DEGREE OF ACCURACY:
 Submeter
 PROVEN SOURCE OF ELEVATION:
 WVDOT, Harrisville, WV

STATE OF WEST VIRGINIA
 DEPARTMENT OF ENVIRONMENTAL PROTECTION
OIL AND GAS DIVISION

DATE: March 29 20 23
 OPERATOR'S WELL NO. Possum 2H
 API WELL NO
 47 - 095 - 02642
 STATE COUNTY PERMIT

WELL TYPE: OIL GAS LIQUID INJECTION WASTE DISPOSAL
 (IF GAS) PRODUCTION: STORAGE DEEP SHALLOW

LOCATION: ELEVATION: As-Drilled 1,061' WATERSHED: Outlet Middle Island Creek QUADRANGLE: Paden City
 DISTRICT: Ellsworth/Lincoln SURFACE OWNER: Barbara Kay Turner ROYALTY OWNER: Naomi V. Beagle; Linda L. Newbrough; Sarah A. Midcap (2);
 COUNTY: 06/02/2023 ACREAGE: 26.18 LEASE NO: ACREAGE: 109.48; 46.43;

PROPOSED WORK: DRILL CONVERT DRILL DEEPER FRACTURE OR STIMULATE PLUG OFF OLD FORMATION
 PERFORATE NEW FORMATION OTHER PHYSICAL CHANGE IN WELL (SPECIFY) As-Drilled
 PLUG AND ABANDON CLEAN OUT AND REPLUG TARGET FORMATION: Marcellus Shale ESTIMATED DEPTH: 6,334' TVD 22,845' MD

WELL OPERATOR: Antero Resources Corporation DESIGNATED AGENT: Dianna Stamper - CT Corporation System
 ADDRESS: 1615 Wynkoop Street ADDRESS: 5400 D Big Tyler Road
 Denver, CO 80202 Charleston, WV 25313