

Antero Resources
Well No. Reba Unit 2H
 BHL MOD
 Antero Resources Corporation

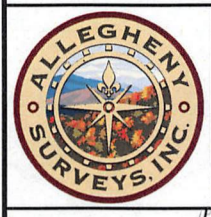

- Lease**
- A Naomi V. Beagle
 - B Jack Russell Folger, et ux
 - C Linda L. Newbrough
 - D Douglas H. Long, et ux
 - E Andrew Hrynczyn
 - F Blackrock Enterprises
 - G Gia Pastors
 - H Lisa Ann Gilmore, et vir
 - I Cathy J. Eastham
 - J Gary R. Davis
 - K Joseph Travis, et ux
 - L Harley G. & Connie L. Stewart
 - M Gary N. & Christine L. Spencer

- Legend**
- Proposed gas well
 - Monument, as noted
 - Existing Well, as noted
 - Digitized Well, as noted
 - Creek or Drain
 - Surface boundary (approx.)
 - Interior surface tracts (approx.)

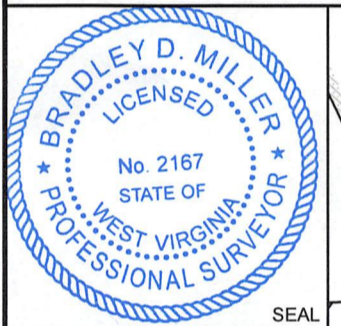

I, the undersigned, hereby certify that this plat is correct to the best of my knowledge and belief and shows all the information required by law and the rules issued and prescribed by the Department of Environmental Protection.

Bradley D. Miller
 Bradley D. Miller, P.S. 2167

Notes:
 Well No. Reba Unit 2H
 UTM Zone 17, NAD 1927
 Top Hole Coordinates
 N: 14,347,230.85'
 E: 1,671,957.93'
 Point of Entry Coordinates
 N: 14,347,737.07'
 E: 1,673,016.34'
 Bottom Hole Coordinates
 N: 14,337,134.12'
 E: 1,676,694.50'

Note: It appears 2 water wells and 2 springs were found within 2000' of proposed well. No occupied dwellings or buildings 2,500 square feet or larger used to house or shelter dairy cattle or poultry husbandry are located within 625' of the center of the well pad.

47-095-00943
 Proposed Well No. Reba Unit 2H
 3000' Spring

47-095-0335
 Proposed Well No. Reba Unit 2H
 Water Well Spring

	Bearing	Dist.
L1	N 28°30' W	1,311.5'
L2	N 57°01' E	2,145.9'
L3	S 45°58' E	1,793.6'
L4	S 01°34' W	1,238.3'
L5	N 65°21' E	1,171.7'

ID	TM/Par	Owner	Bk/Pg	Acres
1	14/27	Ridgetop Capital LP	372/299	64.96
2	14/26	Turner	398/670	26.34
3	15/37	Mendenhall & Davis	444/531	154.17
4	15/18	Turner	398/670	26.18
5	15/19	Mendenhall, et al	282/723	45.00
6	15/17	Mendenhall, et al	288/662	85.71
7	15/23	Mendenhall, et al	326/13	97.25
8	15/22	MacNaughtan	366/289	99.56
9	15/20	Folger	WB 37/622	21.60
10	14/60.2	Long	333/872	24.47
11	14/61	Folger	396/506	4.00
12	15/21.2	Long	287/267	1.79
13	15/21.4	Long	WB 32/551	9.00
14	14/92	White	369/389	1.58
15	15/21.5	Long	WB 32/551	44.55
16	15/24	Fruener	300/342	97.50
17	21/2	Baker	WB 36/545	130.45
18	15/21.1	Baker	WB 36/545	72.00
19	21/1.1	Fritz	357/660	134.28
20	21/1	Pierce	394/517	55.72
21	21/2.1	Baker	233/258	34.55
22	21/3	Copper	287/390	60.46
23	21/20	Conaway	WB 17/354	95.50
24	21/23	Robinson	138/390	72.75
25	21/25.4	Eastham	287/69	44.57
26	21/25	Eastham	330/726	11.47
27	21/27	Leasure & Gilmore	207/260	40.00
28	21/25.3	Davis	356/431	5.465
29	21/25.1	Travis	358/522	2.81
30	21/25.2	Stewart	312/305	2.717
31	21/24	Spencer	270/198	2.25
32	21/43	Crumrine	WB 17/655	231.04
33	21/22	4H Camp	118/239	8.00

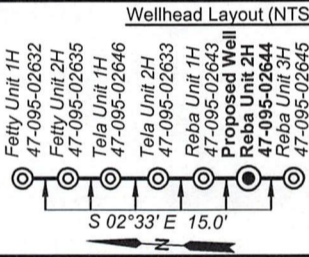
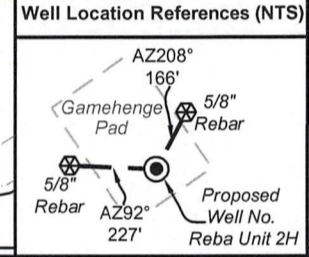

Notes:
 West Virginia Coordinate System of 1927, North Zone
 based upon Differential GPS Measurements.
 Well No. Reba Unit 2H Top Hole coordinates are
 N: 370,473.76 Latitude: 39°30'31.90"
 E: 1,608,341.09 Longitude: 80°53'17.42"
 Bottom Hole coordinates are
 N: 360,295.89 Latitude: 39°28'52.00"
 E: 1,612,910.02 Longitude: 80°52'17.15"
 UTM Zone 17, NAD 1983
 Top Hole Coordinates Bottom Hole Coordinates
 N: 4,373,262.404m N: 4,370,184.939m
 E: 509,628.284m E: 511,071.958m
 Plat orientation and corner and well references are based upon the grid north meridian.
 Well location references are based upon the magnetic meridian.

FILE NO: 40-54-E-16
 DRAWING NO: Reba 2H Well Plat
 SCALE: 1" = 1500'
 MINIMUM DEGREE OF ACCURACY: Submeter
 PROVEN SOURCE OF ELEVATION: WVDOT, Harrisville, WV

STATE OF WEST VIRGINIA
 DEPARTMENT OF ENVIRONMENTAL PROTECTION
OIL AND GAS DIVISION

DATE: November 6 20 19
 OPERATOR'S WELL NO. Reba Unit 2H
 API WELL NO. *MOD*
 47 - 095 - 02644
 STATE COUNTY PERMIT

WELL TYPE: OIL GAS LIQUID INJECTION WASTE DISPOSAL
 (IF GAS) PRODUCTION: STORAGE DEEP SHALLOW
 Proposed 1026'

LOCATION: ELEVATION: Existing 1052' WATERSHED: Outlet Middle Island Creek QUADRANGLE: Btm - Shirley
 DISTRICT: Ellsworth COUNTY: Tyler
 SURFACE OWNER: Ridgetop Capital LP Cathy J. Eastham; Carl W. Miller II; John W. & Alice F. Robinson; 85.71; 62.84375;
 Donald MacNaughtan, Jr.; Jack Russell Folger, et ux; ACREAGE: 64.96 130.45; 189.993;
 ROYALTY OWNER: Naomi V. Beagle; Linda L. Newbrough; Darla S. Colombo; Donald K. Baker; LEASE NO: ACREAGE: 72.75; 64.18; 45; 99.18; 56.045;

PROPOSED WORK: DRILL CONVERT DRILL DEEPER FRACTURE OR STIMULATE PLUG OFF OLD FORMATION
 PERFORATE NEW FORMATION OTHER PHYSICAL CHANGE IN WELL (SPECIFY) BHL MOD
 PLUG AND ABANDON CLEAN OUT AND REPLUG TARGET FORMATION: Marcellus Shale ESTIMATED DEPTH: 7,000' TVD
 19,900' MD

WELL OPERATOR: Antero Resources Corporation DESIGNATED AGENT: Dianna Stamper - CT Corporation System
 ADDRESS: 1615 Wynkoop Street ADDRESS: 5400 D Big Tyler Road
 Denver, CO 80202 Charleston, WV 25313