

LATITUDE 39°25'00"

10,811'

LATITUDE 39°22'30"

9,562' TO BOTTOM HOLE

Antero Resources Corporation Well No. Stampede Unit 1H

AS DRILLED DATA: WELL 1H TOP HOLE INFORMATION: N: 331,506ft E: 1,635,976ft ... BOTTOM HOLE INFORMATION: N: 321,070ft E: 1,637,080ft ... WEST VIRGINIA COORDINATE SYSTEM OF 1927 NORTH ZONE.

(NAD) 83 (UTM) ZONE 17 COORDS: WELL 1H TOP HOLE INFORMATION: N: 4,361,531m E: 518,246m ... BOTTOM HOLE INFORMATION: N: 4,358,358m E: 518,635m

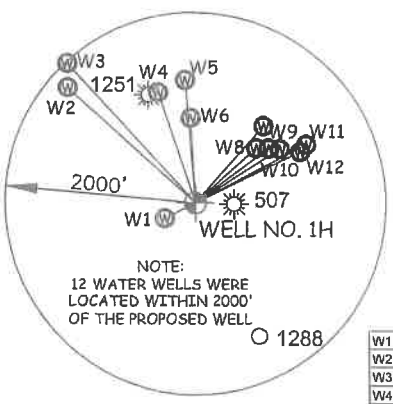
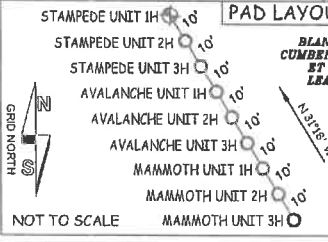

Table with 2 columns: Well ID (W1-W12) and coordinates (S, N, E, W). Example: W1 S 83°23' W 359.2'

McElroy District - Tyler County Surface Owner list. Columns: Well ID, Surface Owner. Includes names like June Griffin, Roger Griffin, Harry Vangoy, etc.

217' TO BOTTOM HOLE LONGITUDE 80°45'00" 4,973'

I THE UNDERSIGNED, HEREBY CERTIFY THAT THIS PLAT IS CORRECT TO THE BEST OF MY KNOWLEDGE AND BELIEF AND SHOWS ALL THE INFORMATION REQUIRED BY LAW AND THE RULES ISSUED AND PERSCRIBED BY THE DEPARTMENT OF ENVIRONMENTAL PROTECTION.



STATE OF WEST VIRGINIA, DIVISION OF ENVIRONMENTAL PROTECTION, OFFICE OF OIL AND GAS. WILLOW LAND SURVEYING PLLC, 220 MASONIC AVE. PENNSBORO WEST VIRGINIA 26415

JOB # 19-001WA DRAWING # STAMPEDE1HAD SCALE 1" = 2000' MINIMUM DEGREE OF ACCURACY SUBMETER PROVEN SOURCE OF ELEV. SUBMETER MAPPING GRADE GPS STATE OF WEST VIRGINIA DEPARTMENT OF ENERGY DIVISION OF OIL AND GAS

LEGEND: Surface Owner Boundary Lines +/- Interior Surface Tracts +/- Proposed Well Path As Drilled Well Path. DOUGLAS R. ROWE P.S. 2202 DATE 09/03/20 OPERATOR'S WELL# STAMPEDE UNIT #1H

NOTE: 1. NO OCCUPIED DWELLINGS OR BUILDINGS TWO THOUSAND FIVE HUNDRED (2,500) SQUARE FEET OR LARGER USED TO HOUSE OR SHELTER DAIRY CATTLE OR POULTRY HUSBANDRY ARE LOCATED WITHIN SIX HUNDRED TWENTY-FIVE (625) FEET OF THE CENTER OF THE WELL PAD. 2. TOP HOLE DATA SHOWN HEREON WAS PROVIDED BY ANTERO RESOURCES CORPORATION. 3. AS DRILLED DATA WAS PROVIDED BY ANTERO RESOURCES CORPORATION. 4. WLS IS NOT CERTIFYING THE DATA AND INFORMATION PROVIDED LISTED IN NOTES 2 AND 3, ONLY THE RELATIONSHIP TO THE DATA AND INFORMATION PROVIDED TO THE LEASE BOUNDARIES. 5. WLS IS BY NO MEANS RESPONSIBLE FOR ANY ERRORS OR INACCURACIES WITH THE DATA AND INFORMATION THAT HAS BEEN PROVIDED.

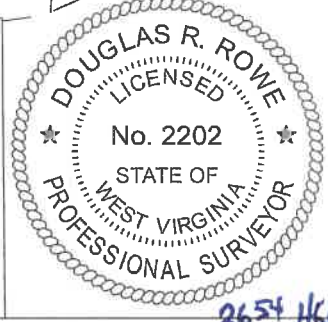

WELL TYPE: OIL GAS X LIQUID INJECTION WASTE DISPOSAL 47 - 095 - 02608 (IF "GAS") PRODUCTION X STORAGE DEEP SHALLOW X STATE COUNTY PERMIT LOCATION: ELEVATION 743' - AS BUILT WATERSHED McElroy CREEK QUADRANGLE TH - SHIRLEY 7.5' BH - WEST UNION 7.5' DISTRICT McElroy COUNTY TYLER SURFACE OWNER ANTERO RESOURCES CORPORATION ACREAGE 127.86 ACRES +/- LEASE ACREAGE 130 AC.±; 85 AC.±; OIL & GAS ROYALTY OWNER B.F. REED ET UX; KENNETH ORR ET AL; JACOB A. CUMBERLEDGE ET UX; GAY CUMBERLEDGE ET AL; FANNY D. DAVIS ET AL; ENID McCULLOUGH ET VIR; W.S. WRIGHT ET AL; JAMES B. FAHEY ET UX TARGET FORMATION MARCELLUS ESTIMATED DEPTH 6,412' TVD 17,335' MD PROPOSED WORK: DRILL CONVERT DRILL DEEPER REDRILL FRACTURE OR STIMULATE PLUG OFF OLD FORMATION PERFORATE NEW FORMATION OTHER PHYSICAL CHANGE IN WELL (SPECIFY) AS DRILLED PLUG & ABANDON CLEAN OUT & REPLUG WELL OPERATOR ANTERO RESOURCES CORP. DESIGNATED AGENT DIANNA STAMPER - CT CORPORATION SYSTEM ADDRESS 1615 WYNKOOP ST. ADDRESS 5400 D BIG TYLER ROAD FORM WW-6 DENVER, CO 80202 CHARLESTON, WV 25313

06/25/2021

COUNTY NAME PERMIT