

10,739' to Bottom Hole

6,713' to Top Hole

LATITUDE 39 - 30 - 00

LONGITUDE 80 - 52 - 30
3,971' to Bottom Hole
10,299' to Top Hole

Antero Resources
Well No. Fender Unit 1H

Legend

- ⊙ Proposed gas well
- ⊛ Monument, as noted
- ⊙ Existing Well, as noted
- ⊙ Existing Well, as noted
- Creek or Drain
- Existing Road
- Surface boundary (approx.)
- Interior surface tracts (approx.)

Page 1 of 2

Notes:
West Virginia Coordinate System of 1927, North Zone based upon Differential GPS Measurements.
Well No. Fender Unit 1H Top Hole coordinates are
N: 356,891.30' Latitude: 39°28'17.20"
E: 1,605,295.40' Longitude: 80°53'53.58"
Bottom Hole coordinates are
N: 363,219.34' Latitude: 39°29'19.11"
E: 1,601,269.15' Longitude: 80°54'46.19"
UTM Zone 17, NAD 1983
Top Hole Coordinates Bottom Hole Coordinates
N: 4,369,108.927m N: 4,371,016.280m
E: 508,769.459m E: 507,510.865m
Plat orientation and corner and well references are based upon the grid north meridian.
Well location references are based upon the magnetic meridian.

Notes:
Well No. Fender Unit 1H
UTM Zone 17, NAD 1927
Top Hole Coordinates
N: 14,333,604.11'
E: 1,669,140.36'
Point of Entry Coordinates
N: 14,332,283.66'
E: 1,667,618.68'
Bottom Hole Coordinates
N: 14,339,861.91'
E: 1,665,010.46'

Bearing	Dist.
L1 S 46°08' E	1,400.9'
L2 S 25°19' W	1,549.8'
L3 N 76°14' W	929.9'
L4 N 09°27' W	1,418.2'
L5 S 50°00' W	2,015.4'



Wellhead Layout

- ⊙ Kramer Unit 2H
- ⊙ Kramer Unit 1H
- ⊙ Lancaster Unit 3H
- ⊙ Lancaster Unit 2H
- ⊙ Lancaster Unit 1H
- ⊙ Fender Unit 3H
- ⊙ Fender Unit 2H
- ⊙ Proposed Well Fender Unit 1H

N 44°06' E 15.0'

Well Location References

Note: 3 water wells and 1 pond were found within 2000' of proposed well. No occupied dwellings or buildings 2,500 square feet or larger used to house or shelter dairy cattle or poultry husbandry are located within 625' of the center of the well pad.

I, the undersigned, hereby certify that this plat is correct to the best of my knowledge and belief and shows all the information required by law and the rules issued and prescribed by the Department of Environmental Protection.

Bradley D. Miller
Bradley D. Miller, P.S. 2167



FILE NO: 17-54-E-19
DRAWING NO: Fender Unit 1H Well Plat
SCALE: 1" = 1500'
MINIMUM DEGREE OF ACCURACY: Submeter
PROVEN SOURCE OF ELEVATION: WV DOT, Harrisville, WV

STATE OF WEST VIRGINIA
DEPARTMENT OF ENVIRONMENTAL PROTECTION
OIL AND GAS DIVISION

DATE: November 20, 2019
OPERATOR'S WELL NO. Fender 1H
API WELL NO. H4A
47 - 095 - 02670
STATE COUNTY PERMIT

WELL TYPE: OIL GAS LIQUID INJECTION WASTE DISPOSAL
(IF GAS) PRODUCTION: STORAGE DEEP SHALLOW
Proposed 1,014.5'
LOCATION: ELEVATION: Existing 1,033' WATERSHED: Outlet Middle Island Creek QUADRANGLE: Middlebourne
DISTRICT: Ellsworth COUNTY: Tyler
SURFACE OWNER: Michael J. & Melinda R. Hogue BRC Appalachian Minerals I, LLC; Nellie M. Wilson; Ruth E. Blake; Betty Lou Hadley; Sam Maxson; Larry K. Spencer; ACREAGE: 192.0
ROYALTY OWNER: Michael J. & Melinda R. Hogue; Ryan L. Walton, et ux (2); David L. Lancaster, et ux (2) LEASE NO: ACREAGE: 8.00;
PROPOSED WORK: DRILL CONVERT DRILL DEEPER FRACTURE OR STIMULATE PLUG OFF OLD FORMATION
 PERFORATE NEW FORMATION OTHER PHYSICAL CHANGE IN WELL (SPECIFY) _____ 6,000' TVD
 PLUG AND ABANDON CLEAN OUT AND REPLUG TARGET FORMATION: Marcellus Shale ESTIMATED DEPTH: 18,300' MD

WELL OPERATOR: Antero Resources Corporation DESIGNATED AGENT: Dianna Stamper - CT Corporation System
ADDRESS: 1615 Wynkoop Street ADDRESS: 5400 D Big Tyler Road
Denver, CO 80202 Charleston, WV 25313



Leases	
A	Michael J. & Melinda R. Hogue
B	James F. Doan, et ux
C	Ryan L. Walton, et ux
D	The Swan Living Trust
E	David L. Lancaster, et ux
F	Ryan L. Walton, et ux
G	David L. Lancaster, et ux
H	Kenneth W. Lancaster
I	Terry Lee Fiber
J	Joe & Shirley Varese
K	OPEN
L	Peter W. & Irmagard E. Guenter Joint Living Trust
M	Thomas & Cynthia H. Hall
N	BRC Appalachian Minerals I, LLC
O	Robert C. Kramer
P	Charles E. Anderson, et ux
Q	Ruth E. Blake
R	Earnestine Pelikan & David Leasure
S	Betty Lou Hadley
T	Sam Maxson
U	Larry K. Spencer
V	Tustin Family Trust
W	Tustin Family Trust
X	BRC Appalachian Minerals I, LLC
Y	Nellie M. Wilson
Z	Arthur D. Haught
AA	Mary Frances Carpenter
AB	Wanda M. Spencer
AC	Larry K. Spencer
AD	Harold L. Holloway, Jr., et ux
AE	Michael H. Glover, et ux
AF	Betty Lou Hadley
AG	Jordan L. & Michael P. Haught
AH	James M. Glover, et ux
AI	James M. Glover, et ux
AJ	April N. DeLong
AK	Ruth Blake
AL	Ruth Blake
AM	Betty Lou Hadley
AN	James D. Anderson & Tracy A. Doll
AO	Betty Lou Hadley
AP	Bessie L. Matthews, et vir
AQ	Betty Lou Hadley
AR	Betty Lou Hadley
AS	Betty Lou Hadley
AT	Stephen D. Ashley, et ux
AU	James M. Glover, et ux
AV	Martha J. Hayes, et vir
AW	Betty Lou Hadley
AX	Betty Lou Hadley
AY	NO LEASE
AZ	Betty Hadley
BA	Laura June Smith
BB	Kathryn Knowlton
BC	Crystal Christophel
BD	Timothy Stanley, et ux
BE	Donald E. Huffman
BF	Betty Lou Hadley
BG	Betty Lou Hadley
BH	Nancy Glover
BI	William H. Eddy

ID	TM/Par	Owner	Bk/Pg	Acres
1	20/108	Michael J. & Melinda R. Hogue	348/404	192.00
2	26/46.10	Leon & Drema Gall Ison	359/311	4.98
3	26/46.5	Richard Doty	493/673	13.14
4	26/46.4	Timothy F. & Jasmine Y. Kanz	415/716	8.10
5	26/22	Ryan Lee & Melinda Jo Walton	342/687	36.50
6	26/21	Ryan Lee & Melinda Jo Walton	342/687	35.90
7	26/20	Kenneth & Brenda Lancaster	210/502	20.00
8	20/102	Antero Midstream LLC	575/69	203.59
9	20/103	Kenneth & Brenda Lancaster	210/341	1.20
10	20/104	David Lancaster	210/505	57.00
11	20/107	David L. & Kathy A. Lancaster	314/344	18.89
12	20/102.1	Terrell Lee Henderson	445/302	0.951
13	20/104.1	Kenneth & Brenda Lancaster	328/13	1.796
14	20/105.1	Terry Lee Fiber	335/682	6.06
15	20/105	Joe & Shirley Varese	352/736	11.322
16	20/105.2	Terry Lee Fiber	336/480	0.098
17	20/106	Eugene F. & Phyllis A. Howell	223/371	19.76
18	20/106.1	Lee Ann Hall	486/806	5.493
19	20/99	Pioneer Land Company LLC	431/414	10.00
20	20/85	Pioneer Land Company LLC	431/414	83.10
21	20/83.5	Thomas & Cynthia Hall	392/229	6.416
22	20/93.1	Vernon Stevens	423/703	2.14
23	20/93.5	Nina Smith & Mary Bennett	308/115	2.88
24	20/106.2	Nancy Forester	328/633	5.429
25	20/93	Robert C. Kramer	547/650	23.964
26	20/92	Charles & Doris Anderson	210/359	27.00
27	20/94	Charles & Doris Anderson	217/398	2.806
28	20/86	Ruth E. Blake	317/103	23.75
29	20/44.1	Ruth E. Blake	317/103	10.17
30	20/44.2	Roy D. Hadley & Betty L. Gully	295/375	11.27
31	20/43	Janet Neff, et al	429/173	35.00
32	20/41	William G. & Larry K. Spencer	296/368	1.71
33	20/42	Janet Neff, et al	429/173	20.23
34	20/42.1	Kenneth & Mary Ashley	351/771	1.889
35	20/41	Kenneth & Mary Ashley	194/365	15.79
36	20/41.1	Janet Neff, et al	429/173	2.218
37	20/46.1	Betty Tustin	WB45/156	2.476
38	20/47	Betty Tustin	WB45/156	1.00
39	20/46	Betty Tustin	WB45/156	29.66

ID	TM/Par	Owner	Bk/Pg	Acres
40	20/45	Nellie M. Wilson	337/462	8.00
41	20/40.1	Gary & Margaret Rymer	232/12	7.07
42	20/40	William H. & Judy M. White	352/566	9.31
43	20A/6	Roy D. & Betty Lou Hadley	353/558	0.53
44	20A/3.1	Larry K. Spencer	425/56	0.524
45	20A/2	Wanda M. Spencer, et al	AR50/170	0.45
46	20A/3	Harold L. & Debra C. Holloway	225/51	0.366
47	20A/5	Michael H. & Vola J. Glover	208/103	1.38
48	20A/7	Jordan L. & Michael P. Haught	522/391	1.66
49	20A/8	James M. & Sara K. Glover	434/163	0.44
50	20A/9	James M. & Sarah M. Glover	578/622	0.17
51	20A/10	April N. DeLong	437/806	0.11
52	20A/10.1	Ruth E. Blake	348/604	0.16
53	20A/11	Ruth E. Blake	343/574	0.14
54	20A/12	Roy D. & Betty Lou Hadley	304/366	0.25
55	20A/13	James D. Anderson & Tracy A. Doll	400/425	0.33
56	20A/55	Roy D. & Betty Lou Hadley	350/341	0.17
57	20A/54	Bessie L. Matthews, et vir	521/634	0.46
58	20A/52	Betty Lou Hadley	579/652	0.24
59	20A/53	Deloris Gully	AR40/97	0.33
60	20A/14	Roy D. Hadley	332/696	0.17
61	20A/15	Stephen D. & Brenda J. Ashley	317/183	0.50
62	20A/16	James M. Glover	330/197	0.50
63	20/46.2	James & Sara Glover	350/386	0.386
64	20A/17	Chris L. Hayes & Martha J. Tennant	343/212	0.17
65	20A/18	Roy D. Hadley	WB23/305	0.66
66	20A/19	Roy D. Hadley	WB23/305	0.17
67	20A/20	Betty Hadley	470/683	0.17
68	20A/50	Betty Lou Hadley	579/652	0.17
69	20A/51	Shirl A. Henderson	WB19/379	0.17
70	20A/51.1	Crystal Christophel	WB19/379	0.16
71	20/86.1	Earnest Leasure, et al	321/160	0.37
72	20A/21	Roy D. Hadley	317/674	3.00
73	20A/22	Roy Hadley	WB23/305	0.17
74	20A/23	Connie Sue Tanner	327/883	0.33
75	20A/24	Timothy & Tonya Stanley	581/792	0.33
76	20A/26.1	Evelyn S. Smith	328/95	0.165
77	20A/25	Nancy Glover	147/104	0.33
78	20A/26	Evelyn S. Smith	332/681	0.165

FILE NO: 17-54-E-19
 DRAWING NO: Fender Unit 1H Well Plat
 SCALE: 1" = 1500'
 MINIMUM DEGREE OF ACCURACY:
 Submeter
 PROVEN SOURCE OF ELEVATION:
 WVDOT, Harrisville, WV

STATE OF WEST VIRGINIA
 DEPARTMENT OF ENVIRONMENTAL PROTECTION
OIL AND GAS DIVISION

DATE: November 20, 2019
 OPERATOR'S WELL NO. Fender 1H
 API WELL NO **HGA**
 47 - 095 - **02610**
 STATE COUNTY PERMIT

WELL TYPE: OIL GAS LIQUID INJECTION WASTE DISPOSAL
 (IF GAS) PRODUCTION: STORAGE DEEP SHALLOW
 Proposed 1,014.5'
 LOCATION: ELEVATION: Existing 1,033' WATERSHED: Outlet Middle Island Creek QUADRANGLE: Middlebourne
 DISTRICT: Ellsworth COUNTY: Tyler
 SURFACE OWNER: Michael J. & Melinda R. Hogue; BRC Appalachian Minerals I, LLC; Nellie M. Wilson; Ruth E. Blake; Betty Lou Hadley; Sam Maxson; Larry K. Spencer;
 ROYALTY OWNER: Michael J. & Melinda R. Hogue; Ryan L. Walton, et ux (2); David L. Lancaster, et ux (2) LEASE NO: ACREAGE: 192.0
 PROPOSED WORK: DRILL CONVERT DRILL DEEPER FRACTURE OR STIMULATE PLUG OFF OLD FORMATION
 PERFORATE NEW FORMATION OTHER PHYSICAL CHANGE IN WELL (SPECIFY) _____
 PLUG AND ABANDON CLEAN OUT AND REPLUG TARGET FORMATION: Marcellus Shale ESTIMATED DEPTH: 18,300' MD

WELL OPERATOR: Antero Resources Corporation DESIGNATED AGENT: Dianna Stamper - CT Corporation System
 ADDRESS: 1615 Wynkoop Street ADDRESS: 5400 D Big Tyler Road
 Denver, CO 80202 Charleston, WV 25313

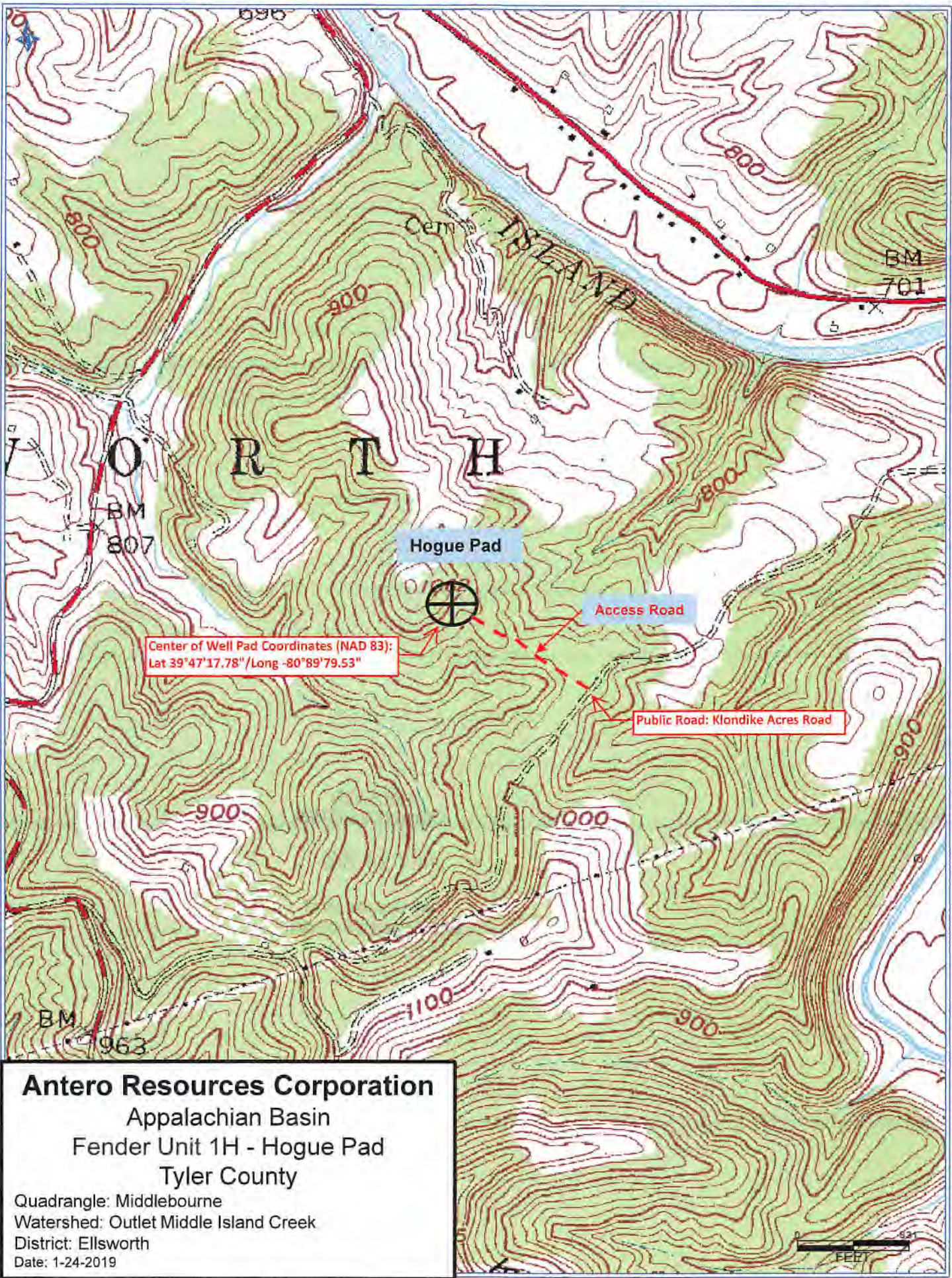

Antero Resources Corporation
Appalachian Basin
Fender Unit 1H - Hogue Pad
Tyler County

Quadrangle: Middlebourne
Watershed: Outlet Middle Island Creek
District: Ellsworth
Date: 1-24-2019

