

Antero Resources
Well No. Lancaster Unit 1H
BHL MOD
Antero Resources Corporation

Bearing	Dist.
L1 S 47°58' E	1,401.8'
L2 S 28°53' W	1,534.5'
L3 N 73°47' W	908.0'
L4 N 08°01' W	1,445.4'
L5 S 07°52' E	1,411.9'

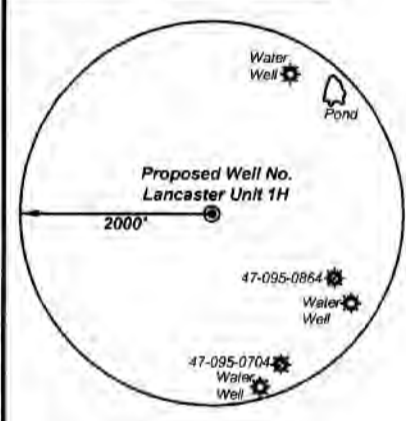
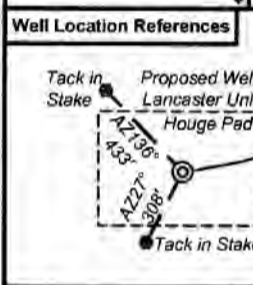
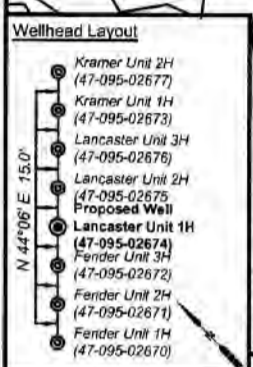

Note: 3 water wells and 1 pond were found within 2000' of proposed well. No occupied dwellings or buildings 2,500 square feet or larger used to house or shelter dairy cattle or poultry husbandry are located within 625' of the center of the well pad.

Legend

- Proposed gas well
- Monument, as noted
- Existing Well, as noted
- Existing Well, as noted
- Creek or Drain
- Existing Road
- Surface boundary (approx.)
- Interior surface tracts (approx.)

9,269' to Bottom Hole
 6,681' to Top Hole
 LATITUDE 39 - 30 - 00
 LONGITUDE 80 - 52 - 30

Page 1 of 4

Notes:
 West Virginia Coordinate System of 1927, North Zone based upon Differential GPS Measurements.
 Well No. Lancaster Unit 1H Top Hole coordinates are
 N: 356,923.62' Latitude: 39°28'17.52"
 E: 1,605,326.71' Longitude: 80°53'53.19"
 Bottom Hole coordinates are
 N: 363,983.03' Latitude: 39°29'26.89"
 E: 1,602,739.20' Longitude: 80°54'27.59"
UTM Zone 17, NAD 1983
 Top Hole Coordinates Bottom Hole Coordinates
 N: 4,369,118.933m N: 4,371,256.431m
 E: 508,778.833m E: 507,954.635m
 Plat orientation and corner and well references are based upon the grid north meridian.
 Well location references are based upon the magnetic meridian.

Notes:
 Well No. Lancaster Unit 1H UTM Zone 17, NAD 1927
 Top Hole Coordinates
 N: 14,333,636.93' E: 1,669,171.12'
 Point of Entry Coordinates
 N: 14,332,242.21' E: 1,669,387.62'
 Bottom Hole Coordinates
 N: 14,340,649.76' E: 1,666,467.05'

Leases

A	Michael J. & Melinda R. Hogue
B	Ridgetop Capital LP
C	James F. Doan, et ux
D	James F. Doan, et ux
E	Ryan L. Walton, et ux
F	David L. Lancaster, et ux
G	David L. Lancaster, et ux
H	Terry Lee Fiber
I	Joe & Shirley Varese
J	Eugene F. Howell, et ux
K	Leeman W. & Susan L. Mason
L	Eugene F. Howell, et ux
M	OPEN
N	Nina Naomi Wise
O	Jerry Todd Williams
P	Barbara J. Davis
Q	William M. Baker
R	William M. Baker, et ux
S	Peter W. & Imgard E. Guenter, Joint Living Trust
T	BRC Appalachian Minerals I, LLC
U	Robert C. Kramer
V	Ruth E. Blake
W	Charles E. Anderson, et ux
X	John Valentour
Y	Clara Jane Glover
Z	Brian D. Carpenter, et ux
AA	Tustin Family Trust
AB	Samuel O. Wagner
AC	Richard A. Fonner, et ux

Continued on Page 4

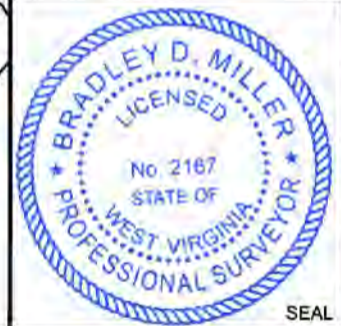

I, the undersigned, hereby certify that this plat is correct to the best of my knowledge and belief and shows all the information required by law and the rules issued and prescribed by the Department of Environmental Protection.

Bradley D. Miller
 Bradley D. Miller, P.S. 2167

FILE NO: 11-54-E-19
 DRAWING NO: Lancaster Unit 1H Well Plat
 SCALE: 1" = 1500'
 MINIMUM DEGREE OF ACCURACY: Submeter
 PROVEN SOURCE OF ELEVATION: WVDOT, Harrisville, WV

STATE OF WEST VIRGINIA
 DEPARTMENT OF ENVIRONMENTAL PROTECTION
OIL AND GAS DIVISION

DATE: February 11, 2020
 OPERATOR'S WELL NO. Lancaster 1H
 API WELL NO
 47 - 095 - 02674
 STATE COUNTY PERMIT

WELL TYPE: OIL GAS LIQUID INJECTION WASTE DISPOSAL
 (IF GAS) PRODUCTION: STORAGE DEEP SHALLOW
 LOCATION: ELEVATION: Existing 1,033' Proposed 1,014.5' WATERSHED: Outlet Middle Island Creek QUADRANGLE: _____
 DISTRICT: Ellsworth COUNTY: Tyler
 SURFACE OWNER: Michael J. & Melinda R. Hogue ACREAGE: 192.0
 ROYALTY OWNER: Michael J. & Melinda R. Hogue; James F. Doan, et ux; Ridgetop Capital LP; Ruth E. Blake LEASE NO: _____ ACREAGE: 0.4343; 28.65; 0.70
 PROPOSED WORK: DRILL CONVERT DRILL DEEPER FRACTURE OR STIMULATE PLUG OFF OLD FORMATION
 PERFORATE NEW FORMATION OTHER PHYSICAL CHANGE IN WELL (SPECIFY) BHL MOD ESTIMATED DEPTH: 6,900' TVD
 PLUG AND ABANDON CLEAN OUT AND REPLUG TARGET FORMATION: Marcellus Shale ESTIMATED DEPTH: 18,600' MD

WELL OPERATOR: Antero Resources Corporation DESIGNATED AGENT: Dianna Stamper - CT Corporation System
 ADDRESS: 1615 Wynkoop Street ADDRESS: 5400 D Big Tyler Road
 Denver, CO 80202 Charleston, WV 25313

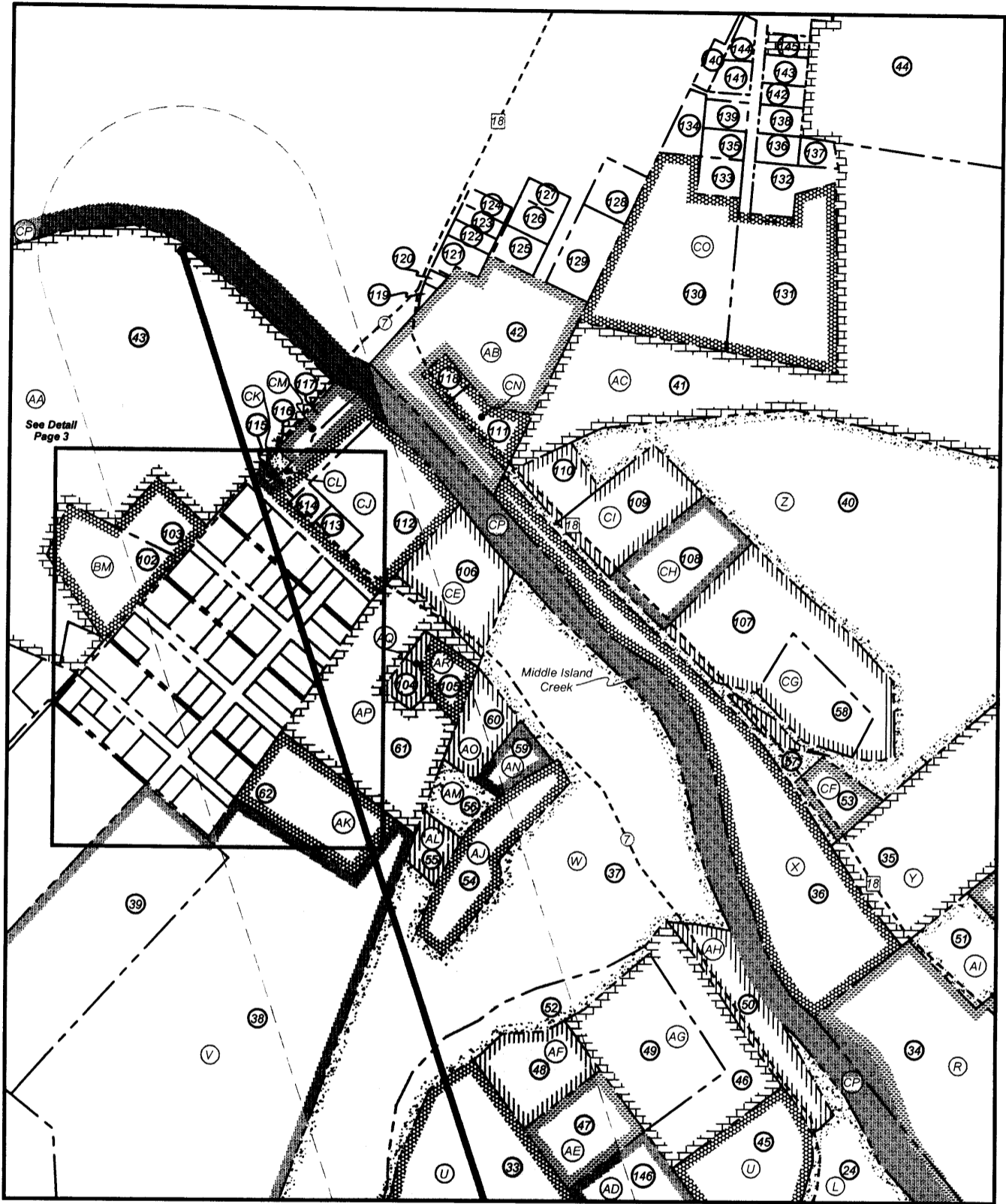

FILE NO: 11-54-E-19
 DRAWING NO: Lancaster Unit 1H Well Plat
 SCALE: 1" = 1500'
 MINIMUM DEGREE OF ACCURACY:
 Submeter
 PROVEN SOURCE OF ELEVATION:
 WVDOT, Harrisville, WV

STATE OF WEST VIRGINIA
 DEPARTMENT OF ENVIRONMENTAL PROTECTION
OIL AND GAS DIVISION

DATE: February 11, 2020
 OPERATOR'S WELL NO. Lancaster 1H
 API WELL NO
47 - 095 - 02674
 STATE COUNTY PERMIT

WELL TYPE: OIL GAS LIQUID INJECTION WASTE DISPOSAL
 (IF GAS) PRODUCTION: STORAGE DEEP SHALLOW

LOCATION: ELEVATION: Proposed 1,014.5' Existing 1,033' WATERSHED: Outlet Middle Island Creek QUADRANGLE: _____

DISTRICT: Ellsworth COUNTY: Tyler

SURFACE OWNER: Michael J. & Melinda R. Hogue ACREAGE: 192.0

ROYALTY OWNER: Michael J. & Melinda R. Hogue; James F. Doan, et ux; Ridgetop Capital LP; Ruth E. Blake LEASE NO: _____ ACREAGE: 0.4343; 28.65; 0.70

PROPOSED WORK: DRILL CONVERT DRILL DEEPER FRACTURE OR STIMULATE PLUG OFF OLD FORMATION
 PERFORATE NEW FORMATION OTHER PHYSICAL CHANGE IN WELL (SPECIFY) BHL MOD

PLUG AND ABANDON CLEAN OUT AND REPLUG TARGET FORMATION: Marcellus Shale ESTIMATED DEPTH: 18,600' 6,900' TVD

WELL OPERATOR: Antero Resources Corporation DESIGNATED AGENT: Dianna Stamper - CT Corporation System
 ADDRESS: 1615 Wynkoop Street ADDRESS: 5400 D Big Tyler Road
Denver, CO 80202 Charleston, WV 25313

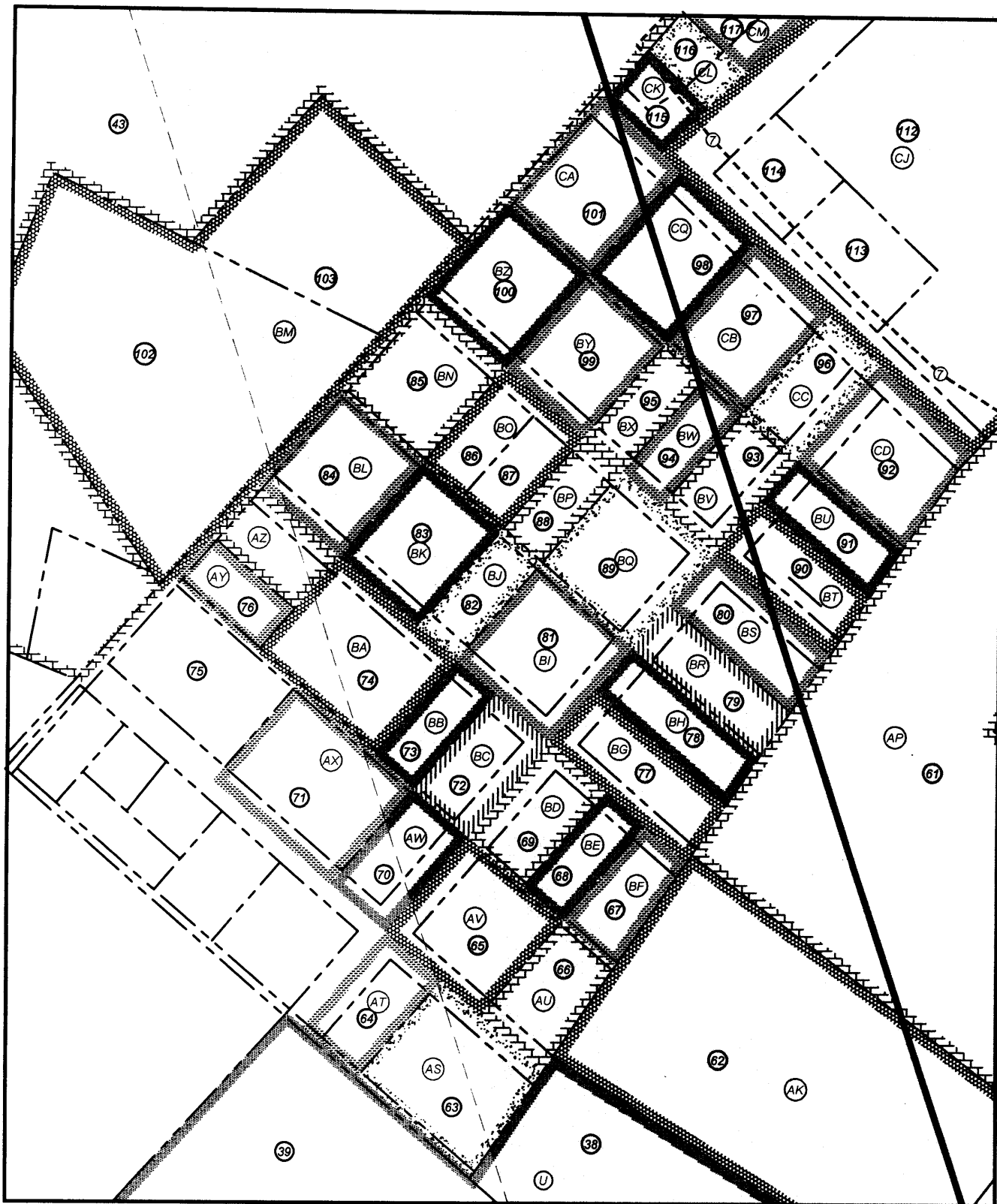

FILE NO: 11-54-E-19
 DRAWING NO: Lancaster Unit 1H Well Plat
 SCALE: 1" = 1500'
 MINIMUM DEGREE OF ACCURACY:
 Submeter
 PROVEN SOURCE OF ELEVATION:
 WVDOT, Harrisville, WV

STATE OF WEST VIRGINIA
 DEPARTMENT OF ENVIRONMENTAL PROTECTION
OIL AND GAS DIVISION

DATE: February 11, 2020
 OPERATOR'S WELL NO. Lancaster 1H
 API WELL NO
 47 - 095 - 02674
 STATE COUNTY PERMIT

WELL TYPE: OIL GAS LIQUID INJECTION WASTE DISPOSAL
 (IF GAS) PRODUCTION: STORAGE DEEP SHALLOW

LOCATION: ELEVATION: Existing 1,033' Proposed 1,014.5' WATERSHED: Outlet Middle Island Creek QUADRANGLE: _____
 DISTRICT: Ellsworth COUNTY: Tyler
 SURFACE OWNER: Michael J. & Melinda R. Hogue ACREAGE: 192.0
 ROYALTY OWNER: Michael J. & Melinda R. Hogue; James F. Doan, et ux; Ridgetop Capital LP; Ruth E. Blake LEASE NO: _____ ACREAGE: 0.16751; 0.19971; 0.16319; 41.425; 191.5; 81.33; 310.393; 11.318; 5.493; 47.016; 25.189; 23.964; 29.806; 3.0; 6.39; 0.19322; 0.21657; 0.1951; 0.05739; 0.4343; 28.65; 0.70

PROPOSED WORK: DRILL CONVERT DRILL DEEPER FRACTURE OR STIMULATE PLUG OFF OLD FORMATION
 PERFORATE NEW FORMATION OTHER PHYSICAL CHANGE IN WELL (SPECIFY) BHL MOD 6,900' TVD
 PLUG AND ABANDON CLEAN OUT AND REPLUG TARGET FORMATION: Marcellus Shale ESTIMATED DEPTH: 18,600' MD

WELL OPERATOR: Antero Resources Corporation DESIGNATED AGENT: Dianna Stamper - CT Corporation System
 ADDRESS: 1615 Wynkoop Street ADDRESS: 5400 D Big Tyler Road
 Denver, CO 80202 Charleston, WV 25313

Antero Resources
Well No. Lancaster Unit 1H
BHL MOD
Antero Resources Corporation

Page 4 of 4

Leases

AD	Robert C. Kramer
AE	Gary R. Davis
AF	Brian Scott Foland
AG	Bernard M. Hayes, et ux
AH	Robert L. Berry, et ux
AI	Bradley Baker
AJ	Frankie Dean Goudy, et ux
AK	Earnestine Pelikan & David Leasure
AL	Larry H. Kimble, et ux
AM	David I. Farhatt, et ux
AN	Lemuel Hugh Moore
AO	Jeffrey A. Lancaster, et ux
AP	Earnestine Pelikan
AQ	Melinda Leasure
AR	Earnestine Pelikan, et vir
AS	Bessie L. Matthews, et vir
AT	Betty Lou Hadley
AU	Betty Lou Hadley
AV	Betty Lou Hadley
AW	Betty Lou Hadley
AX	Stephen D. Ashley, et ux
AY	Martha J. Hayes, et vir
AZ	Betty Lou Hadley
BA	Betty Lou Hadley
BB	Betty Lou Smith
BC	Betty Hadley
BD	Laura June Smith
BE	Kathryn Knowlton
BF	Crystal Christophel
BG	Betty Lou Hadley
BH	Rodney Mack Hayes
BI	Betty Hadley
BJ	Betty Lou Hadley
BK	Donald E. Huffman
BL	Timothy Stanley, et ux
BM	David A. Tustin
BN	Nancy Glover
BO	William H. Eddy
BP	John Miller, et ux
BQ	John R. Miller, et ux
BR	Rodney Mack Hayes
BS	Rodney Mack Hayes
BT	Earl E. Turner
BU	Arvil Shane Matthews
BV	Thurl Wayne Jones
BW	Brenda Lee Oyster
BX	Brenda Lee Oyster
BY	James W. Chapman
BZ	Charles L. Roberts
CA	Robert E. Judge
CB	Carolyn Westfall Barnhart
CC	Charles J. Mead, et ux
CD	Anna Blanche Cline
CE	Upper Ohio Soil Conservation
CF	Jeffrey A. Watson, et ux
CG	John F. Stender, et ux
CH	Neil A. Archer II
CI	Clara Catherine Spencer Wells
CJ	Tyler County Board of Education
CK	James D. Hardesty
CL	Antero Resources Corporation
CM	Tyler County Commission
CN	Kathleen Ross Mansuetto
CO	Michael A. Lenz, et ux
CP	WV Division of Natural Resources
CQ	Sara J. Judge

ID	TM/Par	Owner	Bk/Pg	Acres
1	20-108	Michael J. & Melinda R. Hogue	348/404	192.00
2	26-46	Jay-Bee Production Company	420/97	286.04
3	26-46.14	Jay-Bee Production Company	420/97	8.69
4	26-46.12	Charles R. Holliday, et ux	306/665	3.238
5	26-46.3	Timothy Kanz	440/24	5.4
6	26-46.2	Robert E. Lee II, et al	408/122	5.135
7	26-46.7	Camille Patera	296/247	7.32
8	26-46.9	Eugene B. Johnson, Jr, et ux	351/160	5.00
9	26-46.6	Camille Patera	296/247	1.702
10	26-46.15	Camille Patera	296/247	3.722
11	26-46.1	Darrell L. Shrader	348/711	5.58
12	26-46.16	Jay-Bee Production Company	420/97	5.09
13	26-46.10	Leon & Drema Gailson	359/673	4.98
14	26-46.5	Richard Doty	493/673	13.14
15	26-21	Ryan Lee Walton, et ux	342/687	35.9
16	20-107	David L. & Kathy A. Lancaster	314/344	18.89
17	20-104	David Lancaster	210/505	57.004
18	20-105.1	Terry Lee Fiber	335/682	6.06
19	20-105	Joe & Shirley Varse	352/736	11.322
20	20-106	Eugene & Phyllis Howell	223/371	19.76
21	20-99	Pioneer Land Company, LLC	431/414	10
22	20-106.1	Lee Ann Hall	486/806	5.493
23	20-106.2	Nancy Forester	328/633	5.429
24	20-100	Eugene F. & Phyllis Howell	326/749	42.85
25	20-101	Henderson Cemetery	OS15/137	0.78
26	20-70	Nina Wise	WB25/700	3.91
27	20-69	Jerry Williams, et al	440/471	1.5
28	20-68	Barbara J. Davis	WB30/311	2.09
29	20-67	William M. & Janet S. Baker	175/391	2.10
30	20-100.1	Jacqueline E. Miller	375/626	4.202
31	20-93.5	Nina Smith & Mary Bennett	308/115	2.88
32	20-93.1	Vernon Stevens	423/703	2.14
33	20-93	Robert C. Kramer	547/650	23.964
34	20-54	William M. Baker, et ux	175/391	100.45
35	20-53	Clara Negie	344/51	8
36	20-57	William M. Baker, et ux	189/374	7.5
37	20-92	Charles & Doris Anderson	210/359	27
38	20-86	Ruth E. Blake	317/103	23.75
39	20-44.1	Ruth E. Blake	317/103	10.17
40	20-51.6	Brian & Sarah Carpenter	342/467	24.92
41	20-33	Lance M. & Tina R. Hickman	396/561	77.84
42	20-49	Samuel O. Wagner	327/411	3.37
43	20-46	Betty Tustin	350/386	29.66
44	20-33.3	Richard Fonner	415/796	18.5
45	20-93.7	Charles & Tara Templeton	234/790	4.05
46	20-93.3	Wanna Hayes	347/293	3.25
47	20-93.2	Brian Scott Foland	WB58/423	2
48	20-93.4	Brian Scott Foland	WB58/423	2
49	20-95	Bernard & Tammie Hayes	321/108	3.91
50	20-96	Robert L. & Dorothy L. Berry	230/37	2.416
51	20-54.1	Bradley Baker	355/823	2
52	20-94	Charles & Doris Anderson	217/398	2.806
53	20-52	Jeffery & Deborah Watson	270/234	1.03
54	20-90	F. Dean & Shirley Kimble	303/340	2.42
55	20-91	Larry H. & Shirley I. Kimble	212/435	1.13
56	20-89.2	David L. & Pamela C. Farhatt	375/1	0.848
57	20-51.2	John & Diana Stender	255/47	0.32
58	20-51.1	John & Diana Stender	255/47	2.04
59	20-89	John F. & Hailee Stender	538/343	0.92
60	20-89.1	Jeffrey A. Lancaster, et ux	348/471	1.18
61	20-87	Earnest Leasure, et al	275/579	6.39
62	20-86.1	Earnest Leasure, et al	321/160	3.37
63	20A-54	Bessie L. Mathews, et vir	521/634	0.46
64	20A-55	Roy & Betty Lou Hadley	350/341	0.17
65	20A-53	Deloris Gully	AR40/97	0.33
66	20A-52	Betty Lou Hadley	579/652	0.2433
67	20A-51.1	Crystal Christophel	WB19/379	0.16
68	20A-51	Shiri A. Henderson	WB19/379	0.17
69	20A-50	Laura June Smith	AR48/562	0.1653
70	20A14	Roy D. Hadley	322/696	0.17
71	20A-15	Stephen & Brenda J. Ashley	317/183	0.50
72	20A-20	Betty Hadley	470/683	0.1653
73	20A-19	Roy D. Hadley	WB23/305	0.17

ID	TM/Par	Owner	Bk/Pg	Acres
74	20A-18	Roy D. Hadley	WB23/305	0.66
75	20A-16	James M. Glover	330/197	0.50
76	20A-17	Christopher L. Hayes, et al	342/212	0.17
77	20A-49.1	Roy D. Hadley	299/37	0.24
78	20A-49	Rodney M. Hayes	353/649	0.48
79	20A-48	Rodney M. Hayes	353/649	0.22
80	20A-47	Rodney Mack Hayes	336/609	0.21
81	20A-21	Roy D. Hadley	317/647	0.33
82	20A-22	Roy D. Hadley	WB23/305	0.17
83	20A-23	Connie Sue Tanner	327/883	0.33
84	20A-24	Timothy & Tonya Stanley	581/792	0.33
85	20A-25	Nancy Glover	147/104	0.33
86	20A-26.1	Evelyn S. Smith	328/95	0.165
87	20A-26	Evelyn S. Smith	332/691	0.165
88	20A-27	John R. & Shirley R. Miller	227/273	0.17
89	20A-28	John R. & Shirley R. Miller	269/669	0.33
90	20A-46	Emily L. Eddy	336/590	0.20
91	20A-45	Arvil Shane Matthews	431/116	0.19
92	20A-44	Anna Blanche Cline	WB31/662	0.34
93	20A-29	Joe & Shirley Varse	361/88	0.17
94	20A-30	John M. Hammell, et al	WV37/331	0.17
95	20A-31	John M. Hammell, et al	WV37/331	0.17
96	20A-43	Charles J. & Donna Mead	344/588	0.17
97	20A-41	Carolyn Barnhart	348/286	0.34
98	20A-40	Barry W. & Linda K. Harter	288/516	0.36
99	20A-32	James W. Chapman	348/630	0.33
100	20A-33	Charles L. & Karen S. Roberts	306/558	0.55
101	20A-34	Robert E. Judge	545/765	0.37
102	20-46.1	Betty Tustin	WB45/156	2.476
103	20-47	Betty Tustin	WB45/156	1
104	20-87.2	David & Melinda Leasure	252/581	0.50
105	20-87.1	Earnestine & William Pelikan	242/631	0.77
106	20-88	Upper Ohio Soil Conservation Dist.	233/495	2.36
107	20-51.3	John & Diana Stender	269/180	2.04
108	20-51.5	Neil Archer	355/12	2.513
109	20-51.4	Clara Wells	342/464	2.512
110	20-51	Clara Wells	342/464	1.005
111	20-50	Thomas Wagner	356/410	0.93
112	20A-38	Tyler County BOE	211/575	2.5
113	20A-42	Tyler County BOE	175/181	0.22
114	20A-3	Tyler County BOE	143/292	0.26
115	20A-35	James D. Hardesty	372/186	0.06
116	20A-36	Tina M. Barnhart	373/828	0.08
117	20A-37	Tyler County Commission	332/574	0.50
118	20-48	Tyler County Commission	336/13	0.30
119	4-128	Patty K. Long	AR45/571	0.10
120	4-126	William Long	WB32/551	0.07
121	4-112	James A. White II	357/177	0.285
122	4-113	Patricia Hess	249/263	0.22
123	4-114	Donnie G. & Tawyna D. Rose	353/475	0.22
124	4-115	Kenneth I. Sinclair	342/566	0.22
125	4-120	Ann W. Galindo	WB25/479	0.44
126	4-121	Kenneth I. Sinclair	342/566	0.386
127	4-122	Joseph E. McLaughlin, et ux	432/294	0.276
128	4-125.1	James A. & Heidi M. Suter	354/511	0.66
129	4-125	Ann W. Galindo	WB25/479	0.88
130	20-23.1	Michael & Chris Lenz	323/732	5.517
131	20-23	Michael & Chris Lenz	313/216	4.595
132	20-25	Marshal McKinney	208/650	0.92
133	20-24	Leslie A. Henderson	312/293	0.34
134	20-26	Nancy Mercer	198/157	0.52
135	20-22	Nancy Mercer	WB32/425	0.34
136	20-32	Homer Lee Matthews	176/216	0.34
137	20-33.2	Homer Matthews	284/375	0.28
138	20-31	Larry & Barbara Lee	211/179	0.34
139	20-21	Nancy Mercer	WB32/425	0.34
140	20-109	Lorraine Weekley	AR49/717	0.24
141	20-27	Earl P. & Crucita Kendle	331/341	0.32
142	20-29.1	James Bemby	331/43	0.25
143	20-29	Maurine Hadley	167/69	0.34
144	20-28	Victor & Lorraine Weekley	280/422	0.23
145	20-30	Donald & Susan Smith	321/422	0.26
146	20-93.6	Robert C. Kramer	547/650	4.0

FILE NO: 11-54-E-19
DRAWING NO: Lancaster Unit 1H Well Plat
SCALE: 1" = 1500'
MINIMUM DEGREE OF ACCURACY:
Submeter
PROVEN SOURCE OF ELEVATION:
WVDOT, Harrisville, WV



DATE: February 11, 2020
OPERATOR'S WELL NO. Lancaster 1H
API WELL NO
47 - 095 - 02674
STATE COUNTY PERMIT

WELL TYPE: OIL GAS LIQUID INJECTION WASTE DISPOSAL
(IF GAS) PRODUCTION: STORAGE DEEP SHALLOW
Proposed 1,014.5'
LOCATION: ELEVATION: Existing 1,033' WATERSHED: Outlet Middle Island Creek QUADRANGLE: _____
DISTRICT: Ellsworth COUNTY: Tyler
SURFACE OWNER: Michael J. & Melinda R. Hogue; Sara J. Judge; James D. Hardesty; David A. Tustin; Robert E. Judge; Brenda Lee Oyster (2); Earnestine Pelikan; Rodney Mack Hayes (2); Earl E. Turner; Thurl Wayne Jones; Robert C. Kramer; Charles E. Anderson, et ux; Earnestine Pelikan & David Leasure; Joe & Shirley Varse; Leeman W. & Susan L. Mason; Eugene F. Howell, et ux (2); ACREAGE: 192.0
ROYALTY OWNER: Michael J. & Melinda R. Hogue; James F. Doan, et ux; Ridgetop Capital LP; Ruth E. Blake LEASE NO: _____ ACREAGE: 0.4343; 28.65; 0.70
PROPOSED WORK: DRILL CONVERT DRILL DEEPER FRACTURE OR STIMULATE PLUG OFF OLD FORMATION
 PERFORATE NEW FORMATION OTHER PHYSICAL CHANGE IN WELL (SPECIFY) BHL MOD 6,900' TVD
 PLUG AND ABANDON CLEAN OUT AND REPLUG TARGET FORMATION: Marcellus Shale ESTIMATED DEPTH: 18,600' MD

WELL OPERATOR: Antero Resources Corporation DESIGNATED AGENT: Dianna Stamper - CT Corporation System
ADDRESS: 1615 Wynkoop Street ADDRESS: 5400 D Big Tyler Road
Denver, CO 80202 Charleston, WV 25313