

Antero Resources
Well No. Lancaster Unit 2H
BHL MOD
Antero Resources Corporation



Legend

- ⊙ Proposed gas well
- ⊛ Monument, as noted
- ⊙ Existing Well, as noted
- ⊙ Existing Well, as noted
- Creek or Drain
- Existing Road
- Surface boundary (approx.)
- Interior surface tracts (approx.)

Page 1 of 4

8114' to Bottom Hole
 6,671' to Top Hole
 LATITUDE 39 - 30 - 00
 LONGITUDE 80 - 52 - 30

Notes:
 West Virginia Coordinate System of 1927, North Zone based upon Differential GPS Measurements.
 Well No. Lancaster Unit 2H Top Hole coordinates are
 N: 356,934.39' Latitude: 39°28'17.63"
 E: 1,605,337.15' Longitude: 80°53'53.06"
 Bottom Hole coordinates are
 N: 363,170.23' Latitude: 39°29'19.03"
 E: 1,603,893.90' Longitude: 80°54'12.70"
 UTM Zone 17, NAD 1983
 Top Hole Coordinates Bottom Hole Coordinates
 N: 4,369,122.268m N: 4,371,014.690m
 E: 508,781,959m E: 508,310.552m
 Plat orientation and corner and well references are based upon the grid north meridian.
 Well location references are based upon the magnetic meridian.

Bearing	Dist.
L1 S 48°35' E	1,402.4'
L2 S 27°25' E	1,529.7'
L3 N 72°56' W	901.1'
L4 N 07°33' W	1,454.7'
L5 S 40°57' E	1,453.8'

Notes:
 Well No. Lancaster Unit 2H
 UTM Zone 17, NAD 1927
 Top Hole Coordinates
 N: 14,333,647.86'
 E: 1,669,181.37'
 Point of Entry Coordinates
 N: 14,332,566.39'
 E: 1,670,152.11'
 Bottom Hole Coordinates
 N: 14,339,856.62'
 E: 1,667,634.76'

Leases

A	Michael J. & Melinda R. Hogue
B	Ridgetop Capital LP
C	James F. Doan, et ux
D	James F. Doan, et ux
E	Ryan L. Walton, et ux
F	David L. Lancaster, et ux
G	David L. Lancaster, et ux
H	Terry Lee Fiber
I	Joe & Shirley Varese
J	Eugene F. Howell, et ux
K	Leeman W. & Susan L. Mason
L	Eugene F. Howell, et ux
N	Nina Naomi Wise
O	Jerry Todd Williams
P	Barbara J. Davis
Q	William M. Baker
R	William M. Baker, et ux
S	Peter W. & Immagard E. Guenter, Joint Living Trust
T	BRC Appalachian Minerals I, LLC
U	Robert C. Kramer
V	Ruth E. Blake
W	Charles E. Anderson, et ux
X	John Valentour
Y	Clara Jane Glover
Z	Brian D. Carpenter, et ux
AA	Tustin Family Trust
AB	Samuel O. Wagner
AC	Richard A. Fonner, et ux

Continued on Page 4

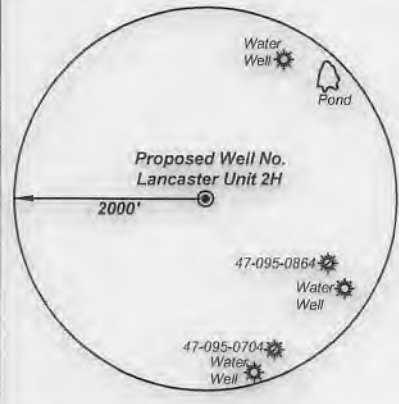
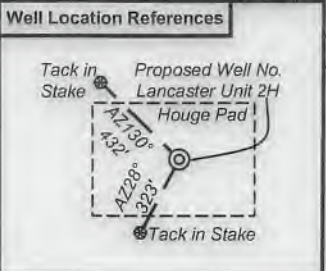
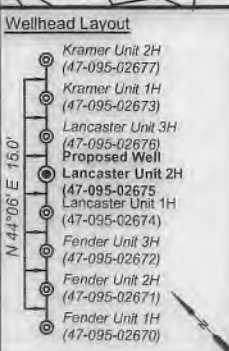

Note: 3 water wells and 1 pond were found within 2000' of proposed well. No occupied dwellings or buildings 2,500 square feet or larger used to house or shelter dairy cattle or poultry husbandry are located within 625' of the center of the well pad.

I, the undersigned, hereby certify that this plat is correct to the best of my knowledge and belief and shows all the information required by law and the rules issued and prescribed by the Department of Environmental Protection.

Bradley D. Miller
 Bradley D. Miller, P.S. 2167

FILE NO: 11-54-E-19
 DRAWING NO: Lancaster Unit 2H Well Plat
 SCALE: 1" = 1500'
 MINIMUM DEGREE OF ACCURACY: Submeter
 PROVEN SOURCE OF ELEVATION: WVDOT, Harrisville, WV

STATE OF WEST VIRGINIA
 DEPARTMENT OF ENVIRONMENTAL PROTECTION
OIL AND GAS DIVISION

DATE: March 2 2020
 OPERATOR'S WELL NO. Lancaster 2H
 API WELL NO
 47 - 095 - 02675 MOD
 STATE COUNTY PERMIT

WELL TYPE: OIL GAS LIQUID INJECTION WASTE DISPOSAL
 (IF GAS) PRODUCTION: STORAGE DEEP SHALLOW
 Proposed 1,014.5'
 LOCATION: ELEVATION: Existing 1,033' WATERSHED: Outlet Middle Island Creek QUADRANGLE: Middlebourne
 DISTRICT: Ellsworth COUNTY: Tyler
 SURFACE OWNER: Michael J. & Melinda R. Hogue WV Division of Natural Resources; Robert C. Kramer; WV Dept. of Transportation, DOH; John Valentour; Eugene F. Howell, et ux; Charles E. Anderson, et ux; Bernard M. Hayes, et ux; ACREAGE: 192.0 6.95064; 89.53875;
 ROYALTY OWNER: Michael J. & Melinda R. Hogue; James F. Doan, et ux; Ridgetop Capital LP. LEASE NO: ACREAGE: 7.16; 23.964; 28.54
 PROPOSED WORK: DRILL CONVERT DRILL DEEPER FRACTURE OR STIMULATE PLUG OFF OLD FORMATION
 PERFORATE NEW FORMATION OTHER PHYSICAL CHANGE IN WELL (SPECIFY) BHL MOD
 PLUG AND ABANDON CLEAN OUT AND REPLUG TARGET FORMATION: Marcellus Shale ESTIMATED DEPTH: 6,900' TVD 16,500' MD

WELL OPERATOR: Antero Resources Corporation DESIGNATED AGENT: Dianna Stamper - CT Corporation System
 ADDRESS: 1615 Wynkoop Street ADDRESS: 5400 D Big Tyler Road
 Denver, CO 80202 Charleston, WV 25313

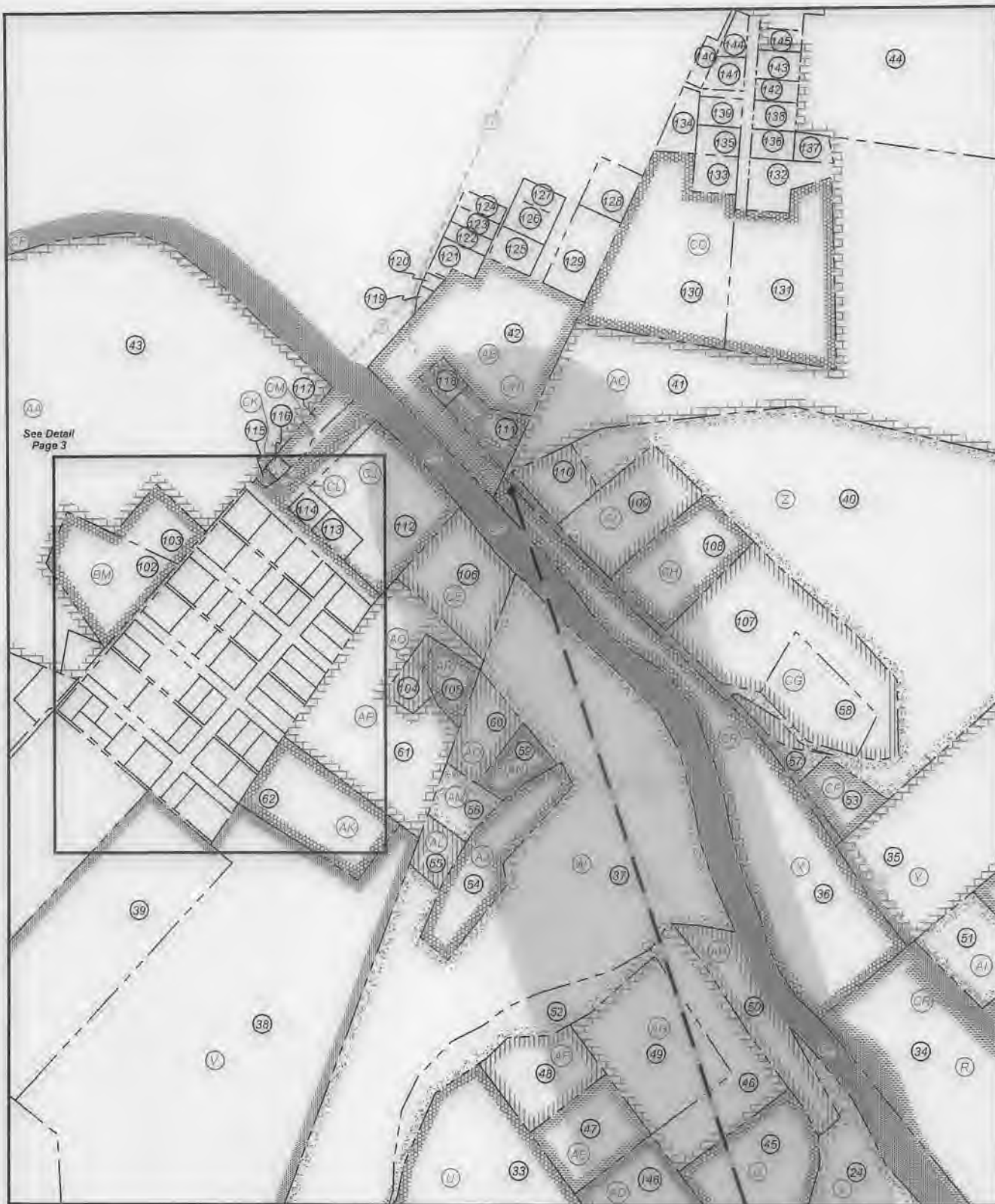

See Detail
Page 3

FILE NO: 11-54-E-19
 DRAWING NO: Lancaster Unit 2H Well Plat
 SCALE: 1" = 1500'
 MINIMUM DEGREE OF ACCURACY:
 Submeter
 PROVEN SOURCE OF ELEVATION:
 WVDOT, Harrisville, WV

STATE OF WEST VIRGINIA
 DEPARTMENT OF ENVIRONMENTAL PROTECTION
OIL AND GAS DIVISION

DATE: March 2 20 20

OPERATOR'S WELL NO. Lancaster 2H

API WELL NO

47 - 095 - 02675 MOD
 STATE COUNTY PERMIT

WELL TYPE: OIL GAS LIQUID INJECTION WASTE DISPOSAL
 (IF GAS) PRODUCTION: STORAGE DEEP SHALLOW

LOCATION: ELEVATION: Existing 1,033' Proposed 1,014.5' WATERSHED: Outlet Middle Island Creek QUADRANGLE: Middlebourne

DISTRICT: Ellsworth COUNTY: Tyler

SURFACE OWNER: Michael J. & Melinda R. Hogue WY Division of Natural Resources: Robert C. Kramer; WV Dept. of Transportation, DOH; John Valentour; Eugene F. Howell, et ux; Charles E. Anderson, et ux; Bernard M. Hayes, et ux; ACREAGE: 192.0 191.5; 81.33; 47.016; 310.393; 29.806; 6 95064; 89,53875;

ROYALTY OWNER: Michael J. & Melinda R. Hogue; James F. Doan, et ux; Ridgetop Capital LP; LEASE NO: ACREAGE: 7.16; 23.964; 28.54

PROPOSED WORK: DRILL CONVERT DRILL DEEPER FRACTURE OR STIMULATE PLUG OFF OLD FORMATION
 PERFORATE NEW FORMATION OTHER PHYSICAL CHANGE IN WELL (SPECIFY) BHL MOD

PLUG AND ABANDON CLEAN OUT AND REPLUG TARGET FORMATION: Marcellus Shale ESTIMATED DEPTH: 16,500' MD 6,900' TVD

WELL OPERATOR: Antero Resources Corporation DESIGNATED AGENT: Dianna Stamper - CT Corporation System

ADDRESS: 1615 Wynkoop Street ADDRESS: 5400 D Big Tyler Road
 Denver, CO 80202 Charleston, WV 25313



FILE NO: 11-54-E-19
DRAWING NO: Lancaster Unit 2H Well Plat
SCALE: 1" = 1500'
MINIMUM DEGREE OF ACCURACY:
Submeter
PROVEN SOURCE OF ELEVATION:
WVDOT, Harrisville, WV



DATE: March 2 2020
OPERATOR'S WELL NO. Lancaster 2H
API WELL NO
47 - 095 - 02675
STATE COUNTY PERMIT

WELL TYPE: OIL GAS LIQUID INJECTION WASTE DISPOSAL
(IF GAS) PRODUCTION: STORAGE DEEP SHALLOW
Proposed 1,014.5'
LOCATION: ELEVATION: Existing 1,033' WATERSHED: Outlet Middle Island Creek QUADRANGLE: Middlebourne
DISTRICT: Ellsworth COUNTY: Tyler
SURFACE OWNER: Michael J. & Melinda R. Hogue WV Division of Natural Resources; Robert C. Kramer; WV Dept. of Transportation, DOH; John Valentour; Eugene F. Howell, et ux; Charles E. Anderson, et ux; Bernard M. Hayes, et ux; ACREAGE: 192.0 6,95064; 89,63875; 191.5; 81.23; 47,016; 310.393; 29,806;
ROYALTY OWNER: Michael J. & Melinda R. Hogue; James F. Doan, et ux; Ridgeway Capital LP; LEASE NO: ACREAGE: 7.16, 23.964, 28.54
PROPOSED WORK: DRILL CONVERT DRILL DEEPER FRACTURE OR STIMULATE PLUG OFF OLD FORMATION
 PERFORATE NEW FORMATION OTHER PHYSICAL CHANGE IN WELL (SPECIFY) BHL MOD 6,900' TVD
 PLUG AND ABANDON CLEAN OUT AND REPLUG TARGET FORMATION: Marcellus Shale ESTIMATED DEPTH: 16,500' MD

WELL OPERATOR: Antero Resources Corporation DESIGNATED AGENT: Dianna Stamper - CT Corporation System
ADDRESS: 1615 Wynkoop Street ADDRESS: 5400 D Big Tyler Road
Denver, CO 80202 Charleston, WV 25313

