

I, the undersigned, hereby certify that this plat is correct to the best of my knowledge and belief and shows all the information required by law and the rules issued and prescribed by the Department of Environmental Protection.

*Bradley D. Miller*  
Bradley D. Miller, P.S. 2167

04/02/2021

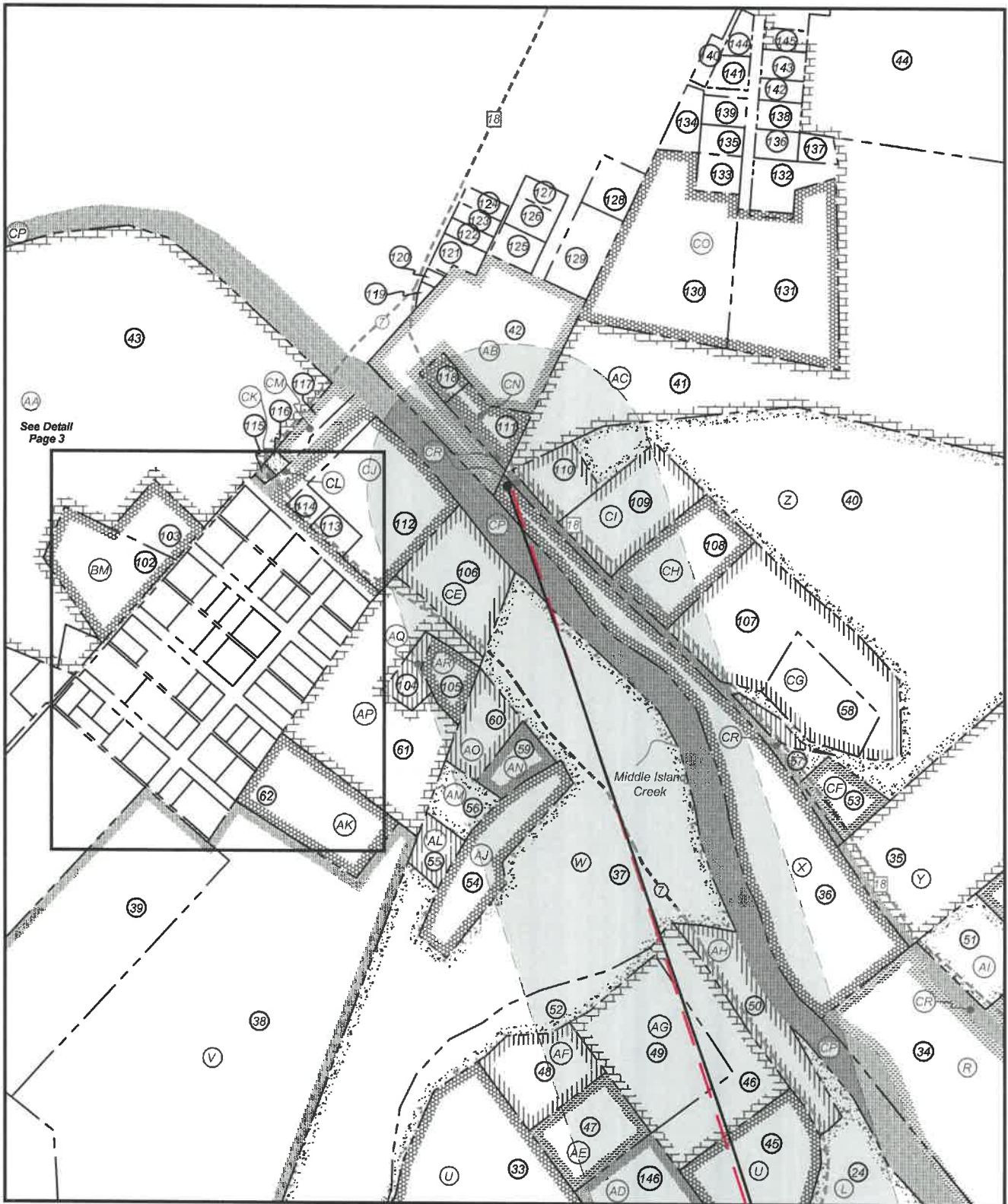

FILE NO: 11-54-E-19  
 DRAWING NO: Lancaster Unit 2H As-Drilled  
 SCALE: 1" = 1500'  
 MINIMUM DEGREE OF ACCURACY:  
 Submeter  
 PROVEN SOURCE OF ELEVATION:  
 WVDOT, Harrisville, WV

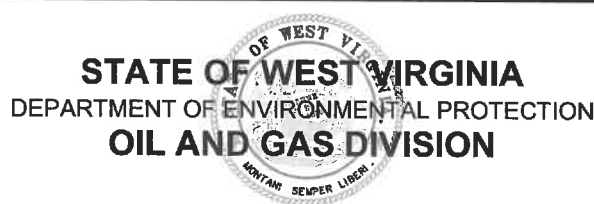

DATE: December 30 2020  
 OPERATOR'S WELL NO. Lancaster 2H  
 API WELL NO  
 47 - 095 - 02675  
 STATE COUNTY PERMIT

WELL TYPE:  OIL  GAS  LIQUID INJECTION  WASTE DISPOSAL  
 (IF GAS) PRODUCTION:  STORAGE  DEEP  SHALLOW

LOCATION: ELEVATION: As-Built 1,015' WATERSHED: Outlet Middle Island Creek QUADRANGLE: Middlebourne  
 DISTRICT: Ellsworth COUNTY: Tyler

SURFACE OWNER: Michael J. & Melinda R. Hogue Robert C. Kramer; John Valentour; WV Division of Natural Resources; Eugene F. Howell, et ux; Charles E. Anderson, et ux; Bernard M. Hayes, et ux; ACREAGE: 192.0  
 ROYALTY OWNER: Michael J. & Melinda R. Hogue; James F. Doan, et ux; Ridgeway Capital LP: LEASE NO: ACREAGE: 7.16; 23.964; 28.54

PROPOSED WORK:  DRILL  CONVERT  DRILL DEEPER  FRACTURE OR STIMULATE  PLUG OFF OLD FORMATION  
 PERFORATE NEW FORMATION  OTHER PHYSICAL CHANGE IN WELL (SPECIFY) As-Drilled 6,406' TVD  
 PLUG AND ABANDON  CLEAN OUT AND REPLUG TARGET FORMATION: Marcellus Shale ESTIMATED DEPTH: 14,509' MD

WELL OPERATOR: Antero Resources Corporation DESIGNATED AGENT: Dianna Stamper - CT Corporation System  
 ADDRESS: 1615 Wynkoop Street ADDRESS: 5400 D Big Tyler Road  
 Denver, CO 80202 Charleston, WV 25313

04/02/2021

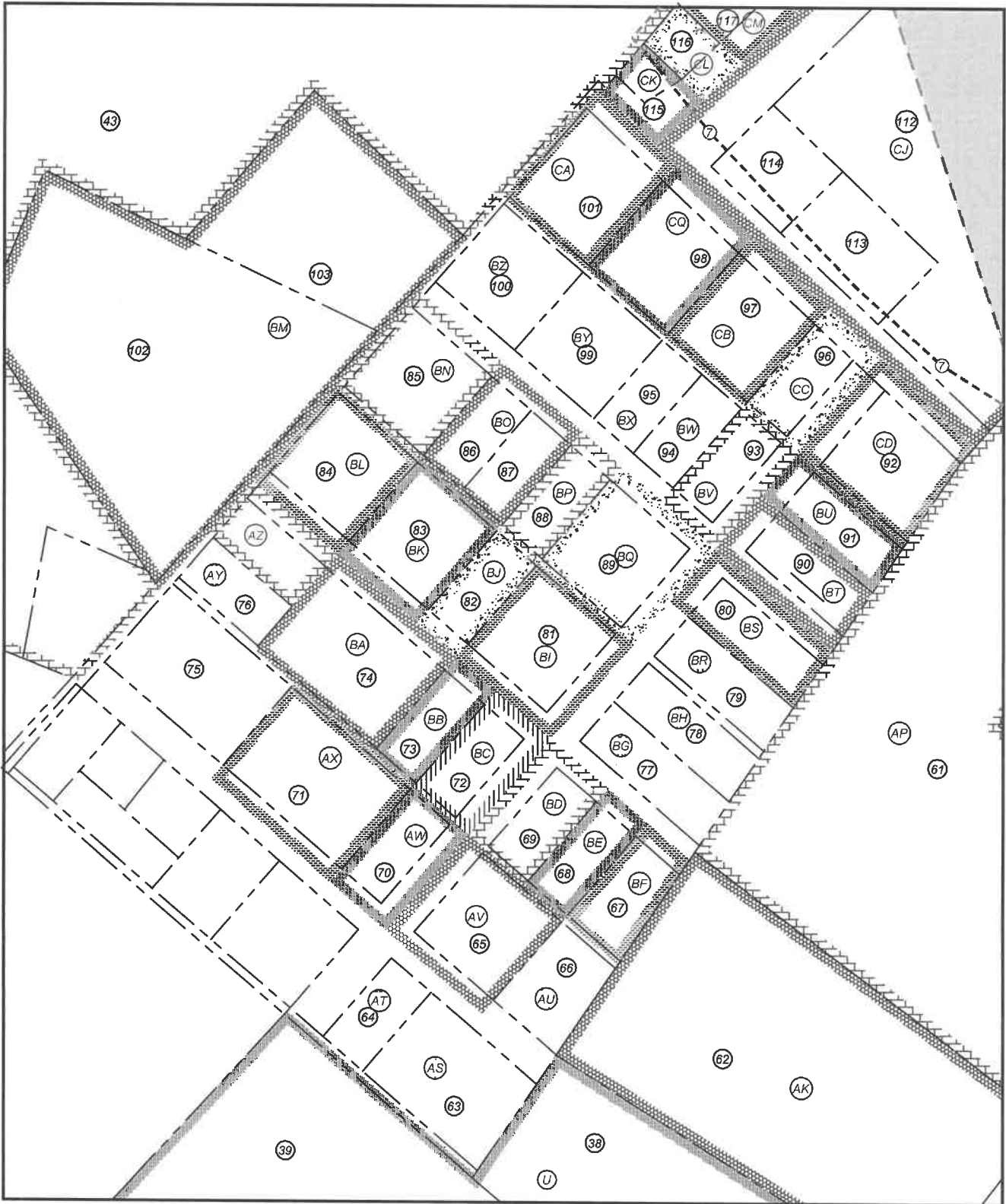

FILE NO: 11-54-E-19  
 DRAWING NO: Lancaster Unit 2H As-Drilled  
 SCALE: 1" = 1500'  
 MINIMUM DEGREE OF ACCURACY:  
Submeter  
 PROVEN SOURCE OF ELEVATION:  
WVDOT, Harrisville, WV



DATE: December 30 2020  
 OPERATOR'S WELL NO. Lancaster 2H  
 API WELL NO  
47 - 095 - 02675  
 STATE COUNTY PERMIT

WELL TYPE:  OIL  GAS  LIQUID INJECTION  WASTE DISPOSAL  
 (IF GAS) PRODUCTION:  STORAGE  DEEP  SHALLOW

LOCATION: ELEVATION: As-Built 1,015' WATERSHED: Outlet Middle Island Creek QUADRANGLE: Middlebourne  
 DISTRICT: Ellsworth COUNTY: Tyler

SURFACE OWNER: Michael J. & Melinda R. Hogue Robert C. Kramer; John Valentour; WV Division of Natural Resources; Eugene F. Howell, et ux; Charles E. Anderson, et ux; Bernard M. Hayes, et ux; 04/02/2021  
 ROYALTY OWNER: Michael J. & Melinda R. Hogue; James F. Doan, et ux; Ridgetop Capital LP; LEASE NO: \_\_\_\_\_ ACREAGE: 192.0 191.5; 81.33; 47.016; 310.393; 29.806; 7.16; 23.964; 28.54

PROPOSED WORK:  DRILL  CONVERT  DRILL DEEPER  FRACTURE OR STIMULATE  PLUG OFF OLD FORMATION  
 PERFORATE NEW FORMATION  OTHER PHYSICAL CHANGE IN WELL (SPECIFY) As-Drilled  
 PLUG AND ABANDON  CLEAN OUT AND REPLUG TARGET FORMATION: Marcellus Shale ESTIMATED DEPTH: 14,509' MD 6,406' TVD

WELL OPERATOR: Antero Resources Corporation DESIGNATED AGENT: Dianna Stamper - CT Corporation System  
 ADDRESS: 1615 Wynkoop Street ADDRESS: 5400 D Big Tyler Road  
Denver, CO 80202 Charleston, WV 25313

**Antero Resources**  
**Well No. Lancaster Unit 2H**  
**As-Drilled**  
**Antero Resources Corporation**

Page 4 of 4

**Leases**

AD	Robert C. Kramer
AE	Gary R. Davis
AF	Brian Scott Foland
AG	Bernard M. Hayes, et ux
AH	Robert L. Berry, et ux
AI	Bradley Baker
AJ	Frankie Dean Goudy, et ux
AK	Earnestine Pelikan & David Leasure
AL	Larry H. Kimble, et ux
AM	David I. Farhatt, et ux
AN	Lemuel Hugh Moore
AO	Jeffrey A. Lancaster, et ux
AP	Earnestine Pelikan
AQ	Melinda Leasure
AR	Earnestine Pelikan, et vir
AS	Bessie L. Matthews, et vir
AT	Betty Lou Hadley
AU	Betty Lou Hadley
AV	Betty Lou Hadley
AW	Betty Lou Hadley
AX	Stephen D. Ashley, et ux
AY	Martha J. Hayes, et vir
AZ	Betty Lou Hadley
BA	Betty Lou Hadley
BB	Betty Lou Smith
BC	Betty Hadley
BD	Laura June Smith
BE	Kathryn Knowlton
BF	Crystal Christophel
BG	Betty Lou Hadley
BH	Rodney Mack Hayes
BI	Betty Hadley
BJ	Betty Lou Hadley
BK	Donald E. Huffman
BL	Timothy Stanley, et ux
BM	David A. Tustin
BN	Nancy Glover
BO	William H. Eddy
BP	John Miller, et ux
BQ	John R. Miller, et ux
BR	Rodney Mack Hayes
BS	Rodney Mack Hayes
BT	Earl E. Turner
BV	Avril Shane Matthews
BW	Thurl Wayne Jones
BX	Brenda Lee Oyster
BY	Brenda Lee Oyster
BZ	James W. Chapman
CA	Charles L. Roberts
CB	Robert E. Judge
CC	Carolyn Westfall Barnhart
CD	Charles J. Mead, et ux
CE	Anna Blanche Cline
CF	Upper Ohio Soil Conservation
CG	Jeffrey A. Watson, et ux
CH	John F. Stender, et ux
CI	Neil A. Archer II
CJ	Clara Catherine Spencer Wells
CK	Tyler County Board of Education
CL	James D. Hardesty
CM	Antero Resources Corporation
CN	Tyler County Commission
CO	Kathleen Ross Mansueto
CP	Michael A. Lenz, et ux
CQ	WV Division of Natural Resources
CR	Sara J. Judge
	WV Dept. of Transportation, DOH

ID	TM/Par	Owner	Bk/Pg	Acres
1	20-108	Michael J. & Melinda R. Hogue	348/404	192.00
2	26-46	Jay-Bee Production Company	420/97	286.04
3	26-46.14	Jay-Bee Production Company	420/97	8.69
4	26-46.12	Charles R. Holliday, et ux	306/665	3.238
5	26-46.3	Timothy Kanz	440/24	5.4
6	26-46.2	Robert E. Lee II, et al	408/122	5.135
7	26-46.7	Camille Patera	296/247	7.32
8	26-46.9	Eugene B. Johnson, Jr, et ux	351/160	5.00
9	26-46.6	Camille Patera	296/247	1.702
10	26-46.15	Camille Patera	296/247	3.722
11	26-46.1	Darrell L. Shrader	348/711	5.58
12	26-46.16	Jay-Bee Production Company	420/97	5.09
13	26-46.10	Leon & Drema Gailson	359/673	4.98
14	26-46.5	Richard Doty	493/673	13.14
15	26-21	Ryan Lee Walton, et ux	342/687	35.9
16	20-107	David L. & Kathy A. Lancaster	314/344	18.89
17	20-104	David Lancaster	210/505	57.004
18	20-105.1	Terry Lee Fiber	335/682	6.06
19	20-105	Joe & Shirley Varse	352/736	11.322
20	20-106	Eugene & Phyllis Howell	223/371	19.76
21	20-99	Pioneer Land Company, LLC	431/414	10
22	20-106.1	Lee Ann Hall	486/806	5.493
23	20-106.2	Nancy Forester	328/633	5.429
24	20-100	Eugene F. & Phyllis Howell	326/749	42.85
25	20-101	Henderson Cemetery	OS15/137	0.78
26	20-70	Nina Wise	WB25/700	3.91
27	20-69	Jerry Williams, et al	440/471	1.5
28	20-68	Barbara J. Davis	WB30/311	2.09
29	20-67	William M. & Janet S. Baker	175/391	2.10
30	20-100.1	Jacqueline E. Miller	375/626	4.202
31	20-93.5	Nina Smith & Mary Bennett	308/115	2.88
32	20-93.1	Vernon Stevens	423/703	2.14
33	20-93	Robert C. Kramer	547/650	23.964
34	20-54	William M. Baker, et ux	175/391	100.45
35	20-53	Clara Negie	344/51	8
36	20-57	William M. Baker, et ux	189/374	7.5
37	20-92	Charles & Doris Anderson	210/359	27
38	20-86	Ruth E. Blake	317/103	23.75
39	20-44.1	Ruth E. Blake	317/103	10.17
40	20-51.6	Brian & Sarah Carpenter	342/467	24.92
41	20-33	Lance M. & Tina R. Hickman	396/561	77.84
42	20-49	Samuel O. Wagner	327/411	3.37
43	20-46	Betty Tustin	350/386	29.66
44	20-33.3	Richard Fonner	415/796	18.5
45	20-93.7	Charles & Tara Templeton	234/790	4.05
46	20-93.3	Wanna Hayes	347/293	3.25
47	20-93.2	Brian Scott Foland	WB58/423	2
48	20-93.4	Brian Scott Foland	WB58/423	2
49	20-95	Bernard & Tammie Hayes	321/108	3.91
50	20-96	Robert L. & Dorothy L. Berry	230/37	2.416
51	20-54.1	Bradley Baker	355/823	2
52	20-94	Charles & Doris Anderson	217/398	2.806
53	20-52	Jeffery & Deborah Watson	270/234	1.03
54	20-90	F. Dean & Shirley Kimble	303/340	2.42
55	20-91	Larry H. & Shirley I. Kimble	212/435	1.13
56	20-89.2	David L. & Pamela C. Farhatt	375/1	0.848
57	20-51.2	John & Diana Stender	255/47	0.32
58	20-51.1	John & Diana Stender	255/47	2.04
59	20-89	John F. & Hailie Stender	538/343	0.92
60	20-89.1	Jefferey A. Lancaster, et ux	348/471	1.18
61	20-87	Earnest Leasure, et al	275/579	6.39
62	20-86.1	Earnest Leasure, et al	321/160	3.37
63	20A-54	Bessie L. Mathews, et vir	521/634	0.46
64	20A-55	Roy & Betty Lou Hadley	350/341	0.17
65	20A-53	Deloris Gulley	AR40/97	0.33
66	20A-52	Betty Lou Hadley	579/652	0.2433
67	20A-51.1	Crystal Christophel	WB19/379	0.16
68	20A-51	Shiri A. Henderson	WB19/379	0.17
69	20A-50	Laura June Smith	AR48/562	0.1653
70	20A14	Roy D. Hadley	322/696	0.17
71	20A-15	Stephen & Brenda J. Ashley	317/183	0.50
72	20A-20	Betty Hadley	470/683	0.1653
73	20A-19	Roy D. Hadley	WB23/305	0.17

ID	TM/Par	Owner	Bk/Pg	Acres
74	20A-18	Roy D. Hadley	WB23/305	0.66
75	20A-16	James M. Glover	330/197	0.50
76	20A-17	Christopher L. Hayes, et al	342/212	0.17
77	20A-49.1	Roy D. Hadley	299/37	0.24
78	20A-49	Rodney M. Hayes	353/649	0.48
79	20A-48	Rodney M. Hayes	353/649	0.22
80	20A-47	Rodney Mack Hayes	336/609	0.21
81	20A-21	Roy D. Hadley	317/647	0.33
82	20A-22	Roy D. Hadley	WB23/305	0.17
83	20A-23	Connie Sue Tanner	327/883	0.33
84	20A-24	Timothy & Tonya Stanley	581/792	0.33
85	20A-25	Nancy Glover	147/104	0.33
86	20A-26	Evelyn S. Smith	328/95	0.165
87	20A-26.1	Evelyn S. Smith	332/691	0.165
88	20A-27	John R. & Shirley R. Miller	227/273	0.17
89	20A-28	John R. & Shirley R. Miller	269/669	0.33
90	20A-46	Emily L. Eddy	336/590	0.20
91	20A-45	Arvit Shane Matthews	431/116	0.19
92	20A-44	Anna Blanche Cline	WB31/662	0.34
93	20A-29	Joe & Shirley Varse	361/88	0.17
94	20A-30	John M. Hammell, et al	WB37/331	0.17
95	20A-31	John M. Hammell, et al	WB37/331	0.17
96	20A-43	Charles J. & Donna Mead	344/588	0.17
97	20A-41	Carolyn Barnhart	348/286	0.34
98	20A-40	Barry W. & Linda K. Harter	288/516	0.36
99	20A-32	James W. Chapman	348/630	0.33
100	20A-33	Charles L. & Karen S. Roberts	306/558	0.55
101	20A-34	Robert E. Judge	545/765	0.37
102	20-46.1	Betty Tustin	WB45/156	2.476
103	20-47	Betty Tustin	WB45/156	1
104	20-87.2	David & Melinda Leasure	252/581	0.50
105	20-87.1	Earnestine & William Pelikan	242/631	0.77
106	20-88	Upper Ohio Soil Conservation Dist.	233/495	2.36
107	20-51.3	John & Diana Stender	269/180	2.04
108	20-51.5	Neil Archer	355/12	2.513
109	20-51.4	Clara Wells	342/464	2.512
110	20-51	Clara Wells	342/464	1.005
111	20-50	Thomas Wagner	356/410	0.93
112	20A-38	Tyler County BOE	211/575	2.5
113	20A-42	Tyler County BOE	175/181	0.22
114	20A-3	Tyler County BOE	143/292	0.26
115	20A-35	James D. Hardesty	372/186	0.06
116	20A-36	Tina M. Barnhart	373/828	0.08
117	20A-37	Tyler County Commission	332/574	0.50
118	20-48	Tyler County Commission	336/13	0.30
119	4-128	Patty K. Long	AR45/571	0.10
120	4-126	William Long	WB32/551	0.07
121	4-112	James A. White II	357/177	0.285
122	4-113	Patricia Hess	249/263	0.22
123	4-114	Donnie G. & Tawyna D. Rose	353/475	0.22
124	4-115	Kenneth I. Sinclair	342/566	0.22
125	4-120	Ann W. Galindo	WB25/479	0.44
126	4-121	Kenneth I. Sinclair	342/566	0.386
127	4-122	Joseph E. McLaughlin, et ux	432/294	0.276
128	4-125.1	James A. & Heidi M. Suter	354/511	0.66
129	4-125	Ann W. Galindo	WB25/479	0.88
130	20-23.1	Michael & Chris Lenz	323/732	5.517
131	20-23	Michael & Chris Lenz	313/216	4.595
132	20-25	Marshal McKinney	208/650	0.92
133	20-24	Leslie A. Henderson	312/293	0.34
134	20-26	Nancy Mercer	198/157	0.52
135	20-22	Nancy Mercer	WB32/425	0.34
136	20-32	Homer Lee Matthews	176/216	0.34
137	20-33.2	Homer Matthews	284/375	0.28
138	20-31	Larry & Barbara Lee	211/179	0.34
139	20-21	Nancy Mercer	WB32/425	0.34
140	20-109	Lorraine Weekley	AR49/717	0.24
141	20-27	Earl P. & Crucita Kendle	331/341	0.32
142	20-29.1	James Bembry	331/43	0.25
143	20-29	Maurine Hadley	167/69	0.34
144	20-28	Victor & Lorraine Weekley	280/422	0.23
145	20-30	Donald & Susan Smith	321/422	0.26
146	20-93.6	Robert C. Kramer	547/650	4.0

FILE NO: 11-54-E-19  
DRAWING NO: Lancaster Unit 2H As-Drilled  
SCALE: 1" = 1500'  
MINIMUM DEGREE OF ACCURACY:  
Submeter  
PROVEN SOURCE OF ELEVATION:  
WVDOT, Harrisville, WV



DATE: December 30 2020  
OPERATOR'S WELL NO. Lancaster 2H  
API WELL NO  
47 - 095 - 02675  
STATE COUNTY PERMIT

WELL TYPE:  OIL  GAS  LIQUID INJECTION  WASTE DISPOSAL  
(IF GAS) PRODUCTION:  STORAGE  DEEP  SHALLOW

LOCATION: ELEVATION: As-Built 1,015' WATERSHED: Outlet Middle Island Creek QUADRANGLE: Middlebourne  
DISTRICT: Ellsworth COUNTY: Tyler

SURFACE OWNER: Michael J. & Melinda R. Hogue Robert C. Kramer; John Valentour; WV Division of Natural Resources; Eugene F. Howell, et ux; Charles E. Anderson, et ux; Bernard M. Hayes, et ux; ACREAGE: 192.0  
ROYALTY OWNER: Michael J. & Melinda R. Hogue; James F. Doan, et ux; Ridgetop Capital LP; LEASE NO: ACREAGE: 7.16; 23.964; 28.54

PROPOSED WORK:  DRILL  CONVERT  DRILL DEEPER  FRACTURE OR STIMULATE  PLUG OFF OLD FORMATION  
 PERFORATE NEW FORMATION  OTHER PHYSICAL CHANGE IN WELL (SPECIFY) As-Drilled 6,406' TVD  
 PLUG AND ABANDON  CLEAN OUT AND REPLUG TARGET FORMATION: Marcellus Shale ESTIMATED DEPTH: 14,509' MD

WELL OPERATOR: Antero Resources Corporation DESIGNATED AGENT: Dianna Stamper - CT Corporation System  
ADDRESS: 1615 Wynkoop Street ADDRESS: 5400 D Big Tyler Road  
Denver, CO 80202 Charleston, WV 25313

04/02/2021