

12,783' to Bottom Hole

11,632' to Top Hole

LATITUDE 39 - 30 - 00

LONGITUDE 80 - 55 - 00

2,217' to Top Hole
4,594' to Bottom Hole

Antero Resources Well No. Eldorado 2H

Antero Resources Corporation



Top Hole 7.5' Spot

Legend	
	Proposed gas well
	Monument, as noted
	Existing Well, as noted
	Creek or Drain
	Road
	Surface boundary (approx.)
	Interior surface tracts (approx.)
	District Line

Notes
West Virginia Coordinate System of 1927, North Zone based upon Differential GPS Measurements. Well No. Eldorado Unit 2H Top Hole coordinates are N: 365,155.26' Latitude: 39°29'36.25" E: 1,588,620.18' Longitude: 80°57'27.91" Bottom Hole coordinates are N: 362,778.83' Latitude: 39°29'12.58" E: 1,587,468.53' Longitude: 80°57'42.11" UTM Zone 17, NAD 1983
Top Hole Coordinates Bottom Hole Coordinates
N: 4,371,541.625m N: 4,370,811.768m
E: 503,647.274m E: 503,308.510m
Plat orientation and corner and well references are based upon the grid north meridian. Well location references are based upon the magnetic meridian.

Norma R. Spencer Trustee of the Allen P. Spencer Living Trust Lease
Gary C. & Maryjane Richards Lease

LINCOLN DIST.

Eldon J. & Ruth A. Helman 383/761 21.0 Ac.

Eldon J. & Ruth A. Helman 383/761 83.13 Ac.

Eldon J. & Ruth A. Helman Lease

Eldon J. & Ruth A. Helman 383/761 96.82 Ac.

Notes:
Well No. Eldorado Unit 2H UTM Zone 17, NAD 1927
Top Hole Coordinates N: 14,341,585.81' E: 1,652,335.28'
Point of Entry Coordinates N: 14,340,890.04' E: 1,650,637.77'
Bottom Hole Coordinates N: 14,339,191.30' E: 1,651,223.85'

Wellhead Layout (NTS)

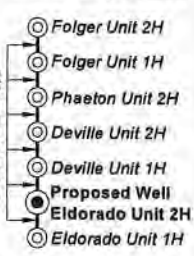

Well Location References (NTS)

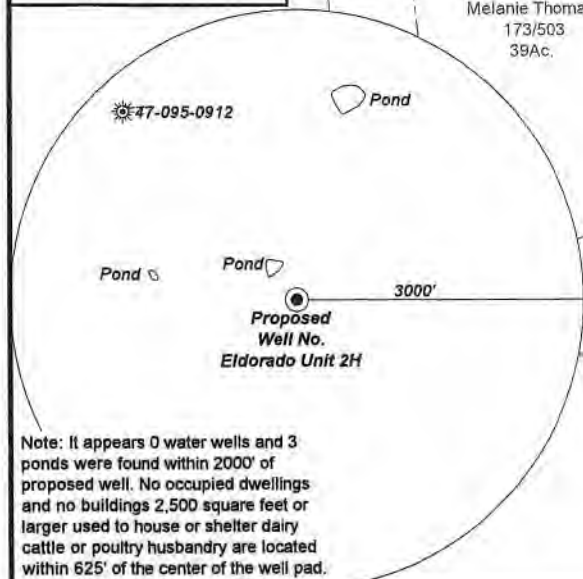
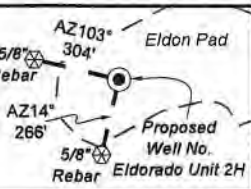

	Bearing	Dist.
L1	N 21°44' E	783.8'
L2	N 56°32' E	700.3'
L3	N 67°22' E	1,374.2'
L4	S 20°21' W	992.3'
L5	S 68°40' W	1,835.2'

I, the undersigned, hereby certify that this plat is correct to the best of my knowledge and belief and shows all the information required by law and the rules issued and prescribed by the Department of Environmental Protection.

Bradley D. Miller
Bradley D. Miller, P.S. 2167



SEAL

FILE NO: 35-54-E-19
DRAWING NO: Eldorado 2H Well Plat
SCALE: 1" = 1000'
MINIMUM DEGREE OF ACCURACY: Submeter
PROVEN SOURCE OF ELEVATION: WVDOT, Harrisville, WV

STATE OF WEST VIRGINIA
DEPARTMENT OF ENVIRONMENTAL PROTECTION
OIL AND GAS DIVISION

DATE: January 3 20 20
OPERATOR'S WELL NO. Eldorado Unit 2H
API WELL NO. H0A
47 - 095 - 02682
STATE COUNTY PERMIT

WELL TYPE: OIL GAS LIQUID INJECTION WASTE DISPOSAL
(IF GAS) PRODUCTION: STORAGE DEEP SHALLOW
Proposed Elev. 880'
LOCATION: ELEVATION: Existing Elev. 882' WATERSHED: Outlet Middle Island Creek QUADRANGLE: Middlebourne
DISTRICT: Ellsworth/Union COUNTY: Tyler
SURFACE OWNER: Eldon J. & Ruth A. Helman; Lara Keller Thomas; Leslie W. Potts; ACREAGE: 61.83
ROYALTY OWNER: Eldon J. & Ruth A. Helman; Gary C. & Maryjane Richards; LEASE NO: ACREAGE: 53; 83.13; 61.83; 50;
PROPOSED WORK: DRILL CONVERT DRILL DEEPER FRACTURE OR STIMULATE PLUG OFF OLD FORMATION
 PERFORATE NEW FORMATION OTHER PHYSICAL CHANGE IN WELL (SPECIFY) _____
 PLUG AND ABANDON CLEAN OUT AND REPLUG TARGET FORMATION: Marcellus Shale ESTIMATED DEPTH: 6,600' TVD 10,700' MD

WELL OPERATOR: Antero Resources Corporation DESIGNATED AGENT: Dianna Stamper - CT Corporation System
ADDRESS: 1615 Wynkoop Street ADDRESS: 5400 D Big Tyler Road
Denver, CO 80202 Charleston, WV 25313