

7,890' to Bottom Hole

1,120' to Top Hole

TOP HOLE LATITUDE 39 - 32 - 30
BTM HOLE LATITUDE 39 - 30 - 00

TOP LONGITUDE 80 - 50 - 00
BTM LONGITUDE 80 - 47 - 30

13,766' to Top Hole

7,476' to Bottom Hole

Antero Resources
Well No. Prosper 2H
As-Drilled
Antero Resources Corporation



Wellhead Layout

- Vulcan Unit 1H 47-095-02701
- Vulcan Unit 2H 47-095-02702
- Prosper Unit 1H 47-095-02699 As-Drilled
- Prosper Unit 2H 47-095-02700 As-Drilled
- Friend Unit 1H 47-095-02695
- Friend Unit 2H 47-095-02696
- Seagrave Unit 1H 47-095-02697
- Seagrave Unit 2H 47-095-02698

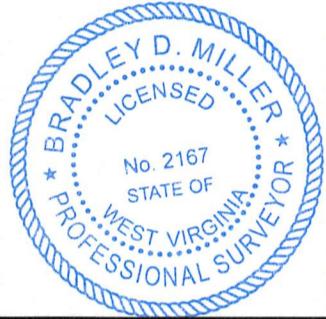

I, the undersigned, hereby certify that this plat is correct to the best of my knowledge and belief and shows all the information required by law and the rules issued and prescribed by the Department of Environmental Protection.

Bradley D. Miller, P.S. 2167

Note: 3 water wells were found within 2000' of proposed well. No occupied dwellings or buildings 2,500 square feet or larger used to house or shelter dairy cattle or poultry husbandry are located within 625' of the center of the well pad.

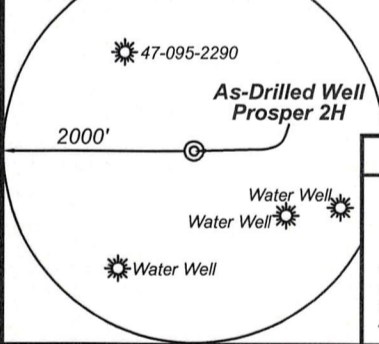

Legend

- Proposed gas well
- Found corner, as noted
- Existing Well, as noted
- Digitized Well
- Existing Road
- Existing Road
- Surface boundary (approx.)
- Interior surface tracts (approx.)

Notes:
West Virginia Coordinate System of 1927, North Zone based upon Differential GPS Measurements.
Well No. Prosper Unit 2H Top Hole coordinates are
N: 368,439.47' Latitude: 39°30'13.94"
E: 1,622,665.51' Longitude: 80°50'14.29"
Bottom Hole coordinates are
N: 359,480.90' Latitude: 39°28'46.11"
E: 1,627,524.04' Longitude: 80°49'10.63"
UTM Zone 17, NAD 1983
Top Hole Coordinates Bottom Hole Coordinates
N: 4,372,715.614m N: 4,370,011.087m
E: 514,002.597m E: 515,528.309m
Plat orientation and corner and well references are based upon the grid north meridian.
Well location references are based upon the magnetic meridian.

Top Hole Coordinates, As-drilled data, and information was provided by Antero Resources Corporation. Allegheny Surveys Inc. (ASI) is not certifying the data and information provided. ASI is not responsible for any errors or inaccuracies with the data and information that has been provided.

Prosper Unit 2H As-Drilled POE Coordinates
West Virginia Coordinate System of 1927, North Zone
N: 368,539.84'
E: 1,624,520.55'
Latitude: 39°30'15.20"
Longitude: 80°49'50.64"
UTM Zone 17, NAD 1983
N: 4,372,755.641m
E: 514,567.231m

	Bearing	Dist.
L1	S 34°44' E	1,259.4'
L2	S 75°56' W	2,070.4'
L3	N 75°34' W	1,522.7'
L4	N 47°33' E	1,166.5'

STATE OF WEST VIRGINIA
DEPARTMENT OF ENVIRONMENTAL PROTECTION
OIL AND GAS DIVISION

FILE NO: 189-54-E-19
DRAWING NO: Prosper Unit 2H As-Drilled
SCALE: 1" = 2000'
MINIMUM DEGREE OF ACCURACY: Submeter
PROVEN SOURCE OF ELEVATION: WVDOT, Harrisville, WV

DATE: February 24 2021
OPERATOR'S WELL NO. Prosper 2H
API WELL NO
47 - 095 - 02700
STATE COUNTY PERMIT

WELL TYPE: OIL GAS LIQUID INJECTION WASTE DISPOSAL
(IF GAS) PRODUCTION: STORAGE DEEP SHALLOW

LOCATION: ELEVATION: As-Built 1081' WATERSHED: Outlet Middle Island Creek QUADRANGLE: Shirley
DISTRICT: Ellsworth COUNTY: Tyler 03/17/2023

SURFACE OWNER: Richard D. Pyles Mary B. Hoover; Anthony Bruce Parr, et ux; Clarence W. Mutschelknaus Sr. & Clarence W. Mutschelknaus Jr. (2); Gary L. Weekley; Rosemary Haught; Carol J. Knapp; Ronald P. Webb; ACREAGE: 168.5
ROYALTY OWNER: Richard D. & Cathy J. Pyles (4); BRC Appalachian Minerals I, LLC; LEASE NO: ACREAGE: 39; 80; 82.75; 113

PROPOSED WORK: DRILL CONVERT DRILL DEEPER FRACTURE OR STIMULATE PLUG OFF OLD FORMATION
 PERFORATE NEW FORMATION OTHER PHYSICAL CHANGE IN WELL (SPECIFY) As-Drilled
 PLUG AND ABANDON CLEAN OUT AND REPLUG TARGET FORMATION: Marcellus Shale ESTIMATED DEPTH: 6,701' TVD 16,936' MD

WELL OPERATOR: Antero Resources Corporation DESIGNATED AGENT: Dianna Stamper - CT Corporation System
ADDRESS: 1615 Wynkoop Street ADDRESS: 5400 D Big Tyler Road
Denver, CO 80202 Charleston, WV 25313



ID	TM/Par	Owner	DB/PG	Acres
1	16-42	Richard D. Pyles	379/20	168.5
2	16-24	Harry Eastham, et al	AR54/518	64.00
3	16-22	Joseph L. Jr. & Karen Sitko	296/13	81.70
4	16-44	Robert A. Pyles, et al	335/482	87.82
5	16-42.1	Richard D. Pyles	336/815	4.56
6	16-42.2	Bonnie J. Hair	569/105	2.44
7	16-42.3	Richard D. Pyles	379/20	3.00
8	16-39	Richard D. & Cathy J. Pyles	490/566	48.51
9	16-43	Alfred L. Eddy	344/22	37.10
10	16-40	Gary L. Weekley	WB 22/601	5.79
11	16-38	Antero Resources Corp.	662/782	15.00
12	22-4	Stephen H. & Barbara J. Dunthorn	216/40	69.00
13	22-6	Antero Resources Corp.	662/782	131.57
14	22-5	Antero Resources Corp.	662/782	84.67
15	22-40	Ronald P. & Sandra L. Webb	282/1	65.00
16	22-17	Dorothy Mae Stevens Irrevocable Trust	453/610	82.75
17	22-39	Ronald P. & Sandra L. Webb	270/587	45.00
18	22-38	Bruce & Sandra L. Parr	368/790	113.00
19	22-23.1	Raymond L. Parr	284/350	18.00
20	22-23.2	Anthony B. Parr	440/62	17.00
21	22-34	Raymond L. Parr, et al	329/181	55.25
22	22-23	Anthony B. Parr	440/62	17.00
23	22-35	Marie Eddy	344/358	52.96
24	22-33	Donald & Wilma Weekley	262/587	65.75
25	28-43	Wanda J. Parr	327/435	8.02
26	28-45	Wanda J. Parr	349/18	4.55
27	28-42	Robert H. Anderson	238/76	0.99
28	28-34	Shirl N. Baker, Jr.	WB 38/1	0.50
29	28-32	B.W. Weekley	107/562	33.31
30	28-33	B.W. Weekley	107/562	25.30
31	28-35	Shirl N. Baker, Jr.	WB 38/1	32.00
32	28-36	Jim & Sandra Young	368/797	46.50
33	28-44	Shirl N. Baker, et al	WB 38/1	0.02

Leases	
A	Richard D. & Cathy J. Pyles
B	Helen E. Boggs
C	Joseph L. Sitko, et ux
D	BRC Appalachian Minerals I, LLC
E	James F. Doan, et ux
F	Dustin A. Hendershot
G	Richard D. & Cathy J. Pyles
H	Richard D. & Cathy J. Pyles
I	Richard D. & Cathy J. Pyles
J	Alfred Lonzo Eddy
K	Gary L. Weekley
L	Taryn E. Pilling
M	Clarence W. Mutschelknaus Sr. & Clarence W. Mutschelknaus Jr.
N	Ridgetop Capital II, LP
O	Rosemary Haught
P	BRC Appalachian Minerals I, LLC
Q	Clarence W. Mutschelknaus Sr. & Clarence W. Mutschelknaus Jr.
R	Mary B. Hoover
S	Ronald P. Webb
T	Carol J. Knapp
U	Anthony Bruce Parr, et ux
V	Open
W	Judith Remley Phillip
X	Nancy L. Mains
Y	Dale H. Parr
Z	Larry Stevens
AA	Richard L. White, II
AB	Wanda J. Parr
AC	Elizabeth Ann Weekley
AD	Lucille Adams
AE	Lucille Adams
AF	Elizabeth A. Weekley
AG	Bounty Minerals LLC
AH	Jim & Sandra Young

FILE NO: 189-54-E-19
 DRAWING NO: Prosper Unit 2H As-Drilled
 SCALE: 1" = 2000'
 MINIMUM DEGREE OF ACCURACY:
 Submeter
 PROVEN SOURCE OF ELEVATION:
 WV DOT, Harrisville, WV

STATE OF WEST VIRGINIA
 DEPARTMENT OF ENVIRONMENTAL PROTECTION
OIL AND GAS DIVISION

DATE: February 24 2021
 OPERATOR'S WELL NO. Prosper 2H
 API WELL NO
 47 - 095 - 02700
 STATE COUNTY PERMIT

WELL TYPE: OIL GAS LIQUID INJECTION WASTE DISPOSAL
 (IF GAS) PRODUCTION: STORAGE DEEP SHALLOW

LOCATION: ELEVATION: As-Built 1081' WATERSHED: Outlet Middle Island Creek QUADRANGLE: Shirley
 DISTRICT: Ellsworth COUNTY: Tyler 03/17/2023
 SURFACE OWNER: Richard D. Pyles Mary B. Hoover; Anthony Bruce Parr, et ux; ACREAGE: 168.5 47.1734; 64; 79.042; 33; 3;
 ROYALTY OWNER: Richard D. & Cathy J. Pyles (4); BRC Appalachian Minerals I, LLC; Gary L. Weekley; Rosemary Haught; Carol J. Knapp; Ronald P. Webb; LEASE NO: ACREAGE: 39; 80; 82.75; 113 5.79; 14; 45; 65;
 PROPOSED WORK: DRILL CONVERT DRILL DEEPER FRACTURE OR STIMULATE PLUG OFF OLD FORMATION
 PERFORATE NEW FORMATION OTHER PHYSICAL CHANGE IN WELL (SPECIFY) As-Drilled
 PLUG AND ABANDON CLEAN OUT AND REPLUG TARGET FORMATION: Marcellus Shale ESTIMATED DEPTH: 16,936' MD 6,701' TVD

WELL OPERATOR: Antero Resources Corporation DESIGNATED AGENT: Dianna Stamper - CT Corporation System
 ADDRESS: 1615 Wynkoop Street ADDRESS: 5400 D Big Tyler Road
 Denver, CO 80202 Charleston, WV 25313