

LATITUDE 39°32'30"

10,717'

LATITUDE 39°35'00"

448' TO BOTTOM HOLE

Antero Resources Corporation Well No. Lemon Unit 1H

LINE	BEARING	DISTANCE
L1	N 72°40' W	1638.0'
L2	N 64°54' W	1582.1'
L3	N 61°22' W	1537.8'
L4	N 34°54' W	1512.5'
L5	N 27°19' W	1636.7'
L6	N 21°11' W	1650.6'
L7	N 06°24' W	1392.9'
L8	N 05°00' W	1521.3'
L9	N 00°15' W	1911.8'
L10	N 03°26' E	1913.5'
L11	N 25°08' E	1338.5'
L12	N 49°41' E	1592.6'

NOTES:
WELL 1H TOP HOLE INFORMATION:
 N: 373,277ft E: 1,324,896ft
 LAT: 39°31'02.07" LON: 80°49'46.75"
BOTTOM HOLE INFORMATION:
 N: 385,140ft E: 1,323,585ft
 LAT: 39°32'59.12" LON: 80°50'05.72"
 WEST VIRGINIA COORDINATE SYSTEM OF 1927 NORTH ZONE. ZONE WAS DERIVED FROM MEASUREMENTS TAKEN WITH TRIMBLE GEOXT SUBMETER MAPPING GRADE GPS UNIT. PLAT ORIENTATION, CORNER, AND WELL REFERENCE TIE LINES ARE BASED ON GRID NORTH.

(NAD) 83 (UTM) ZONE 17 COORDS:
WELL 1H TOP HOLE INFORMATION:
 N: 4,374,201m E: 514,658m
BOTTOM HOLE INFORMATION:
 N: 4,377,808m E: 514,198m

WV NORTH ZONE
GRID NORTH

12,230' TO BOTTOM HOLE

LONGITUDE 80°47'30"

LONGITUDE 80°50'00"

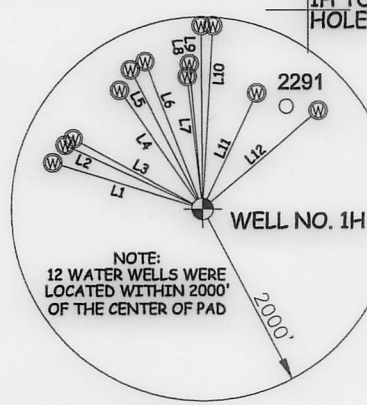
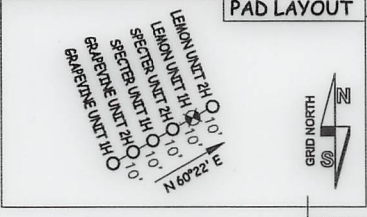

B	REOP, LLC	17 ACRES±
C	LINDA K. LOEHR	82 ACRES±
D	RYAN GREENLEE ET UX	15 ACRES±
E	RYAN GREENLEE ET UX	27.49 ACRES±
F	FISHER OIL COMPANY	45.67 ACRES±
G	BOUNTY MINERALS, LLC	28.47 ACRES±
H	RICHARD MOORE	111.52 ACRES±
I	BOUNTY MINERALS, LLC	38.5 ACRES±
J	CHARLES RAY JOBE	48.74 ACRES±
K	BRC APPALACHIAN MINERALS I LLC	39.29 ACRES±
L	RALPH D. THACKER	25 ACRES±
M	GARY A. SOLE	92.5 ACRES±
N	JUDITH A. ASH	59.69 ACRES±
O	J. MAURICE CARLISLE JR.	19 ACRES±
P	GARY A. SOLE	60 ACRES±
Q	MICHAEL W. EDDY	33.74 ACRES±
R	GARY A. SOLE	45.34 ACRES±
S	RIDGETOP CAPITAL IV, LP	43.5 ACRES±
T	NILE DEAN HARRIS	53.75 ACRES±
U	RIDGETOP CAPITAL LP	69.06 ACRES±
V	BRC APPALACHIAN MINERALS I LLC	58.56 ACRES±
W	RIDGETOP CAPITAL IV, LP	16.5 ACRES±
X	DOUGLAS SCOTT FUNK SR.	11.5 ACRES±
Y	ANTERO RESOURCES CORP.	40 ACRES±
Z	BRC APPALACHIAN MINERALS I LLC	61.73 ACRES±

I THE UNDERSIGNED, HEREBY CERTIFY THAT THIS PLAT IS CORRECT TO THE BEST OF MY KNOWLEDGE AND BELIEF AND SHOWS ALL THE INFORMATION REQUIRED BY LAW AND THE RULES ISSUED AND PERSCRIBED BY THE DEPARTMENT OF ENVIRONMENTAL PROTECTION.



STATE OF WEST VIRGINIA, DIVISION OF ENVIRONMENTAL PROTECTION, OFFICE OF OIL AND GAS
 WILLOW LAND SURVEYING PLLC
 220 MASONIC AVE. PENNSBORO WEST VIRGINIA 26415

A - LEE ROY HOWELL D.B. 170409 TM 11-41 1.67 AC
 B - ROBERT D. MILLER D.B. 300401 TM 11-42 2.707 AC
 C - LEE ROY HOWELL D.B. 290407 TM 11-42-3 0.18 AC
 D - ROBERT D. MILLER D.B. 370332 TM 11-40 3.244 AC
 E - JOHN E. GRIBBS D.B. 330402 TM 11-40 1.00 AC
 F - RONALD R. JONES D.B. 402004 TM 11-44 4.30 AC
 G - CHARLES R. FERRELL D.B. 210025 TM 11-44-1 0.5 AC
 H - RICHARD J. FERRELL D.B. 240025 TM 11-44-2 15.00 AC
 I - CHARLES J. FERRELL D.B. 341028 TM 11-44-3 1.500 AC
 J - RONALD R. JONES D.B. 402004 TM 11-45 0.40 AC
 K - SARAH E. PITTMAN D.B. 214009 TM 11-43 2.4 AC
 L - RICHARD J. FERRELL D.B. 421079 TM 11-40-1 1.13 AC

JOB # **20-008WA**
 DRAWING # **LEMON1HAD**
 SCALE **1" = 2000'**
 MINIMUM DEGREE OF ACCURACY **SUBMETER**
 PROVEN SOURCE OF ELEV. **SUBMETER MAPPING GRADE GPS**

LEGEND
 - - - Surface Owner Boundary Lines +/-
 - - - Interior Surface Tracts +/-
 ○ Proposed Well Path
 ⊗ As Drilled Well Path

D.R. Rowe
DOUGLAS R. ROWE P.S. 2202

STATE OF WEST VIRGINIA DEPARTMENT OF ENERGY DIVISION OF OIL AND GAS

DATE **06/09/21**
 OPERATOR'S WELL# **LEMON UNIT #1H**

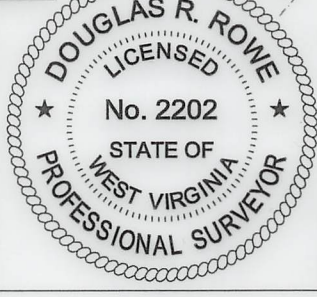

- NOTES:**
- NO OCCUPIED DWELLINGS OR BUILDINGS TWO THOUSAND FIVE HUNDRED (2,500) SQUARE FEET OR LARGER USED TO HOUSE OR SHELTER DAIRY CATTLE OR POULTRY HUSBANDRY ARE LOCATED WITHIN SIX HUNDRED TWENTY-FIVE (625) FEET OF THE CENTER OF THE WELL PAD.
 - TOP HOLE DATA SHOWN HEREON WAS PROVIDED BY ANTERO RESOURCES CORPORATION.
 - AS DRILLED DATA WAS PROVIDED BY ANTERO RESOURCES CORPORATION.
 - WLS IS NOT CERTIFYING THE DATA AND INFORMATION PROVIDED LISTED IN NOTES 2 AND 3, ONLY THE RELATIONSHIP TO THE LEASE AND INFORMATION PROVIDED TO THE LEASE BOUNDARIES.
 - WLS IS BY NO MEANS RESPONSIBLE FOR ANY ERRORS OR INACCURACIES WITH THE DATA AND INFORMATION THAT HAS BEEN PROVIDED.

WELL TYPE: OIL GAS LIQUID INJECTION WASTE DISPOSAL API WELL # **47-095-02703**

(IF "GAS") PRODUCTION STORAGE DEEP SHALLOW STATE COUNTY PERMIT

LOCATION: ELEVATION **1,042' AS BUILT** WATERSHED **OUTLET MIDDLE ISLAND CREEK**

QUADRANGLE **PORTER FALLS 7.5'** DISTRICT **ELLSWORTH** COUNTY **TYLER**

SURFACE OWNER **KAYLA LEEK** ACREAGE **69.06 ACRES +/-**

OIL & GAS ROYALTY OWNER **RIDGETOP CAPITAL LP; BRC APPALACHIAN MINERALS I LLC** LEASE ACREAGE **69.06 AC±; 58.56 AC±;**

DOUGLAS SCOTT FUNK SR.; RIDGETOP CAPITAL IV LP; RIDGETOP CAPITAL IV LP; GARY A. SOLE; GARY A. SOLE; JUDITH A. ASH; **11.5 AC±; 16.5 AC±; 43.5 AC±; 60 AC±; 60 AC±; 92.5 AC±; 59.69 AC±;**

BRC APPALACHIAN MINERALS I LLC; BOUNTY MINERALS, LLC; BOUNTY MINERALS, LLC; RYAN GREENLEE ET UX; **39.29 AC±; 28.47 AC±; 38.5 AC±; 15 AC±;**

LINDA K. LOEHR; REOP, LLC **82 AC±; 17 AC±**

PROPOSED WORK: DRILL CONVERT DRILL DEEPER REDRILL FRACTURE OR STIMULATE

PLUG OFF OLD FORMATION PERFORATE NEW FORMATION OTHER PHYSICAL CHANGE IN WELL

(SPECIFY) **AS DRILLED** PLUG & ABANDON CLEAN OUT & REPLUG

TARGET FORMATION **MARCELLUS** ESTIMATED DEPTH **6,562' TVD 19,075' MD**

WELL OPERATOR **ANTERO RESOURCES CORP.** DESIGNATED AGENT **DIANNA STAMPER - CT CORPORATION SYSTEM**

ADDRESS **1615 WYNKOOP ST.** ADDRESS **5400 D BIG TOWER ROAD**

FORM WW-6 **DENVER, CO 80202** **CHARLESTON, WV 25313**

COUNTY NAME PERMIT