

LATITUDE 39°32'30"

10,755'

LATITUDE 39°35'00"

←2,858' TO BOTTOM HOLE

Antero Resources Corporation  
Well No. Grapevine Unit 2H

(NAD) 83 (UTM) ZONE 17 COORDS:  
WELL 2H TOP HOLE INFORMATION:  
N: 4,374,194m E: 514,646m  
BOTTOM HOLE INFORMATION:  
N: 4,377,574m E: 513,464m

NOTES:  
WELL 2H TOP HOLE INFORMATION:  
N: 373,255ft E: 1,624,857ft  
LAT: 39°31'01.85" LON: 80°49'47.25"  
BOTTOM HOLE INFORMATION:  
N: 384,413ft E: 1,621,164ft  
LAT: 39°32'51.58" LON: 80°50'36.49"  
WEST VIRGINIA COORDINATE SYSTEM OF 1927 NORTH ZONE. ZONE WAS DERIVED FROM MEASUREMENTS TAKEN WITH TRIMBLE GEOXT SUBMETER MAPPING GRADE GPS UNIT. PLAT ORIENTATION, CORNER, AND WELL REFERENCE TIE LINES ARE BASED ON GRID NORTH.

LINE	BEARING	DISTANCE
L1	N 72°40' W	1638.0'
L2	N 64°54' W	1582.1'
L3	N 61°22' W	1537.8'
L4	N 34°54' W	1512.5'
L5	N 27°19' W	1636.7'
L6	N 21°11' W	1650.6'
L7	N 06°24' W	1392.9'
L8	N 05°00' W	1521.3'
L9	N 00°15' W	1911.8'
L10	N 03°26' E	1913.5'
L11	N 25°08' E	1338.5'
L12	N 49°41' E	1592.6'

WV NORTH ZONE GRID NORTH

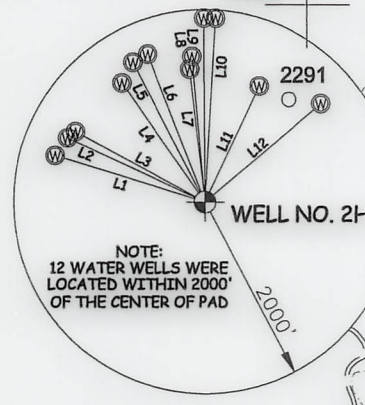
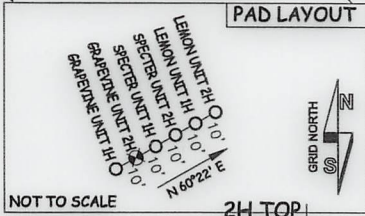

I THE UNDERSIGNED, HEREBY CERTIFY THAT THIS PLAT IS CORRECT TO THE BEST OF MY KNOWLEDGE AND BELIEF AND SHOWS ALL THE INFORMATION REQUIRED BY LAW AND THE RULES ISSUED AND PERSCRIBED BY THE DEPARTMENT OF ENVIRONMENTAL PROTECTION.



STATE OF WEST VIRGINIA, DIVISION OF ENVIRONMENTAL PROTECTION, OFFICE OF OIL AND GAS  
WILLOW LAND SURVEYING PLLC  
220 MASONIC AVE. PENNSBORO WEST VIRGINIA 26415

- A1-LEE ROY HOWELL D.B. 170408 TM 11-41 1.87 AC
- B1-ROBERT D. MILLER D.B. 300401 TM 11-42 2.707 AC
- C1-LEE ROY HOWELL D.B. 254937 TM 11-42 0.18 AC
- D1-ROBERT D. MILLER D.B. 370832 TM 11-40 3.244 AC
- E1-JOHN E. KEPLER D.B. 33842 TM 11-40 1.08 AC
- F1-ROBERT R. JONES D.B. 402204 TM 11-44 4.26 AC
- G1-CHARLES R. FERRELL D.B. 210923 TM 11-44 0.5 AC
- H1-RICHARD J. FERRELL D.B. 240003 TM 11-42 15.08 AC
- I1-CHARLES R. FERRELL D.B. 341726 TM 11-44 1.892 AC
- J1-RONALD R. JONES D.B. 422206 TM 11-45 0.48 AC
- K1-SARAH E. PITTMAN D.B. 214506 TM 11-45 2.4 AC
- L1-RICHARD J. FERRELL D.B. 421878 TM 11-40 1.13 AC

JOB # 20-006WA  
DRAWING # GRAPEVINE2HAD  
SCALE 1" = 2000'  
MINIMUM DEGREE OF ACCURACY SUBMETER  
PROVEN SOURCE OF ELEV. SUBMETER MAPPING GRADE GPS

LEGEND  
- - - Surface Owner Boundary Lines +/-  
- - - Interior Surface Tracts +/-  
○ - - - Proposed Well Path  
○ - - - As Drilled Well Path  
DOUGLAS R. ROWE P.S. 2202

STATE OF WEST VIRGINIA DEPARTMENT OF ENERGY DIVISION OF OIL AND GAS

DATE 06/09/21  
OPERATOR'S WELL # GRAPEVINE UNIT #2H

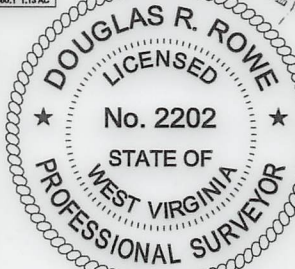

- NOTES
- NO OCCUPIED DWELLINGS OR BUILDINGS TWO THOUSAND FIVE HUNDRED (2,500) SQUARE FEET OR LARGER USED TO HOUSE OR SHELTER DAIRY CATTLE OR POULTRY. HUSBANDRY ARE LOCATED WITHIN SIX HUNDRED TWENTY-FIVE (625) FEET OF THE CENTER OF THE WELL PAD.
  - TOP HOLE DATA SHOWN HEREON WAS PROVIDED BY ANTERO RESOURCES CORPORATION.
  - AS DRILLED DATA WAS PROVIDED BY ANTERO RESOURCES CORPORATION.
  - WELLS IS NOT CERTIFYING THE DATA AND INFORMATION PROVIDED LISTED IN NOTES 2 AND 3, ONLY THE RELATIONSHIP TO THE DATA AND INFORMATION PROVIDED TO THE LEASE BOUNDARIES.
  - WLS IS BY NO MEANS RESPONSIBLE FOR ANY ERRORS OR INACCURACIES WITH THE DATA AND INFORMATION THAT HAS BEEN PROVIDED.

WELL TYPE: OIL  GAS  LIQUID INJECTION  WASTE DISPOSAL  API WELL # 47 - 095 - 02708  
(IF "GAS") PRODUCTION  STORAGE  DEEP  SHALLOW  STATE COUNTY PERMIT  
LOCATION: ELEVATION 1,042' AS BUILT WATERSHED OUTLET MIDDLE ISLAND CREEK

QUADRANGLE PORTER FALLS 7.5' DISTRICT ELLSWORTH COUNTY TYLER  
SURFACE OWNER KAYLA LEEK ACREAGE 69.06 ACRES +/-  
OIL & GAS ROYALTY OWNER RIDGETOP CAPITAL LP; BRC APPALACHIAN I, LLC; LEASE ACREAGE 69.06 AC.±; 61.73 AC.±;

RICHARD J. FERRELL, ET UX; LOUELLA HOSKINS ET UX; ROBERT D. MILLER ET UX; MELISSA DAWN PILANT; 15.08 AC.±; 1.13 AC.±; 2.71 AC.±; 51.49 AC.±;  
PATHFINDER RESOURCES II, LLC; DARWIN MARTIN ET UX; RIDGETOP CAPITAL II, LP; JOHN E. KEPLER; JERRY R. BROWN; 22.5 AC.±; 60.66 AC.±; 70 AC.±; 38 AC.±; 5 AC.±;  
CARR FAMILY TRUST; WACO OIL & GAS COMPANY, INC; BRC APPALACHIAN MINERALS I LLC; HERITAGE RESOURCES-MARCELLUS MINERALS, LLC 64.81 AC.±; 50.25 AC.±; 55 AC.±; 61.52 AC.±

PROPOSED WORK: DRILL  CONVERT  DRILL DEEPER  REDRILL  FRACTURE OR STIMULATE   
PLUG OFF OLD FORMATION  PERFORATE NEW FORMATION  OTHER PHYSICAL CHANGE IN WELL (SPECIFY) AS DRILLED PLUG & ABANDON CLEAN OUT & REPLUG

TARGET FORMATION MARCELLUS ESTIMATED DEPTH 6,551' TVD 18,481' MD  
WELL OPERATOR ANTERO RESOURCES CORP. DESIGNATED AGENT DIANNA STAMPER - CT CORPORATION SYSTEM  
ADDRESS 1615 WYNKOOP ST. ADDRESS 5400 D BIG TYLER ROAD  
FORM WW-6 DENVER, CO 80202 CHARLESTON, WV 25313

12,994' TO BOTTOM HOLE

8,919'

LONGITUDE 80°47'30"

LONGITUDE 80°50'00"

COUNTY NAME PERMIT