



---

west virginia department of environmental protection

---

Office of Oil and Gas  
601 57<sup>th</sup> Street, S.E.  
Charleston, WV 25304  
(304) 926-0450  
fax: (304) 926-0452

Harold D. Ward, Cabinet Secretary  
[www.dep.wv.gov](http://www.dep.wv.gov)

Monday, March 15, 2021  
PERMIT MODIFICATION APPROVAL  
Horizontal 6A / New Drill

ANTERO RESOURCES CORPORATION  
1615 WYNKOOP STREET

DENVER, CO 80202

Re: Permit Modification Approval for TAPEATS UNIT 2H  
47-095-02714-00-00

**Lateral Extension**

ANTERO RESOURCES CORPORATION

The Office of Oil and Gas has reviewed the attached permit modification for the above referenced permit. The attached modification has been approved and well work may begin. Please be reminded that the oil and gas inspector is to be notified twenty-four (24) hours before permitted well work is commenced.

If there are any questions, please feel free to contact me at (304) 926- 0450.

James A. Martin  
Chief

Operator's Well Number: TAPEATS UNIT 2H  
Farm Name: KENNETH TOMBLN ET AL  
U.S. WELL NUMBER: 47-095-02714-00-00  
Horizontal 6A New Drill  
Date Modification Issued: 3/15/2021

Promoting a healthy environment.

03/19/2021

WW-6B  
(04/15)

API NO. 47-095 - 02714  
OPERATOR WELL NO. Tapeats Unit 2H  
Well Pad Name: Grand Pad

STATE OF WEST VIRGINIA  
DEPARTMENT OF ENVIRONMENTAL PROTECTION, OFFICE OF OIL AND GAS  
WELL WORK PERMIT APPLICATION

1) Well Operator: Antero Resources Corporat 494507062 095-Tyler Ellsworth Porter Falls 7.5'  
Operator ID County District Quadrangle

2) Operator's Well Number: Tapeats Unit 2H Well Pad Name: Grand Pad

3) Farm Name/Surface Owner: Kenneth Tomblin et al Public Road Access: Gorrells Run Road

4) Elevation, current ground: 1268' Elevation, proposed post-construction: ~1243'

5) Well Type (a) Gas  Oil  Underground Storage

Other \_\_\_\_\_

(b) If Gas Shallow  Deep

Horizontal

6) Existing Pad: Yes or No Yes

*Dmit  
3-10-21*

7) Proposed Target Formation(s), Depth(s), Anticipated Thickness and Expected Pressure(s):  
Marcellus Shale: 7300' TVD, Anticipated Thickness- 55 feet, Associated Pressure- 2800#

8) Proposed Total Vertical Depth: 7300' TVD

9) Formation at Total Vertical Depth: Marcellus

10) Proposed Total Measured Depth: 26900' MD

11) Proposed Horizontal Leg Length: 16155'

12) Approximate Fresh Water Strata Depths: 25'

13) Method to Determine Fresh Water Depths: 47-095-02267

14) Approximate Saltwater Depths: 2305'

15) Approximate Coal Seam Depths: 431'

16) Approximate Depth to Possible Void (coal mine, karst, other): None Anticipated

17) Does Proposed well location contain coal seams directly overlying or adjacent to an active mine? Yes  No

(a) If Yes, provide Mine Info: Name: \_\_\_\_\_

Depth: \_\_\_\_\_

Seam: \_\_\_\_\_

Owner: \_\_\_\_\_

CASING AND TUBING PROGRAM

TYPE	Size (in)	New or Used	Grade	Weight per ft. (lb/ft)	FOOTAGE: For Drilling (ft)	INTERVALS: Left in Well (ft)	CEMENT: Fill-up (Cu. Ft./CTS)
Conductor	20"	New	H-40	94#	80	80	CTS, 218 Cu. Ft.
Fresh Water	13-3/8"	New	J-55	54.5#	300	300	CTS, 417 Cu. Ft.
Coal	9-5/8"	New	J-55	36#	2500	2500	CTS, 1018 Cu. Ft.
Intermediate							
Production	5-1/2"	New	P-110	23#	26900	26900	6989 Cu. Ft.
Tubing	2-3/8"	New	N-80	4.7#			
Liners							

DMH  
3-10-21

TYPE	Size (in)	Wellbore Diameter (in)	Wall Thickness (in)	Burst Pressure (psi)	Anticipated Max. Internal Pressure (psi)	Cement Type	Cement Yield (cu. ft./k)
Conductor	20"	24"	0.438"	1530	50	Class A	~1.18
Fresh Water	13-3/8"	17-1/2"	0.38"	2730	1000	Class A	~1.18
Coal	9-5/8"	12-1/4"	0.352"	3520	1500	Class A	~1.18
Intermediate							
Production	5-1/2"	8-3/4" & 8-1/2"	0.415"	12,630	2500	1544-PCZ & TRM-H	H/POZ-1.44 & H-1.8
Tubing	2-3/8"	4.778"	0.19"	11,200			
Liners							

PACKERS

Kind:	Sizes:	Depths Set:
N/A	N/A	N/A

WW-6B  
(10/14)

API NO. 47- 095 - 02714  
OPERATOR WELL NO. Tapeats Unit 2H  
Well Pad Name: Grand Pad

19) Describe proposed well work, including the drilling and plugging back of any pilot hole:

Drill, perforate, fracture a new horizontal shallow well and complete Marcellus Shale.

DMH  
3-10-21

20) Describe fracturing/stimulating methods in detail, including anticipated max pressure and max rate:

Antero plans to pump Slickwater into the Marcellus Shale formation in order to ready the well for production. The fluid will be comprised of approximately 99 percent water and sand, with less than 1 percent special-purpose additives as shown in the attached "List of Anticipated Additives Used for Fracturing or Stimulating Well."

Anticipated Max Pressure - 9300 lbs  
Anticipated Max Rate - 80 bpm

21) Total Area to be disturbed, including roads, stockpile area, pits, etc., (acres): Existing 44.34 acres

22) Area to be disturbed for well pad only, less access road (acres): Existing 13.72 acres

23) Describe centralizer placement for each casing string:

Conductor: no centralizers  
Surface Casing: one centralizer 10' above the float shoe, one on the insert float collar and one every 4th joint spaced up the hole to surface.  
Intermediate Casing: one centralizer above float joint, one centralizer 5' above float collar and one every 4th collar to surface.  
Production Casing: one centralizer at shoe joint and one every 3 joints to top of cement in intermediate casing.

24) Describe all cement additives associated with each cement type:

Conductor: no additives, Class A cement.  
Surface: Class A cement with 2-3% calcium chloride and 1/4 lb of flake  
Intermediate: Class A cement with 1/4 lb of flake, 5 gallons of clay treat  
Production: Lead cement- 50/50 Class H/Poz + 1.5% salt + 1% C-45 + 0.5% C-16a + 0.2% C-12 + 0.45% C-20 + 0.05% C-51  
Production: Tail cement- Class H + 45 PPS Calcium Carbonate + 1.0% FL-160 + 0.2% ACGB-47 + 0.05% ACSA-51 + 0.2% ACR-20

25) Proposed borehole conditioning procedures:

Conductor: blowhole clean with air, run casing, 10 bbls fresh water.  
Surface: blowhole clean with air, trip to conductor shoe, trip to bottom, blowhole clean with air, trip out, run casing, circulate pipe capacity + 40 bbls fresh water followed by 25 bbls bentonite mud, 10 bbls fresh water spacer.  
Intermediate: blowhole clean with air, trip to surface casing shoe, trip to bottom, blowhole clean with air, trip out, run casing, circulate 40 bbls brine water followed by 10 bbls fresh water and 25 bbls bentonite mud, pump 10 bbls fresh water.  
Production: circulate with 14 lb/gal NaCl mud, trip to middle of lateral, circulate, pump high viscosity sweep, trip to base of curve, pump high viscosity sweep, trip to top of curve, trip to bottom, circulate, pump high viscosity sweep, trip out, run casing, circulate 10 bbls fresh water, pump 48 bbls barite pill, pump 10 bbls fresh water followed by 48 bbls mud flush and 10 bbls water.

\*Note: Attach additional sheets as needed.



PERMIT MODIFICATION API # 47-095-02714

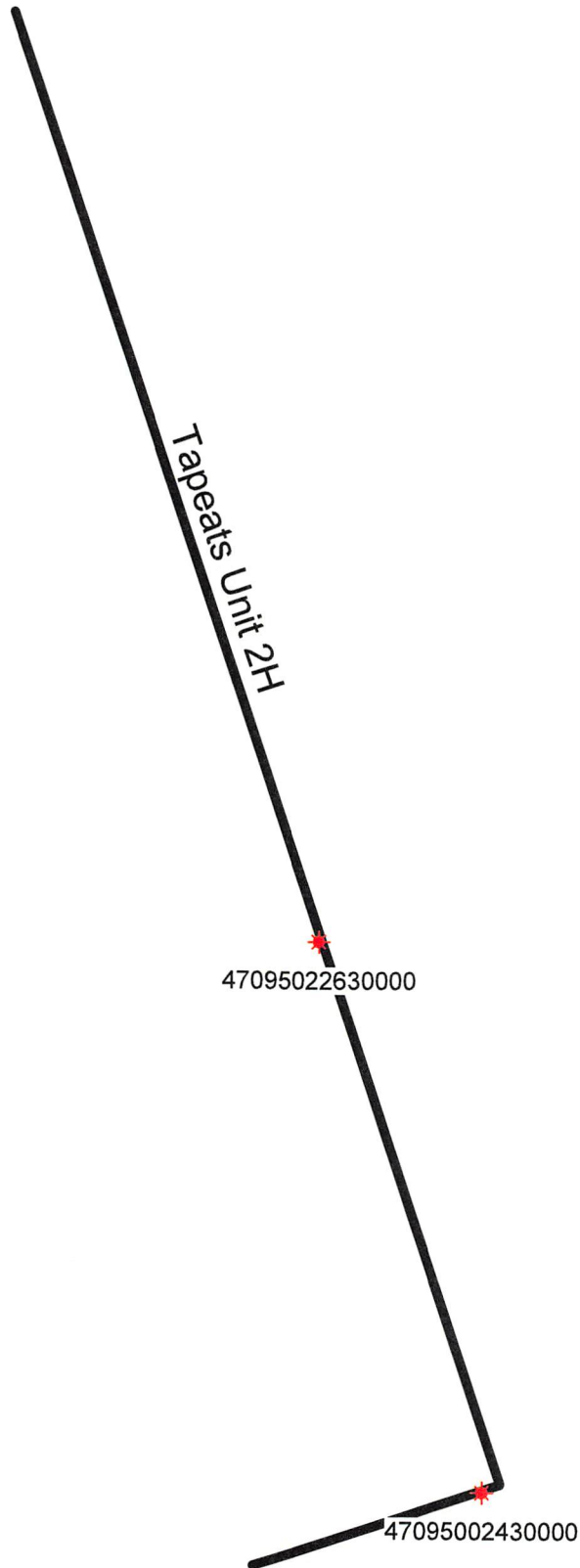

RECEIVED  
Office of Oil and Gas

MAR 03 2021

WV Department of  
Environmental Protection



**Antero Resources Corporation**

Tapeats Unit 2H - AOR



WELL SYMBOLS  
Gas Well

September 29, 2020

03/19/2021

UWI (APINum)	Well Name	Well Number	Operator	Hist Oper	TD	Perforated Interval (shallowest, deepest)	Perforated Formation(s)	Producible Formation(s) not perf'd
47095022630000	HARRIS	3V	ALLIANCE PETR CORP	ALLIANCE PETR CORP	3,590	2150 - 2549	Weir, Gordon	Alexander, Benson
47095002430000	FERRELL NANCY H HEIRS	2	TRIAD HUNTER LLC	EDGAR OIL		1938 - 1938	Keener	Weir, Alexander, Benson

]

RECEIVED  
Office of Oil and Gas  
MAR 03 2021  
WV Department of  
Environmental Protection

LATITUDE 39°32'30"

5,347'

LATITUDE 39°35'00"

8,052' TO BOTTOM HOLE

Antero Resources Corporation Well No. Tapeats Unit 2H

NOTES: WELL 2H TOP HOLE INFORMATION: N: 369,487ft E: 1,630,212ft LAT: 39°30'25.39" LON: 80°48'38.22" BOTTOM HOLE INFORMATION: N: 385,757ft E: 1,627,740ft LAT: 39°33'05.83" LON: 80°49'12.80" WEST VIRGINIA COORDINATE SYSTEM OF 1927 NORTH ZONE. ZONE WAS DERIVED FROM MEASUREMENTS TAKEN WITH TRIMBLE GEOXT SUBMETER MAPPING GRADE GPS UNIT. PLAT ORIENTATION, CORNER, AND WELL REFERENCE TIE LINES ARE BASED ON GRID NORTH.

(NAD) 83 (UTM) ZONE 17 COORDS: WELL 2H TOP HOLE INFORMATION: N: 4,373,073m E: 516,296m BOTTOM HOLE INFORMATION: N: 4,378,018m E: 515,461m

(NAD) 27 (UTM) ZONE 17 COORDS: WELL 2H TOP HOLE INFORMATION: N: 14,346,610ft E: 1,693,835ft POINT OF ENTRY INFORMATION: N: 14,347,546ft E: 1,696,306ft BOTTOM HOLE INFORMATION: N: 14,362,831ft E: 1,691,093ft

NOTE: NO OCCUPIED DWELLINGS OR BUILDINGS TWO THOUSAND FIVE HUNDRED (2,500) SQUARE FEET OR LARGER USED TO HOUSE OR SHELTER DAIRY CATTLE OR POULTRY HUSBANDRY ARE LOCATED WITHIN SIX HUNDRED TWENTY-FIVE (625) FEET OF THE CENTER OF THE WELL PAD.

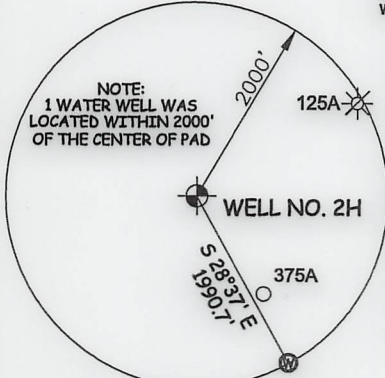
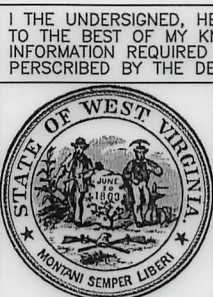
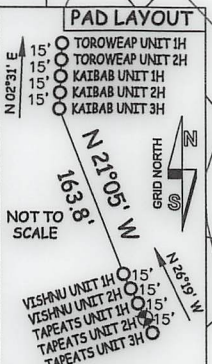

Table listing landowners in Ellsworth District - Tyler County. Owners include Michael Martin, Darrell Sole, Jean Neel Et Al, Richard Neff, Gail Neff, James Barnhart, Harvey Miller Et Al, Kenneth Tomblin, Christopher Investments Inc., Richard Neff, Michael Beagle, and Edna Roberts.

2H BOTTOM HOLE, 2H TOP HOLE



STATE OF WEST VIRGINIA, DIVISION OF ENVIRONMENTAL PROTECTION, OFFICE OF OIL AND GAS

WILLOW LAND SURVEYING PLLC 220 MASONIC AVE. PENNSBORO WEST VIRGINIA 26415

JOB # 20-009WA DRAWING # TAPEATS2H SCALE 1" = 2000' MINIMUM DEGREE OF ACCURACY SUBMETER PROVEN SOURCE OF ELEV. SUBMETER MAPPING GRADE GPS

LEGEND: Surface Owner Boundary Lines +/-, Adjoining Surface Tracts +/-, Found monument, as noted. Signature of Thomas Summers, No. 2109, State of West Virginia Professional Surveyor.

STATE OF WEST VIRGINIA DEPARTMENT OF ENERGY DIVISION OF OIL AND GAS

DATE 02/18/21 OPERATOR'S WELL# TAPEATS UNIT #2H

WELL TYPE: OIL \_\_\_ GAS X LIQUID INJECTION \_\_\_ WASTE DISPOSAL \_\_\_ 47 - 095 - 02714 MID (IF "GAS") PRODUCTION X STORAGE \_\_\_ DEEP \_\_\_ SHALLOW X STATE COUNTY PERMIT LOCATION: ELEVATION 1,268'-ORIGINAL 1,243'-PROPOSED WATERSHED OUTLET MIDDLE ISLAND CREEK QUADRANGLE PORTER FALLS 7.5' DISTRICT ELLSWORTH COUNTY TYLER SURFACE OWNER KENNETH TOMBLIN ET AL ACREAGE 290.32 ACRES +/- 03/19/2021 OIL & GAS ROYALTY OWNER S. A. SMITH AND C. B. MORRIS HEIRS TRUST; MICHAEL LEE TOMBLIN; WALTER R. MYERS; LEASE ACREAGE 290.32 AC +/-; 55 AC +/-; 40 AC +/-; JAMES C. BARNHART; VIRGIL STEVENS; BOUNTY MINERALS LLC; ANTERO MINERALS; BRC APPALACHIAN MINERALS I LLC; NILE DEAN HARRIS; 40 AC +/-; 57.47 AC +/-; 32 AC +/-; 3 AC +/-; 33.38 AC +/-; 99.88 AC +/-; MERCER MINERALS LLC; MERCER MINERALS LLC; MERCER MINERALS LLC; MERCER MINERALS LLC; EVA GENE TAYLOR; BRC APPALACHIAN MINERALS I LLC 158 AC +/-; 34.75 AC +/-; 131.98 AC +/-; 106.5 AC +/-; 52 AC +/-; 33 AC +/- PROPOSED WORK: DRILL \_\_\_ CONVERT \_\_\_ DRILL DEEPER X REDRILL \_\_\_ FRACTURE OR STIMULATE X PLUG OFF OLD FORMATION \_\_\_ PERFORATE NEW FORMATION X OTHER PHYSICAL CHANGE IN WELL (SPECIFY) MOD-BHL PLUG & ABANDON CLEAN OUT & REPLUG TARGET FORMATION MARCELLUS ESTIMATED DEPTH 7,300' TVD 26,900' MD WELL OPERATOR ANTERO RESOURCES CORP. DESIGNATED AGENT DIANNA STAMPER - CT CORPORATION SYSTEM ADDRESS 1615 WYNKOOP ST. ADDRESS 5400 D BIG TYLER ROAD CHARLESTON, WV 25313

Table listing landowners in Ellsworth District - Tyler County. Owners include Josh Amos, Albert Rice Est., Wash Beatty Et Al, Gladys Conley, Glenn Simmons, Charles Gump, Harold Yost, BB Farm Investments LLC, Hezekiah Fluharty, EQT Production Co., Maurice Carlisle Et Al, Maurice Carlisle Et Al, Maurice Carlisle Et Al, BB Farm Investments LLC, BB Farm Investments LLC, Paul Thomas, BB Farm Investments LLC, Sarah Sine, Elzie Hall, Edward Quirk, Nile Harris, Darrell Sole Et Al, Stanley Satkowski, William Murner, Gary Sole, Gary Sole, Florence Leek, Nile Harris, Roger Eddy Jr., Ronnie Eddy, Donald Harris, Richard Neff, Richard Neff, Richard Neff, Edward Quirk, Edward Quirk, Edward Quirk, Edward Quirk, Michael Martin.

11,552' TO BOTTOM HOLE

LONGITUDE 80°47'30"

LONGITUDE 80°47'30"

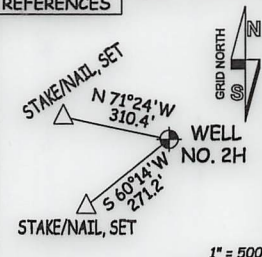
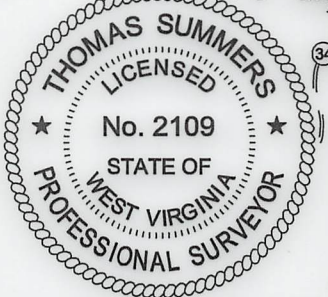

COUNTY NAME PERMIT

LATITUDE 39°32'30"

5,347'

LATITUDE 39°35'00"

8,052' TO BOTTOM HOLE

Antero Resources Corporation Well No. Tapeats Unit 2H

NOTES: WELL 2H TOP HOLE INFORMATION: N: 369,487ft E: 1,630,212ft LAT: 39°30'25.39" LON: 80°48'38.22" BOTTOM HOLE INFORMATION: N: 385,757ft E: 1,627,740ft LAT: 39°33'05.83" LON: 80°49'12.80" WEST VIRGINIA COORDINATE SYSTEM OF 1927 NORTH ZONE. ZONE WAS DERIVED FROM MEASUREMENTS TAKEN WITH TRIMBLE GEOXT SUBMETER MAPPING GRADE GPS UNIT. PLAT ORIENTATION, CORNER, AND WELL REFERENCE TIE LINES ARE BASED ON GRID NORTH.

(NAD) 83 (UTM) ZONE 17 COORDS: WELL 2H TOP HOLE INFORMATION: N: 4,373,073m E: 516,296m BOTTOM HOLE INFORMATION: N: 4,378,018m E: 515,461m

(NAD) 27 (UTM) ZONE 17 COORDS: WELL 2H TOP HOLE INFORMATION: N: 14,346,610ft E: 1,693,835ft POINT OF ENTRY INFORMATION: N: 14,347,546ft E: 1,696,306ft BOTTOM HOLE INFORMATION: N: 14,362,831ft E: 1,691,093ft

NO OCCUPIED DWELLINGS OR BUILDINGS TWO THOUSAND FIVE HUNDRED (2,500) SQUARE FEET OR LARGER USED TO HOUSE OR SHELTER DAIRY CATTLE OR POULTRY HUSBANDRY ARE LOCATED WITHIN SIX HUNDRED TWENTY-FIVE (625) FEET OF THE CENTER OF THE WELL PAD.

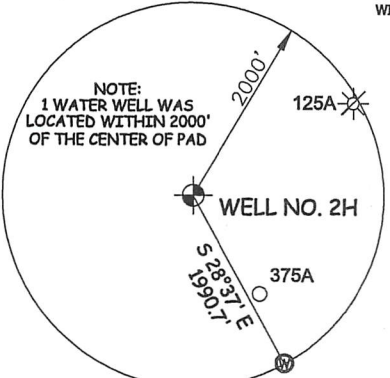
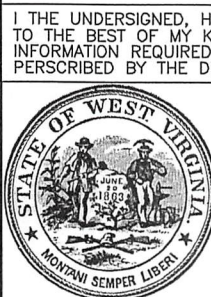
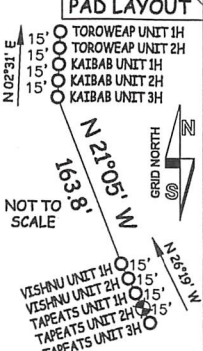

Table listing landowners in Ellsworth District - Tyler County, including names like Michael Martin, Darrell Sole, Jean Neel Et Al, etc.



STATE OF WEST VIRGINIA, DIVISION OF ENVIRONMENTAL PROTECTION, OFFICE OF OIL AND GAS. WILLOW LAND SURVEYING PLLC 220 MASONIC AVE. PENNSBORO WEST VIRGINIA 26415



JOB # 20-009WA DRAWING # TAPEATS2H SCALE 1" = 2000' MINIMUM DEGREE OF ACCURACY SUBMETER PROVEN SOURCE OF ELEV. SUBMETER MAPPING GRADE GPS STATE OF WEST VIRGINIA DEPARTMENT OF ENERGY DIVISION OF OIL AND GAS

LEGEND: Surface Owner Boundary Lines +/-, Adjoining Surface Tracts +/-, Found monument, as noted. THOMAS SUMMERS P.S. 2109 DATE 02/18/21 OPERATOR'S WELL# TAPEATS UNIT #2H

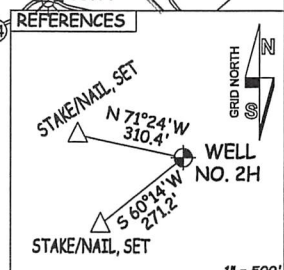
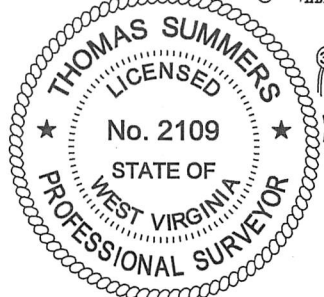

Table listing landowners in Ellsworth District - Tyler County, including names like Josh Amos, Albert Rice Est., Wash Beatty Et Al, etc.

WELL TYPE: OIL \_\_\_ GAS X LIQUID INJECTION \_\_\_ WASTE DISPOSAL \_\_\_ 47 - 095 - 02714 MOD (IF "GAS") PRODUCTION X STORAGE \_\_\_ DEEP \_\_\_ SHALLOW X STATE COUNTY PERMIT LOCATION: ELEVATION 1,268'-ORIGINAL 1,243'-PROPOSED WATERSHED OUTLET MIDDLE ISLAND CREEK QUADRANGLE PORTER FALLS 7.5 DISTRICT ELLSWORTH COUNTY TYLER SURFACE OWNER KENNETH TOMBLIN ET AL ACREAGE 290.32 ACRES +/- 03/19/2021 OIL & GAS ROYALTY OWNER S. A. SMITH AND C. B. MORRIS HEIRS TRUST; MICHAEL LEE TOMBLIN; WALTER R. MYERS; LEASE ACREAGE 290.32 AC.±; 55 AC.±; 40 AC.±; JAMES C. BARNHART; VIRGIL STEVENS; BOUNTY MINERALS LLC; ANTERO MINERALS; BRC APPALACHIAN MINERALS I LLC; NILE DEAN HARRIS; 40 AC.±; 57.47 AC.±; 32 AC.±; 3 AC.±; 33.38 AC.±; 99.88 AC.±; MERCER MINERALS LLC; MERCER MINERALS LLC; MERCER MINERALS LLC; MERCER MINERALS LLC; EVA GENE TAYLOR; BRC APPALACHIAN MINERALS I LLC 158 AC.±; 34.75 AC.±; 131.98 AC.±; 106.5 AC.±; 52 AC.±; 33 AC.± PROPOSED WORK: DRILL \_\_\_ CONVERT \_\_\_ DRILL DEEPER X REDRILL \_\_\_ FRACTURE OR STIMULATE X PLUG OFF OLD FORMATION \_\_\_ PERFORATE NEW FORMATION X OTHER PHYSICAL CHANGE IN WELL (SPECIFY) MOD-BHL PLUG & ABANDON CLEAN OUT & REPLUG TARGET FORMATION MARCELLUS ESTIMATED DEPTH 7,300' TVD 26,900' MD WELL OPERATOR ANTERO RESOURCES CORP. DESIGNATED AGENT DIANNA STAMPER - CT CORPORATION SYSTEM ADDRESS 1615 WYNKOOP ST. ADDRESS 5400 D BIG TYLER ROAD DENVER, CO 80202 CHARLESTON, WV 25313

COUNTY NAME PERMIT



WW-6A1

Operator's Well Number                      Tapeats Unit 2H

INFORMATION SUPPLIED UNDER WEST VIRGINIA CODE  
Chapter 22, Article 6A, Section 5(a)(5)  
IN LIEU OF FILING LEASE(S) AND OTHER CONTINUING CONTRACT(S)

Under the oath required to make the verification on page 1 of this Notice and Application, I depose and say that I am the person who signed the Notice and Application for the Applicant, and that –

- (1) the tract of land is the same tract described in this Application, partly or wholly depicted in the accompanying plat, and described in the Construction and Reclamation Plan;
- (2) the parties and recordation data (if recorded) for lease(s) or other continuing contract(s) by which the Applicant claims the right to extract, produce or market the oil or gas are as follows:

Grantor, lessor, etc.	Grantee, lessee, etc.	Royalty	Book/Page
<u>S.A. Smith &amp; C. B. Morris Heirs Trust Lease</u>			
S.A. Smith & C. B. Morris Trust Heirs	Antero Resources Corporation	1/8+	0022/0268
<u>Michael Lee Tomblin Lease</u>			
Michael Lee Tomblin	Antero Resources Corporation	1/8	0420/0497
<u>Walter R. Myers Lease</u>			
Walter R. Myers	Petroedge Energy LLC	1/8+	0411/0351
Petroedge Energy LLC	Statoil USA Onshore Properties	Assignment	0436/0001
Statoil USA Onshore Properties	EQT Production Company	Assignment	0539/0239
EQT Production Company	Antero Resources Corporation	Assignment	0663/0001
<u>Michael Lee Tomblin Lease</u>			
Michael Lee Tomblin	Antero Resources Corporation	1/8	0420/0497
<u>James C. Barnhart Lease</u>			
James C. Barnhart	Petroedge Energy LLC	1/8+	0400/0184
Petroedge Energy LLC	Statoil USA Onshore Properties	Assignment	0436/0001
Statoil USA Onshore Properties	EQT Production Company	Assignment	0539/0239
EQT Production Company	Antero Resources Corporation	Assignment	0663/0001
<u>Virgil Stevens Lease</u>			
Virgil Stevens	Antero Resources Corporation	1/8+	0624/0048
<u>Bounty Minerals LLC Lease</u>			
Bounty Minerals LLC	Antero Resources Corporation	1/8+	0508/0268
<u>Antero Minerals Lease</u>			
<u>BRC Appalachian Minerals I LLC Lease</u>			
BRC Appalachian Minerals I LLC	Statoil USA Onshore Properties	1/8	0369/0300
Statoil USA Onshore Properties	EQT Production Company	Assignment	0539/0239
EQT Production Company	Antero Resources Corporation	Assignment	0663/0001
<u>Nile Dean Harris Lease</u>			
Nile Dean Harris	Statoil USA Onshore Properties	1/8+	0449/0154
Statoil USA Onshore Properties	EQT Production Company	Assignment	0539/0239
EQT Production Company	Antero Resources Corporation	Assignment	0663/0001

RECEIVED  
Office of Oil and Gas

MAR 03 2021

WV Department of  
Environmental Protection

\*Partial Assignments to Antero Resources Corporation include 100% rights to extract, produce and market the oil and gas from the Marcellus and any other formations completed with this well.

INFORMATION SUPPLIED UNDER WEST VIRGINIA CODE  
 Chapter 22, Article 6A, Section 5(a)(5)  
 IN LIEU OF FILING LEASE(S) AND OTHER CONTINUING CONTRACT(S)

Under the oath required to make the verification on page 1 of this Notice and Application, I depose and say that I am the person who signed the Notice and Application for the Applicant, and that –

- (1) the tract of land is the same tract described in this Application, partly or wholly depicted in the accompanying plat, and described in the Construction and Reclamation Plan;
- (2) the parties and recordation data (if recorded) for lease(s) or other continuing contract(s) by which the Applicant claims the right to extract, produce or market the oil or gas are as follows:

Grantor, lessor, etc.	Grantee, lessee, etc.	Royalty	Book/Page
<u>Mercer Minerals LLC Lease (TM 11 PCL 12)</u> Mercer Minerals LLC	Antero Resources Corporation	1/8+	0547/0640
<u>Mercer Minerals LLC Lease (TM 11 PCL 14)</u> Mercer Minerals LLC	Antero Resources Corporation	1/8+	0547/0640
<u>Mercer Minerals LLC Lease (TM 11 PCL 15)</u> Mercer Minerals LLC	Antero Resources Corporation	1/8+	0547/0640
<u>Eva Gene Taylor Lease</u> Eva Gene Taylor	Antero Resources Corporation	1/8+	0575/0413

RECEIVED  
 Office of Oil and Gas  
 MAR 03 2021  
 WV Department of  
 Environmental Protection

\*Partial Assignments to Antero Resources Corporation include 100% rights to extract, produce and market the oil and gas from the Marcellus and any other formations completed with this well.

WW-6A1  
(5/13)

Operator's Well No. Tapeats Unit 2H

**INFORMATION SUPPLIED UNDER WEST VIRGINIA CODE  
Chapter 22, Article 6A, Section 5(a)(5)  
IN LIEU OF FILING LEASE(S) AND OTHER CONTINUING CONTRACT(S)**

Under the oath required to make the verification on page 1 of this Notice and Application, I depose and say that I am the person who signed the Notice and Application for the Applicant, and that –

- (1) the tract of land is the same tract described in this Application, partly or wholly depicted in the accompanying plat, and described in the Construction and Reclamation Plan;
- (2) the parties and recordation data (if recorded) for lease(s) or other continuing contract(s) by which the Applicant claims the right to extract, produce or market the oil or gas are as follows:

Lease Name or Number	Grantor, Lessor, etc.	Grantee, Lessee, etc.	Royalty	Book/Page
<b><u>BRC Appalachian Minerals I LLC Lease</u></b>				
	BRC Appalachian Minerals I LLC	Statoil USA Onshore Properties	1/8	0378/0764
	Statoil USA Onshore Properties	EQT Production Company	Assignment	0539/0239
	<b>EQT Production Company</b>	<b>Antero Resources Corporation</b>	<b>Assignment</b>	<b>0663/0001</b>

\*Partial Assignments to Antero Resources Corporation include 100% rights to extract, produce and market the oil and gas from the Marcellus and any other formations completed with this well.

**Acknowledgement of Possible Permitting/Approval  
In Addition to the Office of Oil and Gas**

The permit applicant for the proposed well work addressed in this application hereby acknowledges the possibility of the need for permits and/or approvals from local, state, or federal entities in addition to the DEP, Office of Oil and Gas, including but not limited to the following:

- WV Division of Water and Waste Management
- WV Division of Natural Resources WV Division of Highways
- U.S. Army Corps of Engineers
- U.S. Fish and Wildlife Service
- County Floodplain Coordinator

The applicant further acknowledges that any Office of Oil and Gas permit in no way overrides, replaces, or nullifies the need for other permits/approvals that may be necessary and further affirms that all needed permits/approvals should be acquired from the appropriate authority before the affected activity is initiated.

Well Operator: Antero Resources Corporation

By: Tim Rady

Its: VP of Land

RECEIVED  
Office of Oil and Gas

MAR 03 2021

WV Department of  
Environmental Protection

\*Co-tenancy utilization – At least 7 mineral owners in tract. At least 75% of the royalty owners have executed a lease on the tract. The interests of the remaining co-tenants were acquired pursuant to the Co-tenancy Modernization and Majority Protection Act



Antero Resources  
1615 Wynkoop Street  
Denver, CO 80202  
Office 303.357.7310  
Fax 303.357.7315

March 1, 2021

West Virginia Department of Environmental Protection  
Office of Oil and Gas  
Attn: Ms. Laura Adkins  
601 57<sup>th</sup> Street  
Charleston, WV 25304

Check # 226649  
\$5,000.00  
2/18/2021

Ms. Laura Adkins:

Antero Resources Corporation (Antero) would like to submit the following permit modifications for the following approved wells on the existing Grand Pad: Tapeats Unit 1H (API # 47-095-02713) & Tapeats Unit 2H (API # 47-095-02714).

Attached you will find the following documents:

- REVISED Form WW-6B, which shows the updated POE & Measured Depth
- REVISED Form WW-6A1, which shows the new leases we will be drilling into
- REVISED Mylar Plat, which shows the new Lateral Length & Estimated Measured Depth
- AOR & As-Built Design

If you have any questions please feel free to contact me at (303) 357-7223.

Thank you in advance for your consideration.

Sincerely,

Megan Griffith  
Permitting Agent  
Antero Resources Corporation

Enclosures

Inspector Signed  
Copies  
vs  
Stamped?  
Tomblin Kenneth  
vs  
Michael Lee }

MAR 03 2021

WV Department of  
Environmental Protection

03/19/2021