

LATITUDE 39°32'30"

5,347'

LATITUDE 39°35'00"

8,052' TO BOTTOM HOLE

Antero Resources Corporation  
Well No. Tapeats Unit 2H

NOTES:  
WELL 2H TOP HOLE INFORMATION:  
N: 369,487ft E: 1,630,212ft  
LAT: 39°30'25.39" LON: 80°48'38.22"  
BOTTOM HOLE INFORMATION:  
N: 385,757ft E: 1,627,740ft  
LAT: 39°33'05.83" LON: 80°49'12.80"  
WEST VIRGINIA COORDINATE SYSTEM OF 1927 NORTH ZONE. ZONE WAS DERIVED FROM MEASUREMENTS TAKEN WITH TRIMBLE GEOXT SUBMETER MAPPING GRADE GPS UNIT. PLAT ORIENTATION, CORNER, AND WELL REFERENCE TIE LINES ARE BASED ON GRID NORTH.

(NAD) 83 (UTM) ZONE 17 COORDS:  
WELL 2H TOP HOLE INFORMATION:  
N: 4,373,073m E: 516,296m  
BOTTOM HOLE INFORMATION:  
N: 4,378,018m E: 515,461m

(NAD) 27 (UTM) ZONE 17 COORDS:  
WELL 2H TOP HOLE INFORMATION:  
N: 14,346,610ft E: 1,693,835ft  
POINT OF ENTRY INFORMATION:  
N: 14,347,546ft E: 1,696,306ft  
BOTTOM HOLE INFORMATION:  
N: 14,362,831ft E: 1,691,093ft

NOTE  
NO OCCUPIED DWELLINGS OR BUILDINGS TWO THOUSAND FIVE HUNDRED (2,500) SQUARE FEET OR LARGER USED TO HOUSE OR SHELTER DAIRY CATTLE OR POULTRY HUSBANDRY ARE LOCATED WITHIN SIX HUNDRED TWENTY-FIVE (625) FEET OF THE CENTER OF THE WELL PAD.



Ellsworth District - Tyler County

11-60	Michael Martin
16-01	Darrell Sole
16-11	Jean Neel Et Al
16-12	Richard Neff
16-13	Gail Neff
16-13.1	Gail Neff
16-14	James Barnhart
16-15	Harvey Miller Et Al
16-16	Harvey Miller Et Al
16-28	Kenneth Tomblin
16-29	Michael Tomblin
16-30	Christopher Investments Inc.
17-01	Richard Neff
17-58	Christopher Investments Inc.
17-59	Michael Beegle
17-63	Edna Roberts

2H BOTTOM HOLE

2H TOP HOLE

PAD LAYOUT

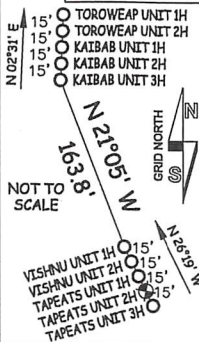

STATE OF WEST VIRGINIA, DIVISION OF ENVIRONMENTAL PROTECTION, OFFICE OF OIL AND GAS

WILLOW LAND SURVEYING PLLC  
220 MASONIC AVE. PENNSBORO WEST VIRGINIA 26415

NOT TO SCALE

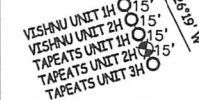

JOB # 20-009WA  
DRAWING # TAPEATS2H  
SCALE 1" = 2000'  
MINIMUM DEGREE OF ACCURACY SUBMETER  
PROVEN SOURCE OF ELEV. SUBMETER MAPPING GRADE GPS  
STATE OF WEST VIRGINIA DEPARTMENT OF ENERGY DIVISION OF OIL AND GAS

LEGEND  
Surface Owner Boundary Lines +/-  
Adjoining Surface Tracts +/-  
Found monument, as noted  
THOMAS SUMMERS P.S. 2109  
DATE 02/18/21  
OPERATOR'S WELL# TAPEATS UNIT #2H

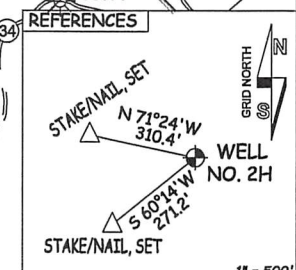
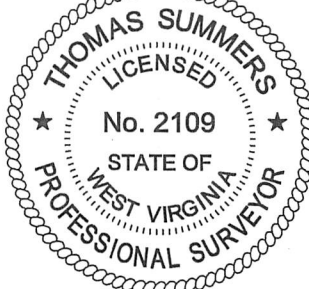

Ellsworth District - Tyler County

07-05	Josh Amos
07-19	Albert Rice Est.
07-20	Wash Beatty Et Al
07-21	Gladys Conley
07-22	Glenn Simmons
07-22.1	Charles Gump
07-23	Harold Yost
07-24	BB Farm Investments LLC
07-25	BB Farm Investments LLC
07-35	Hezekiah Fluharty
11-08	EQT Production Co.
11-09	Maurice Carlisle Et Al
11-10	Maurice Carlisle Et Al
11-11	Maurice Carlisle Et Al
11-12	BB Farm Investments LLC
11-13	BB Farm Investments LLC
11-14	Paul Thomas
11-15	BB Farm Investments LLC
11-18.1	Sarah Sine
11-19	Elzie Hall
11-20	Edward Quirk
11-22	Nile Harris
11-23	Darrell Sole Et Al
11-24	Stanley Satkowski
11-25	William Murner
11-26	Gary Sole
11-27	Gary Sole
11-28	Florence Leek
11-52	Nile Harris
11-53	Roger Eddy Jr.
11-54	Ronnie Eddy
11-55	Donald Harris
11-56	Richard Neff
11-56.1	Richard Neff
11-56.2	Richard Neff
11-57	Edward Quirk
11-58	Edward Quirk
11-59	Edward Quirk
11-59.1	Edward Quirk
11-60	Michael Martin

WELL TYPE: OIL \_\_\_ GAS X LIQUID INJECTION \_\_\_ WASTE DISPOSAL \_\_\_ 47 - 095 - 02714 MOD  
(IF "GAS") PRODUCTION X STORAGE \_\_\_ DEEP \_\_\_ SHALLOW X STATE COUNTY PERMIT  
LOCATION: ELEVATION 1,268'-ORIGINAL 1,243'-PROPOSED WATERSHED OUTLET MIDDLE ISLAND CREEK  
QUADRANGLE PORTER FALLS 7.5' DISTRICT ELLSWORTH COUNTY TYLER  
SURFACE OWNER KENNETH TOMBLIN ET AL ACREAGE 290.32 ACRES +/- 03/19/2021  
OIL & GAS ROYALTY OWNER S. A. SMITH AND C. B. MORRIS HEIRS TRUST; MICHAEL LEE TOMBLIN; WALTER R. MYERS; LEASE ACREAGE 290.32 AC.±; 55 AC.±; 40 AC.±;  
JAMES C. BARNHART; VIRGIL STEVENS; BOUNTY MINERALS LLC; ANTERO MINERALS; BRC APPALACHIAN MINERALS I LLC; NILE DEAN HARRIS; 40 AC.±; 57.47 AC.±; 32 AC.±; 3 AC.±; 33.38 AC.±; 99.88 AC.±;  
MERCER MINERALS LLC; MERCER MINERALS LLC; MERCER MINERALS LLC; MERCER MINERALS LLC; EVA GENE TAYLOR; BRC APPALACHIAN MINERALS I LLC 158 AC.±; 34.75 AC.±; 131.98 AC.±; 106.5 AC.±; 52 AC.±; 33 AC.±;  
PROPOSED WORK: DRILL \_\_\_ CONVERT \_\_\_ DRILL DEEPER X REDRILL \_\_\_ FRACTURE OR STIMULATE X  
PLUG OFF OLD FORMATION \_\_\_ PERFORATE NEW FORMATION X OTHER PHYSICAL CHANGE IN WELL  
(SPECIFY) MOD-BHL PLUG & ABANDON CLEAN OUT & REPLUG  
TARGET FORMATION MARCELLUS ESTIMATED DEPTH 7,300' TVD 26,900' MD  
WELL OPERATOR ANTERO RESOURCES CORP. DESIGNATED AGENT DIANNA STAMPER - CT CORPORATION SYSTEM  
ADDRESS 1615 WYNKOOP ST. ADDRESS 5400 D BIG TYLER ROAD  
FORM WW-6 DENVER, CO 80202 CHARLESTON, WV 25313

COUNTY NAME PERMIT