

Antero Resources Corporation
Well No. Mills Unit 1H
BHL MOD
Page 1 of 2

Well Location References
Not to Scale

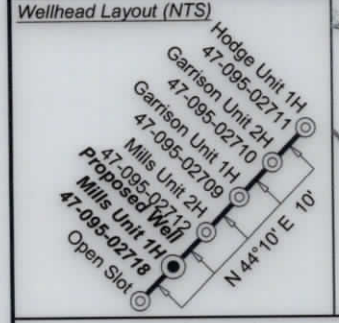
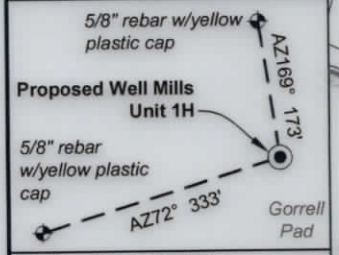

- Legend**
- Proposed gas well
 - Well Reference, as noted
 - Monument, as noted
 - Existing Well, as noted
 - Digitized Well, as noted
 - Existing Road
 - Surface boundary (approx.)
 - Interior surface tracts (approx.)

Notes:
West Virginia Coordinate System of 1927, North Zone based upon Differential GPS Measurements.
Well No. Mills Unit 1H Top Hole coordinates are
N: 337,895.38' Latitude: 39°25'05.26"
E: 1,578,830.97' Longitude: 80°59'27.00"
Bottom Hole coordinates are
N: 347,041.20' Latitude: 39°26'34.58"
E: 1,572,400.07' Longitude: 81°00'50.89"
UTM Zone 17, NAD 1983
Top Hole Coordinates Bottom Hole Coordinates
N: 4,363,186.931m N: 4,365,940.482m
E: 500,803.646m E: 498,797.940m
Plat orientation and corner and well references are based upon the grid north meridian.
Well location references are based upon the magnetic meridian.

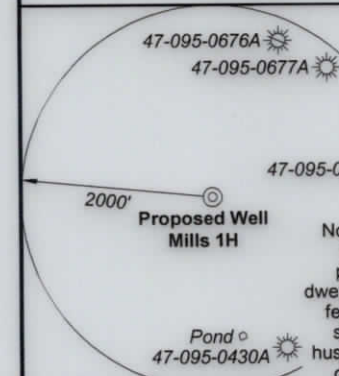

Notes: Well No. Mills Unit 1H
UTM NAD 1927 (USSF)
Top Hole Coordinates
N: 14,314,175.76'
E: 1,643,005.76'
Point of Entry Coordinates
N: 14,314,153.08'
E: 1,639,709.55'
Bottom Hole Coordinates
N: 14,323,209.80'
E: 1,636,425.34'

I, the undersigned, hereby certify that this plat is correct to the best of my knowledge and belief and shows all the information required by law and the rules issued and prescribed by the Department of Environmental Protection.

Bradley D. Miller
Bradley D. Miller, P.S. 2167

Tag	Bearing	Dist.
L1	S 83°24' E	413.9'
L2	S 26°28' E	2,249.6'
L3	N 48°08' W	2,526.2'
L4	N 02°59' W	2,151.3'
L5	S 89°26' W	3,297.4'

FILE NO: 51-54-M-17
DRAWING NO: Mills Unit 1H Well Plat
SCALE: 1" = 1500'
MINIMUM DEGREE OF ACCURACY: Submeter
PROVEN SOURCE OF ELEVATION: CORS, Bridgeport, WV

STATE OF WEST VIRGINIA
DEPARTMENT OF ENVIRONMENTAL PROTECTION
OIL AND GAS DIVISION

DATE: January 25 20 21
OPERATOR'S WELL NO. Mills Unit 1H
API WELL NO
47 - 095 - 02718
STATE COUNTY PERMIT

WELL TYPE: OIL GAS LIQUID INJECTION WASTE DISPOSAL
(IF GAS) PRODUCTION: STORAGE DEEP SHALLOW
LOCATION: ELEVATION: 1045' WATERSHED: Outlet Middle Island Creek QUADRANGLE: Top: Middlebourne Btm: Bens Run
DISTRICT: Union / Meade COUNTY: Tyler
SURFACE OWNER: Elizabeth Gorrell ACREAGE: 242.50
ROYALTY OWNER: Elizabeth Gorrell, et al; David C. Henderson; Sharon A. Brock (2); LEASE NO: ACREAGE: 27.725; 172.68125; 6.61;
PROPOSED WORK: DRILL CONVERT DRILL DEEPER FRACTURE OR STIMULATE PLUG OFF OLD FORMATION
 PERFORATE NEW FORMATION OTHER PHYSICAL CHANGE IN WELL (SPECIFY) BHL MOD
 PLUG AND ABANDON CLEAN OUT AND REPLUG TARGET FORMATION: Marcellus Shale ESTIMATED DEPTH: 20,700' MD

WELL OPERATOR: Antero Resources Corporation DESIGNATED AGENT: Dianna Stamper - CT Corporation System
ADDRESS: 1615 Wynkoop Street ADDRESS: 5400 D Big Tyler Road
Denver CO 80202 Charleston, WV 25313



ID	Lease
A	Elizabeth Gorrell, et al
B	Wilma Jane Benefield
C	Janet Sue Baker
D	Sharon A. Brock
E	Antero Minerals, LLC
F	David C. Henderson
G	Wilma Jane Benefield
H	Mary C. Robinson Living Trust
I	Sharon A. Brock
J	Harry E. West, Jr. et ux
L	Richard W. & Elisa L. Barnhart
M	Gregory L. & Tammy L. Bever
N	Randy M. Myers
O	J&N Management Enterprises, LLC
P	Fisher Oil Co.
Q	Dale V. Hadley
R	Ernest P. Herbold, Jr., et ux
S	Wells Cattle Farms
T	Ernest P. Herbold, Jr., et ux
U	WVDNR
V	Charles N. Grachanin
W	Waco Oil & Gas Co. Inc.
X	Cheryl A. Dairympole
Y	Gerald W. Silliman
Z	City of Sistersville
AA	BRC Appalachian Minerals I, LLC

No.	TM / Par	Owner	Bk / Pg	Ac.
1	7 / 15	Elizabeth Gorrell	321 / 360	242.50
2	7 / 5	Coastal Forest Resources Co.	301 / 131	74.30
3	7 / 14	Russell G. Smith & Ruth M. Smith Family Trust	541 / 608	50.00
4	7 / 9	Russell G. Smith & Ruth M. Smith Family Trust	541 / 608	66.85
5	7 / 13	Russell E. & Janice Smith	328 / 867	6.00
6	7 / 9.1	Russell E. & Janice Smith	332 / 234	1.65
7	7 / 13.1	Russell E. & Janice Smith	328 / 867	2.60
8	7 / 19	Darlene Henderson	W47 / 263	122.83
9	7 / 12.2	Gary W. Freeland	336 / 530	19.97
10	7 / 23	David Henderson & Sharley Shortridge	W47 / 263	16.07
11	7 / 12	Wilma Jane (Benefield) Wagner	W35 / 225	110.30
12	7 / 4	Marcia A. Hill	506 / 479	74.50
13	7 / 8	John Wells	428 / 412	52.39
14	7 / 2	Paul R. Wells & Susie Cunningham	269 / 967	53.85
15	7 / 3	Harry Edward West, Jr. & Noreen Marie West	328 / 530	88.00
16	4 / 20.1	Richard W. Barnhart Jr.	213 / 162	49.74
17	4 / 26	Gregory L. & Tammy L. Bever	620 / 145	53.30
18	4 / 21	Lori C. Kemp & Ernest P. Herbold, et al	343 / 714	27.27
19	4 / 10	Lori C. Kemp & Ernest P. Herbold, et al	343 / 714	84.0
20	4 / 20	Cecil E. Jordan, Jr., et al	337 / 702	103.59
21	4 / 9	Lori C. Kemp & Ernest P. Herbold, et al	343 / 714	35.18
22	4 / 8	Wells Cattle Farm, Inc.	331 / 164	155.00
23	4 / 8.1	Lori C. Kemp & Ernest P. Herbold, et al	343 / 714	6.61
24	15 / 26	Jay L. Summers & Carla Summers	429 / 201	24.18
25	15 / 25	Charles & Marie Grachanin	344 / 722	1.25
26	15 / 24	Cheryl Dalrymple, et al	337 / 108A	8.79
27	15 / 23	Cheryl Dalrymple, et al	337 / 110A	3.13
28	15 / 22	Gerald Silliman, et al	180 / 215	2.86
29	15 / 21	Gerald Silliman, et al	180 / 215	3.38
30	15 / 20	Augusta Lauderman, et al	133 / 455	3.00
31	15 / 18.1	Amy & Howard D. Spurlock, II	380 / 796	2.43
32	15 / 18	Terry L. & Daphne R. Heinzman	356 / 472	15.25

FILE NO: 51-54-M-17
DRAWING NO: Mills Unit 1H Well Plat
SCALE: 1" = 1500'
MINIMUM DEGREE OF ACCURACY: Submeter
PROVEN SOURCE OF ELEVATION: CORS, Bridgeport, WV

STATE OF WEST VIRGINIA
DEPARTMENT OF ENVIRONMENTAL PROTECTION
OIL AND GAS DIVISION

DATE: January 25 20 21
OPERATOR'S WELL NO. Mills Unit 1H
API WELL NO
47 - 095 - 02718
STATE COUNTY PERMIT

WELL TYPE: OIL GAS LIQUID INJECTION WASTE DISPOSAL
(IF GAS) PRODUCTION: STORAGE DEEP SHALLOW
As-Built

LOCATION: ELEVATION: 1045' WATERSHED: Outlet Middle Island Creek QUADRANGLE: Top: Middlebourne
Bottom: Bens Run 08/12/2021
DISTRICT: Union / Meade COUNTY: Tyler
SURFACE OWNER: Elizabeth Gorrell ACREAGE: 242.50
ROYALTY OWNER: Elizabeth Gorrell, et al; David C. Henderson; Sharon A. Brock (2); LEASE NO: ACREAGE: 27.725; 172.68125; 6.61;

PROPOSED WORK: DRILL CONVERT DRILL DEEPER FRACTURE OR STIMULATE PLUG OFF OLD FORMATION
 PERFORATE NEW FORMATION OTHER PHYSICAL CHANGE IN WELL (SPECIFY) BHL MOD 6,700' TVD
 PLUG AND ABANDON CLEAN OUT AND REPLUG TARGET FORMATION: Marcellus Shale ESTIMATED DEPTH: 20,700' MD

WELL OPERATOR: Antero Resources Corporation DESIGNATED AGENT: Dianna Stamper - CT Corporation System
ADDRESS: 1615 Wynkoop Street ADDRESS: 5400 D Big Tyler Road
Denver CO 80202 Charleston, WV 25313