

Antero Resources
Well No. Pechora 2H
As-Drilled
Antero Resources Corporation

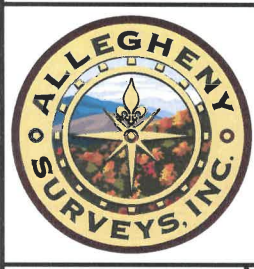

- Wellhead Layout**
- As-Drilled Well Pechora Unit 2H 47-095-02725 Pechora Unit 1H 47-095-02724
 - Whitmore Unit 2H 47-095-02727
 - Whitmore Unit 1H 47-095-02726
 - Wade Unit 2H 47-095-02728
 - Wade Unit 1H 47-095-02729

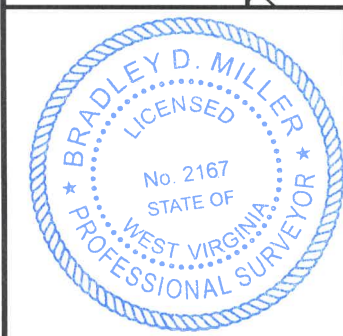

I, the undersigned, hereby certify that this plat is correct to the best of my knowledge and belief and shows all the information required by law and the rules issued and prescribed by the Department of Environmental Protection.

Bradley D. Miller
Bradley D. Miller, P.S. 2167

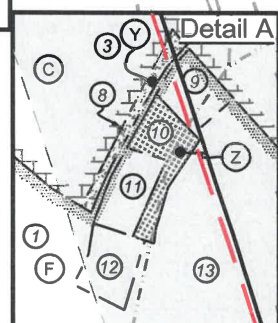
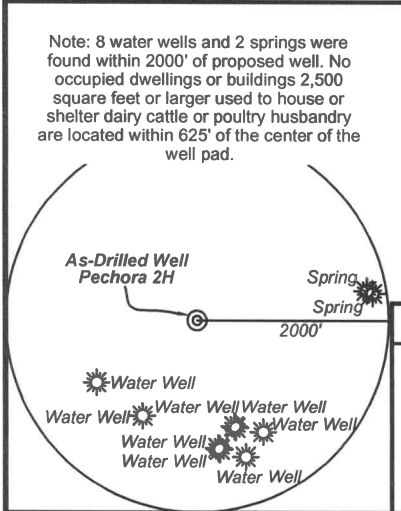

Legend

- Proposed gas well
- Found corner, as noted
- Existing Well, as noted
- Digitized Well
- Existing Road
- Existing Road
- Surface boundary (approx.)
- Interior surface tracts (approx.)

9,570' to Bottom Hole

Top Hole 7.5' Spot

4,985' to Top Hole

LATITUDE 39 - 30 - 00

TOP HOLE LONGITUDE 80 - 50 - 00

BTM HOLE LONGITUDE 80 - 47 - 30

536' to Top Hole

12,826 to Bottom Hole

Notes:
 West Virginia Coordinate System of 1927, North Zone based upon Differential GPS Measurements.
 Well No. Pechora Unit 2H Top Hole coordinates are
 N: 366,552.28' Latitude: 39°29'54.71"
 E: 1,618,771.84' Longitude: 80°51'04.00"
 Bottom Hole coordinates are
 N: 354,155.79' Latitude: 39°27'53.23"
 E: 1,625,767.52' Longitude: 80°49'32.03"
 UTM Zone 17, NAD 1983
 Top Hole Coordinates Bottom Hole Coordinates
 N: 4,372,120.836m N: 4,368,379.821m
 E: 512,825.960m E: 515,020.258m
 Plat orientation and corner and well references are based upon the grid north meridian.
 Well location references are based upon the magnetic meridian.

Pechora Unit 2H As-Drilled POE Coordinates West Virginia Coordinate System of 1927, North Zone
 N: 367,761.53'
 E: 1,621,250.52'
 Latitude: 39°30'07.03"
 Longitude: 80°50'32.21"
 UTM Zone 17, NAD 1983
 N: 4,372,501.867m
 E: 513,574.956m

Top Hole Coordinates, As-drilled data, and information was provided by Antero Resources Corporation. Allegheny Surveys Inc. (ASI) is not certifying the data and information provided. ASI is not responsible for any errors or inaccuracies with the data and information that has been provided.

	Bearing	Dist.
L1	S 24°25' E	971.2'
L2	N 34°36' W	1,621.2'
L3	N 41°29' E	1,196.7'
L4	N 72°51' E	1,001.4'

FILE NO: 121-54-E-19
 DRAWING NO: Pechora 2H As-Drilled
 SCALE: 1" = 2000'
 MINIMUM DEGREE OF ACCURACY: Submeter
 PROVEN SOURCE OF ELEVATION: WVDOT, Harrisville, WV

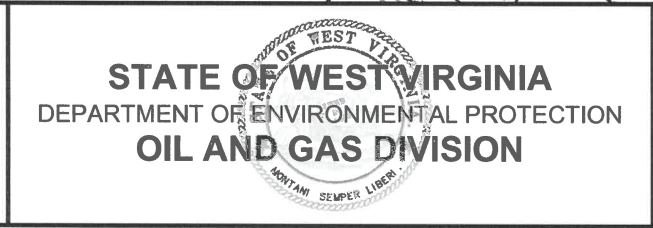

DATE: March 7 2022
 OPERATOR'S WELL NO. Pechora 2H
 API WELL NO
 47 - 095 - 02725
 STATE COUNTY PERMIT

WELL TYPE: OIL GAS LIQUID INJECTION WASTE DISPOSAL
 (IF GAS) PRODUCTION: STORAGE DEEP SHALLOW

LOCATION: ELEVATION: As-Built 1,004' WATERSHED: Outlet Middle Island Creek QUADRANGLE: Shirley
 DISTRICT: Ellsworth COUNTY: Tyler 0.563; 87.53;
 SURFACE OWNER: Roger D. Blizzard Ridgetop Capital II, LP; Kendra K. Wyke; Rodney A. Nash, et ux; 90.168; 177;
 William S. Nash, et al; Roberta L. Schickler; Anthony B. Parr; 3.3; 79.919;
 ROYALTY OWNER: Heritage Resources-Marcellus Minerals (2), LLC; Helen E. Boggs; Bruce Winkelmann; LEASE NO: ACREAGE: 102.62 51.50; 69.50;
 PROPOSED WORK: DRILL CONVERT DRILL DEEPER FRACTURE OR STIMULATE PLUG OFF OLD FORMATION 222; 271
 PERFORATE NEW FORMATION OTHER PHYSICAL CHANGE IN WELL (SPECIFY) As-Drilled
 PLUG AND ABANDON CLEAN OUT AND REPLUG TARGET FORMATION: Marcellus Shale ESTIMATED DEPTH: 21,771' MD 6,619' TVD

WELL OPERATOR: Antero Resources Corporation DESIGNATED AGENT: Dianna Stamper - CT Corporation System
 ADDRESS: 1615 Wynkoop Street ADDRESS: 5400 D Big Tyler Road
 Denver, CO 80202 Charleston, WV 25313

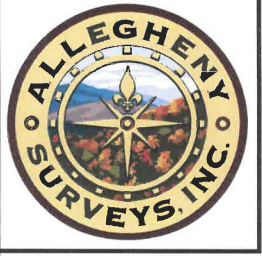

ID	TM/Par	Owner	DB/PG	Acres
1	15-33	Roger D. Blizzard & Ruth E. Spencer	340/170	102.62
2	15-31	Roger D. Blizzard & Ruth E. Spencer	342/782	25.00
3	15-38	Rodney A. & Candis L. Nash	351/701	85.48
4	16-23	Joseph L. Sitko	314/462	29.70
5	16-23.1	Bruce Winkelmann	334/195	3.30
6	16-44.1	Carl Straight	543/598	3.70
7	16-44	Robert A. Pyles, et al	335/482	87.82
8	16-60	Rodney & Candis Nash	378/815	0.56
9	16-54	David M. & Amanda B. Trimble	447/110	1.00
10	16-59	Rodney & Candis Nash	378/818	1.10
11	16-56	Rodney & Candis Nash	247/773	1.00
12	16-57	Rodney & Candis Nash	252/446	1.00
13	15-32	William S. & Opal Marie Nash	335/188	78.58
14	22-3	Harold L. & Deborah C. Hollaway	287/669	22.95
15	21-13	Alfred Lonzo Eddy	337/650	98.58
16	22-1.2	Earl David & Joyce Ann Giles	336/447	5.39
17	22-1.3	Ronald Hartline & Jamie Barnhart	591/741	2.02
18	22-2	Ronald Hartline & Jamie Barnhart	591/741	1.50
19	22-1	Robert I. Reed & Floyd W. Reed	321/763	42.32
20	22-1.4	David E. & Joyce A. Giles	546/764	4.76
21	22-1.1	Robert I. Reed & Floyd W. Reed	278/661	4.49
22	22-4	Stephen H. & Barbara J. Dunthorn	216/40	59.71
23	22-41	Anthony B. Parr	342/763	222.00
24	22-42	Sharon Christenson, et al	635/420	144.26
25	22-43	Loretta Louise Baker	253/131	38.97
26	28-9	David & Cheryl L. Barrick	263/606	87.53
27	28-31	Victor A. & Lorraine B. Weekley	AR49/717	226.25
28	22-37	B.W. Weekley	107/562	15.78
29	22-47	Tom J. & Jean A. Gump	628/629	24.66
30	28-7	Randall L. & Kathryn M. Wise	442/85	9.00
31	28-32	B.W. Weekley	107/562	33.31
32	28-8	Robert L. & Carolee J. Daniell	WB 43/267	30.00
33	28-31.7	Kordell Stewart & Katelyn Gogan	640/473	9.62
34	28-31.14	Ray Howe	363/416	0.51
35	28-31.18	Lorraine Weekley	AR49-717	0.08
36	28-31.16	William Morgan	374/472	0.50
37	28-31.12	William Morgan	374/472	1.00
38	28-31.15	James & Peggy Morgan	525/214	0.81
39	28-31.19	James & Peggy Morgan	377/10	0.14
40	28-31.9	James & Peggy Morgan	525/214	1.38
41	28-31.11	Ray Howe	356/678	1.27
42	28-31.13	Ray Howe	361/436	2.06
43	28-31.5	Kordell Stewart & Katelyn Gogan	640/473	1.75
44	28-31.6	Kordell Stewart & Katelyn Gogan	640/473	3.00
45	28-31.4	Victor & Lorraine Weekley	AR 49/717	3.64
46	28-31.8	Victor & Lorraine Weekley	AR 49/717	2.78
47	28-31.10	Danny Swiger & Peggy Smith	356/675	4.00
48	28-31.3	David Lantz & Rita Parr	618/689	5.00
49	28-30	Keith C. Smith	WB 35/228	30.13
50	5-9	Keith A. Riegelsberger	376/828	43.23
51	28-29	Keith C. Smith	WB 35/228	167.03
52	5-8	James L. & James C. Fitzpatrick	199/171	13.11
53	28-28	Ronald & Linda Hoover	184/383	136.22
54	5-5	Earnley Owens et al	WB 33/418	75.00
55	5-4	William D. Jr. & Saturina M. Morrison	341/35	52.78
56	21-53	Haessly Land & Timber, LLC	337/101A	89.88

Leases	
A	Heritage Resources, Marcellus Minerals, LLC
B	Jerry R. Brown
C	Helen E. Boggs
D	Joseph L. Sitko, et ux
E	Bruce Winkelmann
F	William S. Nash, et al
G	Alfred Lonzo Eddy
H	Roberta L. Schickler
I	Ridgetop Capital II, LP
J	Ridgetop Capital II, LP
K	Marjorie R. Asher Longston, et vir
L	Haessly Land & Timber, LLC
M	United Spinal Association
N	Anthony B. Parr
O	E. Lorna Howard Testamentary Trust
P	Loretta L. Baker
Q	Heritage Resources - Marcellus Minerals, LLC
R	Kendra K. Wyke
S	Rebecca Lynn Gebhardt
T	Randall L. Wise, et ux
U	Carolee J. Daniell
V	Richard L. White II
W	Keith C. & Phyllis J. Smith
X	Ronald L. Hoover, et ux
Y	Rodney A. Nash, et ux
Z	Randy Nash, et ux

FILE NO: 121-54-E-19
 DRAWING NO: Pechora 2H As-Drilled
 SCALE: 1" = 2000'
 MINIMUM DEGREE OF ACCURACY:
 Submeter
 PROVEN SOURCE OF ELEVATION:
 WVDOT, Harrisville, WV

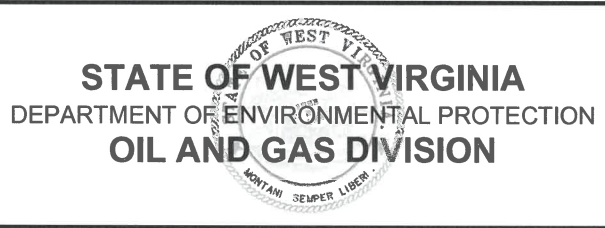

DATE: March 7 2022
 OPERATOR'S WELL NO. Pechora 2H
 API WELL NO
47 - 095 - 02725
 STATE COUNTY PERMIT

WELL TYPE: OIL GAS LIQUID INJECTION WASTE DISPOSAL
 (IF GAS) PRODUCTION: STORAGE DEEP SHALLOW
 LOCATION: ELEVATION: As-Built 1,004' WATERSHED: Outlet Middle Island Creek QUADRANGLE: Shirley
 DISTRICT: Ellsworth COUNTY: Tyler 0.563; 87.53;
 SURFACE OWNER: Roger D. Blizzard & Ruth E. Spencer Ridgetop Capital II, LP; Kendra K. Wyke; Rodney A. Nash, et ux; 90.168; 177;
 William S. Nash, et al; Roberta L. Schickler; Anthony B. Parr; ACREAGE: 102.62 3.3; 79.919;
 ROYALTY OWNER: Heritage Resources-Marcellus Minerals (2), LLC; Helen E. Boggs; Bruce Winkelmann; LEASE NO: _____ ACREAGE: 222; 271 51.50; 69.50;
 PROPOSED WORK: DRILL CONVERT DRILL DEEPER FRACTURE OR STIMULATE PLUG OFF OLD FORMATION
 PERFORATE NEW FORMATION OTHER PHYSICAL CHANGE IN WELL (SPECIFY) As-Drilled 6,619' TVD
 PLUG AND ABANDON CLEAN OUT AND REPLUG TARGET FORMATION: Marcellus Shale ESTIMATED DEPTH: 21,771' MD

WELL OPERATOR: Antero Resources Corporation DESIGNATED AGENT: Dianna Stamper - CT Corporation System
 ADDRESS: 1615 Wynkoop Street ADDRESS: 5400 D Big Tyler Road
Denver, CO 80202 Charleston, WV 25313