

**Antero Resources**  
**Well No. Wade 2H**  
**BHL MOD**  
**Antero Resources Corporation**

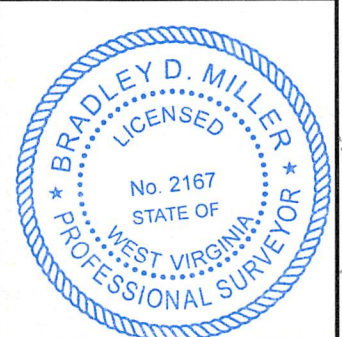

- Wellhead Layout**
- Pechora Unit 2H 47-095-0725
  - Pechora Unit 1H 47-095-02724
  - Whitmore Unit 2H 47-095-02727
  - Whitmore Unit 1H 47-095-02726
  - Proposed Well
  - Wade Unit 2H 47-095-02728
  - Wade Unit 1H 47-095-02729



I, the undersigned, hereby certify that this plat is correct to the best of my knowledge and belief and shows all the information required by law and the rules issued and prescribed by the Department of Environmental Protection.

*Bradley D. Miller*  
**Bradley D. Miller, P.S. 2167**

Note: 8 water wells and 2 springs were found within 2000' of proposed well. No occupied dwellings or buildings 2,500 square feet or larger used to house or shelter dairy cattle or poultry husbandry are located within 625' of the center of the well pad.

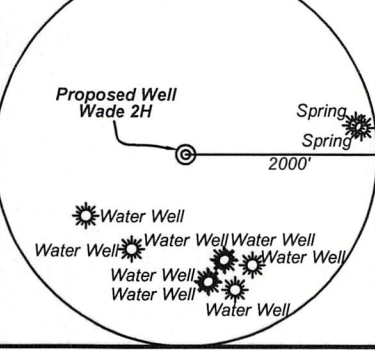

**Legend**

- Proposed gas well
- Found corner, as noted
- ⊙ Existing Well, as noted
- ⊙ Digitized Well
- - - Existing Road
- Existing Road
- - - Surface boundary (approx.)
- Interior surface tracts (approx.)

11,181' to Bottom Hole

5,026' to Top Hole

Top Hole 7.5' Spot

**TOP HOLE LATITUDE 39 - 30 - 00**  
**BTM HOLE LATITUDE 39 - 27 - 30**

**Notes:**  
 West Virginia Coordinate System of 1927, North Zone based upon Differential GPS Measurements.  
 Well No. Wade Unit 2H Top Hole coordinates are  
 N: 366,509.01' Latitude: 39°29'54.28"  
 E: 1,618,730.44' Longitude: 80°51'04.12"  
 Bottom Hole coordinates are  
 N: 348,639.34' Latitude: 39°26'58.46"  
 E: 1,624,076.72' Longitude: 80°49'52.54"  
 UTM Zone 17, NAD 1983  
 Top Hole Coordinates Bottom Hole Coordinates  
 N: 4,372,107.442m N: 4,366,690.599m  
 E: 512,813.568m E: 514,533.203m  
 Plat orientation and corner and well references are based upon the grid north meridian.  
 Well location references are based upon the magnetic meridian.

**Notes:**  
 Well No. Wade Unit 2H UTM Zone 17, NAD 1927  
 Top Hole Coordinates  
 N: 14,343,441.37'  
 E: 1,682,408.45'  
 Point of Entry Coordinates  
 N: 14,343,488.34'  
 E: 1,681,894.88'  
 Bottom Hole Coordinates  
 N: 14,325,669.50'  
 E: 1,688,050.30'

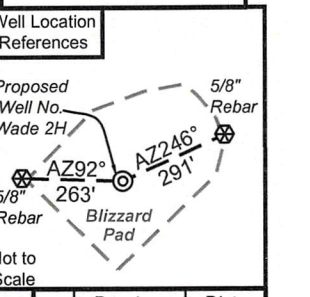

	Bearing	Dist.
L1	S 21°13' E	995.0'
L2	N 36°41' W	1,610.1'
L3	N 41°22' E	1,136.9'
L4	N 74°37' E	949.5'
L5	N 83°49' W	515.9'

FILE NO: 97-54-E-19  
 DRAWING NO: Wade 2H BHL MOD  
 SCALE: 1" = 2000'  
 MINIMUM DEGREE OF ACCURACY: Submeter  
 PROVEN SOURCE OF ELEVATION: WVDOT, Harrisville, WV

**STATE OF WEST VIRGINIA**  
 DEPARTMENT OF ENVIRONMENTAL PROTECTION  
**OIL AND GAS DIVISION**

DATE: May 11 20 21  
 OPERATOR'S WELL NO. Wade 2H  
 API WELL NO MOD  
 47 - 095 - 02728  
 STATE COUNTY PERMIT

WELL TYPE:  OIL  GAS  LIQUID INJECTION  WASTE DISPOSAL  
 (IF GAS) PRODUCTION:  STORAGE  DEEP  SHALLOW

LOCATION: ELEVATION: As-Built 1,004' WATERSHED: Outlet Middle Island Creek QUADRANGLE: Shirley  
 DISTRICT: Ellsworth COUNTY: Tyler 06/11/2021  
 SURFACE OWNER: Roger D. Blizzard & Ruth E. Spencer ACREAGE: 102.62  
 ROYALTY OWNER: The Swan Living Trust; Elmer Earl Bowser, Jr.; Bradley J. Carpenter; Patrick Lewis Smith; David E. Bowyer; Heritage Resources - Marcellus Minerals, LLC; B. Fred Hill Jr.; Virginia Dianne Thompson; WV DNR; LEASE NO: ACREAGE: 1.88; 1.00;

PROPOSED WORK:  DRILL  CONVERT  DRILL DEEPER  FRACTURE OR STIMULATE  PLUG OFF OLD FORMATION  
 PERFORATE NEW FORMATION  OTHER PHYSICAL CHANGE IN WELL (SPECIFY) BHL MOD  
 PLUG AND ABANDON  CLEAN OUT AND REPLUG TARGET FORMATION: Marcellus Shale ESTIMATED DEPTH: 7,000' TVD 27,000' MD

WELL OPERATOR: Antero Resources Corporation DESIGNATED AGENT: Dianna Stamper - CT Corporation System  
 ADDRESS: 1615 Wynkoop Street ADDRESS: 5400 D Big Tyler Road  
 Denver, CO 80202 Charleston, WV 25313

Antero Resources  
Well No. Wade 2H  
BHL MOD  
Antero Resources Corporation

Detail 2



FILE NO: 97-54-E-19  
DRAWING NO: Wade 2H BHL MOD  
SCALE: 1" = 2000'  
MINIMUM DEGREE OF ACCURACY:  
Submeter  
PROVEN SOURCE OF ELEVATION:  
WVDOT, Harrisville, WV

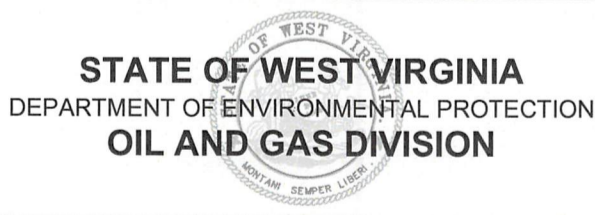

DATE: May 11 20 21  
OPERATOR'S WELL NO. Wade 2H  
API WELL NO Mod  
47 - 095 - 02728  
STATE COUNTY PERMIT

WELL TYPE:  OIL  GAS  LIQUID INJECTION  WASTE DISPOSAL  
(IF GAS) PRODUCTION:  STORAGE  DEEP  SHALLOW

LOCATION: ELEVATION: As-Built 1,004' WATERSHED: Outlet Middle Island Creek QUADRANGLE: Shirley  
DISTRICT: Ellsworth COUNTY: Tyler

SURFACE OWNER: Roger D. Blizzard & Ruth E. Spencer ACREAGE: 102.62

ROYALTY OWNER: The Swan Living Trust; Elmer Earl Bowser, Jr.; Bradley J. Carpenter; Patrick Lewis Smith; David E. Bowyer; AMP Fund II, LP; BRC Appalachian Minerals I, LLC; Haessly Land & Timber, LLC; Kathy Ann Seago; James R. Pinney; Phillip R. Edge; Keith C. & Phylis J. Smith; Jason S. Thompson, et ux; Heritage Resources - Marcellus Minerals, LLC; B. Fred Hill Jr.; Virginia Dianne Thompson; WV DNR; LEASE NO: ACREAGE: 1.88; 1.00;

PROPOSED WORK:  DRILL  CONVERT  DRILL DEEPER  FRACTURE OR STIMULATE  PLUG OFF OLD FORMATION  
 PERFORATE NEW FORMATION  OTHER PHYSICAL CHANGE IN WELL (SPECIFY) BHL MOD  
 PLUG AND ABANDON  CLEAN OUT AND REPLUG TARGET FORMATION: Marcellus Shale ESTIMATED DEPTH: 27,000' MD

WELL OPERATOR: Antero Resources Corporation DESIGNATED AGENT: Dianna Stamper - CT Corporation System  
ADDRESS: 1615 Wynkoop Street ADDRESS: 5400 D Big Tyler Road  
Denver, CO 80202 Charleston, WV 25313

6; 2.97; 102.62;  
119.578; 5.065;  
67.90625; 6.25; 7.52;  
48.475; 75.25;  
10.6175; 143.7325;  
0.4075; 1.00;  
0.098; 1.42; 2.97;  
168.175; 136.22;  
28.009; 17.401; 1.00;  
1.103; 1.092; 3.97;  
1.88; 1.00;

06/11/2021

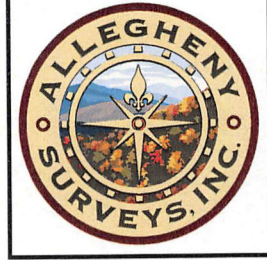
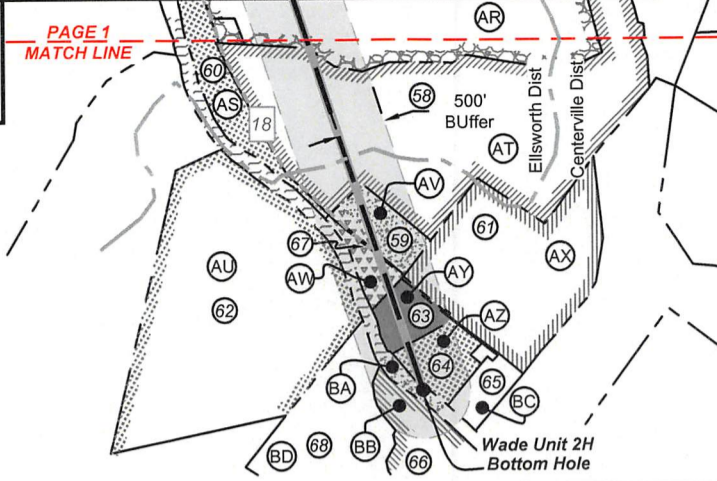

Leases		
A	Heritage Resources - Marcellus Minerals, LLC	AA Lloyd Carl Seckman
		AB David E. Bowyer
B	Jerry R. Brown	AC Brian R. Lemasters, et ux
C	B. Fred Hill Jr.	AD Joshua D. Botkins
D	Clifford and Virginia Perkins Irrevocable Trust	AE Randall L. Wise, et ux
		AF April R. Weekley, et vir
E	Heritage Resources - Marcellus Minerals, LLC	AG Brian M. Glover
		AH Carolee J. Daniell
F	Virginia Dianne Thompson	AI Rodney J. Davis
G	The Swan Living Trust	AJ Donnie R. Griffey, et ux
H	Alfred Lonzo Eddy	AK Robert O'Neil Dotson, et ux
I	Elmer Earl Bowser Jr.	AL AMP Fund II, LP
J	Haessly Land & Timber, LLC	AM Brian M. Weigle
K	City of Sistersville	AN Stephanie D. McGowan
L	E. Lorna Howard Testamentary Trust	AO Keith C. Smith, et ux
		AP Mount Aris Cemetery
M	Kenneth R. & Jennifer L. Mason	AQ Roger H. Smith
N	Bradley J. Carpenter	AR Keith C. & Phyllis J. Smith
O	Ronald E. Thompson, et ux	AS Triple Haught Trust
P	Alf Smith Cemetery	AT Ronald L. Hoover, et ux
Q	Jeffrey D. Smith, et ux	AU Larry Fletcher, et ux
R	Enoch Family Irrevocable Trust	AV BRC Appalachian Minerals I, LLC
S	Patrick Lewis Smith	AW Geraldine Owens Prunty
T	Danny L. & Terri E. Botkins	AX William D. Morrison, et ux
U	Lee Roy Ferguson, et ux	AY Jason S. Thompson, et ux
V	Rebecca Lynn Gebhardt	AZ Kathy Ann Seago
W	Benjamin L. Botkins	BA WV DNR
X	James R. Pinney	BB BRC Appalachian Minerals I, LLC
Y	Phillip R. Edge	BC OPEN
Z	Enoch Family Irrevocable Trust	BD OPEN

ID	TM/Par	Owner	DB/PG	Acres
1	15-33	Roger D. Blizzard & Ruth E. Spencer	340/170	102.62
2	15-31	Roger D. Blizzard & Ruth E. Spencer	342/782	25.00
3	15-30	Thomas C. & Judeann L. Grinage	458/73	124.08
4	15-34.1	Randy & Pamela L. Lancaster	370/776	11.42
5	21-7	Gary O. & Anita K. Bennett	332 / 605	1.75
6	21-8	Roger D. & Darlene Blizzard	345/773	3.75
7	21-8.1	Charles M. & Amanda C. Spencer	397/36	1.32
8	21-10	Roger D. Blizzard & Ruth E. Spencer	340/170	5.00
9	21-9	Clayton M. & Ruth E. Spencer	201/541	0.71
10	21-14	Carl E. & Elsie M. Taylor	391/181	67.91
11	21-13	Alfred Lonzo Eddy	337/650	98.58
12	21-15	Stephanie & Joseph W. Havranek	254/153	45.48
13	21-53	Haessly Land & Timber, LLC	337/101A	89.88
14	21-52	Jennifer L. & Kenneth Mason	345/743	81.0
15	22-42	Sharon Christenson, et al	635/420	144.26
16	21-54	Sybill Gorby	WB 34/343	70.00
17	21-55	Ronald & Janet Thompson	400/552	12.50
18	21-57	Alf Smith Cemetery	107/393	3.00
19	22-42	Sharon Christenson, et al	635/420	144.26
20	22-43.1	Jeffery & Ricki L. Smith	317/507	4.17
21	22-49	Enoch Family Irrevocable Trust	440/433	4.14
22	21-60	Danny & Terri Botkins	342/556	0.86
23	21-58	Roger & Kendra Wyke	219/276	1.55
24	21-61	Danny & Terri Botkins	342/556	1.51
25	22-44	Darell & Doris McCormick	385/776	2.80
26	22-47.3	Lee Roy & Tracey Ferguson	355/656	2.39
27	21-62	Lewis Timmons Estate	332/1	1.8
28	28-5.1	Benjamin L. Botkins	410/440	0.79
29	22-47.4	Samantha Anderson	591/348	2.36
30	22-52	Phillip R. & Mary L. Edge	304/473	0.11
31	28-1.1	Lois J. Estep	258/641	0.97
32	28-1	Lois J. Estep & Edward E. Estep	359/613	1.11
33	28-2	Mary Ladene Lemasters	299/548	2.37
34	28-5	Phillip R. & Mary L. Edge	261/687	0.93
35	28-4	David A. Mays & Connie S. Gilbert	WB 76/405	11.11
36	28-3	Lloyd C. & Kathen G. Seckman	184/296	2.88
37	28-13	David E. Bowyer	481/234	3.97
38	28-4.1	Brian R. & Brooke A. Lemasters	617/403	1.10
39	28-4.3	Jerry T. & Lavonne L. Williams	311/89	1.91
40	28-7	Randall L. & Kathryn M. Wise	442/85	9.00
41	28-4.2	Joshua D. Botkins	451/569	1.18
42	28-4.6	Brian M. Glover	397/415	0.83
43	28-12	April Watkinson & Thomas Weekley	611/755	1.88
44	28-11	Rodney J. & Kennetta K. Davis	281/348	1.00
45	28-11.1	Donnie R. & Melissa K. Griffey	323/700	1.00
46	28-14	Robert & Sandra Dotson	213/445	0.87
47	28-10	Carol Knapp Rev. Trust	435/461	9.20
48	28-10.1	Jean A. & Tom Gump	556/92	8.20
49	28-8	Robert L. & Carolee J. Daniell	WB 43/267	30.00
50	28-17	Kathy Ann Seago, et al	WB 41/119	12.11
51	28-16.1	Brian Weigle	353/776	2.36
52	28-16	Kathy Ann Seago, et al	WB 41/119	4.54
53	28-25	Ripley Alma Methodist Church	199/1	0.86
54	28-24.1	Church of Christ	332/580	0.94
55	28-24	Mt. Aris Union Church & Cemetery	246/47	0.97
56	28-23	Troy & Kelly Smith	OR 20/722	3.60
57	28-29	Keith C. Smith	WB 35/228	116.72
58	28-28	Ronald & Linda Hoover	184/383	136.22
59	5-1	Melvin E. & Sandra K. Ferguson	281/315	6.25
60	28-27	Kenneth & Jennifer Mason	353/389	72.00
61	5-4	Kenneth & Jennifer L. Mason	OR 75/585	52.78
62	2-1	Larry & Betty Fletcher	312/200	120.00
63	5-3	Jason & Melissa R. Thompson	397/39	7.52
64	5-4.1	Kathy Ann Seago, et al	WB 41/119	10.62
65	10-50	Steve Weigle, et al	OR 21/31	6.59
66	5-3	Kenneth Mason	322/724	105.00
67	5-2	James S. Taylor	403/297	6.00
68	5-12	Robert F. & Rita Scardina	203/260	36.90

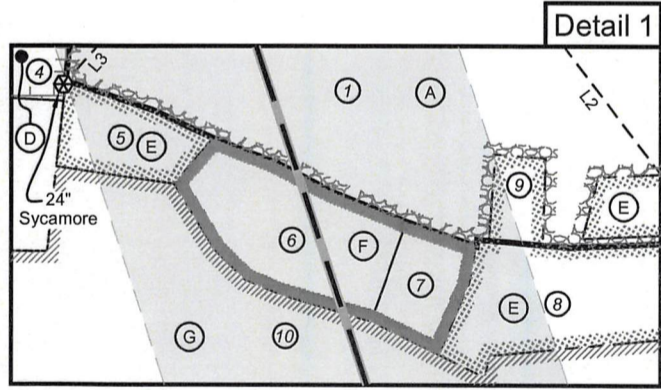

FILE NO: 97-54-E-19  
 DRAWING NO: Wade 2H BHL MOD  
 SCALE: 1" = 2000'  
 MINIMUM DEGREE OF ACCURACY:  
 Submeter  
 PROVEN SOURCE OF ELEVATION:  
 WVDOT, Harrisville, WV

**STATE OF WEST VIRGINIA**  
 DEPARTMENT OF ENVIRONMENTAL PROTECTION  
**OIL AND GAS DIVISION**

DATE: May 11 20 21  
 OPERATOR'S WELL NO. Wade 2H  
 API WELL NO **Mod**  
 47 - 095 - 02728  
 STATE COUNTY PERMIT

WELL TYPE:  OIL  GAS  LIQUID INJECTION  WASTE DISPOSAL  
 (IF GAS) PRODUCTION:  STORAGE  DEEP  SHALLOW

LOCATION: ELEVATION: As-Built 1,004' WATERSHED: Outlet Middle Island Creek QUADRANGLE: Shirley  
 DISTRICT: Ellsworth COUNTY: Tyler **06/11/2021**  
 SURFACE OWNER: Roger D. Blizzard & Ruth E. Spencer ACREAGE: 102.62  
 ROYALTY OWNER: Donnie R. Griffey, et ux; Ronald L. Hoover, et ux; Joshua D. Botkins; Geraldine Owens Prunty; Brian M. Weigle; Rodney J. Davis; Brian R. Lemasters, et ux; April R. Weekley, et vir; E. Lorna Howard Testamentary Trust; Benjamin L. Botkins; Lloyd Carl Seckman; AMP Fund II, LP; BRC Appalachian Minerals I, LLC; Haessly Land & Timber, LLC; Kathy Ann Seago; James R. Pinney; Phillip R. Edge; Keith C. & Phyllis J. Smith; Jason S. Thompson, et ux; The Swan Living Trust; Elmer Earl Bowser, Jr.; Bradley J. Carpenter; Patrick Lewis Smith; David E. Bowyer; Heritage Resources - Marcellus Minerals, LLC; B. Fred Hill Jr.; Virginia Dianne Thompson; WV DNR. LEASE NO: ACREAGE: 1.88; 1.00;

PROPOSED WORK:  DRILL  CONVERT  DRILL DEEPER  FRACTURE OR STIMULATE  PLUG OFF OLD FORMATION  
 PERFORATE NEW FORMATION  OTHER PHYSICAL CHANGE IN WELL (SPECIFY) BHL MOD  
 PLUG AND ABANDON  CLEAN OUT AND REPLUG TARGET FORMATION: Marcellus Shale ESTIMATED DEPTH: 7,000' TVD  
 28,009; 17,401; 1,000; 1.103; 1.092; 3.97;

WELL OPERATOR: Antero Resources Corporation DESIGNATED AGENT: Dianna Stamper - CT Corporation System  
 ADDRESS: 1615 Wynkoop Street ADDRESS: 5400 D Big Tyler Road  
 Denver, CO 80202 Charleston, WV 25313