

**Antero Resources**  
**Well No. Roy 1H**  
 Antero Resources Corporation



ID	TM/Par	Owner	Bk/Pg	Acres
1	10-4.1	Antero Resources Corporation	OR12/739	60.38
2	10-4	Kevin L. & Tammy J. Thomas	OR7/290	32.22
3	9-9.1	Jennifer K. & Diane M. Thomas	AR46/754	40.00
4	10-5.3	Richard Daniel Bowen	344/814	25.93
5	9-16	Billy D. & Roma L. Hart	154/569	20.00
6	10-6	James F. & Sarah K. Boley	321/745	1.00
7	10-9	Bowen Family Irrevocable Trust	370/750	82.00
8	10-7	Michael D. & Carol Wise	349/420	71.70
9	10-8	Don M. & Montana Thomas	136/131	56.36
10	10-10.1	Donald Thomas	WB21/443	33.88
11	14-3	Everett Harris	225/67	6.00
12	14-4	Joseph Thomas	WB21/443	51.00
13	14-1	Donald Marvin & Montana Thomas	215/271	27.25
14	14-2	Everett E. Harris, et al	281/483	109.88
15	2-8	Roy F. Gorrell	415/82	68.66
16	2-6	Barnett Shinn Estate	WB23/146	15.00
17	2-1	Joseph Ben Thomas	155/439	117.01
18	2-11	Edwin E. Jr. & Kathleen F. Weber	355/268	97.90
19	2-10	Joshua D. Botkins	399/327	96.00

Leases	
A	Berna J. Hammel
B	Maurice C. Grove
C	Sally & Mitchell Dunn
D	Roma Hart
E	J&N Management Enterprises, LLC
F	Richard A. Danser
G	Michael D. & Carol Wise
H	Bowen Family Irrevocable Trust
I	Donald M. Thomas, et ux
J	Joseph B. Thomas
K	Donald M. Thomas, et ux
L	Everett Harris
M	Paula D. Garvey
N	Brady Carol Shinn
O	Joseph B. Thomas
P	JayBee Production Co.
Q	Joshua Botkins

FILE NO: 07-54-U-16  
 DRAWING NO: Roy Unit 1H  
 SCALE: 1" = 1500'  
 MINIMUM DEGREE OF ACCURACY:  
Submeter  
 PROVEN SOURCE OF ELEVATION:  
WVDOT, Harrisville, WV

  
**STATE OF WEST VIRGINIA**  
 DEPARTMENT OF ENVIRONMENTAL PROTECTION  
**OIL AND GAS DIVISION**

RECEIVED February 25 20 21  
 Office of Oil and Gas  
 OPERATOR'S WELL NO. Roy 1H  
 MAR 10 2021 API WELL NO H6A  
 WV Department of Environmental Protection  
 STATE OF WEST VIRGINIA COUNTY TYLER PERMIT 095 - 02734

WELL TYPE:  OIL  GAS  LIQUID INJECTION  WASTE DISPOSAL  
 (IF GAS) PRODUCTION:  STORAGE  DEEP  SHALLOW

LOCATION: ELEVATION: As-Built 883' WATERSHED: Outlet Middle Island Creek QUADRANGLE: Middlebourne  
 DISTRICT: Union/Meade COUNTY: Tyler **04/16/2021**

SURFACE OWNER: Antero Resources Corp. Joshua Botkins; Sally & Mitchell Dunn; ACREAGE: 60.38 36.225; 15; 96;  
 ROYALTY OWNER: Berna J. Hammel; J&N Management Enterprises, LLC; Bowen Family Irrevocable Trust; Donald M. Thomas, et ux (2); Everett Harris; Brady Carol Shinn; 60.38; 107.929; 82;  
 LEASE NO: \_\_\_\_\_ ACREAGE: 90.24; 27.25; 115.88;

PROPOSED WORK:  DRILL  CONVERT  DRILL DEEPER  FRACTURE OR STIMULATE  PLUG OFF OLD FORMATION  
 PERFORATE NEW FORMATION  OTHER PHYSICAL CHANGE IN WELL (SPECIFY) \_\_\_\_\_ 6,500' TVD  
 PLUG AND ABANDON  CLEAN OUT AND REPLUG TARGET FORMATION: Marcellus Shale ESTIMATED DEPTH: 17,800' MD

WELL OPERATOR: Antero Resources Corporation DESIGNATED AGENT: Dianna Stamper - CT Corporation System  
 ADDRESS: 1615 Wynkoop Street ADDRESS: 5400 D Big Tyler Road  
Denver, CO 80202 Charleston, WV 25313



2,090' to Bottom Hole

4,427' to Top Hole

LATITUDE 39-30-00  
LONGITUDE 80-57-30

# Antero Resources Well No. Roy 1H

Antero Resources Corporation



Proposed Well  
No. Roy Unit 1H

LATITUDE 39-30-00

**Notes**  
West Virginia Coordinate System of 1927, North Zone based upon Differential GPS Measurements.  
Well No. Roy Unit 1H Top Hole coordinates are  
N: 362,493.21" Latitude: 39°29'09.19"  
E: 1,583,985.95" Longitude: 80°58'26.46"  
Bottom Hole coordinates are  
N: 352,652.86" Latitude: 39°27'32.29"  
E: 1,586,162.71" Longitude: 80°57'56.65"  
UTM Zone 17, NAD 1983  
Top Hole Coordinates Bottom Hole Coordinates  
N: 4,370,707.010m N: 4,367,720.200m  
E: 502,248.986m E: 502,962.200m  
Plat orientation and corner and well references are based upon the grid north meridian.  
Well location references are based upon the magnetic meridian.

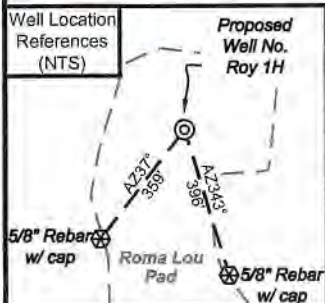

I, the undersigned, hereby certify that this plat is correct to the best of my knowledge and belief and shows all the information required by law and the rules issued and prescribed by the Department of Environmental Protection.

*Bradley D. Miller*  
Bradley D. Miller, P.S. 2167



SEAL

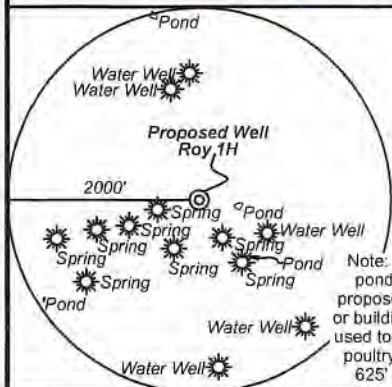

Note: 5 water wells 8 springs and 4 ponds were found within 2000' of proposed well. No occupied dwellings or buildings 2,500 square feet or larger used to house or shelter dairy cattle or poultry husbandry are located within 625' of the center of the well pad.

Bearing	Dist.
L1 N 64°51' E	1,616.7'
L2 S 85°50' W	1,439.5'
L3 N 67°32' W	1,899.4'
L4 N 05°41' W	1,246.3'
L5 S 33°10' W	

**Notes:**  
Well No. Roy Unit 1H  
UTM Zone 17, NAD 1927  
Top Hole Coordinates  
N: 14,338,847.70"  
E: 1,647,747.72"  
Point of Entry Coordinates  
N: 14,337,793.65"  
E: 1,647,083.53"  
Bottom Hole Coordinates  
N: 14,329,048.44"  
E: 1,650,087.65"

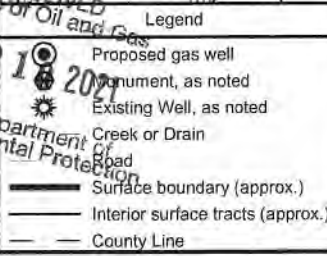
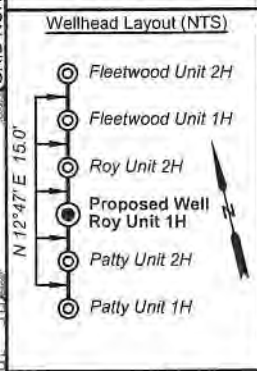

FILE NO: 07-54-U-16  
DRAWING NO: Roy Unit 1H  
SCALE: 1" = 1500'  
MINIMUM DEGREE OF ACCURACY: Submeter  
PROVEN SOURCE OF ELEVATION: WVDOT, Harrisville, WV

**STATE OF WEST VIRGINIA**  
DEPARTMENT OF ENVIRONMENTAL PROTECTION  
**OIL AND GAS DIVISION**

DATE: February 25 2021  
OPERATOR'S WELL NO. Roy 1H  
API WELL NO. 47-095-02734  
STATE COUNTY PERMIT

WELL TYPE:  OIL  GAS  LIQUID INJECTION  WASTE DISPOSAL  
(IF GAS) PRODUCTION:  STORAGE  DEEP  SHALLOW

LOCATION: ELEVATION: As-Built 883' WATERSHED: Outlet Middle Island Creek QUADRANGLE: Middlebourne  
DISTRICT: Union/Meade COUNTY: Tyler 04/16/2021

SURFACE OWNER: Antero Resources Corp. Joshua Botkins; Sally & Mitchell Dunn; 36.225; 15; 96;  
ROYALTY OWNER: Berna J. Hammel; J&N Management Enterprises, LLC; Bowen Family Irrevocable Trust; Donald M. Thomas, et ux (2); Everett Harris; Brady Carol Shinn; 60.38; 107.929; 82;  
PROPOSED WORK:  DRILL  CONVERT  DRILL DEEPER  FRACTURE OR STIMULATE  PLUG OFF OLD FORMATION  
 PERFORATE NEW FORMATION  OTHER PHYSICAL CHANGE IN WELL (SPECIFY) \_\_\_\_\_  
 PLUG AND ABANDON  CLEAN OUT AND REPLUG TARGET FORMATION: Marcellus Shale ESTIMATED DEPTH: 17,800' MD 6,500' TVD

WELL OPERATOR: Antero Resources Corporation DESIGNATED AGENT: Dianna Stamper - CT Corporation System  
ADDRESS: 1615 Wynkoop Street ADDRESS: 5400 D Big Tyler Road  
Denver, CO 80202 Charleston, WV 25313



Antero Resources Well No. Roy 1H Antero Resources Corporation



LATITUDE 39 -30 -00

LONGITUDE 80 -57 -30

**Notes**  
 West Virginia Coordinate System of 1927, North Zone based upon Differential GPS Measurements.  
 Well No. Roy Unit 1H Top Hole coordinates are  
 N: 362,493.21' Latitude: 39°29'09.19"  
 E: 1,583,985.95' Longitude: 80°58'26.46"  
 Bottom Hole coordinates are  
 N: 352,652.86' Latitude: 39°27'32.29"  
 E: 1,586,162.71' Longitude: 80°57'56.65"  
 UTM Zone 17, NAD 1983  
 Top Hole Coordinates Bottom Hole Coordinates  
 N: 4,370,707.010m N: 4,367,720.200m  
 E: 502,248.986m E: 502,962.200m  
 Plat orientation and corner and well references are based upon the grid north meridian.  
 Well location references are based upon the magnetic meridian.

**Notes:**  
 Well No. Roy Unit 1H UTM Zone 17, NAD 1927  
 Top Hole Coordinates  
 N: 14,338,847.70'  
 E: 1,647,747.72'  
 Point of Entry Coordinates  
 N: 14,337,793.65'  
 E: 1,647,083.53'  
 Bottom Hole Coordinates  
 N: 14,329,048.44'  
 E: 1,650,087.65'

Wellhead Layout (NTS)

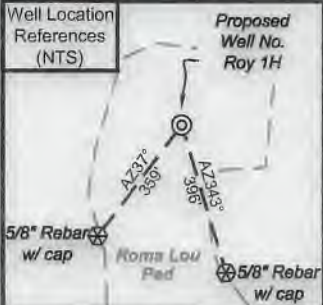
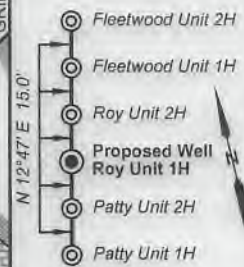

I, the undersigned, hereby certify that this plat is correct to the best of my knowledge and belief and shows all the information required by law and the rules issued and prescribed by the Department of Environmental Protection.

Bradley D. Miller, P.S. 2167

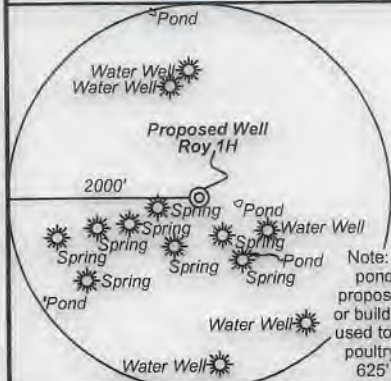

	Bearing	Dist.
L1	N 64°51' E	2,328.5'
L2	S 85°50' W	1,616.7'
L3	N 67°32' W	1,439.5'
L4	N 05°41' W	1,899.4'
L5	S 33°10' W	1,246.3'

**Legend**

- Proposed gas well
- Monument, as noted
- Existing Well, as noted
- Creek or Drain
- Road
- Surface boundary (approx.)
- Interior surface tracts (approx.)
- County Line

FILE NO: 07-54-U-16  
 DRAWING NO: Roy Unit 1H  
 SCALE: 1" = 1500'  
 MINIMUM DEGREE OF ACCURACY: Submeter  
 PROVEN SOURCE OF ELEVATION: WVDOT, Harrisville, WV

**STATE OF WEST VIRGINIA**  
 DEPARTMENT OF ENVIRONMENTAL PROTECTION  
**OIL AND GAS DIVISION**

DATE: February 25 2021  
 OPERATOR'S WELL NO. Roy 1H  
 API WELL NO. ~~164~~  
 47 - 095 - 02734  
 STATE COUNTY PERMIT

WELL TYPE:  OIL  GAS  LIQUID INJECTION  WASTE DISPOSAL  
 (IF GAS) PRODUCTION:  STORAGE  DEEP  SHALLOW

LOCATION: ELEVATION: As-Built 883' WATERSHED: Outlet Middle Island Creek QUADRANGLE: Middlebourne  
 DISTRICT: Union/Meade COUNTY: Tyler 04/16/2021  
 SURFACE OWNER: Antero Resources Corp. Joshua Botkins; Sally & Mitchell Dunn; 36.225; 15; 96;  
 Donald M. Thomas, et ux (2); Everett Harris; Brady Carol Shinn; 60.38; 107.929; 82;  
 ROYALTY OWNER: Berna J. Hammel; J&N Management Enterprises, LLC; Bowen Family Irrevocable Trust; LEASE NO: ACREAGE: 90.24; 27.25; 115.88;  
 PROPOSED WORK:  DRILL  CONVERT  DRILL DEEPER  FRACTURE OR STIMULATE  PLUG OFF OLD FORMATION  
 PERFORATE NEW FORMATION  OTHER PHYSICAL CHANGE IN WELL (SPECIFY) \_\_\_\_\_ 6,500' TVD  
 PLUG AND ABANDON  CLEAN OUT AND REPLUG TARGET FORMATION: Marcellus Shale ESTIMATED DEPTH: 17,800' MD

WELL OPERATOR: Antero Resources Corporation DESIGNATED AGENT: Dianna Stamper - CT Corporation System  
 ADDRESS: 1615 Wynkoop Street ADDRESS: 5400 D Big Tyler Road  
 Denver, CO 80202 Charleston, WV 25313



**Antero Resources**  
**Well No. Roy 1H**  
 Antero Resources Corporation



ID	TM/Par	Owner	Bk/Pg	Acres
1	10-4.1	Antero Resources Corporation	OR12/739	60.38
2	10-4	Kevin L. & Tammy J. Thomas	OR7/290	32.22
3	9-9.1	Jennifer K. & Diane M. Thomas	AR46/754	40.00
4	10-5.3	Richard Daniel Bowen	344/814	25.93
5	9-16	Billy D. & Roma L. Hart	154/569	20.00
6	10-6	James F. & Sarah K. Boley	321/745	1.00
7	10-9	Bowen Family Irrevocable Trust	370/750	82.00
8	10-7	Michael D. & Carol Wise	349/420	71.70
9	10-8	Don M. & Montana Thomas	136/131	56.36
10	10-10.1	Donald Thomas	WB21/443	33.88
11	14-3	Everett Harris	225/67	6.00
12	14-4	Joseph Thomas	WB21/443	51.00
13	14-1	Donald Marvin & Montana Thomas	215/271	27.25
14	14-2	Everett E. Harris, et al	281/483	109.88
15	2-8	Roy F. Gorrell	415/82	68.66
16	2-6	Barnett Shinn Estate	WB23/146	15.00
17	2-1	Joseph Ben Thomas	155/439	117.01
18	2-11	Edwin E. Jr. & Kathleen F. Weber	355/268	97.90
19	2-10	Joshua D. Botkins	399/327	96.00

Leases	
A	Berna J. Hammel
B	Maurice C. Grove
C	Sally & Mitchell Dunn
D	Roma Hart
E	J&N Management Enterprises, LLC
F	Richard A. Danser
G	Michael D. & Carol Wise
H	Bowen Family Irrevocable Trust
I	Donald M. Thomas, et ux
J	Joseph B. Thomas
K	Donald M. Thomas, et ux
L	Everett Harris
M	Paula D. Garvey
N	Brady Carol Shinn
O	Joseph B. Thomas
P	JayBee Production Co.
Q	Joshua Botkins

FILE NO: 07-54-U-16  
 DRAWING NO: Roy Unit 1H  
 SCALE: 1" = 1500'  
 MINIMUM DEGREE OF ACCURACY:  
 Submeter  
 PROVEN SOURCE OF ELEVATION:  
 WVDOT, Harrisville, WV

**STATE OF WEST VIRGINIA**  
 DEPARTMENT OF ENVIRONMENTAL PROTECTION  
**OIL AND GAS DIVISION**

DATE: February 25 2021  
 OPERATOR'S WELL NO. Roy 1H  
 API WELL NO **WGA**  
 47 - 095 - **02734**  
 STATE COUNTY PERMIT

WELL TYPE:  OIL  GAS  LIQUID INJECTION  WASTE DISPOSAL  
 (IF GAS) PRODUCTION:  STORAGE  DEEP  SHALLOW

LOCATION: ELEVATION: As-Built 883' WATERSHED: Outlet Middle Island Creek QUADRANGLE: Middlebourne  
 DISTRICT: Union/Meade COUNTY: Tyler **04/16/2021**

SURFACE OWNER: Antero Resources Corp. Joshua Botkins; Sally & Mitchell Dunn; ACREAGE: 60.38 36.225; 15; 96;  
 ROYALTY OWNER: Berna J. Hammel; J&N Management Enterprises, LLC; Bowen Family Irrevocable Trust; Donald M. Thomas, et ux (2); Everett Harris; Brady Carol Shinn; 60.38; 107.929; 82;  
 LEASE NO: \_\_\_\_\_ ACREAGE: 90.24; 27.25; 115.88;

PROPOSED WORK:  DRILL  CONVERT  DRILL DEEPER  FRACTURE OR STIMULATE  PLUG OFF OLD FORMATION  
 PERFORATE NEW FORMATION  OTHER PHYSICAL CHANGE IN WELL (SPECIFY) \_\_\_\_\_ 6,500' TVD  
 PLUG AND ABANDON  CLEAN OUT AND REPLUG TARGET FORMATION: Marcellus Shale ESTIMATED DEPTH: 17,800' MD

WELL OPERATOR: Antero Resources Corporation DESIGNATED AGENT: Dianna Stamper - CT Corporation System  
 ADDRESS: 1615 Wynkoop Street ADDRESS: 5400 D Big Tyler Road  
Denver, CO 80202 Charleston, WV 25313





**Antero Resources Corporation**  
Appalachian Basin  
Roma Lou Pad  
Tyler County

Quadrangle: Middlebourne  
Watershed: Outlet Middle Island Creek  
District: Union  
Date: 11-22-2019

04/16/2021  
FEET