

LATITUDE 39°32'30"

10,543'

LATITUDE 39°32'30"

3,908' TO BOTTOM HOLE

Antero Resources Corporation Well No. Glamdring Unit 1H

AS DRILLED DATA:
WELL 1H TOP HOLE INFORMATION:
 N: 373,386ft E: 1,625,071ft
 LAT: 39°31'03.17" LON: 80°49'44.54"
BOTTOM HOLE INFORMATION:
 N: 360,611ft E: 1,631,523ft
 LAT: 39°28'57.86" LON: 80°48'19.84"
 WEST VIRGINIA COORDINATE SYSTEM OF 1927 NORTH ZONE. ZONE WAS DERIVED FROM MEASUREMENTS TAKEN WITH TRIMBLE GEOXT SUBMETER MAPPING GRADE GPS UNIT. PLAT ORIENTATION, CORNER, AND WELL REFERENCE TIE LINES ARE BASED ON GRID NORTH.

(NAD) 83 (UTM) ZONE 17 COORDS:
WELL 1H TOP HOLE INFORMATION:
 N: 4,374,235m E: 514,710m
BOTTOM HOLE INFORMATION:
 N: 4,370,376m E: 516,741m

PAD LAYOUT

NOT TO SCALE

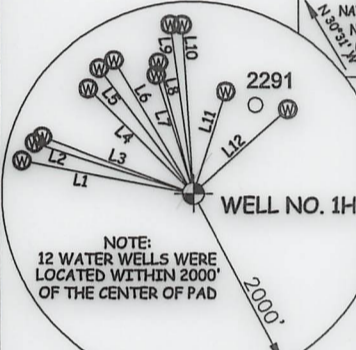
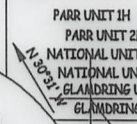

LINE	BEARING	DIST.	LINE	BEARING	DIST.
L1	N 79°23' W	1820.64'	L7	N 17°11' W	1289.39'
L2	N 72°38' W	1737.73'	L8	N 14°44' W	1409.38'
L3	N 69°39' W	1680.54'	L9	N 07°35' W	1774.82'
L4	N 45°05' W	1540.95'	L10	N 03°37' W	1761.12'
L5	N 36°53' W	1627.55'	L11	N 17°55' E	1113.36'
L6	N 30°40' W	1612.05'	L12	N 48°24' E	1322.09'

I THE UNDERSIGNED, HEREBY CERTIFY THAT THIS PLAT IS CORRECT TO THE BEST OF MY KNOWLEDGE AND BELIEF AND SHOWS ALL THE INFORMATION REQUIRED BY LAW AND THE RULES ISSUED AND PRESCRIBED BY THE DEPARTMENT OF ENVIRONMENTAL PROTECTION.



STATE OF WEST VIRGINIA, DIVISION OF ENVIRONMENTAL PROTECTION, OFFICE OF OIL AND GAS

WILLOW LAND SURVEYING PLLC
 220 MASONIC AVE. PENNSBORO WEST VIRGINIA 26415

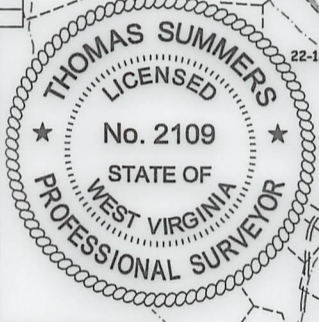

JOB # 21-008WA
 DRAWING # GLAMDING1HAD
 SCALE 1" = 2000'
 MINIMUM DEGREE OF ACCURACY SUBMETER
 PROVEN SOURCE OF ELEV. SUBMETER MAPPING GRADE GPS
 STATE OF WEST VIRGINIA DEPARTMENT OF ENERGY DIVISION OF OIL AND GAS

LEGEND
 --- Surface Owner Boundary Lines +/-
 - - - Interior Surface Tracts +/-
 ⊙ Proposed Well Path
 ⊙ As Drilled Well Path
 THOMAS SUMMERS P.S. 2109
 DATE 04/07/22
 OPERATOR'S WELL# GLAMDING UNIT #1H

WELL 1H POINT OF ENTRY INFORMATION:
 WV STATE PLANE NAD '27 (NORTH ZONE):
 N: 373,874ft E: 1,627,109ft
 GEOGRAPHIC (NAD) 27:
 LAT: 39°31'08.30" LON: 80°49'18.63"
 (NAD) 83 (UTM) ZONE 17 COORDS:
 N: 4,374,394m E: 515,329m

- NOTES**
- NO OCCUPIED DWELLINGS OR BUILDINGS TWO THOUSAND FIVE HUNDRED (2,500) SQUARE FEET OR LARGER USED TO HOUSE OR SHELTER DAIRY CATTLE OR POULTRY HUSBANDRY ARE LOCATED WITHIN SIX HUNDRED TWENTY-FIVE (625) FEET OF THE CENTER OF THE WELL PAD.
 - TOP HOLE DATA SHOWN HEREON WAS PROVIDED BY ANTERO RESOURCES CORPORATION.
 - AS DRILLED DATA WAS PROVIDED BY ANTERO RESOURCES CORPORATION.
 - WLS IS NOT CERTIFYING THE DATA AND INFORMATION PROVIDED LISTED IN NOTES 2 AND 3, ONLY THE RELATIONSHIP TO THE DATA AND INFORMATION PROVIDED TO THE LEASE BOUNDARIES.
 - WLS IS BY NO MEANS RESPONSIBLE FOR ANY ERRORS OR INACCURACIES WITH THE DATA AND INFORMATION THAT HAS BEEN PROVIDED.

Ellsworth District - Tyler County	
11-51	Bear Knob Holdings LLC
16-5	David Leek
16-5.1	Richard Ferrell
16-6	Kayla Leek
16-7	John Thomas
16-7.1	Lianne Wilson
16-8	Jean Neel Et Al
16-9	Bear Knob Holdings LLC
16-10	Jean Neel Et Al
16-11	Jean Neel Et Al
16-15	Harvey Miller Et Al
16-16	Harvey Miller Et Al
16-16.1	Barbara Kittle
16-17	Alfred Steele
16-18	Alfred Steele
16-19	Jean Neel Et Al
16-20	Jean Neel Et Al
16-21	Kayla Leek
16-24	James Eastham
16-25	Nancy Fowler
16-26	Barbara Kittle
16-27	Gilbert Eddy
16-28	Kenneth Tomblin Et Al
16-36	George Karabetis
16-37	Rosella Murner
16-38	EQT Production Company
16-39	Richard Pyles
16-39.1	Leo Wiker
16-40	Gary Weekley
16-42	Richard Pyles
16-42.3	Richard Pyles
16-58	American Energy Marcellus Minerals LLC
22-6	EQT Production Company
22-7	Kenneth Baker
22-8	EQT Production Company
22-9	Steven Wright
22-10	Leslie Henderson
22-13	Debra Blake
22-14	Leslie Weekley
22-15	Lonnie Wade Et Al
22-16	Darlene Stephens
22-16.1	Joann McSwegin
22-16.2	Sarah Bassett

WELL TYPE: OIL ___ GAS X LIQUID INJECTION ___ WASTE DISPOSAL ___ API WELL # 47 - 095 - 02742
 (IF "GAS") PRODUCTION X STORAGE ___ DEEP ___ SHALLOW X STATE COUNTY PERMIT
 LOCATION: ELEVATION AS BUILT - 1,040' WATERSHED OUTLET MIDDLE ISLAND CREEK
 QUADRANGLE PORTER FALLS 7.5' DISTRICT ELLSWORTH COUNTY TYLER
 SURFACE OWNER KAYLA LEEK ACREAGE 69.06 ACRES +/-
 OIL & GAS ROYALTY OWNER RIDGETOP CAPITAL LP; RIDGETOP CAPITAL LP; RIDGETOP CAPITAL LP; DOUGLAS SCOTT FUNK, SR.; ANTERO RESOURCES CORP.; JOHN E. VALENTOUR ET UX; LEASE ACREAGE 69.06 AC.±; 43.5 AC.±;
BRC APPALACHIAN MINERALS I LLC; S.A. SMITH & C.B. MORRIS HEIRS TRUST; BRC APPALACHIAN MINERALS I LLC; 16.5 AC.±; 10 AC.±; 40 AC.±; 80 AC.±;
BOUNTY MINERALS LLC; BETTY MOREHEAD ET VIR; DAVID E. BOWYER; LAURA MAY; BRENDA CUIIC; KAREN J. WOLF 55.13 AC.±; 304.5 AC.±;
 PROPOSED WORK: DRILL ___ CONVERT ___ DRILL DEEPER ___ REDRILL ___ FRACTURE OR STIMULATE ___
 PLUG OFF OLD FORMATION ___ PERFORATE NEW FORMATION ___ OTHER PHYSICAL CHANGE IN WELL
 (SPECIFY) AS DRILLED PLUG & ABANDON CLEAN OUT & REPLUG
 TARGET FORMATION MARCELLUS ESTIMATED DEPTH 6,664' TVD 21,249' MD
 WELL OPERATOR ANTERO RESOURCES CORP. DESIGNATED AGENT DIANNA STAMPER - CT CORPORATION SYSTEM
 ADDRESS 1615 WYNKOOP ST. ADDRESS 5400 D BIG TYLER ROAD
 FORM WW-6 DENVER, CO 80202 ADDRESS CHARLESTON, WV 25313

6,288' TO BOTTOM HOLE

8,785'

LONGITUDE 80°47'30"

LONGITUDE 80°47'30"

COUNTY NAME PERMIT