

LATITUDE 39°32'30"

10,535'

LATITUDE 39°30'00"

2,730' TO BOTTOM HOLE

### Antero Resources Corporation Well No. Glamdring Unit 2H

**AS DRILLED DATA:**  
**WELL 2H TOP HOLE INFORMATION:**  
 N: 373,372ft E: 1,625,079ft  
 LAT: 39°31'03.04" LON: 80°49'44.44"  
**BOTTOM HOLE INFORMATION:**  
 N: 359,694ft E: 1,632,688ft  
 LAT: 39°28'48.96" LON: 80°48'04.82"  
 WEST VIRGINIA COORDINATE SYSTEM OF 1927 NORTH ZONE. ZONE WAS DERIVED FROM MEASUREMENTS TAKEN WITH TRIMBLE GEOXT SUBMETER MAPPING GRADE GPS UNIT. PLAT ORIENTATION, CORNER, AND WELL REFERENCE TIE LINES ARE BASED ON GRID NORTH.

**(NAD) 83 (UTM) ZONE 17 COORDS:**  
**WELL 2H TOP HOLE INFORMATION:**  
 N: 4,374,231m E: 514,713m  
**BOTTOM HOLE INFORMATION:**  
 N: 4,370,102m E: 517,100m

#### PAD LAYOUT

NOT TO SCALE

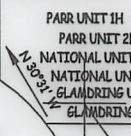
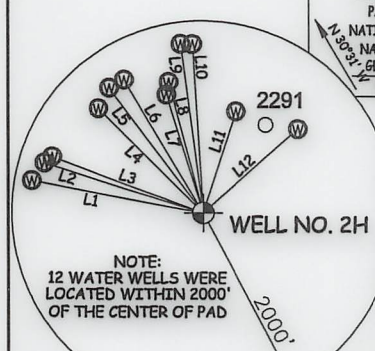

#### 2H TOP HOLE

22-16.3	Charles Stevens
22-17	Dorothy Stevens Revocable Trust
22-18	Clara Baker
22-18.1	Dorothy Stevens Revocable Trust
22-21	Paul Baker
22-22	Paul Baker
22-23	Anthony Parr
22-23.1	Raymond Parr
22-23.2	Anthony Parr
22-24	Ruth Weekley Est.
22-25	Paul Baker
22-26	John Sole
22-27	Carol Knapp Revocable Trust
22-28	WSD Properties LLC
22-29	WSD Properties LLC
22-30	WSD Properties LLC
22-31	Richard Gradstky Et Al
22-32	Richard Gradstky Et Al
22-33	Wilma Weekley
22-34	Raymond Parr Et Al
22-38	Bruce Parr
22-40	Ronald Webb

LINE	BEARING	DIST.	LINE	BEARING	DIST.
L1	N 79°23' W	1820.64'	L7	N 17°11' W	1289.39'
L2	N 72°38' W	1737.73'	L8	N 14°44' W	1409.38'
L3	N 69°39' W	1680.54'	L9	N 07°35' W	1774.82'
L4	N 45°05' W	1540.95'	L10	N 03°37' W	1761.12'
L5	N 36°53' W	1627.55'	L11	N 17°55' E	1113.36'
L6	N 30°40' W	1612.05'	L12	N 48°24' E	1322.09'

I, THE UNDERSIGNED, HEREBY CERTIFY THAT THIS PLAT IS CORRECT TO THE BEST OF MY KNOWLEDGE AND BELIEF AND SHOWS ALL THE INFORMATION REQUIRED BY LAW AND THE RULES ISSUED AND PERSCRIBED BY THE DEPARTMENT OF ENVIRONMENTAL PROTECTION.

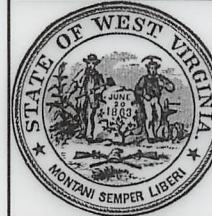

STATE OF WEST VIRGINIA, DIVISION OF ENVIRONMENTAL PROTECTION, OFFICE OF OIL AND GAS  
 WILLOW LAND SURVEYING PLLC  
 220 MASONIC AVE. PENNSBORO WEST VIRGINIA 26415

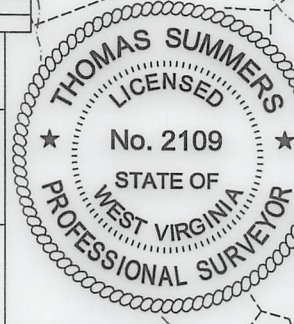

JOB # 21-008WA  
 DRAWING # GLAMDRING2HAD  
 SCALE 1" = 2000'  
 MINIMUM DEGREE OF ACCURACY SUBMETER  
 PROVEN SOURCE OF ELEV. SUBMETER MAPPING GRADE GPS  
 STATE OF WEST VIRGINIA DEPARTMENT OF ENERGY DIVISION OF OIL AND GAS

**LEGEND**  
 - - - - - Surface Owner Boundary Lines +/-  
 - - - - - Interior Surface Tracts +/-  
 O - - - - - Proposed Well Path  
 O - - - - - As Drilled Well Path  
 THOMAS SUMMERS P.S. 2109  
 DATE 04/07/22  
 OPERATOR'S WELL# GLAMDRING UNIT #2H

**WELL 2H POINT OF ENTRY INFORMATION:**  
 WV STATE PLANE NAD '27 (NORTH ZONE):  
 N: 373,997ft E: 1,627,970ft  
 GEOGRAPHIC (NAD) 27:  
 LAT: 39°31'09.64" LON: 80°49'07.66"  
 (NAD) 83 (UTM) ZONE 17 COORDS:  
 N: 4,374,436m E: 515,590m

- NOTES**
1. NO OCCUPIED DWELLINGS OR BUILDINGS TWO THOUSAND FIVE HUNDRED (2,500) SQUARE FEET OR LARGER USED TO HOUSE OR SHELTER DAIRY CATTLE OR POULTRY/HUSBANDRY ARE LOCATED WITHIN SIX HUNDRED TWENTY-FIVE (625) FEET OF THE CENTER OF THE WELL PAD.
  2. TOP HOLE DATA SHOWN HEREON WAS PROVIDED BY ANTERO RESOURCES CORPORATION.
  3. AS DRILLED DATA WAS PROVIDED BY ANTERO RESOURCES CORPORATION.
  4. WLS IS NOT CERTIFYING THE DATA AND INFORMATION PROVIDED LISTED IN NOTES 2 AND 3, ONLY THE RELATIONSHIP TO THE DATA AND INFORMATION PROVIDED TO THE LEASE BOUNDARIES.
  5. WLS IS BY NO MEANS RESPONSIBLE FOR ANY ERRORS OR INACCURACIES WITH THE DATA AND INFORMATION THAT HAS BEEN PROVIDED.

Ellsworth District - Tyler County	
11-51	Bear Knob Holdings LLC
16-5	David Leek
16-5.1	Richard Ferrell
16-6	Kayla Leek
16-7	John Thomas
16-7.1	Lianne Wilson
16-8	Jean Neel Et Al
16-9	Bear Knob Holdings LLC
16-10	Jean Neel Et Al
16-11	Jean Neel Et Al
16-15	Harvey Miller Et Al
16-16	Harvey Miller Et Al
16-16.1	Barbara Kittle
16-17	Alfred Steele
16-18	Alfred Steele
16-19	Jean Neel Et Al
16-20	Jean Neel Et Al
16-21	Kayla Leek
16-24	James Eastham
16-25	Nancy Fowler
16-26	Barbara Kittle
16-27	Gilbert Eddy
16-28	Kenneth Tomblin Et Al
16-36	George Karabetis
16-37	Rosella Murner
16-38	EQT Production Company
16-39	Richard Pyles
16-39.1	Leo Wiker
16-40	Gary Weekley
16-42	Richard Pyles
16-42.3	Richard Pyles
16-58	American Energy Marcellus Minerals LLC
22-6	EQT Production Company
22-7	Kenneth Baker
22-8	EQT Production Company
22-9	Steven Wright
22-10	Leslie Henderson
22-13	Debra Blake
22-14	Leslie Weekley
22-15	Lannie Wade Et Al
22-16	Darlene Stephens
22-16.1	Joann McSwegin
22-16.2	Sarah Bassett

WELL TYPE: OIL \_\_\_ GAS X LIQUID INJECTION \_\_\_ WASTE DISPOSAL \_\_\_ 47 - 095 - 02743  
 (IF "GAS") PRODUCTION X STORAGE \_\_\_ DEEP \_\_\_ SHALLOW X STATE COUNTY PERMIT  
 LOCATION: ELEVATION AS BUILT - 1,040' WATERSHED OUTLET MIDDLE ISLAND CREEK  
 QUADRANGLE PORTER FALLS 7.5' DISTRICT ELLSWORTH COUNTY TYLER  
 SURFACE OWNER KAYLA LEEK ACREAGE 69.06 ACRES +/-  
 OIL & GAS ROYALTY OWNER RIDGETOP CAPITAL LP; RIDGETOP CAPITAL IV LP; LEASE ACREAGE 69.06 AC.±; 43.5 AC.±;  
RIDGETOP CAPITAL IV LP; NILE DEAN HARRIS; DOUGLAS SCOTT FUNK, SR.; ANTERO RESOURCES CORP.; JOHN E. VALENTOUR ET UX; 16.5 AC.±; 53.75 AC.±; 10 AC.±; 02,000,000,000  
HARVEY J. MILLER; BRC APPALACHIAN MINERALS I LLC; S.A. SMITH & C.B. MORRIS HEIRS TRUST; BOUNTY MINERALS LLC; BETTY MOREHEAD ET VIR; 70 AC.±; 55.13 AC.±; 304.5 AC.±; 92.25 AC.±; 68.88 AC.±;  
MORRIS MOUNTAINEER OIL & GAS LLC; BRENDA CUIC; CAROL J. KNAPP; BERNICE BAKER; JAMES A. WEEKLEY ET AL.; JANIE DENOON TRUST 45.98 AC.±; 114 AC.±; 77.5 AC.±; 45 AC.±; 58.5 AC.±; 20 AC.±;  
 PROPOSED WORK: DRILL \_\_\_ CONVERT \_\_\_ DRILL DEEPER \_\_\_ REDRILL \_\_\_ FRACTURE OR STIMULATE \_\_\_  
 PLUG OFF OLD FORMATION \_\_\_ PERFORATE NEW FORMATION \_\_\_ OTHER PHYSICAL CHANGE IN WELL \_\_\_  
 (SPECIFY) AS DRILLED PLUG & ABANDON \_\_\_ CLEAN OUT & REPLUG \_\_\_  
 TARGET FORMATION MARCELLUS ESTIMATED DEPTH 6,670' TVD 22,764' MD  
 WELL OPERATOR ANTERO RESOURCES CORP. DESIGNATED AGENT DIANNA STAMPER - CT CORPORATION SYSTEM  
 ADDRESS 1615 WYNKOOP ST. ADDRESS 5400 D BIG TYLER ROAD  
 FORM WW-6 DENVER, CO 80202 ADDRESS CHARLESTON, WV 25313

7,188' TO BOTTOM HOLE

LONGITUDE 80°47'30"

8,798'

LONGITUDE 80°47'30"

COUNTY PERMIT