

LATITUDE 39°32'30"

10,558'

LATITUDE 39°32'30"

5,404' TO BOTTOM HOLE

Antero Resources Corporation Well No. National Unit 1H

AS DRILLED DATA:
WELL 1H TOP HOLE INFORMATION:
 N: 373,411ft E: 1,625,056ft
 LAT: 39°31'03.42" LON: 80°49'44.73"
BOTTOM HOLE INFORMATION:
 N: 359,840ft E: 1,630,016ft
 LAT: 39°28'50.02" LON: 80°48'38.92"
 WEST VIRGINIA COORDINATE SYSTEM OF 1927 NORTH ZONE. ZONE WAS DERIVED FROM MEASUREMENTS TAKEN WITH TRIMBLE GEOXT SUBMETER MAPPING GRADE GPS UNIT. PLAT ORIENTATION, CORNER, AND WELL REFERENCE TIE LINES ARE BASED ON GRID NORTH.

(NAD) 83 (UTM) ZONE 17 COORDS:
WELL 1H TOP HOLE INFORMATION:
 N: 4,374,242m E: 514,706m
BOTTOM HOLE INFORMATION:
 N: 4,370,133m E: 516,286m

PAD LAYOUT NOT TO SCALE

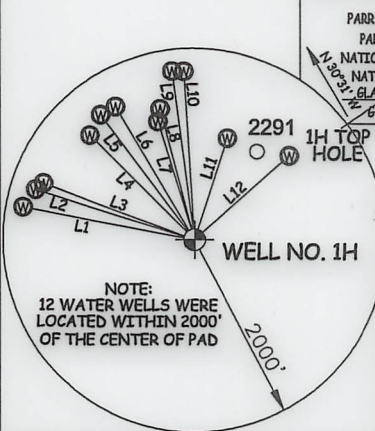

NOTE:
12 WATER WELLS WERE LOCATED WITHIN 2000' OF THE CENTER OF PAD

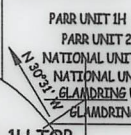

GRID NORTH

PARR UNIT 1H
PARR UNIT 2H
NATIONAL UNIT 1H
NATIONAL UNIT 2H
GLANDRING UNIT 1H
GLANDRING UNIT 2H

2291 1H TOP HOLE

2000'

WELL NO. 1H

| LINE | BEARING | DIST. | LINE | BEARING | DIST. |
|------|------------|----------|------|------------|----------|
| L1 | N 79°23' W | 1820.64' | L7 | N 17°11' W | 1289.39' |
| L2 | N 72°38' W | 1737.73' | L8 | N 14°44' W | 1409.38' |
| L3 | N 69°39' W | 1680.54' | L9 | N 07°35' W | 1774.82' |
| L4 | N 45°05' W | 1540.95' | L10 | N 03°37' W | 1761.12' |
| L5 | N 36°53' W | 1627.55' | L11 | N 17°55' E | 1113.36' |
| L6 | N 30°40' W | 1612.05' | L12 | N 48°24' E | 1322.09' |

| | |
|---------|---------------------------------|
| 22-16.3 | Charles Stevens |
| 22-17 | Dorothy Stevens Revocable Trust |
| 22-18 | Clara Baker |
| 22-18.1 | Dorothy Stevens Revocable Trust |
| 22-21 | Paul Baker |
| 22-22 | Paul Baker |
| 22-23 | Anthony Parr |
| 22-23.1 | Raymond Parr |
| 22-23.2 | Anthony Parr |
| 22-24 | Ruth Weekley Est. |
| 22-25 | Paul Baker |
| 22-26 | John Sale |
| 22-27 | Carol Knapp Revocable Trust |
| 22-28 | WSD Properties LLC |
| 22-29 | WSD Properties LLC |
| 22-30 | WSD Properties LLC |
| 22-31 | Richard Gradslly Et Al |
| 22-32 | Richard Gradslly Et Al |
| 22-33 | Wilma Weekley |
| 22-34 | Raymond Parr Et Al |
| 22-38 | Bruce Parr |
| 22-40 | Ronald Webb |

I, THE UNDERSIGNED, HEREBY CERTIFY THAT THIS PLAT IS CORRECT TO THE BEST OF MY KNOWLEDGE AND BELIEF AND SHOWS ALL THE INFORMATION REQUIRED BY LAW AND THE RULES ISSUED AND PERSCRIBED BY THE DEPARTMENT OF ENVIRONMENTAL PROTECTION.



STATE OF WEST VIRGINIA, DIVISION OF ENVIRONMENTAL PROTECTION, OFFICE OF OIL AND GAS
 WILLOW LAND SURVEYING PLLC
 220 MASONIC AVE. PENNSBORO WEST VIRGINIA 26415

JOB # 21-007WA
 DRAWING # NATIONAL1HAD
 SCALE 1" = 2000'
 MINIMUM DEGREE OF ACCURACY SUBMETER
 PROVEN SOURCE OF ELEV. SUBMETER MAPPING GRADE GPS

LEGEND
 - - - Surface Owner Boundary Lines +/-
 - - - Interior Surface Tracts +/-
 O Proposed Well Path
 O As Drilled Well Path

Thomas Summers
 THOMAS SUMMERS P.S. 2109

STATE OF WEST VIRGINIA DEPARTMENT OF ENERGY DIVISION OF OIL AND GAS

DATE 04/07/22
 OPERATOR'S WELL# NATIONAL UNIT #1H

WELL TYPE: OIL ___ GAS X LIQUID INJECTION ___ WASTE DISPOSAL ___ API WELL # 47 - 095 - 02744
 (IF "GAS") PRODUCTION X STORAGE ___ DEEP ___ SHALLOW X STATE COUNTY PERMIT
 LOCATION: ELEVATION AS BUILT - 1,040' WATERSHED OUTLET MIDDLE ISLAND CREEK

QUADRANGLE PORTER FALLS 7.5' DISTRICT ELLSWORTH COUNTY TYLER

SURFACE OWNER KAYLA LEEK ACREAGE 69.06 ACRES +/-

OIL & GAS ROYALTY OWNER RIDGETOP CAPITAL LP; BRC APPALACHIAN MINERALS I LLC; LEASE ACREAGE 69.06 AC.±; 373.47 AC.±;
 BOUNTY MINERALS LLC; ROSELLA MAY MURNER SHEPHERD; 92.25 AC.±; 30 AC.±;

BRC APPALACHIAN MINERALS I LLC; KAY F. HAIN REVOCABLE LIVING TRUST; DAVID E. BOWYER; DAVID E. BOWYER; 35 AC.±; 37 AC.±; 60 AC.±; 96 AC.±;
 BRENDA CUIC; CLARA SUE BAKER; PAUL RICHARD BAKER 114 AC.±; 13.56 AC.±; 39.96 AC.±;

PROPOSED WORK: DRILL ___ CONVERT ___ DRILL DEEPER ___ REDRILL ___ FRACTURE OR STIMULATE ___
 PLUG OFF OLD FORMATION ___ PERFORATE NEW FORMATION ___ OTHER PHYSICAL CHANGE IN WELL

(SPECIFY) AS DRILLED PLUG & ABANDON CLEAN OUT & REPLUG
 TARGET FORMATION MARCELLUS ESTIMATED DEPTH 6,655' TVD 21,279' MD

WELL OPERATOR ANTERO RESOURCES CORP. DESIGNATED AGENT DIANNA STAMPER - CT CORPORATION SYSTEM
 ADDRESS 1615 WYNKOOP ST. ADDRESS 5400 D BIG TYLER ROAD
 FORM WW-6 DENVER, CO 80202 CHARLESTON, WV 25313

| Ellsworth District - Tyler County | |
|-----------------------------------|--|
| 11-51 | Bear Knob Holdings LLC |
| 16-5 | David Leek |
| 16-5.1 | Richard Ferrell |
| 16-6 | Kayla Leek |
| 16-7 | John Thomas |
| 16-7.1 | Lianne Wilson |
| 16-8 | Jean Neel Et Al |
| 16-9 | Bear Knob Holdings LLC |
| 16-10 | Jean Neel Et Al |
| 16-11 | Jean Neel Et Al |
| 16-15 | Harvey Miller Et Al |
| 16-16 | Harvey Miller Et Al |
| 16-16.1 | Barbara Kittle |
| 16-17 | Alfred Steele |
| 16-18 | Alfred Steele |
| 16-19 | Jean Neel Et Al |
| 16-20 | Jean Neel Et Al |
| 16-21 | Kayla Leek |
| 16-24 | James Eastham |
| 16-25 | Nancy Fowler |
| 16-26 | Barbara Kittle |
| 16-27 | Gilbert Eddy |
| 16-28 | Kenneth Tomblin Et Al |
| 16-36 | George Karabetis |
| 16-37 | Rosella Murner |
| 16-38 | EQT Production Company |
| 16-39 | Richard Pyles |
| 16-39.1 | Leo Wilker |
| 16-40 | Gary Weekley |
| 16-42 | Richard Pyles |
| 16-42.3 | Richard Pyles |
| 16-58 | American Energy Marcellus Minerals LLC |
| 22-6 | EQT Production Company |
| 22-7 | Kenneth Baker |
| 22-8 | EQT Production Company |
| 22-9 | Steven Wright |
| 22-10 | Leslie Henderson |
| 22-13 | Debra Blake |
| 22-14 | Leslie Weekley |
| 22-15 | Lannie Wade Et Al |
| 22-16 | Darlene Stephens |
| 22-16.1 | Joann McSwegin |
| 22-16.2 | Sarah Bassett |

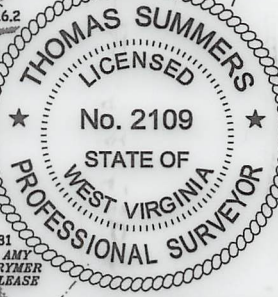

NOTES
 1. NO OCCUPIED DWELLINGS OR BUILDINGS TWO THOUSAND FIVE HUNDRED (2,500) SQUARE FEET OR LARGER USED TO HOUSE OR SHELTER DAIRY CATTLE OR POULTRY HUSBANDRY ARE LOCATED WITHIN SIX HUNDRED TWENTY-FIVE (625) FEET OF THE CENTER OF THE WELL PAD.
 2. TOP HOLE DATA SHOWN HEREON WAS PROVIDED BY ANTERO RESOURCES CORPORATION.
 3. AS DRILLED DATA WAS PROVIDED BY ANTERO RESOURCES CORPORATION.
 4. WLS IS NOT CERTIFYING THE DATA AND INFORMATION PROVIDED LISTED IN NOTES 2 AND 3, ONLY THE RELATIONSHIP TO THE DATA AND INFORMATION PROVIDED TO THE LEASE BOUNDARIES.
 5. WLS IS BY NO MEANS RESPONSIBLE FOR ANY ERRORS OR INACCURACIES WITH THE DATA AND INFORMATION THAT HAS BEEN PROVIDED.

COUNTY TYLER PERMIT

LONGITUDE 80°47'30"

COUNTY TYLER PERMIT