

State of West Virginia
Department of Environmental Protection - Office of Oil and Gas
Well Operator's Report of Well Work

API 47 - 095 - 02746 County Tyler District Ellsworth
Quad Porter Falls 7.5' Pad Name Margery Field/Pool Name -----
Farm name Kayla Leek Well Number Parr Unit 1H
Operator (as registered with the OOG) Antero Resources Corporation
Address 1615 Wynkoop Street City Denver State CO Zip 80202

As Drilled location NAD 83/UTM Attach an as-drilled plat, profile view, and deviation survey
Top hole Northing 4374250m Easting 514701m
Landing Point of Curve Northing 4373535.48m Easting 514565.72m
Bottom Hole Northing 4369682m Easting 515907m

Elevation (ft) 1040' GL Type of Well New Existing Type of Report Interim Final
Permit Type Deviated Horizontal Horizontal 6A Vertical Depth Type Deep Shallow
Type of Operation Convert Deepen Drill Plug Back Redrilling Rework Stimulate
Well Type Brine Disposal CBM Gas Oil Secondary Recovery Solution Mining Storage Other _____
Type of Completion Single Multiple Fluids Produced Brine Gas NGL Oil Other _____
Drilled with Cable Rotary

Drilling Media Surface hole Air Mud Fresh Water Intermediate hole Air Mud Fresh Water Brine
Production hole Air Mud Fresh Water Brine
Mud Type(s) and Additive(s)
Air - Foam & 4% KCL
Mud - Polymer

RECEIVED
Office of Oil and Gas
 Fresh Water Brine
MAR 03 2023
WV Department of
Environmental Protection

Date permit issued 7/29/2021 Date drilling commenced 8/18/2021 Date drilling ceased 11/26/2021
Date completion activities began 1/2/2022 Date completion activities ceased 2/8/2022
Verbal plugging (Y/N) N/A Date permission granted N/A Granted by N/A

Please note: Operator is required to submit a plugging application within 5 days of verbal permission to plug

Freshwater depth(s) ft 102' Open mine(s) (Y/N) depths No
Salt water depth(s) ft 1998' Void(s) encountered (Y/N) depths No
Coal depth(s) ft N/A Cavern(s) encountered (Y/N) depths No
Is coal being mined in area (Y/N) No

Reviewed by:

06/02/2023

API 47- 095 - 02746 Farm name Kayla Leek Well number Parr Unit 1H

CASING STRINGS	Hole Size	Casing Size	Depth	New or Used	Grade wt/ft	Basket Depth(s)	Did cement circulate (Y/N) * Provide details below*
Conductor	28"	20"	125.5'	New	94#, H-40	N/A	Y
Surface	17-1/2"	13-3/8"	427'	New	54.5#, J-55	N/A	Y
Coal							
Intermediate 1	12-1/4"	9-5/8"	2651'	New	36#, J-55	N/A	Y
Intermediate 2							
Intermediate 3							
Production	8-3/4"/8-1/2"	5-1/2"	22323'	New	23#, P-110	N/A	Y
Tubing		2-3/8"	6705'		4.7#, P-110		
Packer type and depth set		N/A					

Comment Details _____

CEMENT DATA	Class/Type of Cement	Number of Sacks	Slurry wt (ppg)	Yield (ft ³ /sks)	Volume (ft ³)	Cement Top (MD)	WOC (hrs)
Conductor	Class A	390 sx	15.6	1.18	460	0'	8 Hrs.
Surface	Class A	431 sx	15.6	1.20	517	0'	8 Hrs.
Coal							
Intermediate 1	Class A	900 sx	15.6	1.19	1071	0'	8 Hrs.
Intermediate 2							
Intermediate 3							
Production	Class G	3606 sx (Tail)	13.5 (Lead), 15.2(Tail)	1.26 (Tail)	4544	-500' into Intermediate Casing	8 Hrs.
Tubing							

Drillers TD (ft) 22323' MD, 6645' TVD (BHL), 6676' (Deepest Point Drilled) Loggers TD (ft) 22323' MD
 Deepest formation penetrated Marcellus Plug back to (ft) N/A
 Plug back procedure N/A

Kick off depth (ft) 5840'

Check all wireline logs run caliper density deviated/directional induction
 neutron resistivity gamma ray temperature sonic

Well cored Yes No Conventional Sidewall Were cuttings collected Yes No

DESCRIBE THE CENTRALIZER PLACEMENT USED FOR EACH CASING STRING _____

Conductor - 0
 Surface - 1 above guide shoe, 1 above insert float, 1 every 4th joint to surface
 Intermediate - 1 above float joint, 1 above float collar, 1 every 4th joint to surface
 Production - 1 above float joint, 1 below float collar, 1 every 3rd joint to top of cement

WAS WELL COMPLETED AS SHOT HOLE Yes No DETAILS _____

WAS WELL COMPLETED OPEN HOLE? Yes No DETAILS _____

WERE TRACERS USED Yes No TYPE OF TRACER(S) USED N/A

API 47-095-02746 Farm Name Kayla Leek Well Number Parr Unit 1H

Exhibit 1

Stage No.	Perforation Date	Perforated from MD ft.	Perforated to MD ft.	Number of Perforations	Formations
1	01/02/2022	22207.0	0	60	Marcellus
2	01/02/2022	22121.8	21943.0143	60	Marcellus
3	01/02/2022	21868.7	21689.8643	60	Marcellus
4	01/03/2022	21615.5	21436.7143	60	Marcellus
5	01/03/2022	21362.4	21183.5643	60	Marcellus
6	01/03/2022	21109.2	20930.4143	60	Marcellus
7	01/04/2022	20856.1	20677.2643	60	Marcellus
8	01/04/2022	20602.9	20424.1143	60	Marcellus
9	01/04/2022	20349.8	20170.9643	60	Marcellus
10	01/05/2022	20096.6	19917.8143	60	Marcellus
11	01/05/2022	19843.5	19664.6643	60	Marcellus
12	01/05/2022	19590.3	19411.5143	60	Marcellus
13	01/06/2022	19337.2	19158.3643	60	Marcellus
14	01/06/2022	19084.0	18905.2143	60	Marcellus
15	01/06/2022	18830.9	18652.0643	60	Marcellus
16	01/07/2022	18577.7	18398.9143	60	Marcellus
17	01/07/2022	18324.6	18145.7643	60	Marcellus
18	01/08/2022	18071.4	17892.6143	60	Marcellus
19	01/08/2022	17818.3	17639.4643	60	Marcellus
20	01/08/2022	17565.1	17386.3143	60	Marcellus
21	01/09/2022	17312.0	17133.1643	60	Marcellus
22	01/09/2022	17058.8	16880.0143	60	Marcellus
23	01/10/2022	16805.7	16626.8643	60	Marcellus
24	01/10/2022	16552.5	16373.7143	60	Marcellus
25	01/11/2022	16299.4	16120.5643	60	Marcellus
26	01/11/2022	16046.2	15867.4143	60	Marcellus
27	01/12/2022	15793.1	15614.2643	60	Marcellus
28	01/12/2022	15539.9	15361.1143	60	Marcellus
29	01/12/2022	15286.8	15107.9643	60	Marcellus
30	01/12/2022	15033.6	14854.8143	60	Marcellus
31	01/13/2022	14780.5	14601.6643	60	Marcellus
32	01/13/2022	14527.3	14348.5143	60	Marcellus
33	01/14/2022	14274.2	14095.3643	60	Marcellus
34	01/14/2022	14021.0	13842.2143	60	Marcellus
35	01/14/2022	13767.9	13589.0643	60	Marcellus
36	01/15/2022	13514.7	13335.9143	60	Marcellus
37	01/15/2022	13261.6	13082.7643	60	Marcellus
38	01/15/2022	13008.4	12829.6143	60	Marcellus
39	01/15/2022	12755.3	12576.4643	60	Marcellus
40	01/16/2022	12502.1	12323.3143	60	Marcellus
41	01/16/2022	12249.0	12070.1643	60	Marcellus
42	01/16/2022	11995.8	11817.0143	60	Marcellus
43	01/18/2022	11742.7	11563.8643	60	Marcellus
44	01/18/2022	11489.5	11310.7143	60	Marcellus
45	01/18/2022	11236.4	11057.5643	60	Marcellus
46	01/19/2022	10983.2	10804.4143	60	Marcellus
47	01/21/2022	10730.1	10551.2643	60	Marcellus
48	01/21/2022	10476.9	10298.1143	60	Marcellus
49	01/21/2022	10223.8	10044.9643	60	Marcellus
50	01/21/2022	9970.6	9791.81429	60	Marcellus
51	01/22/2022	9717.5	9538.66429	60	Marcellus
52	01/22/2022	9464.3	9285.51429	60	Marcellus
53	01/22/2022	9211.2	9032.36429	60	Marcellus
54	01/22/2022	8958.0	8779.21429	60	Marcellus
55	01/23/2022	8704.9	8526.06429	60	Marcellus
56	01/23/2022	8451.7	8272.91429	60	Marcellus
57	01/23/2022	8198.6	8019.76429	60	Marcellus
58	01/23/2022	7945.4	7766.61429	60	Marcellus
59	01/24/2022	7692.3	7513.46429	60	Marcellus
60	01/24/2022	7439.1	7260.31429	60	Marcellus
61	01/24/2022	7186.0	7007.16429	60	Marcellus

RECEIVED
Office of Oil and Gas

MAR 03 2023

WV Department of
Environmental Protection

06/02/2023

EXHIBIT 2

Stage No.	Stimulations Date	Avg Pump Rate	Avg Treatment Pressure (PSI)	Max Breakdown Pressure (PSI)	ISIP (PSI)	Amount of Proppant (lbs)	Amount of Water (bbls)	Amount of Nitrogen/ other (units)
1	01/02/2022	78.9	9983	9256	4351	173360	219637	N/A
2	01/02/2022	86.6	10296	6299	4185	504700	401023	N/A
3	01/02/2022	85.6	10203	6106	3802	507860	373660	N/A
4	01/03/2022	80.7	9574	6356	3768	519360	508886	N/A
5	01/03/2022	84.1	9785	5707	3787	519359	402789	N/A
6	01/03/2022	82.0	9856	6272	3868	505750	386662	N/A
7	01/04/2022	86.4	10085	9032	4063	519780	402190	N/A
8	01/04/2022	86.8	10184	10494	3755	499278	370327	N/A
9	01/04/2022	86.4	10036	6472	3699	509720	374793	N/A
10	01/05/2022	86.1	10016	8372	3603	520820	377346	N/A
11	01/05/2022	89.5	10036	7405	4174	512450	360735	N/A
12	01/05/2022	89.7	10174	7887	3976	506110	366532	N/A
13	01/06/2022	88.7	10055	6515	3871	507820	375691	N/A
14	01/06/2022	90.8	10035	7809	4056	505710	370290	N/A
15	01/06/2022	91.9	10191	7536	4210	512010	372187	N/A
16	01/07/2022	87.5	10037	7966	3743	510080	376131	N/A
17	01/07/2022	91.8	10041	7888	3568	501870	364726	N/A
18	01/08/2022	90.9	10030	6986	3845	499160	367781	N/A
19	01/08/2022	91.9	10027	8119	3737	504130	363089	N/A
20	01/08/2022	92.4	10085	9474	3723	498690	366114	N/A
21	01/09/2022	91.9	10036	5685	3941	516290	379952	N/A
22	01/09/2022	91.8	9980	8026	3708	514890	364263	N/A
23	01/10/2022	94.5	10096	6520	3884	513120	366250	N/A
24	01/10/2022	93.9	9988	8491	3744	455040	371326	N/A
25	01/11/2022	91.9	9873	7810	3791	517030	373112	N/A
26	01/11/2022	94.2	10062	6147	3987	508690	368093	N/A
27	01/12/2022	94.0	9917	8613	3776	517440	369176	N/A
28	01/12/2022	94.5	9823	7281	3898	507840	370454	N/A
29	01/12/2022	96.5	9781	7643	3575	518460	368505	N/A
30	01/12/2022	94.3	9567	8794	3595	507620	366588	N/A
31	01/13/2022	95.1	9687	8455	3801	517210	366869	N/A
32	01/13/2022	98.3	9818	6808	3875	507760	362162	N/A
33	01/14/2022	95.4	9627	7500	3819	499260	363905	N/A
34	01/14/2022	97.0	9998	5777	3682	517540	365558	N/A
35	01/14/2022	96.5	9470	6589	3605	522870	355777	N/A
36	01/15/2022	95.4	9806	7060	3420	520420	369147	N/A
37	01/15/2022	98.0	9800	6502	3968	510680	360663	N/A
38	01/15/2022	97.8	9704	6284	3823	513990	364173	N/A
39	01/15/2022	95.0	9657	8693	3522	512430	357724	N/A
40	01/16/2022	96.0	9456	7529	3602	503490	360971	N/A
41	01/16/2022	96.3	9388	7050	3605	507820	365771	N/A
42	01/16/2022	98.0	9360	6319	3761	505150	360937	N/A
43	01/18/2022	95.0	9152	6126	3844	519280	410367	N/A
44	01/18/2022	96.5	8894	5934	3704	506340	361490	N/A
45	01/18/2022	97.5	9169	7175	3444	500900	362463	N/A
46	01/19/2022	97.8	9263	8237	3559	512990	357203	N/A
47	01/21/2022	96.5	8834	6043	3993	505790	400199	N/A
48	01/21/2022	96.2	9045	6006	3531	518430	384156	N/A
49	01/21/2022	97.4	8998	6274	3463	506430	365811	N/A
50	01/21/2022	98.5	8923	8276	3561	504130	372173	N/A
51	01/22/2022	98.2	9048	8194	3698	523400	368956	N/A
52	01/22/2022	98.3	8961	5838	3969	504900	380646	N/A
53	01/22/2022	97.3	8716	5781	3964	501040	375526	N/A
54	01/22/2022	98.5	8709	7384	3617	503090	373798	N/A
55	01/23/2022	98.1	8844	8293	3720	505421	370593	N/A
56	01/23/2022	97.8	8785	6046	4677	505990	376438	N/A
57	01/23/2022	97.2	8802	5816	4061	505880	373199	N/A
58	01/23/2022	97.3	8679	6820	3699	521700	375146	N/A
59	01/24/2022	98.4	8631	7624	4082	503310	371258	N/A
60	01/24/2022	98.6	8516	8251	3808	503860	369785	N/A
61	01/24/2022	98.0	8425	6985	4369	519100	377775	N/A
	AVERAGE	93	9,574	7,256	3,819	30,725,038	22,678,947	TOTAL

EXHIBIT 3

LITHOLOGY/ FORMATION	TOP DEPTH (TVD)	BOTTOM DEPTH (TVD)	TOP DEPTH (MD)	BOTTOM DEPTH (MD)
	From Surface	From Surface	From Surface	From Surface
Silty Sandstone	74	134	74	134
Shaley Siltstone	134	194	134	194
Shaley Sandstone	194	344	194	344
Shaley Siltstone	344	734	344	734
Sandy Siltstone	734	854	734	854
Shaley Siltstone, Tr Limestone	854	1,334	854	1,334
Shaley Sandstone	1,334	1,454	1,334	1,454
Sandstone, Tr Shale	1,454	1,634	1,454	1,634
Silty Shale	1,634	1,784	1,634	1,784
Shaley Siltstone	1,784	1,844	1,784	1,844
Sandy Shale	1,844	1,874	1,844	1,874
Shale, Tr Limestone	1,874	1,904	1,874	1,904
Shaley Limestone	1,904	1,912	1,904	1,936
Big Lime	1,938	2,720	1,936	2,760
Fifty Foot Sandstone	2,720	2,832	2,734	2,875
Gordon	2,832	3,088	2,849	3,136
Fifth Sandstone	3,088	3,199	3,110	3,249
Bayard	3,199	3,956	3,223	4,016
Speechley	3,956	4,185	3,990	4,249
Balltown	4,185	4,514	4,223	4,581
Bradford	4,514	4,929	4,555	5,001
Benson	4,929	5,250	4,975	5,326
Alexander	5,250	6,404	5,300	6,553
Sycamore	6,277	6,378	6,396	6,527
Middlesex	6,378	6,475	6,527	6,684
Burkett	6,475	6,504	6,684	6,744
Tully	6,504	6,562	6,744	6,923
Marcellus	6,562	NA	6,923	NA

*Please note Antero determines formation tops based on mud logs that are only run on one well on a multi-well pad. The measured depth (MD) data on subsequent wells may be slightly different due to the well's unique departure.

RECEIVED
Office of Oil and Gas

MAR 03 2023

WV Department of
Environmental Protection

06/02/2023

Hydraulic Fracturing Fluid Product Component Information Disclosure

Job Start Date:	1/1/2022
Job End Date:	1/24/2022
State:	West Virginia
County:	Tyler
API Number:	47-095-02746-00-00
Operator Name:	Antero Resources Corporation
Well Name and Number:	PARR UNIT 1H
Latitude:	39.51769000
Longitude:	-80.82914700
Datum:	WGS84
Federal Well:	NO
Indian Well:	NO
True Vertical Depth:	6,676
Total Base Water Volume (gal):	23,444,982
Total Base Non Water Volume:	0



Hydraulic Fracturing Fluid Composition:

Trade Name	Supplier	Purpose	Ingredients	Chemical Abstract Service Number (CAS #)	Maximum Ingredient Concentration in Additive (% by mass)**	Maximum Ingredient Concentration in HF Fluid (% by mass)**	Comments
Produced Water	Halliburton	Base Fluid	Water	7732-18-5	100.00000	86.52170	Density = 8.50
Ingredients	Listed Above	Listed Above					
			Water	7732-18-5	100.00000	0.05838	

RECEIVED
 Office of Oil and Gas
 MAR 03 2022
 WV Department of
 Environmental Protection

OPTIFLO-II DELAYED RELEASE BREAKER	Halliburton	Breaker					
				Listed Below			
Excelerate LX-15	Halliburton	Friction Reducer					
				Listed Below			
FLUID Enviro- Syn HCR-7000- WL	Fluid Energy Group	Acid Replacement					
				Listed Below			
MC B-8614A	MultiChem	Biocide					
				Listed Below			
HYDROCHLORI C ACID, 22 BAUME	Halliburton	Solvent					
				Listed Below			
HAI-501	Halliburton	Acid Corrosion Inhibitor					
				Listed Below			
WG-36 GELLING AGENT	Halliburton	Gelling Agent					
				Listed Below			
Sand-Common White-100 Mesh, SSA-2	Halliburton	Proppant					
				Listed Below			

RECEIVED
 Office of Oil and Gas
 MAR 08 2023
 WV Department of
 Environmental Protection

Items above are Trade Names with the exception of Base Water . Items below are the individual ingredients.

			Crystalline silica, quartz	14808-60-7	100.00000	13.33979	
			Complex Amine Compound	Proprietary	60.00000	0.03324	
			Hydrotreated light petroleum distillate	64742-47-8	30.00000	0.01662	
			Proprietary	Proprietary	20.00000	0.01075	
			Proprietary	Proprietary	10.00000	0.00537	
			Hydrochloric acid	7647-01-0	30.00000	0.00499	
			Guar gum	9000-30-0	100.00000	0.00407	
			Sorbitan, mono-9-octadecenoate, (Z)	1338-43-8	5.00000	0.00277	
			Surfactant	Proprietary	5.00000	0.00277	
			Glutaraldehyde	111-30-8	30.00000	0.00255	
			Ethoxylated alcohols	Proprietary	5.00000	0.00056	
			Alkoxylated polyhydric alcohol	Proprietary	1.00000	0.00055	
			Organic chloride compound	Proprietary	1.00000	0.00055	
			Alkyl (C12-16) dimethylbenzyl ammonium chloride	68424-85-1	5.00000	0.00043	
			Ammonium persulfate	7727-54-0	100.00000	0.00013	
			Ethanol	64-17-5	1.00000	0.00009	
			Oxylated phenolic resin	Proprietary	30.00000	0.00004	
			Methanol	67-56-1	100.00000	0.00003	
			Modified thiourea polymer	Proprietary	30.00000	0.00001	
			Mixture of dimer and trimer fatty acids of indefinite composition derived from tall oil	61790-12-3	30.00000	0.00001	
			Nitrated acetate salt	Proprietary	0.01000	0.00001	
			Organic salt #1	Proprietary	0.01000	0.00001	
			Sodium hydroxide	1310-73-2	0.01000	0.00001	
			Organic salt #2	Proprietary	0.01000	0.00001	

RECEIVED
 Office of Oil and Gas
 MAR 03 2013
 WV Department of
 Environmental Protection

			Acrylamide	79-06-1	0.01000	0.00001	
			Formaldehyde	50-00-0	0.01000	0.00001	
			Sodium glycolate	2836-32-0	0.01000	0.00001	
			Hexadecene	629-73-2	5.00000	0.00000	
			Propargyl alcohol	107-19-7	5.00000	0.00000	
			C.I. pigment Orange 5	3468-63-1	1.00000	0.00000	

- * Total Water Volume sources may include various types of water including fresh water, produced water, and recycled water
- ** Information is based on the maximum potential for concentration and thus the total may be over 100%
- *** If you are calculating a percentage of total ingredients do not add the water volume below the green line to the water volume above the green line

Note: For Field Development Products (products that begin with FDP), MSDS level only information has been provided.
 Ingredient information for chemicals subject to 29 CFR 1910.1200(i) and Appendix D are obtained from suppliers Material Safety Data Sheets (MSDS)

RECEIVED
 Office of Oil and Gas
MAR 03 2023
 WV Department of
 Environmental Protection

LATITUDE 39°32'30"

10,574'

LATITUDE 39°30'00"

6,650' TO BOTTOM HOLE

8,734'

LONGITUDE 80°47'30"

8,558' TO BOTTOM HOLE

Antero Resources Corporation Well No. Parr Unit 1H

AS DRILLED DATA:
WELL 1H TOP HOLE INFORMATION:
 N: 373,437ft E: 1,625,041ft
 LAT: 39°31'03.67" LON: 80°49'44.93"
BOTTOM HOLE INFORMATION:
 N: 358,381ft E: 1,628,749ft
 LAT: 39°28'35.42" LON: 80°48'54.80"
WEST VIRGINIA COORDINATE SYSTEM OF 1927 NORTH ZONE. ZONE WAS DERIVED FROM MEASUREMENTS TAKEN WITH TRIMBLE GEOXT SUBMETER MAPPING GRADE GPS UNIT. PLAT ORIENTATION, CORNER, AND WELL REFERENCE TIE LINES ARE BASED ON GRID NORTH.

(NAD) 83 (UTM) ZONE 17 COORDS:
WELL 1H TOP HOLE INFORMATION:
 N: 4,374,250m E: 514,701m
BOTTOM HOLE INFORMATION:
 N: 4,369,682m E: 515,907m

PAD LAYOUT NOT TO SCALE

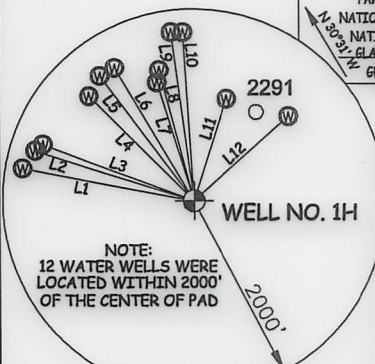
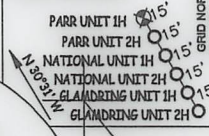

NOTE:
12 WATER WELLS WERE LOCATED WITHIN 2000' OF THE CENTER OF PAD

LINE	BEARING	DIST.	LINE	BEARING	DIST.
L1	N 79°23' W	1820.64'	L7	N 17°11' W	1289.39'
L2	N 72°38' W	1737.73'	L8	N 14°44' W	1409.38'
L3	N 69°39' W	1680.54'	L9	N 07°35' W	1774.82'
L4	N 45°05' W	1540.95'	L10	N 03°37' W	1761.12'
L5	N 36°53' W	1627.55'	L11	N 17°55' E	1113.36'
L6	N 30°40' W	1612.05'	L12	N 48°24' E	1322.09'

I, THE UNDERSIGNED, HEREBY CERTIFY THAT THIS PLAT IS CORRECT TO THE BEST OF MY KNOWLEDGE AND BELIEF AND SHOWS ALL THE INFORMATION REQUIRED BY LAW AND THE RULES ISSUED AND PERSCRIBED BY THE DEPARTMENT OF ENVIRONMENTAL PROTECTION.



STATE OF WEST VIRGINIA, DIVISION OF ENVIRONMENTAL PROTECTION, OFFICE OF OIL AND GAS
 WILLOW LAND SURVEYING PLLC
 220 MASONIC AVE. PENNSBORO WEST VIRGINIA 26415

Ellsworth District - Tyler County	
11-51	Bear Knob Holdings LLC
16-5	David Leek
16-5.1	Richard Ferrell
16-6	Kayla Leek
16-7	John Thomas
16-7.1	Lianne Wilson
16-8	Jean Neel Et Al
16-9	Bear Knob Holdings LLC
16-10	Jean Neel Et Al
16-11	Jean Neel Et Al
16-15	Harvey Miller Et Al
16-16	Harvey Miller Et Al
16-16.1	Barbara Kittle
16-17	Alfred Steele
16-18	Alfred Steele
16-19	Jean Neel Et Al
16-20	Jean Neel Et Al
16-21	Kayla Leek
16-24	James Eastham
16-25	Nancy Fowler
16-26	Barbara Kittle
16-27	Gilbert Eddy
16-28	Kenneth Tomblin Et Al
16-36	George Karabettis
16-37	Rosella Murner
16-38	EQT Production Company
16-39	Richard Pyles
16-39.1	Leo Wiker
16-40	Gary Weekley
16-42	Richard Pyles
16-42.3	Richard Pyles
16-58	American Energy Marcellus Minerals LLC
22-6	EQT Production Company
22-7	Kenneth Baker
22-8	EQT Production Company
22-9	Steven Wright
22-10	Leslie Henderson
22-13	Debra Blake
22-14	Leslie Weekley
22-15	Lonnie Wade Et Al
22-16	Darlene Stephens
22-16.1	Joann McSwegin
22-16.2	Sarah Bassett

22-16.3	Charles Stevens
22-17	Dorothy Stevens Revocable Trust
22-18	Clara Baker
22-18.1	Dorothy Stevens Revocable Trust
22-21	Paul Baker
22-22	Paul Baker
22-23	Anthony Parr
22-23.1	Raymond Parr
22-23.2	Anthony Parr
22-24	Ruth Weekley Est.
22-25	Paul Baker
22-26	John Sole
22-27	Carol Knapp Revocable Trust
22-28	WSD Properties LLC
22-29	WSD Properties LLC
22-30	WSD Properties LLC
22-31	Richard Gradslly Et Al
22-32	Richard Gradslly Et Al
22-33	Wilma Weekley
22-34	Raymond Parr Et Al
22-38	Bruce Parr
22-40	Ronald Webb

JOB # 21-006WA
 DRAWING # PARR1HAD
 SCALE 1" = 2000'
 MINIMUM DEGREE OF ACCURACY SUBMETER
 PROVEN SOURCE OF ELEV. SUBMETER MAPPING GRADE GPS

LEGEND
 - - - Surface Owner Boundary Lines +/-
 - - - Interior Surface Tracts +/-
 ○ Proposed Well Path
 ⊗ As Drilled Well Path

Thomas Summers
 THOMAS SUMMERS P.S. 2109

STATE OF WEST VIRGINIA DEPARTMENT OF ENERGY DIVISION OF OIL AND GAS

DATE 04/07/22
 OPERATOR'S WELL# PARR UNIT #1H

WELL 1H POINT OF ENTRY INFORMATION:
 WV STATE PLANE NAD '27 (NORTH ZONE):
 N: 373,015ft E: 1,624,062ft
GEOGRAPHIC (NAD) 27:
 LAT: 39°30'59.36" LON: 80°49'57.35"
(NAD) 83 (UTM) ZONE 17 COORDS:
 N: 4,374,117m E: 514,405m

NOTES
 1. NO OCCUPIED DWELLINGS OR BUILDINGS TWO THOUSAND FIVE HUNDRED (2,500) SQUARE FEET OR LARGER USED TO HOUSE OR SHELTER DAIRY CATTLE OR POULTRY/HUSBANDRY ARE LOCATED WITHIN SIX HUNDRED TWENTY-FIVE (625) FEET OF THE CENTER OF THE WELL PAD.
 2. TOP HOLE DATA SHOWN HEREON WAS PROVIDED BY ANTERO RESOURCES CORPORATION.
 3. AS DRILLED DATA WAS PROVIDED BY ANTERO RESOURCES CORPORATION.
 4. WLS IS NOT CERTIFYING THE DATA AND INFORMATION PROVIDED LISTED IN NOTES 2 AND 3, ONLY THE RELATIONSHIP TO THE DATA AND INFORMATION PROVIDED TO THE LEASE BOUNDARIES.
 5. WLS IS BY NO MEANS RESPONSIBLE FOR ANY ERRORS OR INACCURACIES WITH THE DATA AND INFORMATION THAT HAS BEEN PROVIDED.

WELL TYPE: OIL ___ GAS X LIQUID INJECTION ___ WASTE DISPOSAL ___ API WELL # 47 - 095 - 02746
 (IF "GAS") PRODUCTION X STORAGE ___ DEEP ___ SHALLOW X STATE COUNTY PERMIT
 LOCATION: ELEVATION AS BUILT - 1,040' WATERSHED OUTLET MIDDLE ISLAND CREEK
 QUADRANGLE PORTER FALLS 7.5' DISTRICT ELLSWORTH COUNTY TYLER
 SURFACE OWNER KAYLA LEEK ACREAGE 69.06 ACRES +/-
 OIL & GAS ROYALTY OWNER RIDGETOP CAPITAL LP; DAVID LEEK; BRC APPALACHIAN MINERALS I LLC; LEASE ACREAGE 69.06 AC.±; 34.38 AC.±; 373.47 AC.±;
 JAMES F. DOAN ET UX; RICHARD D. PYLES ET UX; TARYN E. PILLING; KAY F. HAIN REVOCABLE LIVING TRUST; 692.78 AC.±; 47.17 AC.±; 15.6 AC.±; 37 AC.±;
 CLARENCE W. MUTSCHELKNAUS SR. ET AL; GREENBRIER ROYALTY FUND II, LLC; PAUL RICHARD BAKER 80 AC.±; 134.75 AC.±; 4.125 AC.±; 06/02/2023
 PAUL RICHARD BAKER; HERITAGE RESOURCES-MARCELLUS MINERALS S.LLC; JUDITH REMLEY PHIPPS; ANTHONY B. PARR; NANCY L. MAINS 6.38 AC.±; 9 AC.±; 9 AC.±; 17 AC.±; 226.96 AC.±;
 PROPOSED WORK: DRILL ___ CONVERT ___ DRILL DEEPER ___ REDRILL ___ FRACTURE OR STIMULATE ___
 PLUG OFF OLD FORMATION ___ PERFORATE NEW FORMATION ___ OTHER PHYSICAL CHANGE IN WELL
 (SPECIFY) AS DRILLED PLUG & ABANDON CLEAN OUT & REPLUG
 TARGET FORMATION MARCELLUS ESTIMATED DEPTH 6,645' TVD 22,323' MD
 WELL OPERATOR ANTERO RESOURCES CORP. DESIGNATED AGENT DIANNA STAMPER - CT CORPORATION SYSTEM
 ADDRESS 1615 WYNKOOP ST. ADDRESS 5400 D BIG TYLER ROAD
 FORM WW-6 DENVER, CO 80202 CHARLESTON, WV 25313

COUNTY PERMIT

LATITUDE 39°32'30"

10,574'

LATITUDE 39°30'00"

6,650' TO BOTTOM HOLE

Antero Resources Corporation Well No. Parr Unit 1H

AS DRILLED DATA:

WELL 1H TOP HOLE INFORMATION:
 N: 373,437ft E: 1,625,041ft
 LAT: 39°31'03.67" N LON: 80°49'44.93"
BOTTOM HOLE INFORMATION:
 N: 358,381ft E: 1,628,749ft
 LAT: 39°28'35.42" N LON: 80°48'54.80"
 WEST VIRGINIA COORDINATE SYSTEM OF 1927 NORTH ZONE. ZONE WAS DERIVED FROM MEASUREMENTS TAKEN WITH TRIMBLE GEOXT SUBMETER MAPPING GRADE GPS UNIT. PLAT ORIENTATION, CORNER, AND WELL REFERENCE TIE LINES ARE BASED ON GRID NORTH.

(NAD) 83 (UTM) ZONE 17 COORDS:
WELL 1H TOP HOLE INFORMATION:
 N: 4,374,250m E: 514,701m
BOTTOM HOLE INFORMATION:
 N: 4,369,682m E: 515,907m

PAD LAYOUT NOT TO SCALE

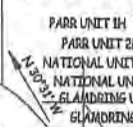

1H TOP HOLE

22-16.3	Charles Stevens
22-17	Dorothy Stevens Revocable Trust
22-18	Clara Baker
22-18.1	Dorothy Stevens Revocable Trust
22-21	Paul Baker
22-22	Paul Baker
22-23	Anthony Parr
22-23.1	Raymond Parr
22-23.2	Anthony Parr
22-24	Ruth Weekley Est.
22-25	Paul Baker
22-26	John Sale
22-27	Carol Knapp Revocable Trust
22-28	WSD Properties LLC
22-29	WSD Properties LLC
22-30	WSD Properties LLC
22-31	Richard Grodsky Et Al
22-32	Richard Grodsky Et Al
22-33	Wilma Weekley
22-34	Raymond Parr Et Al
22-38	Bruce Parr
22-40	Ronald Webb

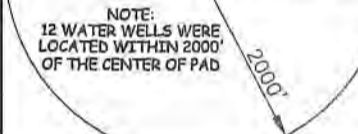

NOTE:
12 WATER WELLS WERE LOCATED WITHIN 2000' OF THE CENTER OF PAD

LINE	BEARING	DIST.	LINE	BEARING	DIST.
L1	N 79°23' W	1820.64'	L7	N 17°11' W	1289.39'
L2	N 72°38' W	1737.73'	L8	N 14°44' W	1409.38'
L3	N 69°39' W	1680.54'	L9	N 07°35' W	1774.82'
L4	N 45°05' W	1540.95'	L10	N 03°37' W	1761.12'
L5	N 36°53' W	1627.55'	L11	N 17°55' E	1113.36'
L6	N 30°40' W	1612.05'	L12	N 48°24' E	1322.09'

I, THE UNDERSIGNED, HEREBY CERTIFY THAT THIS PLAT IS CORRECT TO THE BEST OF MY KNOWLEDGE AND BELIEF AND SHOWS ALL THE INFORMATION REQUIRED BY LAW AND THE RULES ISSUED AND PERSCRIBED BY THE DEPARTMENT OF ENVIRONMENTAL PROTECTION.



STATE OF WEST VIRGINIA, DIVISION OF ENVIRONMENTAL PROTECTION, OFFICE OF OIL AND GAS
 WILLOW LAND SURVEYING PLLC
 220 MASONIC AVE. PENNSBORO WEST VIRGINIA 26415

JOB # 21-006WA
 DRAWING # PARR1HAD
 SCALE 1" = 2000'
 MINIMUM DEGREE OF ACCURACY SUBMETER
 PROVEN SOURCE OF ELEV. SUBMETER MAPPING GRADE GPS

LEGEND
 - - - Surface Owner Boundary Lines +/-
 - - - Interior Surface Tracts +/-
 ⊗ Proposed Well Path
 ⊗ As Drilled Well Path

Thomas Summers
 THOMAS SUMMERS P.S. 2109

STATE OF WEST VIRGINIA DEPARTMENT OF ENERGY DIVISION OF OIL AND GAS

DATE 04/07/22
 OPERATOR'S WELL# PARR UNIT #1H

WELL 1H POINT OF ENTRY INFORMATION:
 WV STATE PLANE NAD '27 (NORTH ZONE):
 N: 373,015ft E: 1,624,062ft
GEOGRAPHIC (NAD) 27:
 LAT: 39°30'59.36" N LON: 80°49'57.35"
(NAD) 83 (UTM) ZONE 17 COORDS:
 N: 4,374,117m E: 514,405m

Ellsworth District - Tyler County	
11-51	Bear Knob Holdings LLC
16-5	David Leek
16-5.1	Richard Ferrell
16-6	Kayla Leek
16-7	John Thomas
16-7.1	Lianne Wilson
16-8	Jean Neel Et Al
16-9	Bear Knob Holdings LLC
16-10	Jean Neel Et Al
16-11	Jean Neel Et Al
16-15	Harvey Miller Et Al
16-16	Harvey Miller Et Al
16-16.1	Barbara Kittle
16-17	Alfred Steele
16-18	Alfred Steele
16-19	Jean Neel Et Al
16-20	Jean Neel Et Al
16-21	Kayla Leek
16-24	James Eastham
16-25	Nancy Fowler
16-26	Barbara Kittle
16-27	Gilbert Eddy
16-28	Kenneth Tamblin Et Al
16-36	George Karabetis
16-37	Rosella Murner
16-38	EQT Production Company
16-39	Richard Pyles
16-39.1	Lea Wiker
16-40	Gary Weekley
16-42	Richard Pyles
16-42.3	Richard Pyles
16-58	American Energy Marcellus Minerals LLC
22-6	EQT Production Company
22-7	Kenneth Baker
22-8	EQT Production Company
22-9	Steven Wright
22-10	Leslie Henderson
22-13	Debra Blake
22-14	Leslie Weekley
22-15	Lonnie Wade Et Al
22-16	Darlene Stephens
22-16.1	Joann McSwegin
22-16.2	Sarah Bassett

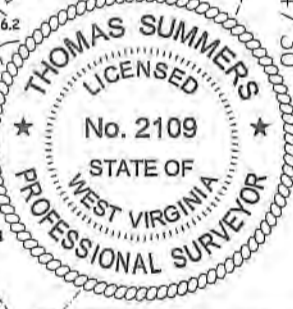

NOTES
 1. NO OCCUPIED DWELLINGS OR BUILDINGS TWO THOUSAND FIVE HUNDRED (2,500) SQUARE FEET OR LARGER USED TO HOUSE OR SHELTER DAIRY CATTLE OR POULTRY HUSBANDRY ARE LOCATED WITHIN SIX HUNDRED TWENTY-FIVE (625) FEET OF THE CENTER OF THE WELL PAD.
 2. TOP HOLE DATA SHOWN HEREON WAS PROVIDED BY ANTERO RESOURCES CORPORATION.
 3. AS DRILLED DATA WAS PROVIDED BY ANTERO RESOURCES CORPORATION.
 4. WLS IS NOT CERTIFYING THE DATA AND INFORMATION PROVIDED LISTED IN NOTES 2 AND 3. ONLY THE RELATIONSHIP TO THE DATA AND INFORMATION PROVIDED TO THE LEASE BOUNDARIES.
 5. WLS IS BY NO MEANS RESPONSIBLE FOR ANY ERRORS OR INACCURACIES WITH THE DATA AND INFORMATION THAT HAS BEEN PROVIDED.

WELL TYPE: OIL ___ GAS X LIQUID INJECTION ___ WASTE DISPOSAL ___ API WELL # 47 - 095 - 02746
 (IF "GAS") PRODUCTION X STORAGE ___ DEEP ___ SHALLOW X STATE COUNTY PERMIT
 LOCATION: ELEVATION AS BUILT - 1,040' WATERSHED OUTLET MIDDLE ISLAND CREEK
 QUADRANGLE PORTER FALLS 7.5' DISTRICT ELLSWORTH COUNTY TYLER
 SURFACE OWNER KAYLA LEEK ACREAGE 69.06 ACRES +/-
 OIL & GAS ROYALTY OWNER RIDGETOP CAPITAL LP; DAVID LEEK; BRC APPALACHIAN MINERALS I LLC; LEASE ACREAGE 69.06 AC.±; 34.38 AC.±; 373.47 AC.±;
 JAMES F. DOAN ET UX; RICHARD D. PYLES ET UX; TARYN E. PILLING; KAY F. HAIN REVOCABLE LIVING TRUST; 692.78 AC.±; 47.17 AC.±; 15.6 AC.±; 37 AC.±;
 CLARENCE W. MUTSCHELKNAUS SR. ET AL; GREENBRIER ROYALTY FUND II, LLC; PAUL RICHARD BAKER 80 AC.±; 134.75 AC.±; 4.125 AC.±; 06/02/2023
 PAUL RICHARD BAKER; HERITAGE RESOURCES-MARCELLUS MINERALS S.L.C.; JUDITH REMLEY PHIPPS; ANTHONY B. PARR; NANCY L. MAINS 6.38 AC.±; 9 AC.±; 9 AC.±; 17 AC.±; 226.96 AC.±;
 PROPOSED WORK: DRILL ___ CONVERT ___ DRILL DEEPER ___ REDRILL ___ FRACTURE OR STIMULATE ___
 PLUG OFF OLD FORMATION ___ PERFORATE NEW FORMATION ___ OTHER PHYSICAL CHANGE IN WELL
 (SPECIFY) AS DRILLED ___ PLUG & ABANDON ___ CLEAN OUT & REPLUG ___
 TARGET FORMATION MARCELLUS ESTIMATED DEPTH 6,645' TVD 22,323' MD
 WELL OPERATOR ANTERO RESOURCES CORP. DESIGNATED AGENT DIANNA STAMPER - CT CORPORATION SYSTEM
 ADDRESS 1815 WYNKOOP ST. ADDRESS 5400 D BIG TYLER ROAD
 FORM WW-6 DENVER, CO 80202 CHARLESTON, WV 25313

8,734'
 8,558' TO BOTTOM HOLE
 LONGITUDE 80°47'30"