

LATITUDE 39°32'30"

10,574'

LATITUDE 39°30'00"

9,078' TO BOTTOM HOLE

### Antero Resources Corporation Well No. Parr Unit 1H

**NOTES:**  
 WELL 1H TOP HOLE INFORMATION:  
 N: 373,437ft E: 1,625,041ft  
 LAT: 39°31'03.67" LON: 80°49'44.93"  
 BOTTOM HOLE INFORMATION:  
 N: 365,489ft E: 1,626,423ft  
 LAT: 39°29'45.33" LON: 80°49'25.80"  
 WEST VIRGINIA COORDINATE SYSTEM OF 1927 NORTH ZONE. ZONE WAS DERIVED FROM MEASUREMENTS TAKEN WITH TRIMBLE 660XT SUBMETER MAPPING GRADE GPS UNIT. PLAT ORIENTATION, CORNER, AND WELL REFERENCE TIE LINES ARE BASED ON GRID NORTH.

(NAD) 83 (UTM) ZONE 17 COORDS:  
 WELL 1H TOP HOLE INFORMATION:  
 N: 4,374,250m E: 514,701m  
 BOTTOM HOLE INFORMATION:  
 N: 4,371,836m E: 515,162m

#### PAD LAYOUT NOT TO SCALE

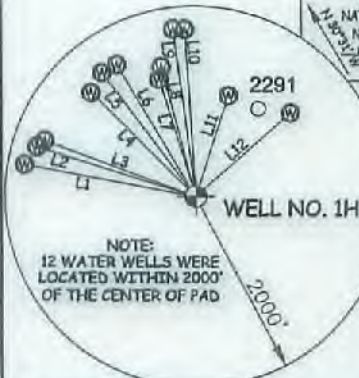
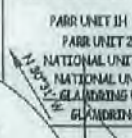

**NOTE:**  
 12 WATER WELLS WERE LOCATED WITHIN 2000' OF THE CENTER OF PAD

22-16.3	Charles Stevens
22-17	Dorothy Stevens Revocable Trust
22-18	Clara Baker
22-16.1	Dorothy Stevens Revocable Trust
22-21	Paul Baker
22-22	Paul Baker
22-23	Anthony Parr
22-23.1	Raymond Parr
22-23.2	Anthony Parr
22-24	Ruth Weekley Est.
22-25	Paul Baker
22-26	John Sole
22-27	Carol Knapp Revocable Trust
22-28	WSD Properties LLC
22-29	WSD Properties LLC
22-30	Wsb Properties LLC
22-31	Richard Grodzky Et Al
22-32	Richard Grodzky Et Al
22-33	Wilma Weekley
22-34	Raymond Parr Et Al
22-38	Bruce Parr
22-40	Renold Webb

LINE BEARING	DIST.	LINE BEARING	DIST.
L1 N 79°23' W	1820.64' L7	N 17°11' W	1289.39'
L2 N 72°38' W	1737.73' L8	N 14°44' W	1409.38'
L3 N 69°39' W	1680.54' L9	N 07°35' W	1774.82'
L4 N 46°08' W	1840.95' L10	N 03°37' W	1761.12'
L5 N 36°53' W	1627.25' L11	N 17°55' E	1113.36'
L6 N 30°40' W	1612.05' L12	N 48°24' E	1322.09'

I THE UNDERSIGNED, HEREBY CERTIFY THAT THIS PLAT IS CORRECT TO THE BEST OF MY KNOWLEDGE AND BELIEF AND SHOWS ALL THE INFORMATION REQUIRED BY LAW AND THE RULES ISSUED AND PERSCRIBED BY THE DEPARTMENT OF ENVIRONMENTAL PROTECTION.



STATE OF WEST VIRGINIA, DIVISION OF ENVIRONMENTAL PROTECTION, OFFICE OF OIL AND GAS

WILLOW LAND SURVEYING PLLC  
 220 MASONIC AVE. PENNSBORO  
 WEST VIRGINIA 26415

Ellsworth District - Tyler County	
11-51	Bear Knob Holdings LLC
16-5	David Leek
16-5.1	Richard Ferrell
16-6	Kayla Leek
16-7	John Thomas
16-7.1	Lionne Wilson
16-8	Jean Neal Et Al
16-9	Bear Knob Holdings LLC
16-10	Jean Neal Et Al
16-11	Jean Neal Et Al
16-15	Harvey Miller Et Al
16-16	Harvey Miller Et Al
16-16.1	Barbara Kittle
16-17	Alfred Steele
16-18	Alfred Steele
16-19	Jean Neal Et Al
16-20	Jean Neal Et Al
16-21	Kayla Leek
16-24	James Earham
16-25	Nancy Fowler
16-26	Barbara Kittle
16-27	Gilbert Eddy
16-28	Kenneth Tamblin Et Al
16-36	George Karobette
16-37	Russella Murner
16-38	EQT Production Company
16-39	Richard Pyles
16-39.1	Leo Wikar
16-40	Gary Weekley
16-42	Richard Pyles
16-42.3	Richard Pyles
16-58	American Energy Minerals LLC
22-6	EQT Production Company
22-7	Kenneth Baker
22-8	EQT Production Company
22-9	Steven Wright
22-10	Leslie Henderson
22-13	Debra Biale
22-14	Leslie Weekley
22-15	Lennie Wade Et Al
22-16	Dorlene Stephens
22-16.1	Joann McSwain
22-16.2	Sarah Bassett

**NOTE:**  
 NO OCCUPIED DWELLINGS OR BUILDINGS TWO THOUSAND FIVE HUNDRED (2,500) SQUARE FEET OR LARGER USED TO HOUSE OR SHELTER DAIRY CATTLE OR POULTRY. HUSBANDRY ARE LOCATED WITHIN SIX HUNDRED TWENTY-FIVE (625) FEET OF THE CENTER OF THE WELL PAD.

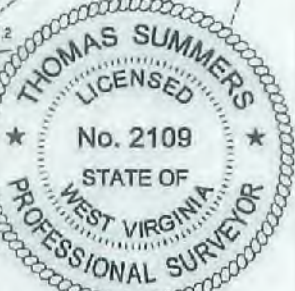

JOB # 21-006WA  
 DRAWING # PARR1H  
 SCALE 1" = 2000'  
 MINIMUM DEGREE OF ACCURACY SUBMETER  
 PROVEN SOURCE OF ELEV. SUBMETER MAPPING GRADE GPS

**LEGEND**  
 - - - Surface Owner Boundary Lines +/-  
 - - - Adjoining Surface Tracts +/-  
 ⊕ Found monument, as noted

*Thomas Summers*  
 THOMAS SUMMERS P.S. 2109

(NAD) 27 (UTM) ZONE 17 COORDS:  
 WELL 1H TOP HOLE INFORMATION:  
 N: 14,350,471ft E: 1,685,600ft  
 POINT OF ENTRY INFORMATION:  
 N: 14,350,076ft E: 1,687,625ft  
 BOTTOM HOLE INFORMATION:  
 N: 14,342,550ft E: 1,690,114ft



STATE OF WEST VIRGINIA  
 DEPARTMENT OF ENERGY  
 DIVISION OF OIL AND GAS

DATE 06/09/21  
 OPERATOR'S WELL# PARR UNIT#1H

WELL TYPE: OIL \_\_\_ GAS X LIQUID INJECTION \_\_\_ WASTE DISPOSAL \_\_\_ API WELL # 47 - 095 - 02746  
 (IF "GAS") PRODUCTION X STORAGE \_\_\_ DEEP \_\_\_ SHALLOW X STATE COUNTY PERMIT  
 LOCATION: ELEVATION AS BUILT - 1,041' WATERSHED OUTLET MIDDLE ISLAND CREEK

QUADRANGLE PORTER FALLS 7.5' DISTRICT ELLSWORTH COUNTY TYLER

SURFACE OWNER KAYLA LEEK ACREAGE 69.06 ACRES +/-  
 OIL & GAS ROYALTY OWNER RIDGETOP CAPITAL LP: DAVID LEEK; LEASE ACREAGE 69.06 AC +/- 34.38 AC +/-  
 BRC APPALACHIAN MINERALS I LLC; JAMES F. DOAN ET UX; RICHARD D. PYLES ET UX; 373.47 AC +/- 692.78 AC +/- 47.17 AC +/-  
 TARYN E. PILLING 15.6 AC +/-

PROPOSED WORK: DRILL X CONVERT \_\_\_ DRILL DEEPER \_\_\_ REDRILL \_\_\_ FRACTURE OR STIMULATE X  
 PLUG OFF OLD FORMATION \_\_\_ PERFORATE NEW FORMATION \_\_\_ OTHER PHYSICAL CHANGE IN WELL  
 (SPECIFY) \_\_\_ PLUG & ABANDON CLEAN OUT & REPLUG

TARGET FORMATION MARCELLUS ESTIMATED DEPTH 7,100' TVD 16,900' MD  
 WELL OPERATOR ANTERO RESOURCES CORP. DESIGNATED AGENT DIANNA STAMPER - CT CORPORATION SYSTEM  
 ADDRESS 1815 WYNKOOP ST. ADDRESS 5400 D BIG TYLER ROAD  
 FORM WW-6 DENVER, CO 80202 CHARLESTON, WV 25313

1,485' TO BOTTOM HOLE

LONGITUDE 80°47'30"

COUNTY NAME PERMIT

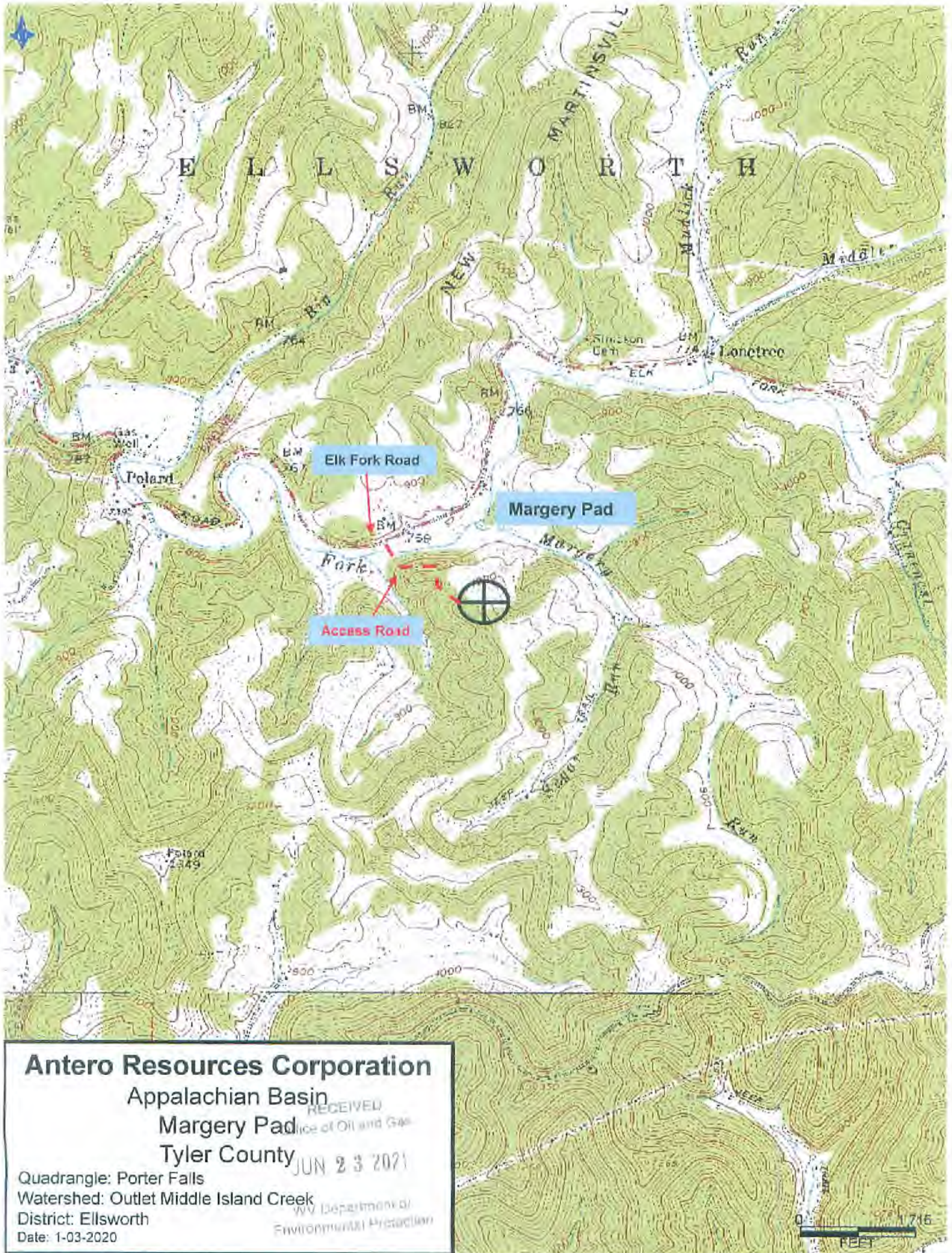

**Antero Resources Corporation**  
 Appalachian Basin  
 Margery Pad  
 Tyler County

RECEIVED  
 Office of Oil and Gas  
 JUN 23 2021  
 WV Department of  
 Environmental Protection

Quadrangle: Porter Falls  
 Watershed: Outlet Middle Island Creek  
 District: Ellsworth  
 Date: 1-03-2020

0 1715  
 FEET