

Antero Resources
Well No. Jed 1H
As-Drilled
 Antero Resources Corporation



Top Hole Coordinates, As-drilled data, and information was provided by Antero Resources Corporation. Allegheny Surveys Inc. (ASI) is not certifying the data and information provided. ASI is not responsible for any errors or inaccuracies with the data and information that has been provided.

I, the undersigned, hereby certify that this plat is correct to the best of my knowledge and belief and shows all the information required by law and the rules issued and prescribed by the Department of Environmental Protection.

Bradley D. Miller
 Bradley D. Miller, P.S. 2167

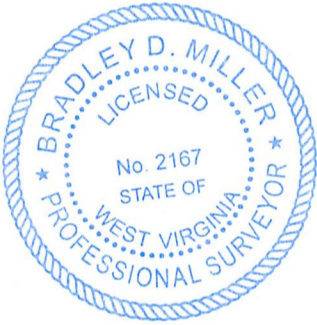

Note: 1 water well and 1 spring were found within 2000' of proposed well. No occupied dwellings or buildings 2,500 square feet or larger used to house or shelter dairy cattle or poultry husbandry are located within 625' of the center of the well pad.

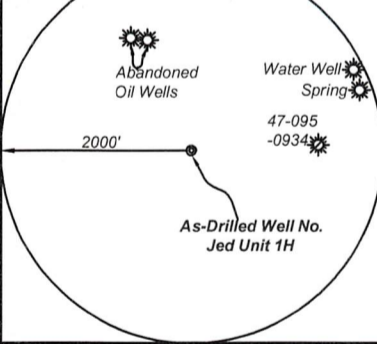

	Bearing	Dist.
L1	N 68°16' E	810.9'
L2	N 81°50' E	1,865.1'
L3	S 73°16' W	1,340.5'
L4	N 25°18' W	1,603.0'

- Legend**
- Proposed gas well
 - Monument, as noted
 - Existing Well, as noted
 - Digitized Well, as noted
 - Creek or Drain
 - Road
 - Surface boundary (approx.)
 - Interior surface tracts (approx.)

10,776' to Top Hole

7,135' to Bottom Hole

TOP HOLE LATITUDE 39 - 35 - 00
 BTM HOLE LATITUDE 39 - 32 - 30

Notes
 West Virginia Coordinate System of 1927, North Zone based upon Differential GPS Measurements.
 Well No. Jed Unit 1H Top Hole coordinates are
 N: 383,726.78' Latitude: 39°32'39.96"
 E: 1,589,732.35' Longitude: 80°57'17.56"
 Bottom Hole coordinates are
 N: 369,216.66' Latitude: 39°30'17.11"
 E: 1,593,144.86' Longitude: 80°56'31.03"
 UTM Zone 17, NAD 1983
 Top Hole Coordinates Bottom Hole Coordinates
 N: 4,377,205.222m N: 4,372,802.003m
 E: 503,891.760m E: 505,005.085m
 Plat orientation and corner and well references are based upon the grid north meridian.
 Well location references are based upon the magnetic meridian.

Jed Unit 1H As-Drilled POE Coordinates
 West Virginia Coordinate System of 1927, North Zone
 N: 383,384.69'
 E: 1,588,594.12'
 Latitude: 39°32'36.40"
 Longitude: 80°57'32.02"
 UTM Zone 17, NAD 1983
 N: 4,377,095.203m
 E: 503,546.731m

Wellhead Layout (NTS)

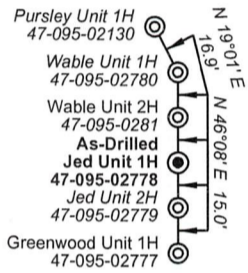

LONGITUDE 80 - 55 - 00

13,446' to Bottom Hole

14,169' to Top Hole

STATE OF WEST VIRGINIA
 DEPARTMENT OF ENVIRONMENTAL PROTECTION
OIL AND GAS DIVISION

FILE NO: 34-54-L-17
 DRAWING NO: Jed Unit 1H As-Drilled
 SCALE: 1" = 2000'
 MINIMUM DEGREE OF ACCURACY: Submeter
 PROVEN SOURCE OF ELEVATION: WVDOT, Harrisville, WV

DATE: December 6 2022
 OPERATOR'S WELL NO. Jed Unit 1H
 API WELL NO
 47 - 095 - 02778
 STATE COUNTY PERMIT

WELL TYPE: OIL GAS LIQUID INJECTION WASTE DISPOSAL
 (IF GAS) PRODUCTION: STORAGE DEEP SHALLOW

LOCATION: ELEVATION: As-Built 971.8' WATERSHED: Middle Island Creek QUADRANGLE: Paden City 48.1; 80; 53.7; 0.922;
 DISTRICT: Lincoln Robert D. & Ridgetop Capital, LP (2); Central Trinity Methodist Church; COUNTY: Tyler 0.85; 140.0; 49.146;
 SURFACE OWNER: Virginia A. Nalley Leslie R. Tennant; Debra Lynn Warner; BRC Appalachian Minerals I, LLC (2); 3.16563; 6.444; 2.44;
 ROYALTY OWNER: Robert D. Nalley, et ux (3); Thomas D. Butterfield, et ux; Michael A. Mars, et ux; Donald L. George, et ux; Stacey Lynn Carney, et vir; Matthew Goodfellow; ACREAGE: 80.00 71.99; 69.15; 50.0;
 PROPOSED WORK: DRILL CONVERT DRILL DEEPER FRACTURE OR STIMULATE PLUG OFF OLD FORMATION 17.0; 3.33; 205.862;
 PERFORATE NEW FORMATION OTHER PHYSICAL CHANGE IN WELL (SPECIFY) As-Drilled LEASE NO: ACREAGE: 71.93152;25; 127.39
 PLUG AND ABANDON CLEAN OUT AND REPLUG TARGET FORMATION: Marcellus Shale ESTIMATED DEPTH: 21,383' MD 6,255' TVD

WELL OPERATOR: Antero Resources Corporation DESIGNATED AGENT: Kevin Ellis
 ADDRESS: 1615 Wynkoop Street ADDRESS: 535 White Oaks Blvd.
 Denver, CO 80202 Bridgeport, WV 26330

SM

Antero Resources
Well No. Jed 1H
As-Drilled
 Antero Resources Corporation

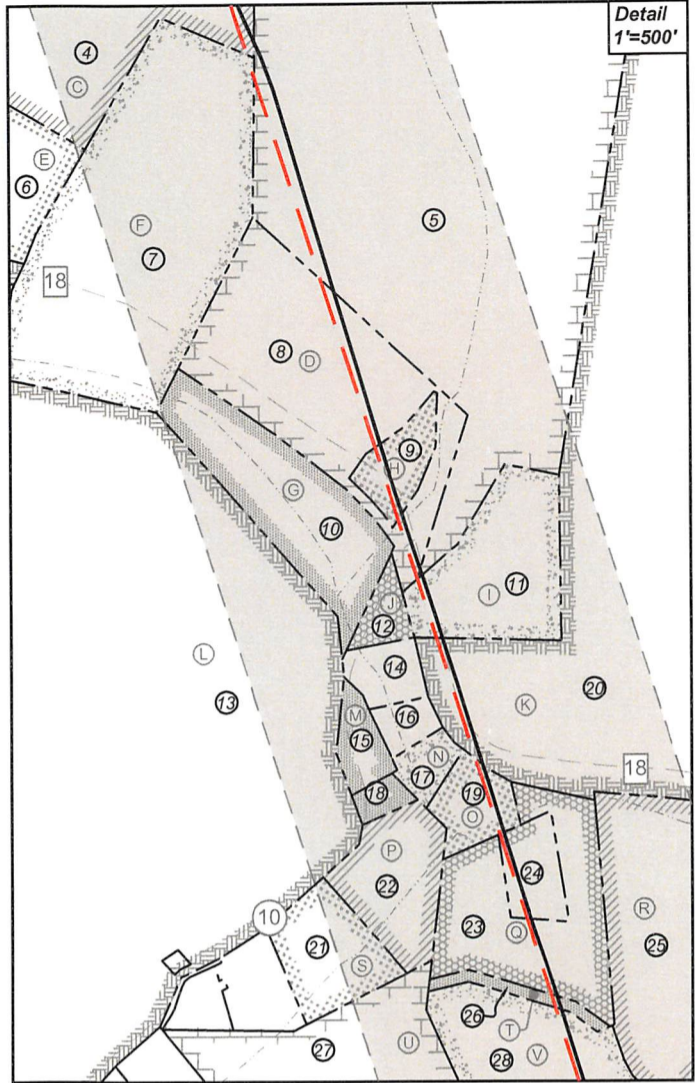

ID	TM/Par	Owner	Bk/Pg	Acres
1	8-54	Robert D. & Virginia A. Nalley	198/41	80.00
2	8-38.3	Joann & Howard L. Schubach Jr.	467/383	21.17
3	8-38.5	Donald D. & Alice J. Haught	300/583	21.17
4	8-53	Robert D. & Virginia A. Nalley	200/53	48.10
5	12-13	Robert D. & Virginia A. Nalley	183/452	38.75
6	12-11	Kenneth R. & Mary Joanne Hunt	231/387	3.00
7	12-12	George & Mary Jo Miller	195/44	9.33
8	12-14	Robert D. Nalley	393/662	7.35
9	12-14.1	Robert D. & Virginia Nalley	424/382	0.85
10	12-28	Warren C. & Erica N. Conklin	400/261	3.75
11	12-15	Pursley Cemetery	97/2	3.16
12	12A-1	Donald B. & Barbara S. Stokes	270/372	0.43
13	12-27	William P. & Jo Anne Ingram	156/175	183.16
14	12A-2	Church of Christ	85/552	0.66
15	12A-4	Eric J. Fletcher	666/526	0.44
16	12A-3	Pursley Church of Christ	358/83	0.42
17	12A-5	Stephen M. Johnson	AR51/1229	0.68
18	12A-6	Eric J. Fletcher	666/526	0.29
19	12A-7	Michael A. & Cheryl A. Mars	619/130	0.83
20	12-16	Harry Huff	230/546	45.11
21	12-32.1	Kay K. & Donald L. Steward	311/676	1.66
22	12-32	David R. & Nancy J. Goodfellow	311/618	1.94
23	12-34	Ronald L. & Donna L. George	372/167	5.13
24	12-33	Ronald L. & Donna L. George	372/167	0.85
25	12-35	Dale E. Berisford	307/443	9.21
26	12-34.1	Stacey Lynn Carney, et al	W53/701	0.90
27	12-38	Dena Grimes	W35/150	9.64
28	12-39	Stacey Carney, et al	W53/701	71.99
29	12-53.4	Walter J. West	359/817	52.95
30	12-52	Leslie Ray Tennant	382/603	69.15
31	12-51	Rickie Lee Littleton	281/193	61.23
32	12-61	Melinda A. King	568/757	17.00
33	12-62	Leslie Ray Tennant, et al	282/305	50.00
34	12-63	Melinda A. King	568/757	8.66
35	12-64	Ridgetop Capital, LP	375/206	3.33
36	12-65	GR Meckley Family Trust	OR50/28	0.50
37	12-67	Leslie R. Tennant, et al	283/574	54.07
38	12-66	Eugene W. & Leah M. Gilmore	286/7	25.00
39	15-9	Ridgetop Capital, LP	375/206	120.00
40	15-20	James L. & Martha Jo Stewart	330/936	76.10
41	15-13	B. F., Ben H. & Ida M. Kile	174/412	140.00
42	13-1	James L. & Martha Jo Stewart	330/931	194.04
43	15-16	Mary Ann Devine, et al	W36/282	81.67
44	15-17	Earl & Donna Smith	191/12	127.39
45	13-3.5	Lisa M. Beane	406/668	17.64

Leases			
A	Robert D. Nalley, et ux	S	Donald L. Steward, et ux
B	Robert L. Keller	T	Stacey Lynn Carney, et vir
C	Robert D. Nalley, et ux	U	Dena Raye Grimes
D	Robert D. Nalley, et ux	V	Matthew Goodfellow
E	Kenneth R. Hunt	W	Walter J. West
F	George E. Miller, et ux	X	Leslie R. Tennant
G	Warren C. Conklin, et ux	Y	Larry Folger, et ux
H	Thomas D. Butterfield, et ux	Z	BRC Appalachian Minerals I, LLC
I	Pursley Cemetery	AA	BRC Appalachian Minerals I, LLC
J	Donald B. & Barbara S. Stokes	AB	BRC Appalachian Minerals I, LLC
K	Harry H. Huff, et ux	AC	Gerald Meckley
L	William P. Ingram	AD	Ridgetop Capital, LP
M	Kimberly Wilcox	AE	Central Trinity Methodist Church
N	Stephen M. Johnson	AF	Ridgetop Capital, LP
O	Michael A. Mars, et ux	AG	Donald H. Lancaster, Jr.
P	Lisa J. York	AH	Debra Lynn Warner
Q	Ronald L. George et ux	AI	Donna Smith
R	Dale E. Berisford		

FILE NO: 34-54-L-17
 DRAWING NO: Jed Unit 1H As-Drilled
 SCALE: 1" = 2000'
 MINIMUM DEGREE OF ACCURACY:
 Submeter
 PROVEN SOURCE OF ELEVATION:
 WVDOT, Harrisville, WV

STATE OF WEST VIRGINIA
 DEPARTMENT OF ENVIRONMENTAL PROTECTION
OIL AND GAS DIVISION



DATE: December 6 20 22
 OPERATOR'S WELL NO. Jed Unit 1H
 API WELL NO
 47 - 095 - 02778
 STATE COUNTY PERMIT

WELL TYPE: OIL GAS LIQUID INJECTION WASTE DISPOSAL
 (IF GAS) PRODUCTION: STORAGE DEEP SHALLOW
 LOCATION: ELEVATION: As-Built 971.8' WATERSHED: Middle Island Creek QUADRANGLE: Paden City 48.1;
 DISTRICT: Lincoln Robert D. & Ridgetop Capital, LP (2); Central Trinity Methodist Church; 80; 53.7; 0.922;
 SURFACE OWNER: Virginia A. Nalley Leslie R. Tennant; Debra Lynn Warner; BRC Appalachian Minerals I, LLC (2); 0.85; 140.0; 49.146;
 ROYALTY OWNER: Robert D. Nalley, et ux (3); Thomas D. Butterfield, et ux; Michael A. Mars, et ux; Donald H. Lancaster, Jr.; Harry H. Huff, et ux; Pursley Cemetery; Donna Smith; 3.16563; 6.444; 2.44;
 PROPOSED WORK: DRILL CONVERT DRILL DEEPER FRACTURE OR STIMULATE PLUG OFF OLD FORMATION
 PERFORATE NEW FORMATION OTHER PHYSICAL CHANGE IN WELL (SPECIFY) As-Drilled
 PLUG AND ABANDON CLEAN OUT AND REPLUG TARGET FORMATION: Marcellus Shale ESTIMATED DEPTH: 21,383' MD 6,255' TVD

WELL OPERATOR: Antero Resources Corporation DESIGNATED AGENT: Kevin Ellis
 ADDRESS: 1615 Wynkoop Street ADDRESS: 535 White Oaks Blvd.
 Denver, CO 80202 Bridgeport, WV 26330