

LATITUDE 39°32'30"

9133'

LATITUDE 39°35'00"

10,855'

Antero Resources Corporation
Well No. Emmons Unit 1H

AS DRILLED DATA:
WELL 1H TOP HOLE INFORMATION:
N: 377,188ft E: 1,638,290ft
LAT: 39°31'42.65" LON: 80°46'56.57"
BOTTOM HOLE INFORMATION:
N: 387,848ft E: 1,636,716ft
LAT: 39°33'27.78" LON: 80°47'18.60"
WEST VIRGINIA COORDINATE SYSTEM OF 1927 NORTH ZONE. ZONE WAS DERIVED FROM MEASUREMENTS TAKEN WITH TRIMBLE GEOXT SUBMETER MAPPING GRADE GPS UNIT. PLAT ORIENTATION, CORNER, AND WELL REFERENCE TIE LINES ARE BASED ON GRID NORTH.

(NAD) 83 (UTM) ZONE 17 COORDS:
WELL 1H TOP HOLE INFORMATION:
N: 4,375,460m E: 518,718m
BOTTOM HOLE INFORMATION:
N: 4,378,700m E: 518,185m

(NAD) 27 (UTM) ZONE 17 COORDS:
WELL 1H TOP HOLE INFORMATION:
N: 14,354,441ft E: 1,701,780ft
POINT OF ENTRY INFORMATION:
N: 14,355,096ft E: 1,703,441ft
BOTTOM HOLE INFORMATION:
N: 14,365,071ft E: 1,700,030ft

WV NORTH ZONE
GRID NORTH

Ellsworth District - Tyler County	
07-16	John Bennett
08-01	Karen Clark
08-02	Wendi Manion
08-03	Wendi Manion
08-04	Karen Clark
08-06	Karen Clark
08-7.1	Arthur Clark
08-7.2	Danny Booher
08-7.3	Danny Moore
08-08	Vera Knight
12-01	James Kleech
12-02	Gary Midcap
12-03	Dorothy Lauster
12-04	Charles Midcap Jr.
12-4.1	Charles Midcap Jr.
12-4.2	David Gifford
12-05	Rosalie Henry
12-06	Antero Midstream LLC
12-07	Coastal Forest Resources Co.
12-08	Shirley Carroll
12-09	Coastal Forest Resources Co.
12-17	Antero Midstream LLC
12-18	Antero Midstream LLC
12-19	Jon Dumars
12-20	Sha Yoho
12-20.1	Sha Yoho
12-21	Clarabelle Ferrell
12-22	Ralph Thacker
12-25	Margaret Lancaster
Green District - Wetzel County	
15-3	Robert Clark
15-4	Clair Dawson
15-6	Robert Clark
15-7	Clair Dawson
15-8	Clair Dawson
15-8.1	Edward Dawson Est.
15-11	Timothy Ueltschy
16-1	Ronald Nolan
16-5	Mount Olive Cemetery
16-6	Clair Dawson
16-7	Wilbur Dawson
16-17	Cathy Stewart
16-18	Cathy Stewart
16-19	Eugene Mason
16-27	Janet Jones
16-28	Janet Jones
16-34	Cheryl Loy
16-34.1	Shirley Carroll
16-35	Eugene Mason
16-35.1	Janet Jones
16-42	RBMA LLC
16-43	RBMA LLC
16-50	Christine Booher
16-51	David Gifford
16-52	RBMA LLC
19-1	Joshua Highley
19-55	Olive Moore
19-56	Brian Weekley
19-57	Brian Weekley

4,791'

9,330'

LONGITUDE 80°45'00"

LONGITUDE 80°45'00"

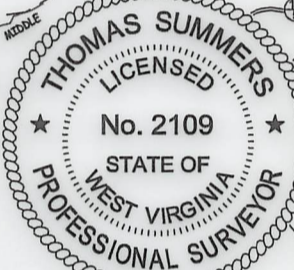
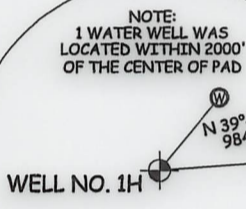

I THE UNDERSIGNED, HEREBY CERTIFY THAT THIS PLAT IS CORRECT TO THE BEST OF MY KNOWLEDGE AND BELIEF AND SHOWS ALL THE INFORMATION REQUIRED BY LAW AND THE RULES ISSUED AND PERSCRIBED BY THE DEPARTMENT OF ENVIRONMENTAL PROTECTION.



STATE OF WEST VIRGINIA, DIVISION OF ENVIRONMENTAL PROTECTION, OFFICE OF OIL AND GAS

WILLOW LAND SURVEYING PLLC
220 MASONIC AVE. PENNSBORO
WEST VIRGINIA 26415

MINERAL OWNERSHIP	
A	JOHN RAY NOLAN
B	TIMOTHY W. UELTSCHY
C	CLAIR P. DAWSON
D	SHIBEN ESTATES, INC.
E	KAREN SUB CLARK
F	BRC APPALACHIAN MINERALS I LLC
G	JANET CARROLL JONES
H	BRC APPALACHIAN MINERALS I LLC
I	ERNEST E. STEWART ET AL
J	CHERYL LOY
K	SHIRLEY L. CARROLL
L	DANNY RAY BOOHER ET UX
M	RBMA LLC
N	DANNY RAY BOOHER ET UX
O	DEANNA R. COCHRAN
P	ROSALIE B. HENRY
Q	OMA ANN FERRELL
R	BRIAN MICHAEL WEEKLEY
S	ELSIE M. SNIVELY
T	ELAINE L. OILER
U	H3 LLC
V	HAUGHT FAMILY TRUST
W	JOHN MICHAEL DUMARS ET UX
X	KAREN SUB CLARK
Y	JANET CARROLL JONES

JOB # 20-014WA
DRAWING # EMMONS1HAD
SCALE 1" = 2000'
MINIMUM DEGREE OF ACCURACY SUBMETER
PROVEN SOURCE OF ELEV. SUBMETER MAPPING GRADE GPS

LEGEND
--- Surface Owner Boundary Lines +/-
--- Interior Surface Tracts +/-
--- Proposed Well Path
--- As Drilled Well Path
THOMAS SUMMERS P.S. 2109
DATE 05/11/23
OPERATOR'S WELL# EMMONS UNIT #1H

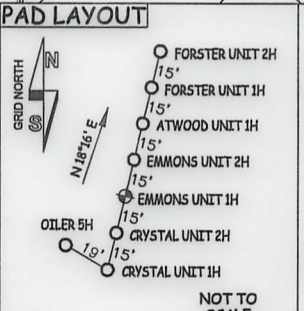

- NOTE
1. NO OCCUPIED DWELLINGS OR BUILDINGS TWO THOUSAND FIVE HUNDRED (2,500) SQUARE FEET OR LARGER USED TO HOUSE OR SHELTER DAIRY CATTLE OR POULTRY HUSBANDRY ARE LOCATED WITHIN SIX HUNDRED TWENTY-FIVE (625) FEET OF THE CENTER OF THE WELL PAD.
 2. TOP HOLE DATA SHOWN HEREON WAS PROVIDED BY ANTERO RESOURCES CORPORATION.
 3. AS DRILLED DATA WAS PROVIDED BY ANTERO RESOURCES CORPORATION.
 4. WLS IS NOT CERTIFYING THE DATA AND INFORMATION PROVIDED LISTED IN NOTES 2 AND 3, ONLY THE RELATIONSHIP TO THE DATA AND INFORMATION PROVIDED TO THE LEASE BOUNDARIES.
 5. WLS IS BY NO MEANS RESPONSIBLE FOR ANY ERRORS OR INACCURACIES WITH THE DATA AND INFORMATION THAT HAS BEEN PROVIDED.

STATE OF WEST VIRGINIA DEPARTMENT OF ENERGY DIVISION OF OIL AND GAS

WELL TYPE: OIL ___ GAS LIQUID INJECTION ___ WASTE DISPOSAL ___ 47 - 095 - 02801
(IF "GAS") PRODUCTION STORAGE ___ DEEP ___ SHALLOW STATE COUNTY PERMIT
LOCATION: ELEVATION 1,223'-AS BUILT WATERSHED OUTLET MIDDLE ISLAND CREEK
QUADRANGLE PORTER FALLS 7.5' DISTRICT ELLSWORTH COUNTY TYLER
SURFACE OWNER ANTERO MIDSTREAM LLC ACREAGE 50 ACRES +/-

OIL & GAS ROYALTY OWNER ELAINE L. OILER; HAUGHT FAMILY TRUST; LEASE ACREAGE 50 AC±; 16.25 AC±;
H3 LLC; OMA ANN FERRELL; DEANNA R. COCHRAN; DANNY RAY BOOHER ET UX; RBMA LLC; 14 AC±; 67 AC±; 67 AC±; 51.5 AC±; 119.75 AC±;
SHIRLEY L. CARROLL; CHERYL LOY; BRC APPALACHIAN MINERALS I LLC; JANET CARROLL JONES; 1.41 AC±; 10.59 AC±; 96.38 AC±; 20 AC±;
JANET CARROLL JONES; BRC APPALACHIAN MINERALS I LLC; CLAIR P. DAWSON; SHIBEN ESTATES 26.5 AC±; 15 AC±; 120.5 AC±; 54.5 AC±

PROPOSED WORK: DRILL ___ CONVERT ___ DRILL DEEPER ___ REDRILL ___ FRACTURE OR STIMULATE ___
PLUG OFF OLD FORMATION ___ PERFORATE NEW FORMATION ___ OTHER PHYSICAL CHANGE IN WELL ___
(SPECIFY) AS DRILLED PLUG & ABANDON CLEAN OUT & REPLUG
TARGET FORMATION MARCELLUS ESTIMATED DEPTH 6,899' TVD 18,014' MD
WELL OPERATOR ANTERO RESOURCES CORP. DESIGNATED AGENT KEVIN ELLIS
ADDRESS 1615 WYNKOOP ST. ADDRESS 535 WHITE OAKS BLVD
FORM WW-6 DENVER, CO 80202 BRIDGEPORT, WV 26330

COUNTY NAME
PERMIT

09/22/2023