



---

west virginia department of environmental protection

---

Office of Oil and Gas  
601 57<sup>th</sup> Street, S.E.  
Charleston, WV 25304  
(304) 926-0450  
fax: (304) 926-0452

Harold D. Ward, Cabinet Secretary  
[www.dep.wv.gov](http://www.dep.wv.gov)

Monday, December 5, 2022  
PERMIT MODIFICATION APPROVAL  
Horizontal 6A / New Drill

ANTERO RESOURCES CORPORATION  
1615 WYNKOOP STREET

DENVER, CO 80202

Re: Permit Modification Approval for FORSTER UNIT 2H  
47-095-02804-00-00

**Lateral Extension**

ANTERO RESOURCES CORPORATION

The Office of Oil and Gas has reviewed the attached permit modification for the above referenced permit. The attached modification has been approved and well work may begin. Please be reminded that the oil and gas inspector is to be notified twenty-four (24) hours before permitted well work is commenced.

If there are any questions, please feel free to contact me at (304) 926- 0450.

A handwritten signature in blue ink, appearing to read 'James A. Martin', is written over a faint, larger version of the signature.

James A. Martin  
Chief

Operator's Well Number: FORSTER UNIT 2H  
Farm Name: ANTERO MIDSTREAM LLC  
U.S. WELL NUMBER: 47-095-02804-00-00  
Horizontal 6A New Drill  
Date Modification Issued: 12/5/2022

Promoting a healthy environment.

12/09/2022

WW-6B  
(04/15)

CK# 4014925  
11/15/22  
\$15000

Expedited Mod  
4709502804

API NO. 47-095  
OPERATOR WELL NO. Forster Unit 2H  
Well Pad Name: Beech Run Pad

STATE OF WEST VIRGINIA  
DEPARTMENT OF ENVIRONMENTAL PROTECTION, OFFICE OF OIL AND GAS  
WELL WORK PERMIT APPLICATION

1) Well Operator: Antero Resources Corporation 494507062 095-Tyler Ellsworth Porter Falls 7.5'  
Operator ID County District Quadrangle

2) Operator's Well Number: Forster Unit 2H Well Pad Name: Beech Run Pad

3) Farm Name/Surface Owner: Antero Midstream LLC Public Road Access: Beech Run Rd.

4) Elevation, current ground: 1223' Elevation, proposed post-construction: \_\_\_\_\_

5) Well Type (a) Gas  Oil \_\_\_\_\_ Underground Storage \_\_\_\_\_

Other \_\_\_\_\_

(b) If Gas Shallow  Deep \_\_\_\_\_

Horizontal

6) Existing Pad: Yes or No Yes

7) Proposed Target Formation(s), Depth(s), Anticipated Thickness and Expected Pressure(s):  
Marcellus Shale: 7500' TVD, Anticipated Thickness- 55 feet, Associated Pressure- 2850#

8) Proposed Total Vertical Depth: 7500' TVD

9) Formation at Total Vertical Depth: Marcellus

10) Proposed Total Measured Depth: 25200' MD

11) Proposed Horizontal Leg Length: 15842'

12) Approximate Fresh Water Strata Depths: 880'

13) Method to Determine Fresh Water Depths: 47095308530000

14) Approximate Saltwater Depths: 2289'

15) Approximate Coal Seam Depths: 431'

16) Approximate Depth to Possible Void (coal mine, karst, other): None Anticipated

17) Does Proposed well location contain coal seams directly overlying or adjacent to an active mine? Yes \_\_\_\_\_ No

(a) If Yes, provide Mine Info: Name: \_\_\_\_\_  
Depth: \_\_\_\_\_  
Seam: \_\_\_\_\_  
Owner: \_\_\_\_\_

RECEIVED  
Office of Oil and Gas

DEC 05 2022

WV Department of  
Environmental Protection

Steve M...  
12/09/2022  
11/30/22

WW-6B  
(04/15)

4709502804  
 API NO. 47- 095  
 OPERATOR WELL NO. Forster Unit 2H  
 Well Pad Name: Beech Run Pad

18)

**CASING AND TUBING PROGRAM**

<b>TYPE</b>	<b>Size (in)</b>	<b>New or Used</b>	<b>Grade</b>	<b>Weight per ft. (lb/ft)</b>	<b>FOOTAGE: For Drilling (ft)</b>	<b>INTERVALS: Left in Well (ft)</b>	<b>CEMENT: Fill-up (Cu. Ft.)/CTS</b>
Conductor	20"	New	X-60	78.67#	100	100	CTS, 96 Cu. Ft.
Fresh Water	13-3/8"	New	J-55	54.5#	930	930	CTS, 969 Cu. Ft.
Coal	9-5/8"	New	J-55	36#	3000	3000	CTS, 1221 Cu. Ft.
Intermediate							
Production	5-1/2"	New	P-110HP	23#	25200	25200	5422 Cu. Ft.
Tubing	2-3/8"	New	N-80	4.7#			
Liners							

<b>TYPE</b>	<b>Size (in)</b>	<b>Wellbore Diameter (in)</b>	<b>Wall Thickness (in)</b>	<b>Burst Pressure (psi)</b>	<b>Anticipated Max. Internal Pressure (psi)</b>	<b>Cement Type</b>	<b>Cement Yield (cu. ft./k)</b>
Conductor	20"	24"	0.375"	2250	50	Class A	~1.18
Fresh Water	13-3/8"	17-1/2"	0.38"	2730	1000	Class A	~1.18
Coal	9-5/8"	12-1/4"	0.352"	3520	1500	Class A	~1.18
Intermediate							
Production	5-1/2"	8-3/4" & 8-1/2"	0.415"	14,360	2500	Class G/H	~1.8
Tubing	2-3/8"	4.778"	0.19"	11,200			
Liners							

**PACKERS**

Kind:	N/A			
Sizes:	N/A			
Depths Set:	N/A			

RECEIVED  
Office of Oil and Gas

DEC 05 2022

WV Department of  
Environmental Protection

*Steve Maly*  
11/30/22 12/09/2022



WW-6B  
(10/14)

API NO. 47-095

OPERATOR WELL NO. Forster Unit 2H

Well Pad Name: Beech Run Pad

19) Describe proposed well work, including the drilling and plugging back of any pilot hole:

Drill a new horizontal shallow well into the Marcellus Shale.

\*Antero will be air drilling the fresh water string which makes it difficult to determine when fresh water is encountered. Therefore, we have built in a buffer for the casing setting depth which helps to ensure that all fresh water zones are covered.

20) Describe fracturing/stimulating methods in detail, including anticipated max pressure and max rate:

Antero plans to pump Slickwater into the Marcellus Shale formation in order to ready the well for production. The fluid will be comprised of approximately 99 percent water and sand, with less than 1 percent special-purpose additives as shown in the attached "List of Anticipated Additives Used for Fracturing or Stimulating Well."

Anticipated Max Pressure - 9300 lbs

Anticipated Max Rate - 80 bpm

21) Total Area to be disturbed, including roads, stockpile area, pits, etc., (acres): 24.47 acres

22) Area to be disturbed for well pad only, less access road (acres): 12.89 acres

23) Describe centralizer placement for each casing string:

Conductor: no centralizers

Surface Casing: one centralizer 10' above the float shoe, one on the insert float collar and one every 4th joint spaced up the hole to surface.

Intermediate Casing: one centralizer above float joint, one centralizer 5' above float collar and one every 4th collar to surface.

Production Casing: one centralizer at shoe joint and one every 3 joints to top of cement in intermediate casing.

24) Describe all cement additives associated with each cement type:

Conductor: no additives, Class A cement.

Surface: Class A cement with 2-3% calcium chloride and 1/4 lb of flake

Intermediate: Class A cement with 1/4 lb of flake, 5 gallons of clay treat

Production: Lead cement- 50/50 Class H/Poz + 1.5% salt + 1% C-45 + 0.5% C-16a + 0.2% C-12 + 0.45% C-20 + 0.05% C-51

Production: Tail cement- Class H + 45 PPS Calcium Carbonate + 1.0% FL-160 + 0.2% ACGB-47 + 0.05% ACSA-51 + 0.2% ACR-20

RECEIVED  
Office of Oil and Gas

DEC 05 2022

WV Department of  
Environmental Protection

25) Proposed borehole conditioning procedures:

Conductor: blowhole clean with air, run casing, 10 bbls fresh water.

Surface: blowhole clean with air, trip to conductor shoe, trip to bottom, blowhole clean with air, trip out, run casing, circulate pipe capacity + 40 bbls fresh water followed by 25 bbls bentonite mud, 10 bbls fresh water spacer.

Intermediate: blowhole clean with air, trip to surface casing shoe, trip to bottom, blowhole clean with air, trip out, run casing, circulate 40 bbls brine water followed by 10 bbls fresh water and 25 bbls bentonite mud, pump 10 bbls fresh water.

Production: circulate with 14 lb/gal NaCl mud, trip to middle of lateral, circulate, pump high viscosity sweep, trip to base of curve, pump high viscosity sweep, trip to top of curve, trip to bottom, circulate, pump high viscosity sweep, trip out, run casing, circulate 10 bbls fresh water, pump 48 bbls barite pill, pump 10 bbls fresh water followed by 48 bbls mud flush and 10 bbls water.

\*Note: Attach additional sheets as needed.

# BEECH RUN PAD ANTERO RESOURCES CORPORATION

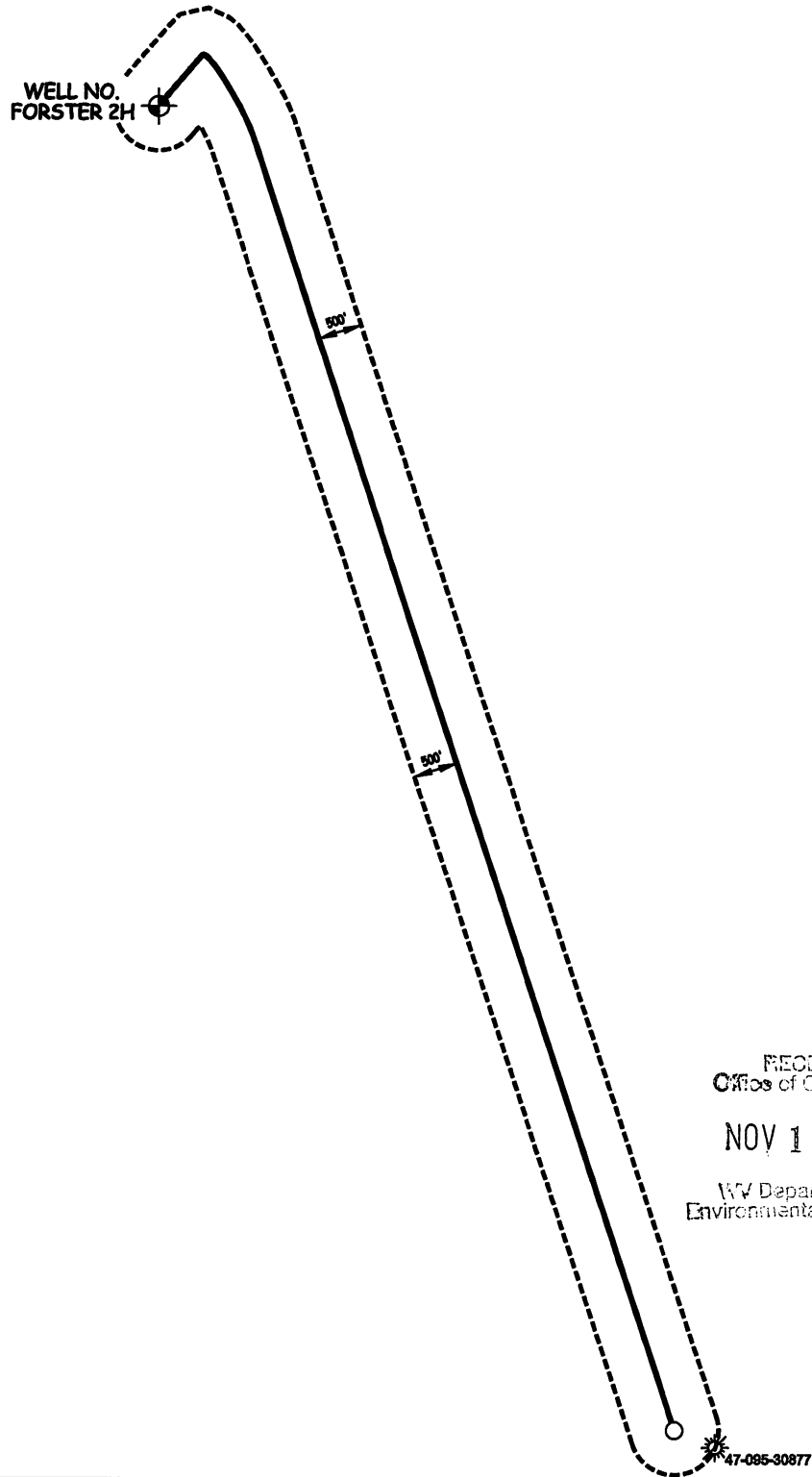

RECEIVED  
Office of Oil and Gas  
NOV 16 2022  
WV Department of  
Environmental Protection

WILLOW LAND SURVEYING, PLLC  
P.O. BOX 17, PENNSBORO, WV 26415  
(304) 659-1717

JOB #: 22-005WA

SCALE : 1-INCH = 2000-FEET

0' 2000' 4000' 6000'

DATE: 05/26/22

DRAWN BY: D.L.P.

FILE: FORSTER2HAOR.DWG



12/09/2022

UWI (APINum)	Well Name	Well Number	Operator	Historical Operator	TD	Perforated Interval (shallowest, deepest)	Perforated Formation(s)	Producible Formation(s) not perfd
47095308770000	GEORGE W BAILEY 1	2005	MANUFACT LIGHT & HEAT	MANUFACT LIGHT & HEAT	2,029		Big Injun	Berea, Weir, Alexander

RECEIVED  
 OFFICE OF OIL AND GAS  
 NOV 16 2022  
 NY Department of  
 Environmental Protection

4709502804



LATITUDE 39°32'30"

9,120'

LATITUDE 39°30'00"

3,104' TO BOTTOM HOLE

Antero Resources Corporation Well No. Forster Unit 2H

NOTES: WELL 2H TOP HOLE INFORMATION: N: 377,246ft E: 1,638,304ft LAT: 39°31'43.23" LON: 80°46'56.39" BOTTOM HOLE INFORMATION: N: 362,355ft E: 1,644,113ft LAT: 39°29'16.87" LON: 80°45'39.59" WEST VIRGINIA COORDINATE SYSTEM OF 1927 NORTH ZONE. ZONE WAS DERIVED FROM MEASUREMENTS TAKEN WITH TRIMBLE GEOXT SUBMETER MAPPING GRADE GPS UNIT. PLAT ORIENTATION, CORNER, AND WELL REFERENCE TIE LINES ARE BASED ON GRID NORTH.

(NAD) 83 (UTM) ZONE 17 COORDS: WELL 2H TOP HOLE INFORMATION: N: 4,375,478m E: 518,722m BOTTOM HOLE INFORMATION: N: 4,370,971m E: 520,568m

(NAD) 27 (UTM) ZONE 17 COORDS: WELL 2H TOP HOLE INFORMATION: N: 14,354,500ft E: 1,701,794ft POINT OF ENTRY INFORMATION: N: 14,354,658ft E: 1,702,608ft BOTTOM HOLE INFORMATION: N: 14,339,713ft E: 1,707,849ft

NOTE: NO OCCUPIED DWELLINGS OR BUILDINGS TWO THOUSAND FIVE HUNDRED (2,500) SQUARE FEET OR LARGER USED TO HOUSE OR SHELTER DAIRY CATTLE OR POULTRY HUSBANDRY ARE LOCATED WITHIN SIX HUNDRED TWENTY-FIVE (625) FEET OF THE CENTER OF THE WELL PAD.

NOTE: 1 WATER WELL WAS LOCATED WITHIN 2000' OF THE CENTER OF PAD

WELL NO. 2H

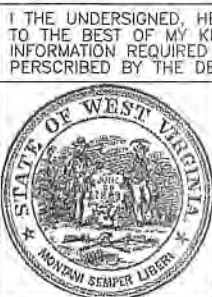
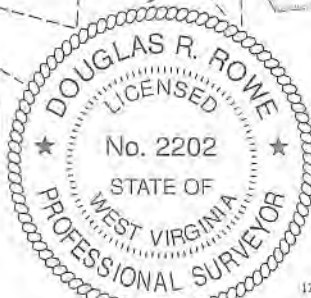

STATE OF WEST VIRGINIA, DIVISION OF ENVIRONMENTAL PROTECTION, OFFICE OF OIL AND GAS

WILLOW LAND SURVEYING PLLC 220 MASONIC AVE. PENNSBORO WEST VIRGINIA 26415

JOB # 20-014WA DRAWING # FORSTER2H SCALE 1" = 2000' MINIMUM DEGREE OF ACCURACY SUBMETER PROVEN SOURCE OF ELEV. SUBMETER MAPPING GRADE GPS

LEGEND: Surface Owner Boundary Lines +/-, Adjoining Surface Tracts +/-, Found monument, as noted. Signature: DR

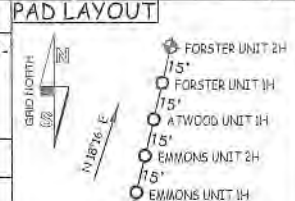

STATE OF WEST VIRGINIA DEPARTMENT OF ENERGY DIVISION OF OIL AND GAS

DATE 09/19/22 OPERATOR'S WELL# FORSTER UNIT #2H

WELL TYPE: OIL GAS X LIQUID INJECTION WASTE DISPOSAL 47 - 095 - 02804 MOD (IF "GAS") PRODUCTION X STORAGE DEEP SHALLOW X STATE COUNTY PERMIT LOCATION: ELEVATION 1,223'-AS BUILT WATERSHED OUTLET MIDDLE ISLAND CREEK QUADRANGLE PORTER FALLS 7.5' DISTRICT ELLSWORTH COUNTY TYLER SURFACE OWNER ANTERO MIDSTREAM LLC ACREAGE 50 ACRES +/-

OIL & GAS ROYALTY OWNER ELAINE L. OILER; ELSIE M. SNIVELY; JON MICHAEL DUMARS ET UX; CLARENCE MUTSCHELKNAUS; LEASE ACREAGE 50 AC±; 53.75 AC±; 47.5 AC±; 45 AC±; ROBERT LOUIS BARD; SUSAN LANCASTER GREEN; ELIZABETH G. MORRISON RICHIE; BRC APPALACHIAN MINERALS I LLC; BILLIE BLOYD; BRC APPALACHIAN MINERALS I LLC; 30 AC±; 49.33 AC±; 54.56 AC±; 83.25 AC±; 70 AC±; 13 AC±; PATRICK G. KELLER; JETT CARNEY GILL; STAR FURNITURE COMPANY OF WEST UNION; BRC APPALACHIAN MINERALS I LLC; ED BROOME INC.; 5 AC±; 10.38 AC±; 1.02 AC±; 121 AC±; 109.25 AC±; ANDREW HAUGHT ET UX; ANDREW HAUGHT ET UX; TINA LOUISE ZEDIKER ET AL.; KAREN & ROGER ENTERPRISES LLC; ANDREW HAUGHT ET UX 351.25 AC±; 15 AC±; 35 AC±; 13.13 AC±; 104.75 AC±; PROPOSED WORK: DRILL CONVERT DRILL DEEPER X REDRILL FRACTURE OR STIMULATE X PLUG OFF OLD FORMATION PERFORATE NEW FORMATION X OTHER PHYSICAL CHANGE IN WELL (SPECIFY) MOD-BHL PLUG & ABANDON CLEAN OUT & REPLUG TARGET FORMATION MARCELLUS ESTIMATED DEPTH 7,500' TVD 25,200' MD WELL OPERATOR ANTERO RESOURCES CORP. DESIGNATED AGENT DIANNA STAMPER - CT CORPORATION SYSTEM ADDRESS 1615 WYNKOOP ST. ADDRESS 5400 D BIG TYLER ROAD CHARLESTON, WV 25313

FORM WW-6

DENVER, CO 80202

CHARLESTON, WV 25313

WV NORTH ZONE GRID NORTH

4,364' TO BOTTOM HOLE

LONGITUDE 80°45'00"

Table listing mineral ownership for various tracts, including names like A. ELSIE M. SNIVELY, B. ELAINE L. OILER, C. JON MICHAEL DUMARS ET UX, etc.

12/09/2022

COUNTY NAME

PERMIT



LATITUDE 39°32'30"

9,120'

LATITUDE 39°30'00"

3,104' TO BOTTOM HOLE

Antero Resources Corporation  
Well No. Forster Unit 2H

**NOTES:**  
**WELL 2H TOP HOLE INFORMATION:**  
 N: 377,246ft E: 1,638,304ft  
 LAT: 39°31'43.23" LON: 80°46'56.39"  
**BOTTOM HOLE INFORMATION:**  
 N: 362,355ft E: 1,644,113ft  
 LAT: 39°29'16.87" LON: 80°45'39.59"  
 WEST VIRGINIA COORDINATE SYSTEM OF 1927 NORTH ZONE. ZONE WAS DERIVED FROM MEASUREMENTS TAKEN WITH TRIMBLE GEOXT TAKEMETER MAPPING GRADE GPS UNIT. PLAT ORIENTATION, CORNER, AND WELL REFERENCE TIE LINES ARE BASED ON GRID NORTH.

**(NAD) 83 (UTM) ZONE 17 COORDS:**  
**WELL 2H TOP HOLE INFORMATION:**  
 N: 4,375,478m E: 518,722m  
**BOTTOM HOLE INFORMATION:**  
 N: 4,370,971m E: 520,568m

**(NAD) 27 (UTM) ZONE 17 COORDS:**  
**WELL 2H TOP HOLE INFORMATION:**  
 N: 14,354,500ft E: 1,701,794ft  
**POINT OF ENTRY INFORMATION:**  
 N: 14,354,658ft E: 1,702,608ft  
**BOTTOM HOLE INFORMATION:**  
 N: 14,339,713ft E: 1,707,849ft

**NOTE**  
 NO OCCUPIED DWELLINGS OR BUILDINGS TWO THOUSAND FIVE HUNDRED (2,500) SQUARE FEET OR LARGER USED TO HOUSE OR SHELTER DAIRY CATTLE OR POULTRY HUSBANDRY ARE LOCATED WITHIN SIX HUNDRED TWENTY-FIVE (625) FEET OF THE CENTER OF THE WELL PAD.

**NOTE:**  
 1 WATER WELL WAS LOCATED WITHIN 2000' OF THE CENTER OF PAD

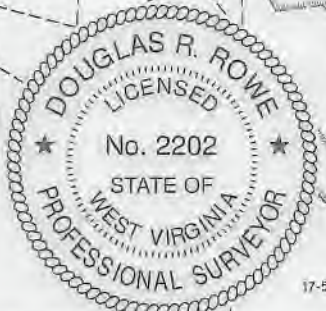
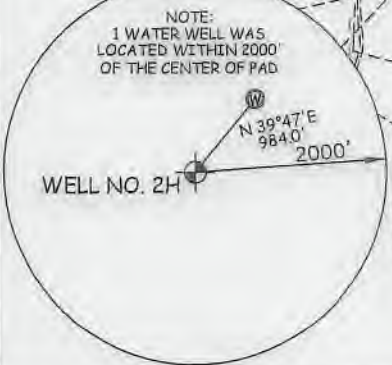

I THE UNDERSIGNED, HEREBY CERTIFY THAT THIS PLAT IS CORRECT TO THE BEST OF MY KNOWLEDGE AND BELIEF AND SHOWS ALL THE INFORMATION REQUIRED BY LAW AND THE RULES ISSUED AND PERSCRIBED BY THE DEPARTMENT OF ENVIRONMENTAL PROTECTION.



STATE OF WEST VIRGINIA, DIVISION OF ENVIRONMENTAL PROTECTION, OFFICE OF OIL AND GAS  
 WILLOW LAND SURVEYING PLLC  
 220 MASONIC AVE. PENNSBORO WEST VIRGINIA 26415

JOB # 20-014WA  
 DRAWING # FORSTER2H  
 SCALE 1" = 2000'  
 MINIMUM DEGREE OF ACCURACY SUBMETER  
 PROVEN SOURCE OF ELEV. SUBMETER MAPPING GRADE GPS  
 STATE OF WEST VIRGINIA DEPARTMENT OF ENERGY DIVISION OF OIL AND GAS

**LEGEND**  
 - - - - - Surface Owner Boundary Lines +/-  
 - - - - - Adjoining Surface Tracts +/-  
 ⊕ Found monument, as noted  
 DOUGLAS R. ROWE P.S. 2202  
 DATE 09/19/22  
 OPERATOR'S WELL# FORSTER UNIT #2H

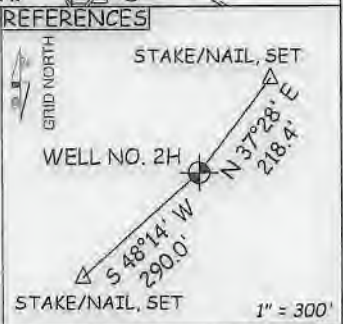
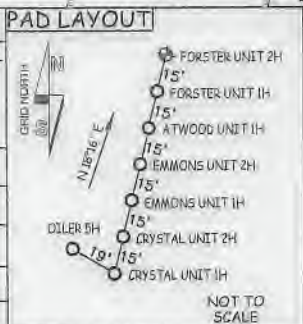

WELL TYPE: OIL  GAS  LIQUID INJECTION  WASTE DISPOSAL  47 - 095 - 02804 Mod  
 (IF "GAS") PRODUCTION  STORAGE  DEEP  SHALLOW  STATE COUNTY PERMIT  
 LOCATION: ELEVATION 1,223' -AS BUILT WATERSHED OUTLET MIDDLE ISLAND CREEK  
 QUADRANGLE PORTER FALLS 7.5' DISTRICT ELLSWORTH COUNTY TYLER  
 SURFACE OWNER ANTERO MIDSTREAM LLC ACREAGE 50 ACRES +/-  
 OIL & GAS ROYALTY OWNER ELAINE L. OILER; ELSIE M. SNIVELY; JON MICHAEL DUMARS ET UX; CLARENCE MUTSCHELKNAUS; LEASE ACREAGE 50 AC±; 53.75 AC±; 47.5 AC±; 45 AC±;  
 ROBERT LOUIS BARD; SUSAN LANCASTER GREEN; ELIZABETH G. MORRISON RICHIE; BRC APPALACHIAN MINERALS I LLC; BILLIE BLOYD; BRC APPALACHIAN MINERALS I LLC; 30 AC±; 49.33 AC±; 54.56 AC±; 93.25 AC±; 70 AC±; 13 AC±;  
 PATRICK G. KELLER; JETT CARNEY GILL; STAR FURNITURE COMPANY OF WEST UNION; BRC APPALACHIAN MINERALS I LLC; ED BROOME INC.; 5 AC±; 10.38 AC±; 1.02 AC±; 121 AC±; 109.25 AC±;  
 ANDREW HAUGHT ET UX; ANDREW HAUGHT ET UX; TINA LOUISE ZEDIKER ET AL; KAREN & ROGER ENTERPRISES LLC; ANDREW HAUGHT ET UX; 351.25 AC±; 15 AC±; 35 AC±; 13.13 AC±; 104.75 AC±;  
 PROPOSED WORK: DRILL  CONVERT  DRILL DEEPER  REDRILL  FRACTURE OR STIMULATE   
 PLUG OFF OLD FORMATION  PERFORATE NEW FORMATION  OTHER PHYSICAL CHANGE IN WELL  
 (SPECIFY) MOD-BHL PLUG & ABANDON CLEAN OUT & REPLUG  
 TARGET FORMATION MARCELLUS ESTIMATED DEPTH 7,500' TVD 25,200' MD  
 WELL OPERATOR ANTERO RESOURCES CORP. DESIGNATED AGENT DIANNA STAMPER - CT CORPORATION SYSTEM  
 ADDRESS 1615 WYNKOOP ST. ADDRESS 5400 D BIG TYLER ROAD  
 FORM WW-6 DENVER, CO 80202 CHARLESTON, WV 25313

WV NORTH ZONE GRID NORTH

4,364' TO BOTTOM HOLE

LONGITUDE 80°45'00"

LONGITUDE 80°45'00"

4,733'

12/09/2022

COUNTY NAME

PERMIT



WW-6A1

Operator's Well Number Forster Unit 2H MOD

INFORMATION SUPPLIED UNDER WEST VIRGINIA CODE  
Chapter 22, Article 6A, Section 5(a)(5)  
IN LIEU OF FILING LEASE(S) AND OTHER CONTINUING CONTRACT(S)

Under the oath required to make the verification on page 1 of this Notice and Application, I depose and say that I am the person who signed the Notice and Application for the Applicant, and that –

- (1) the tract of land is the same tract described in this Application, partly or wholly depicted in the accompanying plat, and described in the Construction and Reclamation Plan;
- (2) the parties and recordation data (if recorded) for lease(s) or other continuing contract(s) by which the Applicant claims the right to extract, produce or market the oil or gas are as follows:

Grantor, lessor, etc.	Grantee, lessee, etc.	Royalty	Book/Page
<b>B: Elaine L. Oiler Lease</b>			
Elaine L. Oiler	Petroedge Energy LLC	1/8	0399/0725
Petroedge Energy LLC	Statoil USA Onshore Properties	Assignment	0406/0147
Statoil USA Onshore Properties	EQT Production Company	Assignment	0539/0239
EQT Production Company	<b>Antero Resources Corporation</b>	<b>Assignment</b>	<b>0663/0001</b>
<b>A: Elsie M. Snively Lease</b>			
Elsie M. Snively	Statoil USA Onshore Properties Inc	1/8+	0463/0680
Statoil USA Onshore Properties Inc	EQT Production Company	Assignment	0539/0239
EQT Production Company	<b>Antero Resources Corporation</b>	<b>Assignment</b>	<b>0663/0001</b>
<b>C: Jon Michael Dumars et ux Lease</b>			
Jon Michael Dumars et ux	Petroedge Energy LLC	1/8+	0397/0007
Petroedge Energy LLC	Statoil USA Onshore Properties Inc	Assignment	0406/0147
Statoil USA Onshore Properties Inc	EQT Production Company	Assignment	0539/0239
EQT Production Company	<b>Antero Resources Corporation</b>	<b>Assignment</b>	<b>0663/0001</b>
<b>E: Clarence Mutschelkaus Lease</b>			
Clarence Mutschelkaus	<b>Antero Resources Corporation</b>	1/8+	0156/0242
<b>F: Robert Louis Bard Lease</b>			
Robert Louis Bard	Petroedge Energy LLC	1/8+	0387/0248
Petroedge Energy LLC	Statoil USA Onshore Properties Inc	Assignment	0406/0147
Statoil USA Onshore Properties Inc	EQT Production Company	Assignment	0539/0239
EQT Production Company	<b>Antero Resources Corporation</b>	<b>Assignment</b>	<b>0663/0001</b>
<b>G: Susan Lancaster Green Lease</b>			
Susan Lancaster Green	<b>Antero Resources Corporation</b>	1/8+	0526/0073
<b>I: Elizabeth G. Morrison Richie Lease</b>			
Elizabeth G. Morrison Richie	Statoil USA Onshore Properties Inc	1/8+	0438/0685
Statoil USA Onshore Properties Inc	EQT Production Company	Assignment	0539/0239
EQT Production Company	<b>Antero Resources Corporation</b>	<b>Assignment</b>	<b>0663/0001</b>
<b>K: BRC Appalachian Minerals I LLC Lease</b>			
BRC Appalachian Minerals I LLC	BRC Working Interest Company LLC	1/8+	0369/0300
BRC Appalachian Minerals I LLC	BRC Working Interest Company LLC	Amend	0369/0648
BRC Working Interest Company LLC	Chesapeake Appalachia, LLC	Assignment	0369/0784
Chesapeake Appalachia, LLC	Statoil USA Onshore Properties Inc	Assignment	0378/0764
Statoil USA Onshore Properties Inc	SWN Exchange Titleholder LLC	Assignment	0470/0668
SWN Exchange Titleholder LLC	SWN Production Company LLC	Merger	0009/0404
SWN Production Company LLC	Antero Exchange Properties	Assignment	0544/0242
Antero Exchange Properties	<b>Antero Resources Corporation</b>	<b>Merger</b>	<b>0525/0315</b>
<b>L: Billie Bloyd Lease</b>			
Billie Bloyd	Petroedge Energy LLC	1/8	0384/0072
Petroedge Energy LLC	Statoil USA Onshore Properties Inc	Assignment	0406/0147
Statoil USA Onshore Properties Inc	EQT Production Company	Assignment	0539/0239
EQT Production Company	<b>Antero Resources Corporation</b>	<b>Assignment</b>	<b>0663/0001</b>

12/09/2022

WW-6A1

Operator's Well Number Forster Unit 2H MOD

INFORMATION SUPPLIED UNDER WEST VIRGINIA CODE  
Chapter 22, Article 6A, Section 5(a)(5)  
IN LIEU OF FILING LEASE(S) AND OTHER CONTINUING CONTRACT(S)

Under the oath required to make the verification on page 1 of this Notice and Application, I depose and say that I am the person who signed the Notice and Application for the Applicant, and that –

- (1) the tract of land is the same tract described in this Application, partly or wholly depicted in the accompanying plat, and described in the Construction and Reclamation Plan;
- (2) the parties and recordation data (if recorded) for lease(s) or other continuing contract(s) by which the Applicant claims the right to extract, produce or market the oil or gas are as follows:

Grantor, lessor, etc.	Grantee, lessee, etc.	Royalty	Book/Page
<b><u>N: BRC Appalachian Minerals I LLC Lease</u></b>			
BRC Appalachian Minerals I LLC	BRC Working Interest Company LLC	1/8+	0369/0300
BRC Appalachian Minerals I LLC	BRC Working Interest Company LLC	Amend	0369/0648
BRC Working Interest Company LLC	Chesapeake Appalachia, LLC	Assignment	0369/0784
Chesapeake Appalachia, LLC	Statoil USA Onshore Properties Inc	Assignment	0378/0764
Statoil USA Onshore Properties Inc	SWN Exchange Titleholder LLC	Assignment	0470/0668
SWN Exchange Titleholder LLC	SWN Production Company LLC	Merger	0009/0404
SWN Production Company LLC	Antero Exchange Properties	Assignment	0544/0242
Antero Exchange Properties	Antero Resources Corporation	Merger	0525/0315
<b><u>P: Patrick G. Keller Lease</u></b>			
Patrick G. Keller	Petroedge Energy LLC	1/8+	0383/0316
Petroedge Energy LLC	Statoil USA Onshore Properties Inc	Assignment	0406/0147
Statoil USA Onshore Properties Inc	EQT Production Company	Assignment	0539/0239
EQT Production Company	Antero Resources Corporation	Assignment	0663/0001
<b><u>Q: Jet Carney Gill Lease</u></b>			
Jet Carney Gill	Petroedge Energy LLC	1/8+	0416/0542
Petroedge Energy LLC	Statoil Onshore Properties Inc	Assignment	0406/0147
Statoil USA Onshore Properties Inc	EQT Production Company	Assignment	0539/0239
EQT Production Company	Antero Resources Corporation	Assignment	0663/0001
<b><u>R: Star Furniture Company of West Union Lease</u></b>			
Star Furniture Company of West Union	Petroedge Energy LLC	1/8	0385/0847
Petroedge Energy LLC	Statoil USA Onshore Properties Inc	Assignment	0406/0147
Statoil USA Onshore Properties Inc	EQT Production Company	Assignment	0539/0239
EQT Production Company	Antero Resources Corporation	Assignment	0663/0001
<b><u>S: BRC Appalachian Minerals I LLC Lease</u></b>			
BRC Appalachian Minerals I LLC	BRC Working Interest Company LLC	1/8+	0369/0300
BRC Appalachian Minerals I LLC	BRC Working Interest Company LLC	Amend	0369/0648
BRC Working Interest Company LLC	Chesapeake Appalachia, LLC	Assignment	0369/0784
Chesapeake Appalachia, LLC	Statoil USA Onshore Properties Inc	Assignment	0378/0764
Statoil USA Onshore Properties Inc	SWN Exchange Titleholder LLC	Assignment	0470/0668
SWN Exchange Titleholder LLC	SWN Production Company LLC	Merger	0009/0404
SWN Production Company LLC	Antero Exchange Properties	Assignment	0544/0242
Antero Exchange Properties	Antero Resources Corporation	Merger	0525/0315
<b><u>U: BRC Appalachian Minerals I LLC Lease</u></b>			
BRC Appalachian Minerals I LLC	BRC Working Interest Company LLC	1/8+	0369/0300
BRC Appalachian Minerals I LLC	BRC Working Interest Company LLC	Amend	0369/0648
BRC Working Interest Company LLC	Chesapeake Appalachia, LLC	Assignment	0369/0784
Chesapeake Appalachia, LLC	Statoil USA Onshore Properties Inc	Assignment	0378/0764
Statoil USA Onshore Properties Inc	SWN Exchange Titleholder LLC	Assignment	0470/0668
SWN Exchange Titleholder LLC	SWN Production Company LLC	Merger	0009/0404
SWN Production Company LLC	Antero Exchange Properties	Assignment	0544/0242
Antero Exchange Properties	Antero Resources Corporation	Merger	0525/0315

RECEIVED  
Department of Oil and Gas  
NOV 16 2022

WV Department of  
Environmental Protection

12/09/2022



WW-6A1

Operator's Well Number Forster Unit 2H MOD

INFORMATION SUPPLIED UNDER WEST VIRGINIA CODE  
Chapter 22, Article 6A, Section 5(a)(5)  
IN LIEU OF FILING LEASE(S) AND OTHER CONTINUING CONTRACT(S)

Under the oath required to make the verification on page 1 of this Notice and Application, I depose and say that I am the person who signed the Notice and Application for the Applicant, and that –

- (1) the tract of land is the same tract described in this Application, partly or wholly depicted in the accompanying plat, and described in the Construction and Reclamation Plan;
- (2) the parties and recordation data (if recorded) for lease(s) or other continuing contract(s) by which the Applicant claims the right to extract, produce or market the oil or gas are as follows:

Grantor, lessor, etc.	Grantee, lessee, etc.	Royalty	Book/Page
<b>T: Ed Broome Inc Lease</b> Ed Broome Inc	Antero Resources Corporation	1/8+	0577/0482
<b>V: Andrew Haught et ux Lease</b> Andrew Haught et ux E.H. Jennings and Bros Tri-State Gas Company Manufacturer Light and Heat Company Union Gasoline and Oil Corporation  A.M. Snider and Duane M. Snider dba Hundred Gas Company Carl D. Perkins Perkins Oil and Gas, Inc Stone Energy Corporation EQT Production Company	E.H. Jennings and Bros Tri-State Gas Company Manufacturer Light and Heat Company Union Gasoline and Oil Corporation A.M. Snider and Duane M. Snider dba Hundred Gas Company Carl D. Perkins Perkins Oil and Gas, Inc Stone Energy Corporation EQT Production Company Antero Resources Corporation	1/8 Assignment Assignment Assignment Assignment  Assignment Assignment Assignment Assignment Assignment	0039/0292 0043/0110 0080/0048 0103/0313 0167/0423  0201/0316 0225/0574 0390/0066 0556/0132 Permission to Permit
<b>X: Andrew Haught et ux Lease</b> Andrew Haught et ux E.H. Jennings and Bros Tri-State Gas Company Manufacturer Light and Heat Company Union Gasoline and Oil Corporation  A.M. Snider and Duane M. Snider dba Hundred Gas Company Carl D. Perkins Perkins Oil and Gas, Inc Stone Energy Corporation EQT Production Company	E.H. Jennings and Bros Tri-State Gas Company Manufacturer Light and Heat Company Union Gasoline and Oil Corporation A.M. Snider and Duane M. Snider dba Hundred Gas Company Carl D. Perkins Perkins Oil and Gas, Inc Stone Energy Corporation EQT Production Company Antero Resources Corporation	1/8 Assignment Assignment Assignment Assignment  Assignment Assignment Assignment Assignment	0039/0292 0043/0110 0080/0048 0103/0313 0167/0423  0201/0316 0225/0574 0390/0066 0556/0132 Permission to Permit
<b>Z: Tina Louise Zediker et al Lease</b> Tine Louise Zediker et al Petroedge Energy LLC Statoil USA Onshore Properties Inc EQT Production Company	Petroedge Energy LLC Statoil USA Onshore Properties Inc EQT Production Company Antero Resources Corporation	1/8+ Assignment Assignment Assignment	0395/0498 0406/0147 0539/0239 0663/0001
<b>AA: Karen &amp; Roger Enterprises LLC Lease</b> Karen & Roger Enterprises LLC Petroedge Energy LLC Statoil USA Onshore Properties Inc EQT Production Company	Petroedge Energy LLC Statoil USA Onshore Properties Inc EQT Production Company Antero Resources Corporation	1/8+ Assignment Assignment Assignment	0433/0582 0406/0147 0539/0239 0663/0001

\*Partial Assignments to Antero Resources Corporation include 100% rights to extract, produce and market the oil and gas from the Marcellus and any other formations completed with this well.

12/09/2022

**INFORMATION SUPPLIED UNDER WEST VIRGINIA CODE  
Chapter 22, Article 6A, Section 5(a)(5)  
IN LIEU OF FILING LEASE(S) AND OTHER CONTINUING CONTRACT(S)**

Under the oath required to make the verification on page 1 of this Notice and Application, I depose and say that I am the person who signed the Notice and Application for the Applicant, and that –

- (1) the tract of land is the same tract described in this Application, partly or wholly depicted in the accompanying plat, and described in the Construction and Reclamation Plan;
- (2) the parties and recordation data (if recorded) for lease(s) or other continuing contract(s) by which the Applicant claims the right to extract, produce or market the oil or gas are as follows:

Lease Name or Number	Grantor, Lessor, etc.	Grantee, Lessee, etc.	Royalty	Book/Page
<u>AC: Andrew Haught et ux Lease</u>				
	Andrew Haught et ux	E.H Jennings and Bros	1/8+	39/292
	E.H Jennings and Bros	Tri-State Gas Company	Assignment	43/110
	Tri- State Gas Company	Manufacturer Light and Heat Company	Assignment	80/48
	Manufacturer Light and Heat Company	Union Gasoline and Oil Company	Assignment	103/313
	Union Gasoline and Oil Company	AM Snider and Duane M Snider dba Hundred Gas Company	Assignment	167/423
	AM Snider and Duane M Snider dba Hundred Gas Company	Carl D Perkins	Assignment	201/316
	Carl D Perkins	Perkins Oil and Gas Inc	Assignment	225/574
	Perkins Oil and Gas Inc	Stone Energy Corporation	Assignment	390/66
	Stone Energy Corporation	EQT Production Company	Assignment	556/132
	EQT Production Company	Antero Resources Corporation	Assignment	Permission to Permit

\*Partial Assignments to Antero Resources Corporation include 100% rights to extract, produce and market the oil and gas from the Marcellus and any other formations completed with this well.

The permit applicant for the proposed well work addressed in this application hereby acknowledges the possibility of the need for permits and/or approvals from local, state, or federal entities in addition to the DEP, Office of Oil and Gas, including but not limited to the following:

- WV Division of Water and Waste Management
- WV Division of Natural Resources WV Division of Highways
- U.S. Army Corps of Engineers
- U.S. Fish and Wildlife Service
- County Floodplain Coordinator

The applicant further acknowledges that any Office of Oil and Gas permit in no way overrides, replaces, or nullifies the need for other permits/approvals that may be necessary and further affirms that all needed permits/approvals should be acquired from the appropriate authority before the affected activity is initiated.

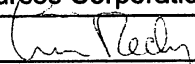
Well Operator: Antero Resources Corporation  
 By: Tim Rady   
 Its: Senior Vice President of Land



November 4, 2022

Jarred Detweiler  
EQT Production Company  
EQT Plaza  
625 Liberty Avenue, Suite 1700  
Pittsburgh, PA 15222

**RE: Permission to Permit and Drill**

Tyler and Wetzel County, West Virginia

Dear Mr. Detweiler,

Antero Resources Corporation ("**Antero**") hereby requests permission from EQT Production Company ("**EQT**") to proceed with Antero's plans to drill one or more horizontal wells in, under, and through certain properties subject to oil and gas interests owned or controlled by EQT located in Tyler and Wetzel County, West Virginia, as more particularly described on Exhibit A to this letter agreement (the "**O&G Interests**"), and insofar and only insofar as to the Marcellus Rights (the "**Properties**"), pursuant to the terms and conditions of this letter agreement. Antero and EQT are currently parties to an Acreage Trade Agreement dated December 17, 2021 (as amended from time to time, the "**Trade Agreement**"), which includes the Properties. Capitalized terms not otherwise defined herein shall have the meanings ascribed to them in the Trade Agreement.

In order to generate mutual goodwill between EQT and Antero, and for one hundred dollars (\$100.00) and other good and valuable consideration, the receipt and sufficiency of which are hereby acknowledged, subject to the terms and conditions of this letter agreement and the Trade Agreement, EQT hereby grants Antero the right to apply for and obtain all applicable governmental permits for the drilling of one or more wellbore laterals in, under, and through the Properties (collectively, "**Wells**") and to drill, complete and produce such Wells.

In the event that Antero and EQT do not consummate the Closing of the Trade Agreement with respect to a Property, then Antero shall have the right to elect to enter into with EQT one (1) or more mutually-agreed joint operating agreements (with each contract area covering a unit) with respect to such Properties, effective as of the date hereof and in each case subject to the terms and conditions of the Trade Agreement.

Antero hereby agrees to release, protect, indemnify, defend and hold harmless EQT from and against any claims, expenses, damages, injuries, claims or obligations or liabilities (including reasonable attorneys' fees) that may be brought by any third party against EQT or its Affiliates to the extent arising out of Antero's drilling or other operations pursuant to this letter agreement and that arise on or after the date of this letter agreement through the Expiration Date (as defined below). This paragraph shall survive (a) the Closing and the assignment or lease, as applicable,

12/09/2022

related to the Properties, (b) the execution of a mutually-agreed joint operating agreement with respect to any Properties, or (c) any termination of all or any part of this letter agreement.

Nothing in this letter agreement will diminish any current or future rights of EQT in the Properties or other properties. This letter agreement and the rights and obligations of EQT and Antero hereunder will terminate (on a Property-by-Property basis) upon the earliest of (I) the execution of a mutually-agreed joint operating agreement with respect to such Property, (II) if and when Antero and EQT consummate the Closing of the Trade Agreement with respect to such Property and (III) the date this letter agreement terminates with respect to such Property as provided in the Trade Agreement. ("*Expiration Date*").

If the above meets your approval, please execute in the space provided below and return one signed copy to the letterhead address. Should you have any questions, please contact Jared Hurst at (303) 357-6835.

[*Signature Pages Follow.*]

NOV 16 2022  
WV Department of  
Environmental Protection



Sincerely,

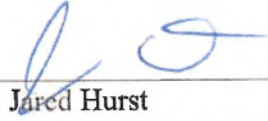

**ANTERO RESOURCES CORPORATION**

By:   
Name: Jared Hurst  
Title: Vice President – Land

RECEIVED  
Office of Oil and Gas  
NOV 16 2022  
NY Department of  
Environmental Protection

AGREED TO AND ACCEPTED:

**EQT PRODUCTION COMPANY**

By:     
Name: Corey C. Peck  
Title: Authorized Agent

RECEIVED  
Office of Oil and Gas  
NOV 16 2022  
NY Department of  
Environmental Protection



**EXHIBIT A  
PROPERTIES**

[See attached.]

RECEIVED  
Office of Oil and Gas  
NOV 16 2022  
WV Department of  
Environmental Protection

12/09/2022

**EXHIBIT A**  
**PROPERTIES**

Owner	Company	Acquire Date	Acquire Price	Current Price	County	District	Book	Page	Comments/Notes	Related to...	For Conversion?	Other Comments	Exp. Date	April Trail Pkt
Jennifer Meeker, s/k/a Jennifer Evans Meeker, a widow	EQT Production Company	11/26/2018	55.00000	55.00000	Tyler	Ellsworth	632	799	p/o 2-3-28, p/o 2-3-28.1, 2-3-28.2, 2-3-28.5, 2-3-28.6, 2-3-28.7	None	X			
J. Maurice Carlisle, Jr., a widower	EQT Production Company	8/15/2019	61.95000	61.95000	Tyler	Ellsworth	666	508	p/o 2-3-9 (A)	None	X			
D. Ralph Thacker, a married man dealing in his sole and separate property	EQT Production Company	6/14/2019	61.95000	61.95000	Tyler	Ellsworth	666	524	p/o 2-3-9 (A)	None	X			
Penny Bucher, a widow	EQT Production Company	11/21/2018	66.50000	66.50000	Tyler	Ellsworth	630	704	7-3-24	None	X			
Ronald L. Rogers and Diane D. Rogers, his wife	EQT Production Company	7/31/2018	66.50000	66.50000	Tyler	Ellsworth	620	406	2-3-24	None	X			
Thomas J. Rogers and Lois J. Rogers, his wife	EQT Production Company	8/6/2018	66.50000	66.50000	Tyler	Ellsworth	622	41	2-3-24	None	X			
Uinda G. Tennis and Keith E. Tennis, her husband	EQT Production Company	9/11/2018	66.50000	66.50000	Tyler	Ellsworth	623	521	2-3-24	None	X			
Jeffrey C. Moore and Violet A. Moore, his wife	EQT Production Company	7/31/2018	66.50000	66.50000	Tyler	Ellsworth	620	408	2-3-24	None	X			
Richard C. Moore, a married man dealing in his sole and separate property	EQT Production Company	7/31/2018	66.50000	66.50000	Tyler	Ellsworth	620	403	2-3-24	None	X			
Uinda Toothman Watkins, a widow	Stone Energy Corporation	2/22/2018	44.00000	44.00000	Wetzel Tyler	Magnolia Ellsworth	214A 620	494 256	p/o 2-1-11, 8-16-64	None	X			
Trustees of Saint Paul's United Methodist Church, by its Trustee, Sandra Headley	EQT Production Company	1/16/2019	44.00000	44.00000	Wetzel Tyler	Magnolia Ellsworth	222A 220A	711 749	p/o 2-1-11, 8-16-64	None	X			
Trustees of Saint Paul's United Methodist Church, by its Trustee, Sandra Headley	EQT Production Company	1/16/2019	49.33000	44.00000	Wetzel Tyler	Magnolia Ellsworth	222A 220A	711 749	2-1-11	None	X			
Jo Ann Whitacre	Stone Energy Corporation	4/19/2013	44.00000	44.00000	Wetzel Tyler	Magnolia Ellsworth	148A 436	704 344	p/o 2-1-11, 8-16-64	None	X			
Elsie Woods, dealing in her own right	Stone Energy Corporation	12/26/2012	44.00000	44.00000	Wetzel Tyler	Magnolia Ellsworth	145A 426	348 598	p/o 2-1-11, 8-16-64	None	X			
Clare Jan Hand	Stone Energy Corporation	1/7/2013	44.00000	44.00000	Wetzel Tyler	Magnolia Ellsworth	145A 426	346 592	p/o 2-1-11, 8-16-64	None	X			
Lisa Sambianet	Stone Energy Corporation	1/7/2013	44.00000	44.00000	Wetzel Tyler	Magnolia Ellsworth	141A 421	720 172	p/o 2-1-11, 8-16-64	None	X			
Howard Anderson	Stone Energy Corporation	1/30/2013	44.00000	44.00000	Wetzel Tyler	Magnolia Ellsworth	144A 427	303 235	p/o 2-1-11, 8-16-64	None	X			
Victor Joe Wells	Stone Energy Corporation	2/6/2013	44.00000	44.00000	Wetzel Tyler	Magnolia Ellsworth	145A 425	90 845	p/o 2-1-11, 8-16-64	None	X			
Gary L. Anderson	Stone Energy Corporation	1/2/2013	44.00000	44.00000	Wetzel Tyler	Magnolia Ellsworth	141A 421	783 174	p/o 2-1-11, 8-16-64	None	X			
Sara A. Fitch, dealing in her own right	Stone Energy Corporation	1/6/2013	44.00000	44.00000	Wetzel Tyler	Magnolia Ellsworth	141A 421	692 166	p/o 2-1-11, 8-16-64	None	X			
Jason Adams, dealing in his own right	Stone Energy Corporation	2/8/2013	44.00000	44.00000	Wetzel Tyler	Magnolia Ellsworth	145A 426	100 13	p/o 2-1-11, 8-16-64	None	X			
Joy E. Hossman	Stone Energy Corporation	2/27/2013	44.00000	44.00000	Wetzel Tyler	Magnolia Ellsworth	145A 426	344 580	p/o 2-1-11, 8-16-64	None	X			
Geraldine O'Connell	Stone Energy Corporation	1/4/2013	44.00000	44.00000	Wetzel Tyler	Magnolia Ellsworth	141A 421	718 170	p/o 2-1-11, 8-16-64	None	X			



Lessee	Lessee	Lessee Date	Original Book/Acres	Subveyed Acres	County	Tract	Book/Type	Surveyed (MO/YR)	Retained Interest	Full Conveyance Lease	Well Trace Requirement	Split Tract	Split Tract Plat
[REDACTED] dealing in her own right	Stone Energy Corporation	12/7/2012	44.00000	44.00000	Wetzel Tyler	Magnolia Ellsworth	145A 426 600	p/o 2-1-11, 8-16-64	None	X			
Frederic Russell Killin	Stone Energy Corporation	12/26/2012	44.00000	44.00000	Wetzel Tyler	Magnolia Ellsworth	145A 427 391 335	p/o 2-1-11, 8-16-64	None	X			
Barbara Lesko Michle, dealing in her own right	Stone Energy Corporation	3/25/2013	44.00000	44.00000	Wetzel Tyler	Magnolia Ellsworth	145A 425 88 757	p/o 2-1-11, 8-16-64	None	X			
Noel W. Anderson, II, dealing in her own right	Stone Energy Corporation	2/25/2013	44.00000	44.00000	Wetzel Tyler	Magnolia Ellsworth	144A 427 301 293	p/o 2-1-11, 8-16-64	None	X			
Cheryl Bruno	Stone Energy Corporation	1/8/2013	44.00000	44.00000	Wetzel Tyler	Magnolia Ellsworth	141A 421 714 164	p/o 2-1-11, 8-16-64	None	X			
Marcy L. Ream	Stone Energy Corporation	1/29/2013	44.00000	44.00000	Wetzel Tyler	Magnolia Ellsworth	141A 421 771 176	p/o 2-1-11, 8-16-64	None	X			
William Forrest Van Camp, dealing in his own right	Stone Energy Corporation	4/15/2013	44.00000	44.00000	Wetzel Tyler	Magnolia Ellsworth	148A 435 451 240	p/o 2-1-11, 8-16-64	None	X			
Cinda Lee Weisch, dealing in her own right	Stone Energy Corporation	2/20/2013	44.00000	44.00000	Wetzel Tyler	Magnolia Ellsworth	144A 427 297 220	p/o 2-1-11, 8-16-64	None	X			
Shaun Adams, dealing in his own right	Stone Energy Corporation	4/11/2013	44.00000	44.00000	Wetzel Tyler	Magnolia Ellsworth	148A 436 698 334	p/o 2-1-11, 8-16-64	None	X			
Diane Lesko Calderone	Stone Energy Corporation	2/15/2013	44.00000	44.00000	Wetzel Tyler	Magnolia Ellsworth	144A 427 335 227	p/o 2-1-11, 8-16-64	None	X			
Gerry Killin	Stone Energy Corporation	12/21/2012	44.00000	44.00000	Wetzel Tyler	Magnolia Ellsworth	145A 427 389 353	p/o 2-1-11, 8-16-64	None	X			
William J. Johnson	Stone Energy Corporation	6/25/2013	44.00000	44.00000	Wetzel Tyler	Magnolia Ellsworth	144A 436 706 346	p/o 2-1-11, 8-16-64	None	X			
Cynthia Weltz Boyson	Stone Energy Corporation	1/30/2013	44.00000	44.00000	Wetzel Tyler	Magnolia Ellsworth	145A 426 92 1	p/o 2-1-11, 8-16-64	None	X			
Linda Toothman Watkins, a widow	Stone Energy Corporation	1/25/2013	44.00000	44.00000	Wetzel Tyler	Magnolia Ellsworth	214A 427 494 331	p/o 2-1-11, 8-16-64	None	X			
Susanne Stalnaker, dealing in her own right	Stone Energy Corporation	12/12/2012	44.00000	44.00000	Wetzel Tyler	Magnolia Ellsworth	145A 427 387 351	p/o 2-1-11, 8-16-64	None	X			
Daniel F. Yoho and Sha M. Yoho, husband and wife	PetroEdge Energy, LLC	10/16/2011	49.33000	49.33000	Tyler	Ellsworth	404 432	2-17-13	None	X			
Victor A. Conaway and Trudi H. Conaway, husband and wife	PetroEdge Energy, LLC	2/27/2012	52.00000	52.00000	Tyler	Ellsworth	399 515	p/o 2-12-16	None	X			
Carolyn Diane Myers and Randy L. Myers, wife and husband	PetroEdge Energy, LLC	2/27/2012	52.00000	52.00000	Tyler	Ellsworth	394 72	p/o 2-12-16	None	X			
James Sherwood Richmond, a widower	PetroEdge Energy LLC	10/1/2012	49.33000	49.33000	Tyler	Ellsworth	404 436	2-17-13	None	X			
Beverly Brooks, a single woman	PetroEdge Energy LLC	10/1/2012	49.33000	49.33000	Tyler	Ellsworth	404 432	2-17-13	None	X			
Karon Sue Hieflin, a widow	PetroEdge Energy LLC	10/1/2012	49.33000	49.33000	Tyler	Ellsworth	404 434	2-17-13	None	X			
Louise Fay Holden, a married woman dealing in her sole and separate property	PetroEdge Energy LLC	10/1/2012	49.33000	49.33000	Tyler	Ellsworth	404 440	2-17-13	None	X			
Norma Lee Pierce, a married woman dealing in her sole and separate property	PetroEdge Energy LLC	10/1/2012	49.33000	49.33000	Tyler	Ellsworth	404 438	2-17-13	None	X			
Janie Lou Harris, a single woman	PetroEdge Energy LLC	11/15/2012	49.33000	49.33000	Tyler	Ellsworth	404 812	2-17-13	None	X			
Linda L. Smith, a married woman dealing in her sole and separate property	PetroEdge Energy LLC	10/22/2012	49.33000	49.33000	Tyler	Ellsworth	405 723	2-17-13	None	X			

Locator	Letter	Grant Date	Lease Gross Acre	Conveyed Gross Acre	County	District	Book	Page	Conveyed Interest	Retained Interest	Full Conveyance Lease	Split Trust Instrument	Split Trust	Split Trust Plat
Ruby Joann Flowers, a single woman	PetroEdge Energy LLC	11/26/2012	49.33000	49.33000	Tyler	Ellsworth	405	728	2-17-13	None	*			
Jenny Liz Needy, a single woman	PetroEdge Energy, LLC	11/15/2012	49.33000	49.33000	Tyler	Ellsworth	405	765	2-17-13	None	*			
Robert Flowers, a married man dealing in his sole and separate property	PetroEdge Energy LLC	11/26/2012	49.33000	49.33000	Tyler	Ellsworth	405	730	2-17-13	None	*			
Shirley Ann Drake, a widow	PetroEdge Energy LLC	10/17/2012	49.33000	49.33000	Tyler	Ellsworth	406	1	2-17-13	None	*			
Bornie J. Sisley, a widow	PetroEdge Energy, LLC	1/10/2013	49.33000	49.33000	Tyler	Ellsworth	407	378	2-17-13	None	*			
Sandra Lattimer, aka Sandra Buck Lattimer, a single woman	PetroEdge Energy, LLC	1/10/2013	49.33000	49.33000	Tyler	Ellsworth	407	376	2-17-13	None	*			
Victoria Crampton, a married woman dealing in her sole and separate property	PetroEdge Energy LLC	12/10/2012	49.33000	49.33000	Tyler	Ellsworth	407	173	2-17-13	None	*			
Earl Harris, a married man dealing in his sole and separate property	PetroEdge, LLC	12/10/2012	49.33000	49.33000	Tyler	Ellsworth	407	140	2-17-13	None	*			
Shirley Homer, a/w/e Shirley Buck Homer, a married woman dealing in her sole and separate property	PetroEdge Energy, LLC	1/10/2013	49.33000	49.33000	Tyler	Ellsworth	407	374	2-17-13	None	*			
Ruth Ann Caugherty, a married woman dealing in her sole and separate property	PetroEdge Energy, LLC	1/21/2013	49.33000	49.33000	Tyler	Ellsworth	407	681	2-17-13	None	*			
Ronald A. Stollar, a married man dealing in his sole and separate property	Statoil USA Onshore Properties, Inc.	1/9/2014	49.33125	49.33125	Tyler	Ellsworth	438	682	2-17-13	None	*			
Melanie Lynn Edgar, a widow	Statoil USA Onshore Properties, Inc.	1/28/2014	49.33125	49.33125	Tyler	Ellsworth	446	832	2-17-13	None	*			
Tammy Debbitt, a married woman dealing in her sole and separate property	Statoil USA Onshore Properties, Inc.	3/21/2014	49.33125	49.33125	Tyler	Ellsworth	447	423	2-17-13	None	*			
Misty Dolin, a single woman	Statoil USA Onshore Properties, Inc.	3/21/2014	49.33125	49.33125	Tyler	Ellsworth	447	426	2-17-13	None	*			
James Dolin, a single man	Statoil USA Onshore Properties, Inc.	3/21/2014	49.33125	49.33125	Tyler	Ellsworth	447	420	2-17-13	None	*			
Estella Goodfellow, a married woman dealing in her sole and separate property	Statoil USA Onshore Properties, Inc.	1/16/2015	71.75000	71.75000	Tyler	Ellsworth	472	355	p/o 2-17-14 9, p/o 2-17-12	None	*			
David Mark Wilcox	Spartan Exploration Co.	4/4/2007	254.37000	29.66875	Tyler	Ellsworth	357	37	2-12-32, 2-17-23, 2-17-24, 2-17-24.1	All tracts not listed in the "Conveyed Interest" Column are retained		*		
David Mark Wilcox	Spartan Exploration Co.	4/4/2007	254.37000	80.70000	Tyler	Ellsworth	357	37	p/o 2-12-16, 2-17-8, 2-17-9	All tracts not listed in the "Conveyed Interest" Column are retained		*		
Philip Ronald Wilcox	Spartan Exploration Co.	4/4/2007	254.37000	29.66875	Tyler	Ellsworth	357	41	2-12-32, 2-17-23, 2-17-24, 2-17-24.1	All tracts not listed in the "Conveyed Interest" Column are retained		*		



Lessor	Lessee	Lease Date	Lease Gross Acres	Conveyed Gross Acres	County	District	Book	Page	Conveyed Interest	Retained Interest	Full Conveyance Lease	Multi Tract Instrument	Split Tract	Split Tract Plat
Andrew Haight & Plesky Haight, his wife	E H Jennings and Bros.	8/13/1898	469.00000	125.24000	Tyler	Ellsworth	39	292	2-17-45, 2-17-46, 2-23-14, 2-23-25 & p/o 2-23-28	Any tracts not listed in the "Conveyed Interest" Column or any portion of a tract depicted as "Retained" on the attached Exhibit A-1-Part 2-43		x	x	Exhibit A-1-Part 2-43
Eva Ruth Lawlis, a widow	Petroedge Energy, LLC	7/15/2013	13.00000	12.34000	Tyler	Ellsworth	423	489	p/o 2-23-16	Any tracts not listed in the "Conveyed Interest" Column or any portion of a tract depicted as "Retained" on the attached Exhibit A-1-Part 2-46			x	Exhibit A-1-Part 2-46
Bernadine Broadwater Molnar, a widow	Statoil USA Onshore Properties Inc.	7/24/2013	13.00000	12.34000	Tyler	Ellsworth	424	113	p/o 2-23-16	Any tracts not listed in the "Conveyed Interest" Column or any portion of a tract depicted as "Retained" on the attached Exhibit A-1-Part 2-46			x	Exhibit A-1-Part 2-46
Douglas Underwood, a married man dealing in his sole and separate property	Statoil USA Onshore Properties Inc.	8/29/2013	13.00000	12.34000	Tyler	Ellsworth	428	145	p/o 2-23-16	Any tracts not listed in the "Conveyed Interest" Column or any portion of a tract depicted as "Retained" on the attached Exhibit A-1-Part 2-46			x	Exhibit A-1-Part 2-46
Toni G. Jimbers, f/k/a Toni Underwood, a married woman dealing in her sole and separate property	Statoil USA Onshore Properties Inc.	8/16/2013	13.00000	12.34000	Tyler	Ellsworth	428	584	p/o 2-23-16	Any tracts not listed in the "Conveyed Interest" Column or any portion of a tract depicted as "Retained" on the attached Exhibit A-1-Part 2-46			x	Exhibit A-1-Part 2-46
Ethel Virginia Underwood, a widow, by her Attorney-in-Fact, Ralph John Underwood, Jr.	Statoil USA Onshore Properties Inc.	8/30/2013	13.00000	12.34000	Tyler	Ellsworth	428	312	p/o 2-23-16	Any tracts not listed in the "Conveyed Interest" Column or any portion of a tract depicted as "Retained" on the attached Exhibit A-1-Part 2-46			x	Exhibit A-1-Part 2-46
Ralph John Underwood, Jr., II, a married man dealing in his sole and separate property	Statoil USA Onshore Properties Inc.	8/29/2013	13.00000	12.34000	Tyler	Ellsworth	428	304	p/o 2-23-16	Any tracts not listed in the "Conveyed Interest" Column or any portion of a tract depicted as "Retained" on the attached Exhibit A-1-Part 2-46			x	Exhibit A-1-Part 2-46
Edward Earl Underwood, a single man	Statoil USA Onshore Properties Inc.	9/4/2013	13.00000	12.34000	Tyler	Ellsworth	428	200	p/o 2-23-16	Any tracts not listed in the "Conveyed Interest" Column or any portion of a tract depicted as "Retained" on the attached Exhibit A-1-Part 2-46			x	Exhibit A-1-Part 2-46

NOV 16 2022  
 10:41 AM  
 State of Texas  
 Department of State

Lessor	Lessee	Lease Date	Lease Gross Acres	Conveyed Gross Acres	County	District	Book	Page	Conveyed Interest	Retained Interest	Full Conveyance Lease	Multi Tract Instrument	Split Tract	Split Tract Plat
Donald Lee Underwood, a married man dealing in his sole and separate property	Statoil USA Onshore Properties Inc.	8/31/2013	13.00000	12.34000	Tyler	Ellsworth	428	228	p/o 2-23-16	Any tracts not listed in the "Conveyed Interest" Column or any portion of a tract depicted as "Retained" on the attached Exhibit A-1-Part 2-46			x	Exhibit A-1-Part 2-46
Fred Utle, a widow	Statoil USA Onshore Properties Inc.	8/20/2013	13.00000	12.34000	Tyler	Ellsworth	428	320	p/o 2-23-16	Any tracts not listed in the "Conveyed Interest" Column or any portion of a tract depicted as "Retained" on the attached Exhibit A-1-Part 2-46			x	Exhibit A-1-Part 2-46
Beverly Rudberg, a single woman	Statoil USA Onshore Properties Inc.	8/29/2013	13.00000	12.34000	Tyler	Ellsworth	428	168	p/o 2-23-16	Any tracts not listed in the "Conveyed Interest" Column or any portion of a tract depicted as "Retained" on the attached Exhibit A-1-Part 2-46			x	Exhibit A-1-Part 2-46
Opal Mae Kuntz, a married woman dealing in her sole and separate property	Statoil USA Onshore Properties Inc.	9/4/2013	13.00000	12.34000	Tyler	Ellsworth	426	202	p/o 2-23-16	Any tracts not listed in the "Conveyed Interest" Column or any portion of a tract depicted as "Retained" on the attached Exhibit A-1-Part 2-46			x	Exhibit A-1-Part 2-46
Ralph F. Wilson, a widower	Statoil USA Onshore Properties Inc.	9/12/2013	13.00000	12.34000	Tyler	Ellsworth	431	272	p/o 2-23-16	Any tracts not listed in the "Conveyed Interest" Column or any portion of a tract depicted as "Retained" on the attached Exhibit A-1-Part 2-46			x	Exhibit A-1-Part 2-46
Vicki Underwood, a married woman dealing in her sole and separate property	Statoil USA Onshore Properties Inc.	8/29/2013	13.00000	12.34000	Tyler	Ellsworth	431	229	p/o 2-23-16	Any tracts not listed in the "Conveyed Interest" Column or any portion of a tract depicted as "Retained" on the attached Exhibit A-1-Part 2-46			x	Exhibit A-1-Part 2-46
Mary A. Bassaro, a married woman dealing in her sole and separate property	Statoil USA Onshore Properties Inc.	9/11/2013	13.00000	12.34000	Tyler	Ellsworth	431	254	p/o 2-23-16	Any tracts not listed in the "Conveyed Interest" Column or any portion of a tract depicted as "Retained" on the attached Exhibit A-1-Part 2-46			x	Exhibit A-1-Part 2-46
Jennifer L. Parfitt, a married woman dealing in her sole and separate property	Statoil USA Onshore Properties Inc.	9/10/2013	13.00000	12.34000	Tyler	Ellsworth	431	256	p/o 2-23-16	Any tracts not listed in the "Conveyed Interest" Column or any portion of a tract depicted as "Retained" on the attached Exhibit A-1-Part 2-46			x	Exhibit A-1-Part 2-46

Lessor	Lessee	Lease Date	Lease Gross Acres	Conveyed Gross Acres	County	District	Book	Page	Conveyed Interest	Retained Interest	Full Conveyed Lease	MOU Tract Instrument	Split Tract	Split Tract Plat
Joyce Ann Wilson, a widow	Statoil USA Onshore Properties Inc.	9/12/2013	13.00000	12.34000	Tyler	Elsworth	431	270	p/o 2-23-16	Any tracts not listed in the "Conveyed Interest" Column or any portion of a tract depicted as "Retained" on the attached Exhibit A-1-Part 2-46			x	Exhibit A-1-Part 2-46
Rosemarie Whitney, a married woman dealing in her sole and separate property	Statoil USA Onshore Properties Inc.	9/12/2013	13.00000	12.34000	Tyler	Elsworth	431	266	p/o 2-23-16	Any tracts not listed in the "Conveyed Interest" Column or any portion of a tract depicted as "Retained" on the attached Exhibit A-1-Part 2-46			x	Exhibit A-1-Part 2-46
Mary Kay Campbell, a married woman dealing in her sole and separate property	Statoil USA Onshore Properties Inc.	9/12/2013	13.00000	12.34000	Tyler	Elsworth	431	268	p/o 2-23-16	Any tracts not listed in the "Conveyed Interest" Column or any portion of a tract depicted as "Retained" on the attached Exhibit A-1-Part 2-46			x	Exhibit A-1-Part 2-46
Kathryn J. Phillips, f/w/a Kathryn Jean (Kittie) Wilson, a married woman dealing in her sole and separate property	Statoil USA Onshore Properties Inc.	9/12/2013	13.00000	12.34000	Tyler	Elsworth	431	261	p/o 2-23-16	Any tracts not listed in the "Conveyed Interest" Column or any portion of a tract depicted as "Retained" on the attached Exhibit A-1-Part 2-46			x	Exhibit A-1-Part 2-46
Cynthia I. Goodyear, a married woman dealing in her sole and separate property	Statoil USA Onshore Properties Inc.	9/10/2013	13.00000	12.34000	Tyler	Elsworth	431	254	p/o 2-23-16	Any tracts not listed in the "Conveyed Interest" Column or any portion of a tract depicted as "Retained" on the attached Exhibit A-1-Part 2-46			x	Exhibit A-1-Part 2-46
Mary A. Bassard, a married woman dealing in her sole and separate property	Statoil USA Onshore Properties Inc.	9/11/2013	15.50000	4.43000	Tyler	Elsworth	432	553	p/o 2-23-17	Any tracts not listed in the "Conveyed Interest" Column or any portion of a tract depicted as "Retained" on the attached Exhibit A-1-Part 2-47			x	Exhibit A-1-Part 2-47
Jet Conroy Gill, a married man dealing in his sole and separate property	Statoil USA Onshore Properties Inc.	10/14/2013	104.00000	56.91000	Tyler	Elsworth	435	202	2-17-39, 2, 2-17-47, 2-17-48	Any tracts not listed in the "Conveyed Interest" Column or any portion of a tract depicted as "Retained" on the attached Exhibit A-1-Part 2-41 and Exhibit A-1-Part 2-42			x	Exhibit A-1-Part 2-41 and Exhibit A-1-Part 2-42
Ronald Underwood, a married man dealing in his sole and separate property	Statoil USA Onshore Properties Inc.	8/29/2013	13.00000	12.34000	Tyler	Elsworth	435	1	p/o 2-23-16	Any tracts not listed in the "Conveyed Interest" Column or any portion of a tract depicted as "Retained" on the attached Exhibit A-1-Part 2-46			x	Exhibit A-1-Part 2-46



Lessor	Lessee	Lease Date	Lease Gross Acres	Conveyed Gross Acres	County	District	Book	Page	Conveyed Interest	Retained Interest	Full Conveyance Lease	Multi Tract Instrument	Split Tract	Split Tract Plat
Katie Underwood, a single woman	Statoil USA Onshore Properties Inc.	9/20/2013	13.00000	12.34000	Tyler	Ellsworth	435	11	p/o 2-23-16	Any tracts not listed in the "Conveyed Interest" Column or any portion of a tract depicted as "Retained" on the attached Exhibit A-1-Part 2-46			x	Exhibit A-1-Part 2-46
Margaret Jeanne Wells, f/k/a Margaret Jeanne Gill, a married woman dealing in her sole and separate property	Statoil USA Onshore Properties Inc.	10/18/2013	104.00000	56.91000	Tyler	Ellsworth	436	162	2-17-39.2, 2-17-47, 2-17-48	Any tracts not listed in the "Conveyed Interest" Column or any portion of a tract depicted as "Retained" on the attached Exhibit A-1-Part 2-41 and Exhibit A-1-Part 2-42			x	Exhibit A-1-Part 2-41 and Exhibit A-1-Part 2-42
Ivey Castleberry, a married woman dealing in her sole and separate property	Statoil USA Onshore Properties Inc.	9/19/2013	13.00000	12.34000	Tyler	Ellsworth	437	163	p/o 2-23-16	Any tracts not listed in the "Conveyed Interest" Column or any portion of a tract depicted as "Retained" on the attached Exhibit A-1-Part 2-46			x	Exhibit A-1-Part 2-46
Johanna Tustin, a widow	Statoil USA Onshore Properties Inc.	12/5/2013	104.00000	56.91000	Tyler	Ellsworth	438	795	2-17-39.2, 2-17-48	Any tracts not listed in the "Conveyed Interest" Column or any portion of a tract depicted as "Retained" on the attached Exhibit A-1-Part 2-41			x	Exhibit A-1-Part 2-41
Mary A. Bassaro, a married woman dealing in her sole and separate property	EQT Production Company	11/7/2018	13.00000	12.34000	Tyler	Ellsworth	628	69	p/o 2-23-16	Any tracts not listed in the "Conveyed Interest" Column or any portion of a tract depicted as "Retained" on the attached Exhibit A-1-Part 2-46			x	Exhibit A-1-Part 2-46
Bernadine Broadwater Molnar, a widow	EQT Production Company	12/20/2018	13.00000	12.34000	Tyler	Ellsworth	631	712	p/o 2-23-16	Any tracts not listed in the "Conveyed Interest" Column or any portion of a tract depicted as "Retained" on the attached Exhibit A-1-Part 2-46			x	Exhibit A-1-Part 2-46

END OF EXHIBIT A

# EXHIBIT A-1-Part 2-41

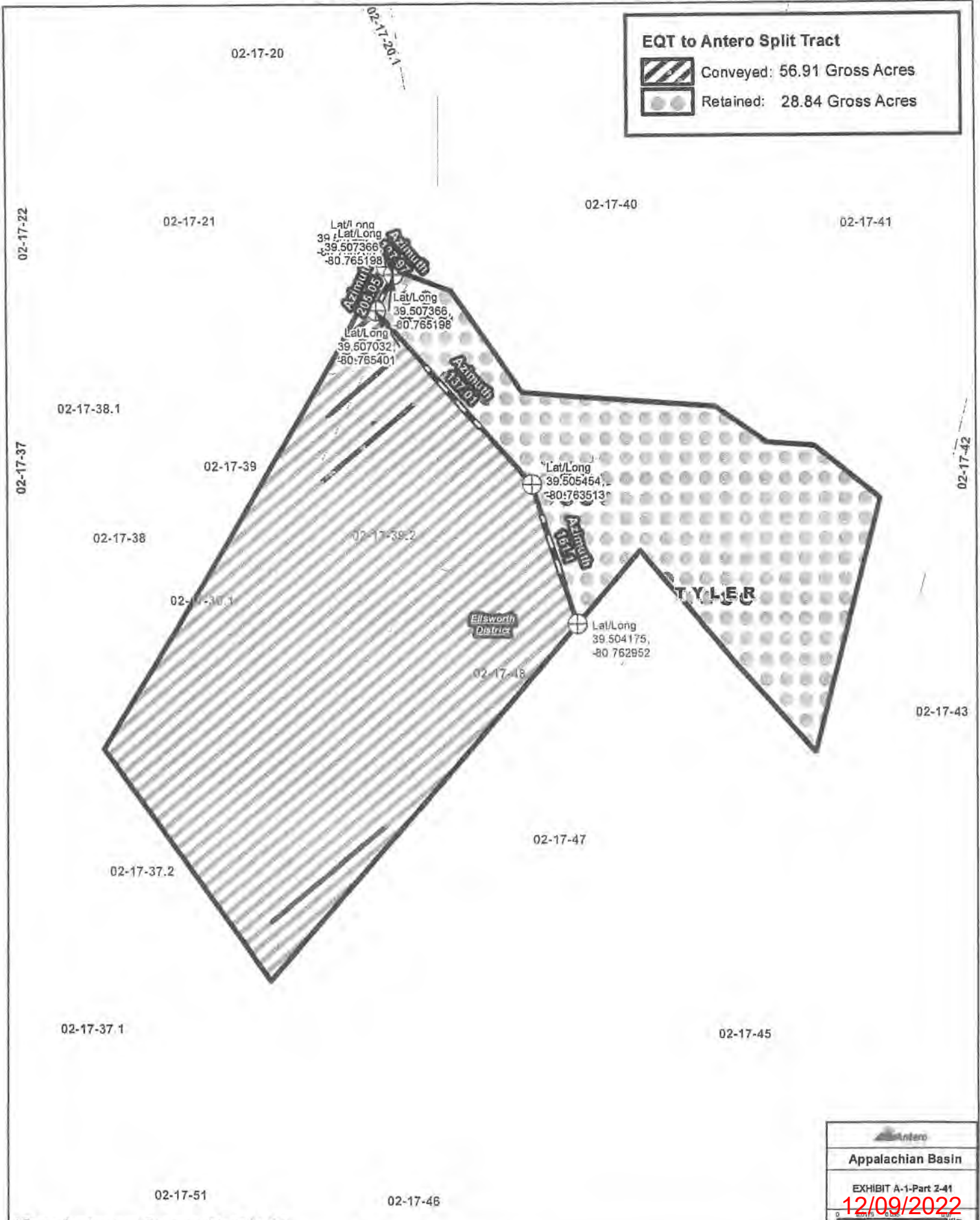

**EQT to Antero Split Tract**

- Conveyed: 56.91 Gross Acres
- Retained: 28.84 Gross Acres

Lat/Long  
39.507366,  
-80.765198

Azimuth  
205.05

Lat/Long  
39.507366,  
-80.765198

Lat/Long  
39.507032,  
-80.765401

Azimuth  
137.01

Lat/Long  
39.505454,  
-80.763513

Azimuth  
161.1

Lat/Long  
39.504175,  
-80.762952

Ellsworth  
District

**TYLER**

Antero

**Appalachian Basin**

EXHIBIT A-1-Part 2-41

**12/09/2022**

10/23/2022 Created by: bstrange

\*Coordinates are Geographic NAD27

# EXHIBIT A-1-Part 2-42

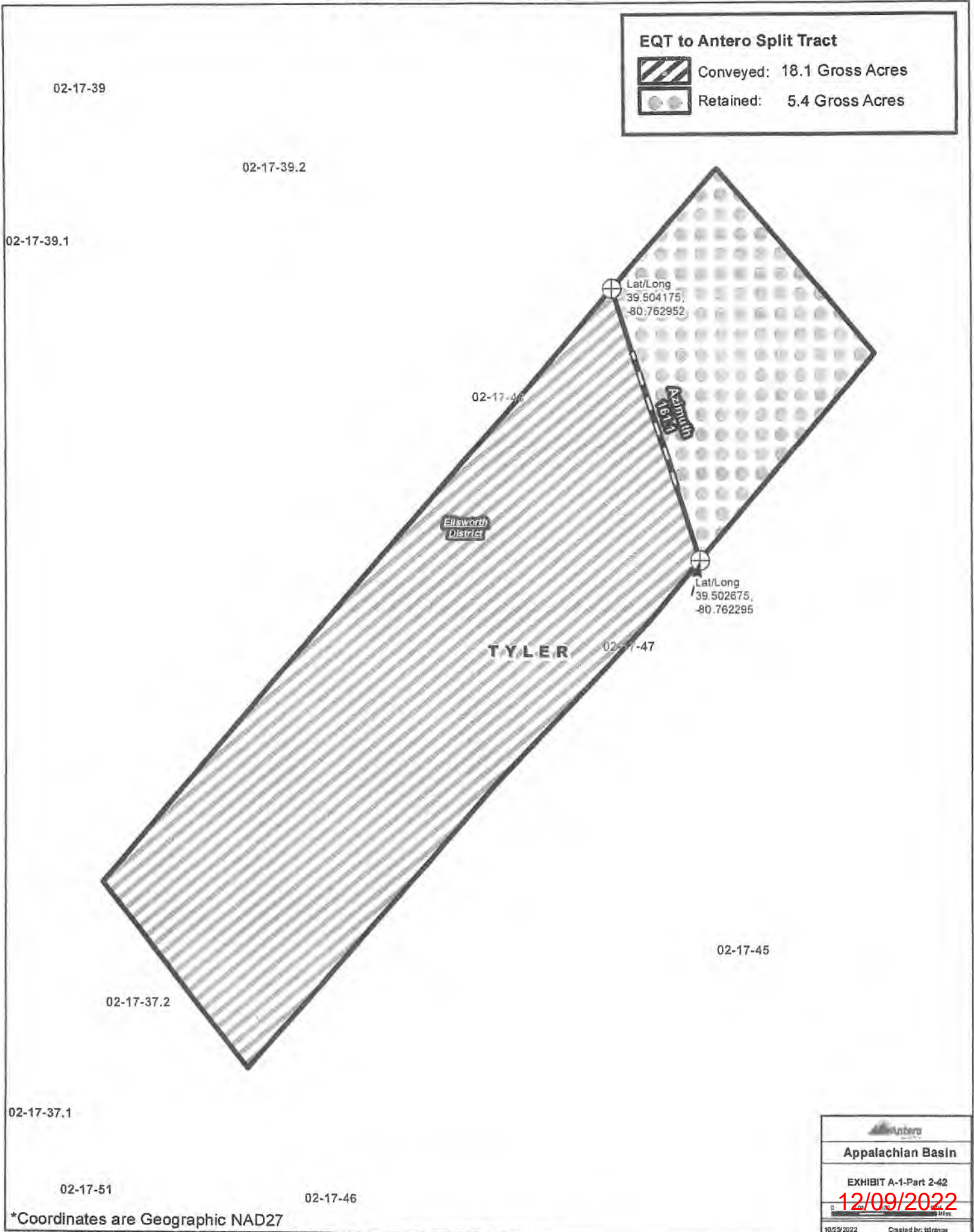

\*Coordinates are Geographic NAD27



<b>Appalachian Basin</b>	
EXHIBIT A-1-Part 2-42	
12/09/2022	
10/29/2022	Created by: lstrange





# EXHIBIT A-1-Part 2-46

### EQT to Antero Split Tract

-  Conveyed: 12.34 Gross Acres
-  Retained: 0.66 Gross Acres

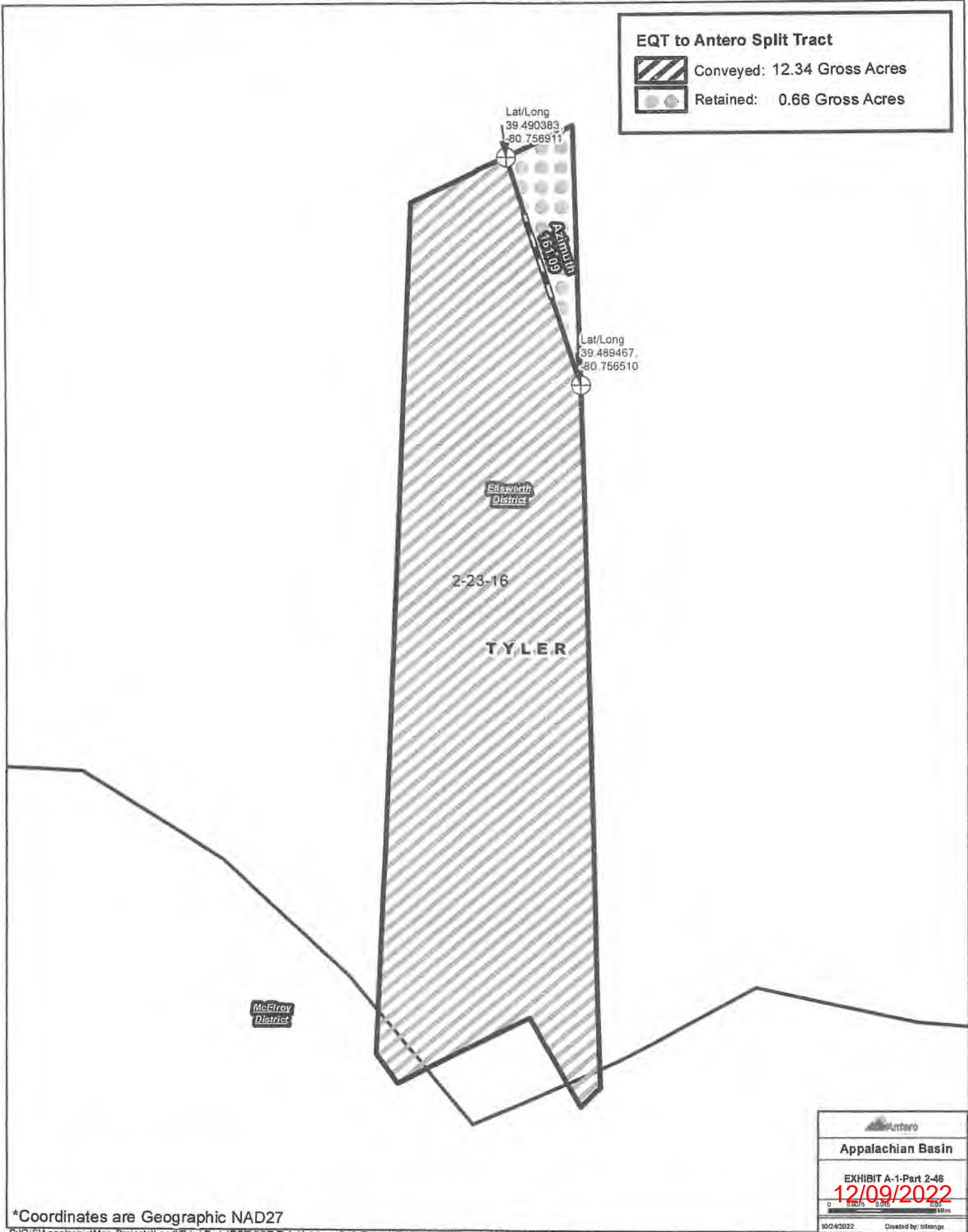

\*Coordinates are Geographic NAD27

Antero  
 Appalachian Basin  
 EXHIBIT A-1-Part 2-46  
 12/09/2022  
 0 0.005 0.015 0.030 Miles  
 10/24/2022 Created by: tsrange

# EXHIBIT A-1-Part 2-47

### EQT to Antero Split Tract



Conveyed: 4.41 Gross Acres

Retained: 11.09 Gross Acres

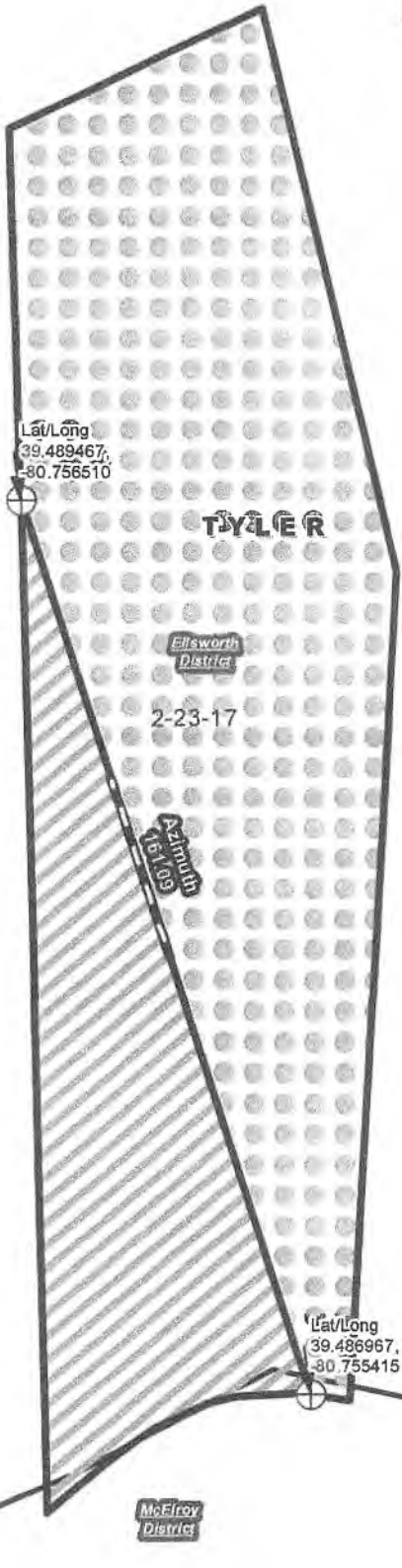

\*Coordinates are Geographic NAD27

<b>Appalachian Basin</b>
EXHIBIT A-1-Part 2-47
<b>12/09/2022</b>
10/24/2022 Created by: strange



**Certificate Of Completion**

Envelope Id: 9EA133045A8D475C928BA9CF7EA95B96

Status: Completed

Subject: Complete with DocuSign: Compiled (Antero-EQT) Permission to Antero to Permit and Drill Executio...

Source Envelope:

Document Pages: 17

Signatures: 1

Envelope Originator:

Certificate Pages: 2

Initials: 2

Jarred Detweiler

AutoNav: Enabled

625 Liberty Ave Ste 1700

EnvelopeId Stamping: Enabled

Pittsburgh, PA 15222

Time Zone: (UTC-05:00) Eastern Time (US & Canada)

jdetweiler@eqt.com

IP Address: 100.6.91.42

**Record Tracking**

Status: Original

Holder: Jarred Detweiler

Location: DocuSign

11/8/2022 7:09:43 AM

jdetweiler@eqt.com

**Signer Events**

Jarred Detweiler

jdetweiler@eqt.com

Landman IV

EQT Corporation

Security Level: Email, Account Authentication (None)

**Signature**



**Timestamp**

Sent: 11/8/2022 7:11:57 AM

Viewed: 11/8/2022 7:12:09 AM

Signed: 11/8/2022 7:12:14 AM

Signature Adoption: Pre-selected Style

Using IP Address: 136.226.48.251

**Electronic Record and Signature Disclosure:**  
Not Offered via DocuSign

Matt Eller

meller@eqt.com

Land BD Director

EQT Corporation

Security Level: Email, Account Authentication (None)

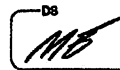

Sent: 11/8/2022 7:12:17 AM

Viewed: 11/8/2022 7:15:27 AM

Signed: 11/8/2022 1:04:31 PM

Signature Adoption: Pre-selected Style

Using IP Address: 136.226.51.4

**Electronic Record and Signature Disclosure:**  
Not Offered via DocuSign

Corey Peck

cpeck@eqt.com

Managing Director - Land Ops

EQT Corporation

Security Level: Email, Account Authentication (None)

DocuSigned by:  
  
839B4A94E0C848A...

Sent: 11/8/2022 1:04:34 PM

Viewed: 11/8/2022 1:47:46 PM

Signed: 11/8/2022 1:48:06 PM

Signature Adoption: Pre-selected Style

Using IP Address: 174.203.111.19

Signed using mobile

**Electronic Record and Signature Disclosure:**  
Not Offered via DocuSign

**In Person Signer Events**

**Signature**

**Timestamp**

**Editor Delivery Events**

**Status**

**Timestamp**

**Agent Delivery Events**

**Status**

**Timestamp**

**Intermediary Delivery Events**

**Status**

**Timestamp**

**Certified Delivery Events**

**Status**

**Timestamp**

**Carbon Copy Events**

**Status**

**Timestamp**

**Witness Events****Signature****Timestamp****Notary Events****Signature****Timestamp****Envelope Summary Events****Status****Timestamps**

Envelope Sent

Hashed/Encrypted

11/8/2022 7:11:57 AM

Certified Delivered

Security Checked

11/8/2022 1:47:46 PM

Signing Complete

Security Checked

11/8/2022 1:48:06 PM

Completed

Security Checked

11/8/2022 1:48:06 PM

**Payment Events****Status****Timestamps**



Stansberry, Wade A &lt;wade.a.stansberry@wv.gov&gt;

---

**Modification Horizontal H6A Well Work Permit API : (47-095-02798, 47-095-02803, & 47-095-02804)**

1 message

**Stansberry, Wade A** <wade.a.stansberry@wv.gov>

Wed, Dec 7, 2022 at 12:05 PM

To: Mallory Stanton &lt;mstanton@anteroresources.com&gt;, sgaspar@anteroresources.com, Dani DeVito &lt;ddevito@shalepro.com&gt;, ljackson@wvassessor.com, Stephen E McCoy &lt;stephen.e.mccoy@wv.gov&gt;

Attached is the newly issued permits:



**47-095-02804 - FORSTER UNIT 2H**  
**47-095-02803 - FORSTER UNIT 1H**  
**47-095-02798 - ATWOOD UNIT 1H**

These will serve as your copy.

Thank you,

**Wade A. Stansberry****Environmental Resource Specialist 3****West Virginia Department of Environmental Protection****Office of Oil & Gas****601 57th St. SE****Charleston, WV 25304****(304) 926-0499 ext. 41115****(304) 926-0452 fax****[Wade.A.Stansberry@wv.gov](mailto:Wade.A.Stansberry@wv.gov)**

---

**3 attachments** **47-095-02803 - mod.pdf**  
1937K **47-095-02804 - mod.pdf**  
1982K **47-095-02798 - mod.pdf**  
1936K**12/09/2022**