

8,624' to Bottom Hole

2,031' to Top Hole

TOP HOLE LATITUDE 39 - 27 - 30
BTM HOLE LATITUDE 39 - 25 - 00

Antero Resources Well No. Little 1H

Antero Resources Corporation



Proposed Well No.
Little Unit 1H



Notes
West Virginia Coordinate System of 1927, North Zone based upon Differential GPS Measurements.
Well No. Little Unit 1H Top Hole coordinates are
N: 339,069.60" Latitude: 39°25'16.10"
E: 1,574,228.87" Longitude: 81°00'25.88"
Bottom Hole coordinates are
N: 326,774.97" Latitude: 39°23'15.42"
E: 1,579,208.22" Longitude: 80°59'19.84"
UTM Zone 17, NAD 1983
Top Hole Coordinates Bottom Hole Coordinates
N: 4,363,521.219m N: 4,359,800.991m
E: 499,395.640m E: 500,975.148m
Plat orientation and corner and well references are based upon the grid north meridian.
Well location references are based upon the magnetic meridian.

TOP HOLE LONGITUDE 81 - 00 - 00
BTM HOLE LONGITUDE 80 - 57 - 30

10,581' to Bottom Hole
13,547' to Top Hole

Well Location References

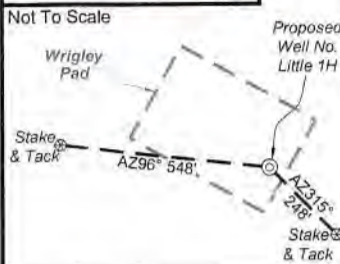

Notes:
Well No. Little Unit 1H UTM Zone 17, NAD 1927
Top Hole Coordinates
N: 14,315,272.60"
E: 1,638,386.31"
Point of Entry Coordinates
N: 14,313,838.87"
E: 1,639,614.10"
Bottom Hole Coordinates
N: 14,303,067.07"
E: 1,643,568.43"

Wellhead Layout (NTS)

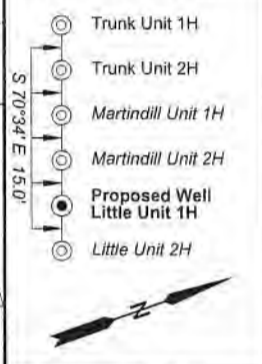

I, the undersigned, hereby certify that this plat is correct to the best of my knowledge and belief and shows all the information required by law and the rules issued and prescribed by the Department of Environmental Protection.

Bradley D. Miller
Bradley D. Miller, P.S. 2167



GRID NORTH

Note: 8 water wells were found within 2000' of proposed well. No occupied dwellings or buildings 2,500 square feet or larger used to house or shelter dairy cattle or poultry husbandry are located within 625' of the center of the well pad.

Bearing	Dist.
L1 S 78°04' E	2,450.4'
L2 S 05°51' W	1,449.1'
L3 N 19°39' W	1,804.7'
L4 N 56°04' E	1,723.4'
L5 S 39°37' E	1,888.3'



- Legend**
- Proposed gas well
 - Monument, as noted
 - Existing Well, as noted
 - Digitized Well, as noted
 - Creek or Drain
 - Road
 - Surface boundary (approx.)
 - Interior surface tracts (approx.)
 - County Line

FILE NO: 125-54-M-22
DRAWING NO: Little Unit 1H Well Plat
SCALE: 1" = 2000'
MINIMUM DEGREE OF ACCURACY: Submeter
PROVEN SOURCE OF ELEVATION: WVDOT, Harrisville, WV

STATE OF WEST VIRGINIA
DEPARTMENT OF ENVIRONMENTAL PROTECTION
OIL AND GAS DIVISION

DATE: July 20 2022
OPERATOR'S WELL NO. Little Unit 1H
API WELL NO
47 - 095 - 02811
STATE COUNTY PERMIT

WELL TYPE: OIL GAS LIQUID INJECTION WASTE DISPOSAL
(IF GAS) PRODUCTION: STORAGE DEEP SHALLOW
LOCATION: ELEVATION: Proposed 937' Existing 964' WATERSHED: Outlet Middle Island Creek QUADRANGLE: TH:Bens Run BH:Middlebourne
DISTRICT: Meade COUNTY: Tyler 09/02/2022
SURFACE OWNER: Shirley J. Wells & Arnold L. Schulberg Oil & Gas Trust; Steven L. & Jeral A. McGowan; Ronal Grimes, et ux; William C. & Rebecca Doty; Wilma Jane Benefiel; David C. Henderson; John E. Grimes, Jr., et ux ACREAGE: 53.85 63.95937; 140; 228.798; 50; 31
ROYALTY OWNER: Greenbrier Royalty Fund II, LLC; Mary C. Robinson Living Trust; LEASE NO: ACREAGE: 26.38; 100; 61.3875
PROPOSED WORK: DRILL CONVERT DRILL DEEPER FRACTURE OR STIMULATE PLUG OFF OLD FORMATION
 PERFORATE NEW FORMATION OTHER PHYSICAL CHANGE IN WELL (SPECIFY)
 PLUG AND ABANDON CLEAN OUT AND REPLUG TARGET FORMATION: Marcellus Shale ESTIMATED DEPTH: 6,600' TVD 20,600' MD

WELL OPERATOR: Antero Resources Corporation DESIGNATED AGENT: Dianna Stamper - CT Corporation System
ADDRESS: 1615 Wynkoop Street ADDRESS: 5400 D Big Tyler Road
Denver, CO 80202 Charleston, WV 25313

**Antero Resources
Well No. Little 1H**

Antero Resources Corporation



ID	TM/Par	Owner	Bk/Pg	Acres
1	7-2	Shirley J. Wells & Susie Cunningham	W41/317	53.85
2	7-3	Harry E., Jr. & Noreen M. West	328/530	88.00
3	7-8	John Wells	428/412	52.39
4	7-4	Marcia A. Hill	506/479	74.50
5	7-23	David Henderson & Sharley Shortridge	W47/263	16.07
6	7-12	Wilma Jane (Benefiel) Wagner	W35/225	110.30
7	7-9	Russell G. & Ruth M. Smith Family Trust	541/608	66.85
8	7-19	Darlene Henderson	W47/263	122.83
9	7-9.1	Russell E. & Janice Smith	332/234	1.65
10	7-13.1	Russell E. & Janice Smith	328/867	2.60
11	7-12.2	Gary W. Freeland	336/530	19.97
12	7-12.1	Gary W. Freeland	251/546	8.73
13	7-19.1/2	Kenneth G. Hall	555/34	0.45
14	7A-9	Jerry Irvin, Jr. & Linda Sue Lowther	568/361	2.00
15	7A-1	Trevor L. & Marinia M. Tallman	547/710	2.97
16	7A-1.1	Thaddeus R. & Deborah A. Biedrzycki	504/359	4.44
17	7-24	Ronald Wayne & Frances A. Grimes	335/304	50.00
18	7-19	Darlene Henderson	W47/263	122.83
19	7-22	Thaddeus R. & Deborah A. Biedrzycki	581/74	31.00
20	10-38	John E. Jr. & Mary Catherine Grimes	335/312	26.38
21	10-5	Thaddeus R. & Deborah A. Biedrzycki	349/513	44.73
22	10-8	David Henderson & Sharley Shortridge	W47/263	44.28
23	10-7	David Henderson & Sharley Shortridge	W47/263	41.00
24	10-9	Charles L. & Laura McGowan, et al	348/320	61.51
25	10-23	BB Farm Investments LLC	594/417	66.69
26	10-18	Lyle A. Jackson, et al	348/697	18.31
27	10-22	Clayton Hill	321/409	15.00
28	10-20	Lyle A. Jackson, et al	348/697	56.88
29	10-34	Dale A. & Melanie L. Proctor	642/567	43.55

Leases	
A	Greenbrier Royalty Fund II LLC
B	Harry E. West, Jr.
C	Mary C. Robinson Living Trust
D	Shirley Smith
E	David C. Henderson
F	Wilma Jane Benefiel
G	Theresa L. Wilson
H	Shirly Ann Smith
I	Jerry Irvin, Jr. & Linda S. Lowther
J	Kerr-McGee Oil & Gas Onshore LP
K	Ronald Grimes, et ux
L	William C. Doty & Rebecca Doty
M	John E. Grimes, Jr., et ux
N	Ridgetop Royalties, LLC
O	Steven L. & Jeral A. McGowan
P	Arnold L. Schulberg Oil & Gas Trust
Q	Edith Ulrich Smith
R	Robert R. Osterland, et ux

FILE NO: 125-54-M-22
 DRAWING NO: Little Unit 1H Well Plat
 SCALE: 1" = 2000'
 MINIMUM DEGREE OF ACCURACY:
Submeter
 PROVEN SOURCE OF ELEVATION:
WVDOT, Harrisville, WV

STATE OF WEST VIRGINIA
 DEPARTMENT OF ENVIRONMENTAL PROTECTION
OIL AND GAS DIVISION

DATE: July 20 2022
 OPERATOR'S WELL NO. Little Unit 1H
 API WELL NO
47 — 095 — 02811
 STATE COUNTY PERMIT

WELL TYPE: OIL GAS LIQUID INJECTION WASTE DISPOSAL
 (IF GAS) PRODUCTION: STORAGE DEEP SHALLOW

LOCATION: ELEVATION: Proposed 937' Existing 964' WATERSHED: Middle Island Creek QUADRANGLE: TH:Bens Run
BH:Middlebourne

DISTRICT: Meade COUNTY: Tyler **09/02/2022**

SURFACE OWNER: Shirley J. Wells & Arnold L. Schulberg Oil & Gas Trust; Steven L. & Jeral A. McGowan;
Suise Cunningham Ronald Grimes, et ux; William C. & Rebecca Doty;
Wilma Jane Benefiel; David C. Henderson; John E. Grimes, Jr., et ux ACREAGE: 53.85 63.95937; 140;
 ROYALTY OWNER: Greenbrier Royalty Fund II, LLC; Mary C. Robinson Living Trust; LEASE NO: _____ 228.798; 50; 31

PROPOSED WORK: DRILL CONVERT DRILL DEEPER FRACTURE OR STIMULATE PLUG OFF OLD FORMATION
 PERFORATE NEW FORMATION OTHER PHYSICAL CHANGE IN WELL (SPECIFY) _____

PLUG AND ABANDON CLEAN OUT AND REPLUG TARGET FORMATION: Marcellus Shale ESTIMATED DEPTH: 6,600' TVD
20,600' MD

WELL OPERATOR: Antero Resources Corporation DESIGNATED AGENT: Dianna Stamper - CT Corporation System
 ADDRESS: 1615 Wynkoop Street ADDRESS: 5400 D Big Tyler Road
Denver, CO 80202 Charleston, WV 25313

**Antero Resources
Well No. Little 1H**

Antero Resources Corporation

8,624' to Bottom Hole

2,031' to Top Hole

TOP HOLE LATITUDE 39 - 27 - 30
BTM HOLE LATITUDE 39 - 25 - 00



Proposed Well No. Little Unit 1H

Capped Rebar

47-095-0617

2" Pipe

POE L5

47-095-0489

BTM Hole 7.5' Spot

Little Unit 1H Bottom Hole

500' Buffer

Top Hole 7.5' Spot

Notes
West Virginia Coordinate System of 1927, North Zone based upon Differential GPS Measurements. Well No. Little Unit 1H Top Hole coordinates are N: 339,069.60' Longitude: 81°00'25.88" E: 1,574,228.87' Bottom Hole coordinates are N: 326,774.97' Longitude: 80°59'19.84" E: 1,579,208.22' UTM Zone 17, NAD 1983
Top Hole Coordinates N: 4,363,521.219m E: 499,395.640m
Bottom Hole Coordinates N: 4,359,800.991m E: 500,975.148m
Plat orientation and corner and well references are based upon the grid north meridian. Well location references are based upon the magnetic meridian.

TOP HOLE LONGITUDE 81 - 00 - 00
BTM HOLE LONGITUDE 80 - 57 - 30

13,547' to Top Hole

10,581' to Bottom Hole

Well Location References

Not To Scale

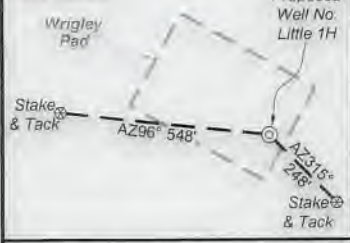

I, the undersigned, hereby certify that this plat is correct to the best of my knowledge and belief and shows all the information required by law and the rules issued and prescribed by the Department of Environmental Protection.

Bradley D. Miller, P.S. 2167



Note: 8 water wells were found within 2000' of proposed well. No occupied dwellings or buildings 2,500 square feet or larger used to house or shelter dairy cattle or poultry husbandry are located within 625' of the center of the well pad.

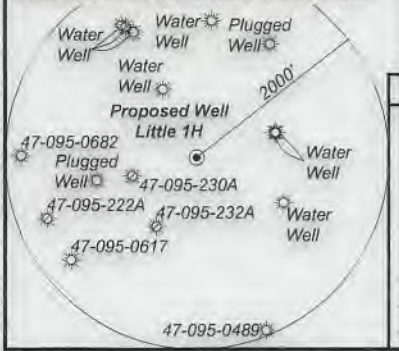

Bearing	Dist.
L1 S 78°04' E	2,450.4'
L2 S 05°51' W	1,449.1'
L3 N 19°39' W	1,804.7'
L4 N 56°04' E	1,723.4'
L5 S 39°37' E	1,888.3'

- Legend**
- Proposed gas well
 - Monument, as noted
 - Existing Well, as noted
 - Digitized Well, as noted
 - Creek or Drain
 - Road
 - Surface boundary (approx.)
 - Interior surface tracts (approx.)
 - County Line

Notes:
Well No. Little Unit 1H UTM Zone 17, NAD 1927
Top Hole Coordinates N: 14,315,272.60' E: 1,638,386.31'
Point of Entry Coordinates N: 14,313,838.87' E: 1,639,614.10'
Bottom Hole Coordinates N: 14,303,067.07' E: 1,643,568.43'

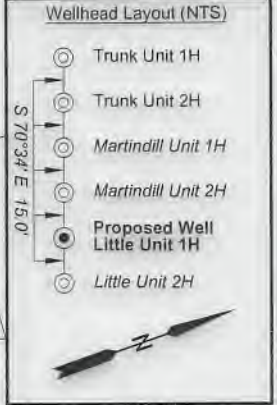

FILE NO: 125-54-M-22
DRAWING NO: Little Unit 1H Well Plat
SCALE: 1" = 2000'
MINIMUM DEGREE OF ACCURACY: Submeter
PROVEN SOURCE OF ELEVATION: WVDOT, Harrisville, WV

**STATE OF WEST VIRGINIA
DEPARTMENT OF ENVIRONMENTAL PROTECTION
OIL AND GAS DIVISION**

DATE: July 20 2022
OPERATOR'S WELL NO. Little Unit 1H
API WELL NO
47 - 095 - 02811
STATE COUNTY PERMIT

WELL TYPE: OIL GAS LIQUID INJECTION WASTE DISPOSAL
(IF GAS) PRODUCTION: STORAGE DEEP SHALLOW
LOCATION: ELEVATION: Existing 964' Proposed 937' WATERSHED: Middle Island Creek QUADRANGLE: TH:Bens Run BH:Middlebourne
DISTRICT: Meade COUNTY: Tyler 09/02/2022
SURFACE OWNER: Shirley J. Wells & Arnold L. Schulberg Oil & Gas Trust; Steven L. & Jeral A. McGowan; Ronald Grimes, et ux; William C. & Rebecca Doty; Wilma Jane Benefiel; David C. Henderson; John E. Grimes, Jr., et ux ACREAGE: 53.85 63.95937, 140; 228.798, 50; 31
ROYALTY OWNER: Greenbrier Royalty Fund II, LLC; Mary C. Robinson Living Trust; LEASE NO: ACREAGE: 26.38; 100; 61.3875
PROPOSED WORK: DRILL CONVERT DRILL DEEPER FRACTURE OR STIMULATE PLUG OFF OLD FORMATION
 PERFORATE NEW FORMATION OTHER PHYSICAL CHANGE IN WELL (SPECIFY) _____
 PLUG AND ABANDON CLEAN OUT AND REPLUG TARGET FORMATION: Marcellus Shale ESTIMATED DEPTH: 6,600' TVD 20,600' MD

WELL OPERATOR: Antero Resources Corporation DESIGNATED AGENT: Dianna Stamper - CT Corporation System
ADDRESS: 1615 Wynkoop Street ADDRESS: 5400 D Big Tyler Road
Denver, CO 80202 Charleston, WV 25313

**Antero Resources
Well No. Little 1H**

Antero Resources Corporation



ID	TM/Par	Owner	Bk/Pg	Acres
1	7-2	Shirley J. Wells & Susie Cunningham	W41/317	53.85
2	7-3	Harry E., Jr. & Noreen M. West	328/530	88.00
3	7-8	John Wells	428/412	52.39
4	7-4	Marcia A. Hill	506/479	74.50
5	7-23	David Henderson & Sharley Shortridge	W47/263	16.07
6	7-12	Wilma Jane (Benefiel) Wagner	W35/225	110.30
7	7-9	Russell G. & Ruth M. Smith Family Trust	541/608	66.85
8	7-19	Darlene Henderson	W47/263	122.83
9	7-9.1	Russell E. & Janice Smith	332/234	1.65
10	7-13.1	Russell E. & Janice Smith	328/867	2.60
11	7-12.2	Gary W. Freeland	336/530	19.97
12	7-12.1	Gary W. Freeland	251/546	8.73
13	7-19.1/2	Kenneth G. Hall	555/34	0.45
14	7A-9	Jerry Irvin, Jr. & Linda Sue Lowther	568/361	2.00
15	7A-1	Trevor L. & Marinia M. Tallman	547/710	2.97
16	7A-1.1	Thaddeus R. & Deborah A. Biedrzycki	504/359	4.44
17	7-24	Ronald Wayne & Frances A. Grimes	335/304	50.00
18	7-19	Darlene Henderson	W47/263	122.83
19	7-22	Thaddeus R. & Deborah A. Biedrzycki	581/74	31.00
20	10-38	John E. Jr. & Mary Catherine Grimes	335/312	26.38
21	10-5	Thaddeus R. & Deborah A. Biedrzycki	349/513	44.73
22	10-8	David Henderson & Sharley Shortridge	W47/263	44.28
23	10-7	David Henderson & Sharley Shortridge	W47/263	41.00
24	10-9	Charles L. & Laura McGowan, et al	348/320	61.51
25	10-23	BB Farm Investments LLC	594/417	66.69
26	10-18	Lyle A. Jackson, et al	348/697	18.31
27	10-22	Clayton Hill	321/409	15.00
28	10-20	Lyle A. Jackson, et al	348/697	56.88
29	10-34	Dale A. & Melanie L. Proctor	642/567	43.55

Leases	
A	Greenbrier Royalty Fund II LLC
B	Harry E. West, Jr.
C	Mary C. Robinson Living Trust
D	Shirley Smith
E	David C. Henderson
F	Wilma Jane Benefiel
G	Thereasa L. Wilson
H	Shirly Ann Smith
I	Jerry Irvin, Jr. & Linda S. Lowther
J	Kerr-McGee Oil & Gas Onshore LP
K	Ronald Grimes, et ux
L	William C. Doty & Rebecca Doty
M	John E. Grimes, Jr., et ux
N	Ridgetop Royalties, LLC
O	Steven L. & Jeral A. McGowan
P	Arnold L. Schulberg Oil & Gas Trust
Q	Edith Ulrich Smith
R	Robert R. Osterland, et ux

FILE NO: 125-54-M-22
 DRAWING NO: Little Unit 1H Well Plat
 SCALE: 1" = 2000'
 MINIMUM DEGREE OF ACCURACY:
 Submeter
 PROVEN SOURCE OF ELEVATION:
 WVDOT, Harrisville, WV

STATE OF WEST VIRGINIA
 DEPARTMENT OF ENVIRONMENTAL PROTECTION
OIL AND GAS DIVISION

DATE: July 20 20 22
 OPERATOR'S WELL NO. Little Unit 1H
 API WELL NO
 47 - 095 - 02811
 STATE COUNTY PERMIT

WELL TYPE: OIL GAS LIQUID INJECTION WASTE DISPOSAL
 (IF GAS) PRODUCTION: STORAGE DEEP SHALLOW

LOCATION: ELEVATION: Proposed 937' Existing 964' WATERSHED: Outlet Middle Island Creek QUADRANGLE: TH:Bens Run BH:Middlebourne

DISTRICT: Meade COUNTY: Tyler
 SURFACE OWNER: Shirley J. Wells & Arnold L. Schulberg Oil & Gas Trust; Steven L. & Jeral A. McGowan. 57,375;
 Suise Cunningham Ronald Grimes, et ux; William C. & Rebecca Doty; 63.95937; 140;
 ROYALTY OWNER: Greenbrier Royalty Fund II, LLC; Mary C. Robinson Living Trust; Wilma Jane Benefiel; David C. Henderson; John E. Grimes, Jr., et ux 228.798; 50; 31
 LEASE NO: ACREAGE: 26.38; 100; 61.3875

PROPOSED WORK: DRILL CONVERT DRILL DEEPER FRACTURE OR STIMULATE PLUG OFF OLD FORMATION
 PERFORATE NEW FORMATION OTHER PHYSICAL CHANGE IN WELL (SPECIFY)

PLUG AND ABANDON CLEAN OUT AND REPLUG TARGET FORMATION: Marcellus Shale ESTIMATED DEPTH: 6,600' TVD 20,600' MD

WELL OPERATOR: Antero Resources Corporation DESIGNATED AGENT: Dianna Stamper - CT Corporation System
 ADDRESS: 1615 Wynkoop Street ADDRESS: 5400 D Big Tyler Road
 Denver, CO 80202 Charleston, WV 25313

09/02/2022

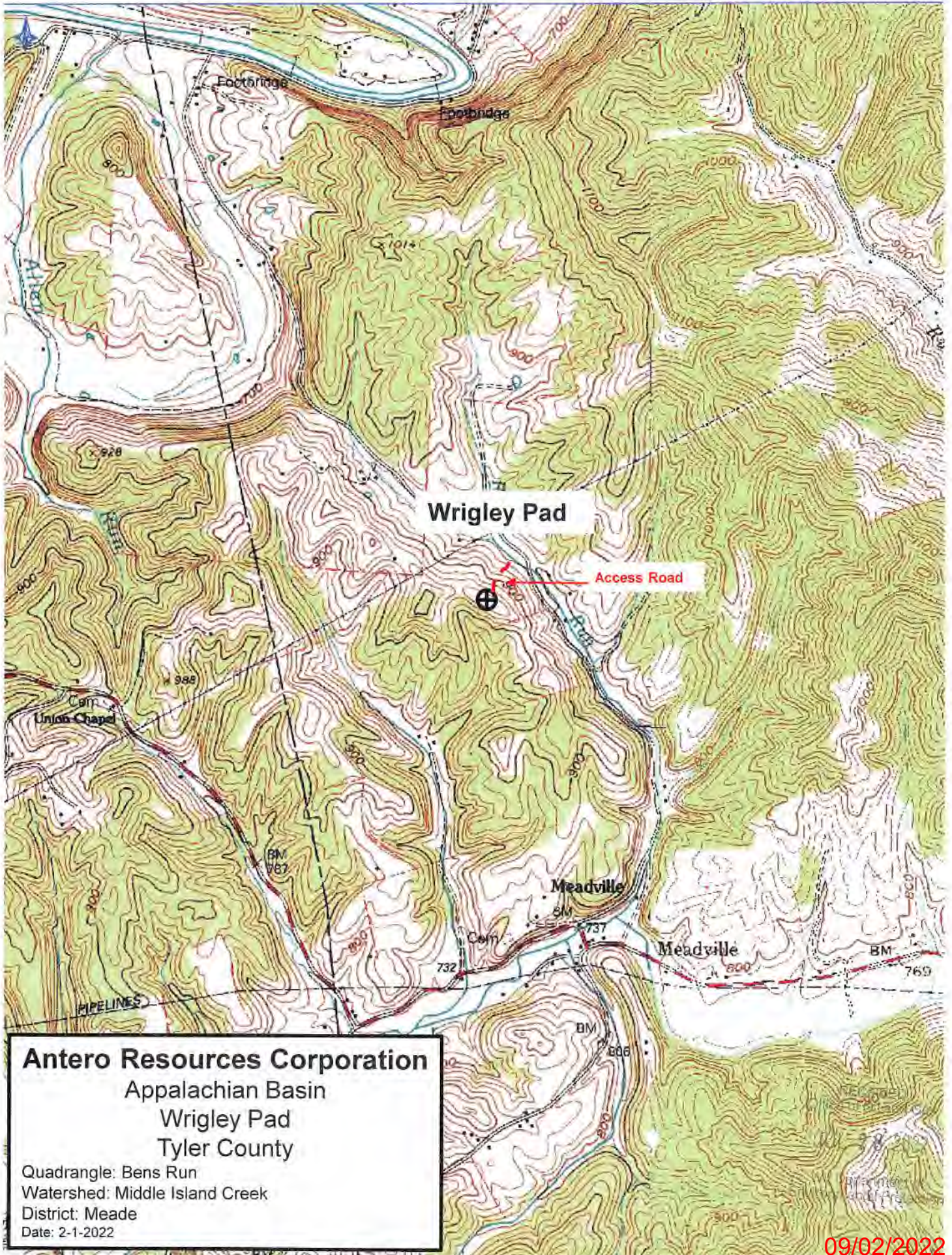

Antero Resources Corporation
Appalachian Basin
Wrigley Pad
Tyler County

Quadrangle: Bens Run
Watershed: Middle Island Creek
District: Meade
Date: 2-1-2022