

Antero Resources
Well No. Little 2H
BHL MOD
 Antero Resources Corporation

2,017' to Top Hole
 TOP HOLE LATITUDE 39 - 27 - 30
 BTM HOLE LATITUDE 39 - 25 - 00



Proposed Well No. Little Unit 2H

Little Unit 2H

Capped Rebar

2" Pipe

47-095-0617

47-095-0489

47-095-02073

47-095-02815

47-095-02816

47-095-02813

47-095-02814

47-095-02811

Proposed Well Little Unit 2H (47-095-02812)

Notes
 West Virginia Coordinate System of 1927, North Zone based upon Differential GPS Measurements. Well No. Little Unit 2H Top Hole coordinates are N: 339,064.62' Latitude: 39°25'16.06" E: 1,574,243.02' Longitude: 81°00'25.70" Bottom Hole coordinates are N: 327,094.84' Latitude: 39°23'18.74" E: 1,580,177.55' Longitude: 80°59'07.57" UTM Zone 17, NAD 1983
 Top Hole Coordinates Bottom Hole Coordinates
 N: 4,363,519.774m N: 4,359,903.379m
 E: 499,399.976m E: 501,268.827m
 Plat orientation and corner and well references are based upon the grid north meridian. Well location references are based upon the magnetic meridian.

Notes:
 Well No. Little Unit 2H UTM Zone 17, NAD 1927
 Top Hole Coordinates
 N: 14,315,267.85'
 E: 1,638,400.53'
 Point of Entry Coordinates
 N: 14,314,358.63'
 E: 1,640,640.43'
 Bottom Hole Coordinates
 N: 14,303,402.96'
 E: 1,644,531.94'

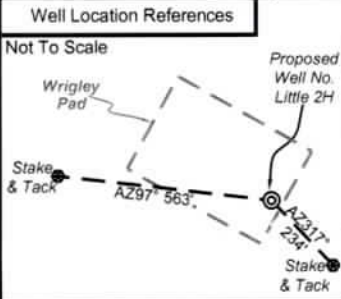

I, the undersigned, hereby certify that this plat is correct to the best of my knowledge and belief and shows all the information required by law and the rules issued and prescribed by the Department of Environmental Protection.

Bradley D. Miller
 Bradley D. Miller, P.S. 2167

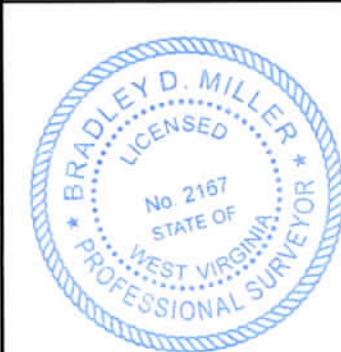

Note: 8 water wells were found within 2000' of proposed well. No occupied dwellings or buildings 2,500 square feet or larger used to house or shelter dairy cattle or poultry husbandry are located within 625' of the center of the well pad.

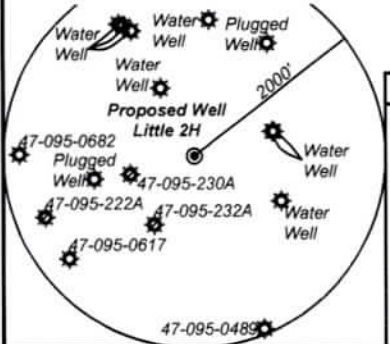

Bearing	Dist.
L1 S 78°02' E	2,465.3'
L2 S 05°17' W	1,452.7'
L3 N 19°16' W	1,795.3'
L4 N 56°28' E	1,732.4'
L5 S 66°57' E	2,418.2'

- Legend**
- Proposed gas well
 - ⊙ Monument, as noted
 - ⊛ Existing Well, as noted
 - ⊚ Digitized Well, as noted
 - Creek or Drain
 - Road
 - Surface boundary (approx.)
 - Interior surface tracts (approx.)
 - County Line

FILE NO: 125-54-M-22
 DRAWING NO: Little Unit 2H Well Plat
 SCALE: 1" = 2000'
 MINIMUM DEGREE OF ACCURACY: Submeter
 PROVEN SOURCE OF ELEVATION: WVDOT, Harrisville, WV

STATE OF WEST VIRGINIA
 DEPARTMENT OF ENVIRONMENTAL PROTECTION
OIL AND GAS DIVISION

DATE: October 27 2022
 OPERATOR'S WELL NO. Little Unit 2H
 API WELL NO
 47 - 095 - 02812
 STATE COUNTY PERMIT

WELL TYPE: OIL GAS LIQUID INJECTION WASTE DISPOSAL
 (IF GAS) PRODUCTION: STORAGE DEEP SHALLOW
 LOCATION: ELEVATION: Proposed 937' Existing 964' WATERSHED: Outlet Middle Island Creek QUADRANGLE: TH:Bens Run BH:Middlebourne 57.375; 77.09; 86.325; 20.774; 86.325; 20.774; 50; 26.38; 42.81; 61.3875; 71.18
 DISTRICT: Meade COUNTY: Tyler
 SURFACE OWNER: Shirley J. Wells & John E. Grimes, Jr., et ux; Diane Whitehall; Steven L. & Jeral A. McGowan; David C. Henderson; Antero Minerals, LLC; Ronald Grimes, et ux; ACREAGE: 53.85
 ROYALTY OWNER: Greenbrier Royalty Fund II, LLC; Mary C. Robinson Living Trust; Harry E. West, Jr. LEASE NO: _____ ACREAGE: 50; 26.38; 42.81; 61.3875; 71.18
 PROPOSED WORK: DRILL CONVERT DRILL DEEPER FRACTURE OR STIMULATE PLUG OFF OLD FORMATION
 PERFORATE NEW FORMATION OTHER PHYSICAL CHANGE IN WELL (SPECIFY) BHL MOD
 PLUG AND ABANDON CLEAN OUT AND REPLUG TARGET FORMATION: Marcellus Shale ESTIMATED DEPTH: 21,300' MD 6,400' TVD

WELL OPERATOR: Antero Resources Corporation DESIGNATED AGENT: Dianna Stamper - CT Corporation System
 ADDRESS: 1615 Wynkoop Street ADDRESS: 5400 D Big Tyler Road
 Denver, CO 80202 Charleston, WV 25313

TOP HOLE LONGITUDE 81 - 00 - 00
 BTM HOLE LONGITUDE 80 - 57 - 30
 10,245' to Bottom Hole
 13,552' to Top Hole



ID	TM/Par	Owner	Bk/Pg	Acres
1	7-2	Shirley J. Wells & Susie Cunningham	W41/317	53.85
2	7-3	Harry E., Jr. & Noreen M. West	328/530	88.00
3	7-8	John Wells	428/412	52.39
4	7-4	Marcia A. Hill	506/479	74.50
5	7-23	David Henderson & Sharley Shortridge	W47/263	16.07
6	7-9	Russell G. & Ruth M. Smith Family Trust	541/608	66.85
7	7-9.1	Russell E. & Janice Smith	332/234	1.65
8	7-13	Russell E. & Janice Smith	328/867	6.00
9	7-13.1	Russell E. & Janice Smith	328/867	2.60
10	7-19	Darlene Henderson	W47/263	122.83
11	7-24	Ronald Wayne & Frances A. Grimes	335/304	50.00
12	7-24.1	Lloyd C. & Charlene R. Adams	335/309	2.00
13	7-24.2	Lloyd C. & Charlene R. Adams	218/258	0.82
14	7-15	Elizabeth Gorrell	321/360	242.50
15	10-38	John E. Jr. & Mary Catherine Grimes	335/312	26.38
16	10-8	David Henderson & Sharley Shortridge	W47/263	44.28
17	10-10	Mark Layne & Lori Helmick	262/135	42.81
18	10-9	Charles L. & Laura McGowan, et al	348/320	61.51
19	10-23	BB Farm Investments LLC	594/417	66.69
20	10-18	Lyle A. Jackson, et al	348/697	18.31
21	10-17	Lyle A. Jackson, et al	348/697	18.00
22	10-16	Lyle A. Jackson, et al	355/311	71.18
23	10-20	Lyle A. Jackson, et al	348/697	56.88

Leases	
A	Greenbrier Royalty Fund II LLC
B	Harry E. West, Jr.
C	Mary C. Robinson Living Trust
D	Shirley Smith
E	Thereasa L. Wilson
F	Shirley Ann Smith
G	David C. Henderson
H	Ronald Grimes, et ux
I	Antero Minerals, LLC
J	Vickie Gorrell, et al
K	John E. Grimes, Jr., et ux
L	Diane Whitehall
M	Steven L. & Jeral A. McGowan
N	Arnold L. Schulberg Oil & Gas Trust
O	Scott L. & Bernadine Jackson
P	Edith Ulrich Smith

FILE NO: 125-54-M-22
 DRAWING NO: Little Unit 2H Well Plat
 SCALE: 1" = 2000'
 MINIMUM DEGREE OF ACCURACY:
Submeter
 PROVEN SOURCE OF ELEVATION:
WVDOT, Harrisville, WV



DATE: October 27 2022
 OPERATOR'S WELL NO. Little Unit 2H
 API WELL NO
47 - 095 - 02812
 STATE COUNTY PERMIT

WELL TYPE: OIL GAS LIQUID INJECTION WASTE DISPOSAL
 (IF GAS) PRODUCTION: STORAGE DEEP SHALLOW

LOCATION: ELEVATION: Proposed 937' Existing 964' WATERSHED: Outlet Middle Island Creek QUADRANGLE: TH:Bens Run BH:Middlebourne

DISTRICT: Meade COUNTY: Tyler 11/25/2022

SURFACE OWNER: Shirley J. Wells & Suise Cunningham ACREAGE: 53.85 8.47 228.798 2.821 50 26.38 42.81 61.3875 71.18

ROYALTY OWNER: Greenbrier Royalty Fund II, LLC; Mary C. Robinson Living Trust; Harry E. West, Jr. LEASE NO: _____ ACREAGE: _____

PROPOSED WORK: DRILL CONVERT DRILL DEEPER FRACTURE OR STIMULATE PLUG OFF OLD FORMATION
 PERFORATE NEW FORMATION OTHER PHYSICAL CHANGE IN WELL (SPECIFY) BHL MOD

PLUG AND ABANDON CLEAN OUT AND REPLUG TARGET FORMATION: Marcellus Shale ESTIMATED DEPTH: 21,300' MD 6,400' TVD

WELL OPERATOR: Antero Resources Corporation DESIGNATED AGENT: Dianna Stamper - CT Corporation System
 ADDRESS: 1615 Wynkoop Street ADDRESS: 5400 D Big Tyler Road
Denver, CO 80202 Charleston, WV 25313