

**Antero Resources
Well No. Leap 1H**

Antero Resources Corporation



6,352' to Top Hole

3,269' to Bottom Hole

TOP HOLE LATITUDE 39 - 35 - 00
BTM HOLE LATITUDE 39 - 37 - 30

Notes
West Virginia Coordinate System of 1927, North Zone based upon Differential GPS Measurements.
Well No. Leap Unit 1H Top Hole coordinates are
N: 382,769.41' Latitude: 39°32'34.82"
E: 1,617,646.15' Longitude: 80°51'21.08"
Bottom Hole coordinates are
N: 398,660.50' Latitude: 39°35'10.81"
E: 1,610,634.44' Longitude: 80°52'53.70"
UTM Zone 17, NAD 1983
Top Hole Coordinates Bottom Hole Coordinates
N: 4,377,055.762m N: 4,381,861.375m
E: 512,400.693m E: 510,183.860m
Plat orientation and corner and well references are based upon the grid north meridian.
Well location references are based upon the magnetic meridian.

BTM HOLE LONGITUDE 80 - 52 - 30
TOP HOLE LONGITUDE 80 - 50 - 00

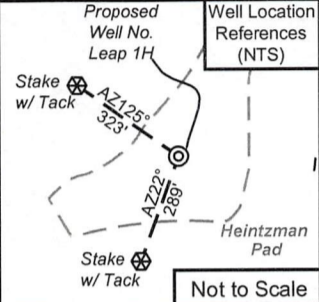

I, the undersigned, hereby certify that this plat is correct to the best of my knowledge and belief and shows all the information required by law and the rules issued and prescribed by the Department of Environmental Protection.

Bradley D. Miller
Bradley D. Miller, P.S. 2167

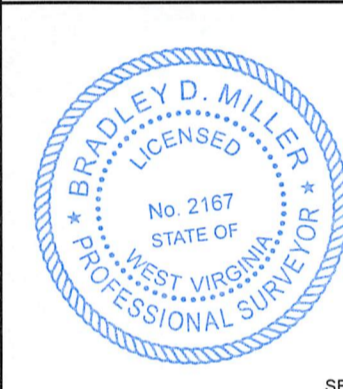

Notes:
Well No. Leap Unit 1H
UTM Zone 17, NAD 1927
Top Hole Coordinates
N: 14,359,675.87'
E: 1,681,053.34'
Point of Entry Coordinates
N: 14,360,366.62'
E: 1,678,984.92'
Bottom Hole Coordinates
N: 14,375,442.33'
E: 1,673,779.79'

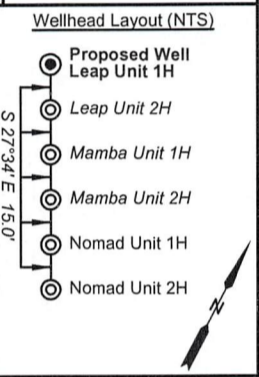

	Bearing	Dist.
L1	S 35°29' E	2,364.9'
L2	S 06°01' W	2,255.0'
L3	S 29°57' W	856.6'
L4	N 05°11' W	447.8'
L5	N 70°35' W	2,181.5'

- Legend**
- Proposed gas well
 - Monument, as noted
 - Existing Well, as noted
 - Digitized Well, as noted
 - Creek or Drain
 - Road
 - Surface boundary (approx.)
 - Interior surface tracts (approx.)
 - County Line

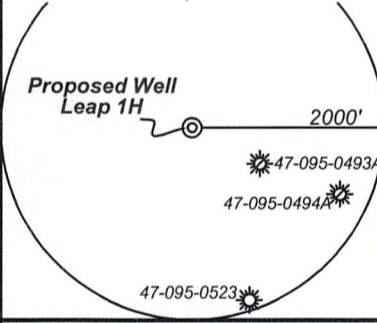

FILE NO: 77-54-E-22
DRAWING NO: Leap Unit 1H Well Plat
SCALE: 1" = 2000'
MINIMUM DEGREE OF ACCURACY: Submeter
PROVEN SOURCE OF ELEVATION: WVDOT, Harrisville, WV

STATE OF WEST VIRGINIA
DEPARTMENT OF ENVIRONMENTAL PROTECTION
OIL AND GAS DIVISION

DATE: August 12 2022
OPERATOR'S WELL NO. Leap Unit 1H
API WELL NO
47 - 095 - 02318
STATE COUNTY PERMIT

WELL TYPE: OIL GAS LIQUID INJECTION WASTE DISPOSAL
(IF GAS) PRODUCTION: STORAGE DEEP SHALLOW

LOCATION: ELEVATION: Proposed 1193' Outlet Existing 1215' Middle Island Creek TH:Porter Falls BH:Paden City
DISTRICT: Ellsworth/Magnolia Joel Potts III; Robert D. Wetzel
SURFACE OWNER: Dennis & Clista Heintzman Sara Ann Midcap; Will E. Morris Heirs Trust; Lowmax R. Kunkel;
ROYALTY OWNER: BRC Appalachian Minerals I, LLC (2); Dennis R. & Clista Heintzman; LARRY R. & Kim M. Henthorn; Waco Oil & Gas Co. Inc.; Antero Minerals, LLC;
PROPOSED WORK: DRILL CONVERT DRILL DEEPER FRACTURE OR STIMULATE PLUG OFF OLD FORMATION
 PERFORATE NEW FORMATION OTHER PHYSICAL CHANGE IN WELL (SPECIFY) _____
 PLUG AND ABANDON CLEAN OUT AND REPLUG TARGET FORMATION: Marcellus Shale ESTIMATED DEPTH: 7,100' TVD 26,000' MD

WELL OPERATOR: Antero Resources Corporation DESIGNATED AGENT: Dianna Stamper - CT Corporation System
ADDRESS: 1615 Wynkoop Street ADDRESS: 5400 D Big Tyler Road
Denver, CO 80202 Charleston, WV 25313

09/23/2022

**Antero Resources
Well No. Leap 1H**

Antero Resources Corporation



Detail 1 (NTS)

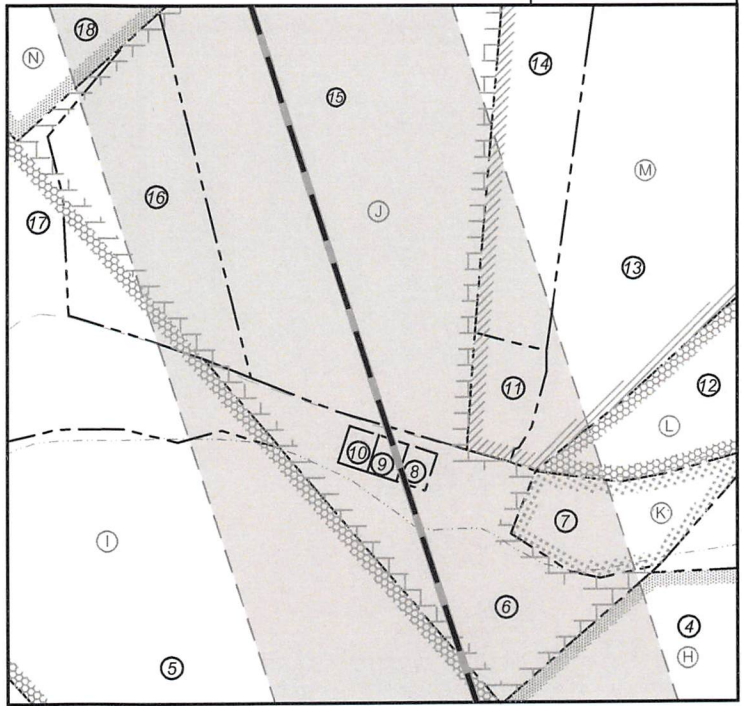

Leases	
A	BRC Appalachian Minerals I, LLC
B	Rose Enterprises, LLC
C	Dennis R. & Clista A. Heintzman
D	Nina A. Whitefield
E	Larry R. and Kim M. Henthorn
F	Waco Oil and Gas Co. Inc.
G	BRC Appalachian Minerals I, LLC
H	Judy P. Meyers
I	Antero Minerals, LLC
J	Larry F. Hughes
K	Michael L. West, et ux
L	Linda J. & Jack E. Mason
M	Paula Sue Porfeli
N	Gary A. Midcap, et ux
O	Ruth E. VanCamp Estate
P	Ruth E. VanCamp Estate
Q	Gary A. Midcap, et ux
R	Sara Ann Midcap
S	Linda Allen
T	Will E. Morris Heirs Trust
U	Gary A. Midcap, et ux
V	Lowmax R. Kunkel
W	Joel Potts III
X	Robert D. Wetzel
Y	Bounty Minerals, LLC

ID	TM/Par	Owner	Bk/Pg	Acres
1	6-36	Dennis & Clista Heintzman	297/640	417.60
2	10-4	Stefan L. & Alberta B. Smolski	356/467	56.08
3	6-49	Dennis & Clista A. Heintzman	297/637	45.00
4	6-26	Ronnie L. VanCamp, et al	670/641	23.00
5	6-25.2	Joshua M. & Crystal L. Rocchio	543/206	32.00
6	6-17.3	Tracy Postlethwait	354/74	3.00
7	6-17.2	Michael L. & Donna S. West	243/175	2.66
8	6-52	Juanita A. Morgan, et al	296/313	0.18
9	6-51	Juanita A. Morgan, et al	296/313	0.18
10	6-50	Juanita A. Morgan, et al	296/313	0.18
11	6-18.1	Maxine M. Ankrom	362/75	1.16
12	6-19	Linda J. & Jack E. Mason	OR101/678	10.00
13	6-18	Kirk Family Trust	511/171	39.00
14	6-18.2	Kirk Family Trust	511/169	11.00
15	6-17.1	Larry Henthorn	560/660	25.00
16	6-17	William McClain	297/87	10.24
17	6-25	William L. McClain	253/323	11.87
18	6-6	Gary A. & Penny K. Midcap	301/265	100.00
19	3-26.1	Gary A. & Penny K. Midcap	301/265	40.00
20	3-32	Gary A. & Penny K. Midcap	301/265	38.09
21	6-5	Gary A. & Penny K. Midcap	301/265	75.55
22	3-42	Rosalie B. Henry	362/339	27.00
23	3-26	Gary Midcap	318/496	50.00
24	3-24	Gary A. & Penny K. Midcap	301/265	66.50
25	3-18	Gary Midcap	322/108	80.33
26	3-13	Lomax R. Kunkel	297/692	63.50
27	3-8	Steven D. & Brenda M. Higgins	313/623	67.00
28	16-67	Robert D. Wetzel	404/372	82.06
29	16-61.1	Robert D. Wetzel	184/351	3.00
30	16-61	Kenneth W. & Norma A. Headley	355/347	41.75

FILE NO: 77-54-E-22
 DRAWING NO: Leap Unit 1H Well Plat
 SCALE: 1" = 2000'
 MINIMUM DEGREE OF ACCURACY:
 Submeter
 PROVEN SOURCE OF ELEVATION:
 WVDOT, Harrisville, WV

STATE OF WEST VIRGINIA
 DEPARTMENT OF ENVIRONMENTAL PROTECTION
OIL AND GAS DIVISION

DATE: August 12 2022
 OPERATOR'S WELL NO. Leap Unit 1H
 API WELL NO
 47 - 095 - 02818
 STATE COUNTY PERMIT

WELL TYPE: OIL GAS LIQUID INJECTION WASTE DISPOSAL
 (IF GAS) PRODUCTION: STORAGE DEEP SHALLOW

LOCATION: ELEVATION: Existing 1215' Proposed 1193' WATERSHED: Middle Island Creek Outlet: QUADRANGLE: BH: Paden City TH: Porter Falls

DISTRICT: Ellsworth/Magnolia COUNTY: Tyler/Wetzel
 SURFACE OWNER: Dennis & Clista Heintzman
 ROYALTY OWNER: BRC Appalachian Minerals I, LLC (2); Dennis R. & Clista Heintzman; LEASE NO: ACREAGE: 66.5; 63.3125; 67

PROPOSED WORK: DRILL CONVERT DRILL DEEPER FRACTURE OR STIMULATE PLUG OFF OLD FORMATION
 PERFORATE NEW FORMATION OTHER PHYSICAL CHANGE IN WELL (SPECIFY) _____ 7,100' TVD
 PLUG AND ABANDON CLEAN OUT AND REPLUG TARGET FORMATION: Marcellus Shale ESTIMATED DEPTH: 26,000' MD

WELL OPERATOR: Antero Resources Corporation DESIGNATED AGENT: Dianna Stamper - CT Corporation System
 ADDRESS: 1615 Wynkoop Street ADDRESS: 5400 D Big Tyler Road
 Denver, CO 80202 Charleston, WV 25313

09/23/2022

4709502818

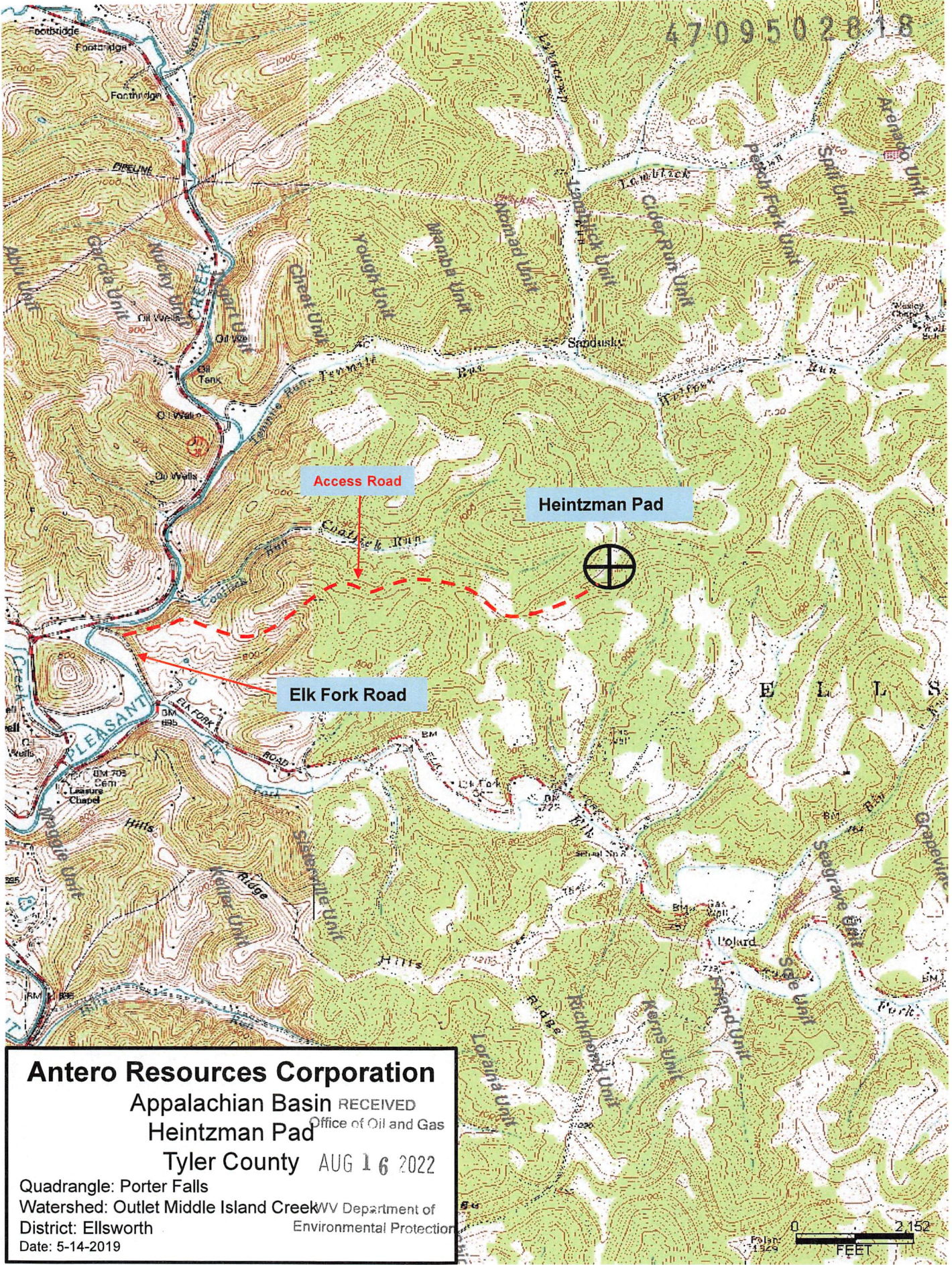

Antero Resources Corporation
 Appalachian Basin RECEIVED
 Heintzman Pad Office of Oil and Gas
 Tyler County AUG 16 2022
 Quadrangle: Porter Falls
 Watershed: Outlet Middle Island Creek WV Department of
 District: Ellsworth Environmental Protection
 Date: 5-14-2019



09/23/2022