

Antero Resources
Well No. Leap 1H
As-Drilled
 Antero Resources Corporation



Top Hole Coordinates, As-drilled data, and information was provided by Antero Resources Corporation. Allegheeny Surveys Inc. (ASI) is not certifying the data and information provided. ASI is not responsible for any errors or inaccuracies with the data and information that has been provided.

I, the undersigned, hereby certify that this plat is correct to the best of my knowledge and belief and shows all the information required by law and the rules issued and prescribed by the Department of Environmental Protection.

Bradley D. Miller
 Bradley D. Miller, P.S. 2167



Note: 0 water wells or springs were found within 2000' of proposed well. No occupied dwellings or buildings 2,500 square feet or larger used to house or shelter dairy cattle or poultry husbandry are located within 625' of the center of the well pad.

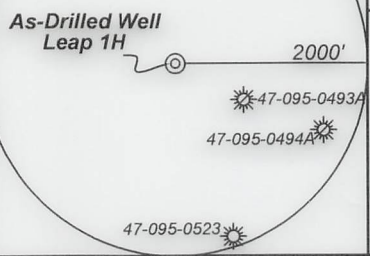

	Bearing	Dist.
L1	S 35°30' E	2,364.5'
L2	S 06°01' W	2,254.5'
L3	S 29°58' W	856.2'
L4	N 05°12' W	448.3'

- Legend**
- As-Drilled gas well
 - Monument, as noted
 - Existing Well, as noted
 - Digitized Well, as noted
 - Creek or Drain
 - Road
 - Surface boundary (approx.)
 - Interior surface tracts (approx.)
 - County Line



6,352' to Top Hole
 3,279' to Bottom Hole

TOP HOLE LATITUDE 39 - 35 - 00
BTM HOLE LATITUDE 39 - 37 - 30

Notes
 West Virginia Coordinate System of 1927, North Zone based upon Differential GPS Measurements.
 Well No. Leap Unit 1H Top Hole coordinates are
 N: 382,769.93" Latitude: 39°32'34.82"
 E: 1,617,646.07" Longitude: 80°51'21.08"
 Bottom Hole coordinates are
 N: 398,682.23" Latitude: 39°35'11.02"
 E: 1,610,624.98" Longitude: 80°52'53.82"
 UTM Zone 17, NAD 1983
 Top Hole Coordinates Bottom Hole Coordinates
 N: 4,377,055.920m N: 4,381,867.947m
 E: 512,400.665m E: 510,180.868m
 Plat orientation and corner and well references are based upon the grid north meridian.
 Well location references are based upon the magnetic meridian.

BTM HOLE LONGITUDE 80 - 52 - 30
 TOP HOLE LONGITUDE 80 - 50 - 00

Leap Unit 1H As-Drilled POE Coordinates
 West Virginia Coordinate System of 1927, North Zone
 N: 383,427.00"
 E: 1,615,563.69"
 Latitude: 39°32'41.00"
 Longitude: 80°51'47.79"
 UTM Zone 17, NAD 1983
 N: 4,377,245.492m
 E: 511,762.922m

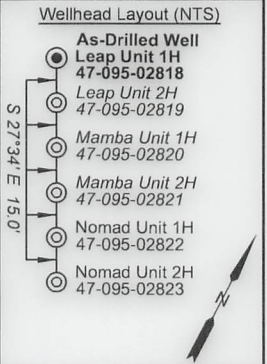

STATE OF WEST VIRGINIA
 DEPARTMENT OF ENVIRONMENTAL PROTECTION
OIL AND GAS DIVISION

FILE NO: 77-54-E-22
 DRAWING NO: Leap Unit 1H As-Drilled
 SCALE: 1" = 2000'
 MINIMUM DEGREE OF ACCURACY: Submeter
 PROVEN SOURCE OF ELEVATION: WVDOT, Harrisville, WV

DATE: July 28 2022
 OPERATOR'S WELL NO. Leap Unit 1H
API WELL NO
 47 - 095 - 02818
 STATE COUNTY PERMIT

WELL TYPE: OIL GAS LIQUID INJECTION WASTE DISPOSAL
 (IF GAS) PRODUCTION: STORAGE DEEP SHALLOW

LOCATION: ELEVATION: As-Built: 1,193' WATERSHED: Outlet Middle Island Creek QUADRANGLE: TH:Porter Falls BH:Paden City

DISTRICT: Ellsworth/Magnolia SURFACE OWNER: Dennis & Clista Heintzman ROYALTY OWNER: BRC Appalachian Minerals I, LLC (2); Dennis R. & Clista Heintzman; LEASE NO: COUNTY: Tyler/Wetzel ACREAGE: 417.6 28.8375; 9.1875; 60; 48; 38; 100; 38.09; 66.5; 63.3125; 67

PROPOSED WORK: DRILL CONVERT DRILL DEEPER FRACTURE OR STIMULATE PLUG OFF OLD FORMATION
 PERFORATE NEW FORMATION OTHER PHYSICAL CHANGE IN WELL (SPECIFY) As-Drilled
 PLUG AND ABANDON CLEAN OUT AND REPLUG TARGET FORMATION: Marcellus Shale ESTIMATED DEPTH: 23,185' MD 6,577' TVD

WELL OPERATOR: Antero Resources Corporation DESIGNATED AGENT: Kevin Ellis
 ADDRESS: 1615 Wynkoop Street ADDRESS: 535 White Oaks Blvd.
 Denver, CO 80202 Bridgeport WV, 26330

02/16/2024

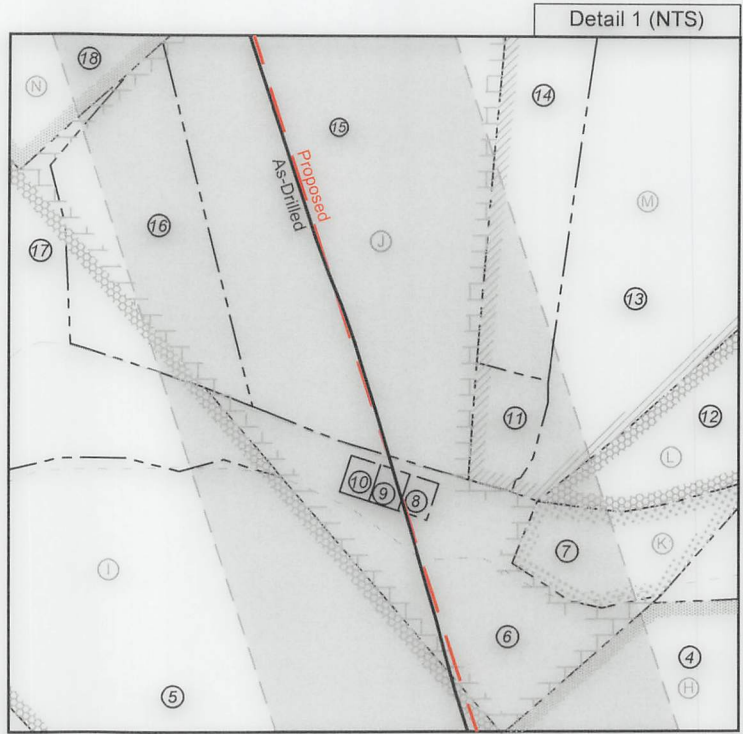

Leases	
A	BRC Appalachian Minerals I, LLC
B	Rose Enterprises, LLC
C	Dennis R. & Clista A. Heintzman
D	Nina A. Whitefield
E	Larry R. and Kim M. Henthorn
F	Waco Oil and Gas Co. Inc.
G	BRC Appalachian Minerals I, LLC
H	Judy P. Meyers
I	Antero Minerals, LLC
J	Larry F. Hughes
K	Michael L. West, et ux
L	Linda J. & Jack E. Mason
M	Paula Sue Porfeli
N	Gary A. Midcap, et ux
O	Ruth E. VanCamp Estate
P	Ruth E. VanCamp Estate
Q	Gary A. Midcap, et ux
R	Sara Ann Midcap
S	Linda Allen
T	Will E. Morris Heirs Trust
U	Gary A. Midcap, et ux
V	Lowmax R. Kunkel
W	Joel Potts III
X	Robert D. Wetzel
Y	Bounty Minerals, LLC

ID	TM/Par	Owner	Bk/Pg	Acres
1	6-36	Dennis & Clista Heintzman	297/640	417.60
2	10-4	Stefan L. & Alberta B. Smolski	356/467	56.08
3	6-49	Dennis & Clista A. Heintzman	297/637	45.00
4	6-26	Ronnie L. VanCamp, et al	670/641	23.00
5	6-25.2	Joshua M. & Crystal L. Rocchio	543/206	32.00
6	6-17.3	Tracy Postlethwait	354/74	3.00
7	6-17.2	Michael L. & Donna S. West	243/175	2.66
8	6-52	Juanita A. Morgan, et al	296/313	0.18
9	6-51	Juanita A. Morgan, et al	296/313	0.18
10	6-50	Juanita A. Morgan, et al	296/313	0.18
11	6-18.1	Maxine M. Ankrom	362/75	1.16
12	6-19	Linda J. & Jack E. Mason	OR101/678	10.00
13	6-18	Kirk Family Trust	511/171	39.00
14	6-18.2	Kirk Family Trust	511/169	11.00
15	6-17.1	Larry Henthorn	560/660	25.00
16	6-17	William McClain	297/87	10.24
17	6-25	William L. McClain	253/323	11.87
18	6-6	Gary A. & Penny K. Midcap	301/265	100.00
19	3-26.1	Gary A. & Penny K. Midcap	301/265	40.00
20	3-32	Gary A. & Penny K. Midcap	301/265	38.09
21	6-5	Gary A. & Penny K. Midcap	301/265	75.55
22	3-42	Rosalie B. Henry	362/339	27.00
23	3-26	Gary Midcap	318/496	50.00
24	3-24	Gary A. & Penny K. Midcap	301/265	66.50
25	3-18	Gary Midcap	322/108	80.33
26	3-13	Lomax R. Kunkel	297/692	63.50
27	3-8	Steven D. & Brenda M. Higgins	313/623	67.00
28	16-67	Robert D. Wetzel	404/372	82.06
29	16-61.1	Robert D. Wetzel	184/351	3.00
30	16-61	Kenneth W. & Norma A. Headley	355/347	41.75

FILE NO: 77-54-E-22
 DRAWING NO: Leap Unit 1H As-Drilled
 SCALE: 1" = 2000'
 MINIMUM DEGREE OF ACCURACY:
 Submeter
 PROVEN SOURCE OF ELEVATION:
 WVDOT, Harrisville, WV

STATE OF WEST VIRGINIA
 DEPARTMENT OF ENVIRONMENTAL PROTECTION
OIL AND GAS DIVISION

DATE: July 28 2022
 OPERATOR'S WELL NO. Leap Unit 1H
 API WELL NO
 47 - 095 - 02818
 STATE COUNTY PERMIT

WELL TYPE: OIL GAS LIQUID INJECTION WASTE DISPOSAL
 (IF GAS) PRODUCTION: STORAGE DEEP SHALLOW

LOCATION: ELEVATION: As-Built: 1,193' WATERSHED: Outlet Middle Island Creek QUADRANGLE: TH:Porter Falls BH:Paden City

DISTRICT: Ellsworth/Magnolia COUNTY: Tyler
 SURFACE OWNER: Dennis & Clista Heintzman ACREAGE: 417.6
 ROYALTY OWNER: BRC Appalachian Minerals I, LLC (2); Dennis R. & Clista Heintzman; LEASE NO: ACREAGE: 66.5; 63.3125; 67

PROPOSED WORK: DRILL CONVERT DRILL DEEPER FRACTURE OR STIMULATE PLUG OFF OLD FORMATION
 PERFORATE NEW FORMATION OTHER PHYSICAL CHANGE IN WELL (SPECIFY) As-Drilled
 PLUG AND ABANDON CLEAN OUT AND REPLUG TARGET FORMATION: Marcellus Shale ESTIMATED DEPTH: 6,577' TVD 23,185' MD

WELL OPERATOR: Antero Resources Corporation DESIGNATED AGENT: Kevin Ellis
 ADDRESS: 1615 Wynkoop Street ADDRESS: 535 White Oaks Blvd.
 Denver, CO 80202 Bridgeport WV, 26330