

LATITUDE 39°32'30" 281'

Antero Resources Corporation
Well No. Marcellina Unit 1H

LATITUDE 39°30'00"

6,753' TO BOTTOM HOLE

5,811' TO BOTTOM HOLE

4,827'

LONGITUDE 80°47'30"

AS DRILLED DATA:
 WELL 1H TOP HOLE INFORMATION:
 N: 377,193ft E: 1,635,389ft
 LAT: 39°31'42.29" LON: 80°47'33.58"
 BOTTOM HOLE INFORMATION:
 N: 360,936ft E: 1,640,444ft
 LAT: 39°29'02.33" LON: 80°46'26.13"
 WEST VIRGINIA COORDINATE SYSTEM OF 1927 NORTH ZONE. ZONE WAS DERIVED FROM MEASUREMENTS TAKEN WITH TRIMBLE GEOXT SUBMETER MAPPING GRADE GPS UNIT. PLAT ORIENTATION, CORNER, AND WELL REFERENCE TIE LINES ARE BASED ON GRID NORTH.

(NAD) 83 (UTM) ZONE 17 COORDS:
 WELL 1H TOP HOLE INFORMATION:
 N: 4,375,447m E: 517,834m
 BOTTOM HOLE INFORMATION:
 N: 4,370,520m E: 519,457m

(NAD) 27 (UTM) ZONE 17 COORDS:
 WELL 1H TOP HOLE INFORMATION:
 N: 14,354,399ft E: 1,698,881ft
 POINT OF ENTRY INFORMATION:
 N: 14,354,221ft E: 1,698,735ft
 BOTTOM HOLE INFORMATION:
 N: 14,338,233ft E: 1,704,204ft

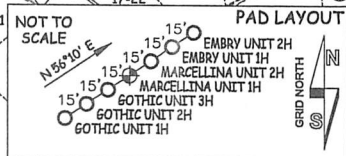

- NO OCCUPIED DWELLINGS OR BUILDINGS TWO THOUSAND FIVE HUNDRED (2,500) SQUARE FEET OR LARGER USED TO HOUSE OR SHELTER DAIRY CATTLE OR POULTRY HUSBANDRY ARE LOCATED WITHIN SIX HUNDRED TWENTY-FIVE (625) FEET OF THE CENTER OF THE WELL PAD.
- TOP HOLE DATA SHOWN HEREON WAS PROVIDED BY ANTERO RESOURCES CORPORATION.
- AS DRILLED DATA WAS PROVIDED BY ANTERO RESOURCES CORPORATION.
- WLS IS NOT CERTIFYING THE DATA AND INFORMATION PROVIDED LISTED IN NOTES 2 AND 3, ONLY THE RELATIONSHIP TO THE DATA AND INFORMATION PROVIDED TO THE LEASE BOUNDARIES.
- WLS IS BY NO MEANS RESPONSIBLE FOR ANY ERRORS OR INACCURACIES WITH THE DATA AND INFORMATION THAT HAS BEEN PROVIDED.

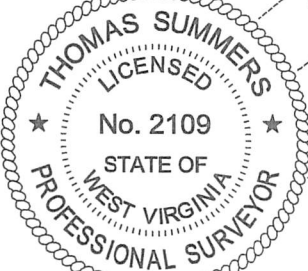

ELLSWORTH DISTRICT - TYLER COUNTY

11-20	EDWARD QUIRK
11-21	EDWARD QUIRK
11-22	NILE HARRIS
11-59	EDWARD QUIRK
11-60	MICHAEL MARTIN
12-8	ROSALIE HENRY
12-8	ANTERO MIDSTREAM LLC
12-7	COASTAL FOREST RESOURCES CO.
12-8	SHIRLEY CARROLL
12-9	COASTAL FOREST RESOURCES CO.
12-10	MICHAEL MARTIN
12-11	CLARA WALLACE
12-12	ROCKFORD ENERGY LLC
12-13	ERIC FISHER
12-14	ANTERO MIDSTREAM LLC
12-15	PATRICIA NYE
12-16	PATRICIA NYE
12-17	ANTERO MIDSTREAM LLC
12-18	ANTERO MIDSTREAM LLC
12-19	JON DUMARS
12-23	ROBERT BARD
12-32	CARL WILCOX

16-13	GAIL NEFF
17-21	CHRISTOPHER INVESTMENTS INC.
17-2	EDWARD WARF
17-3	FLOYD EDDY
17-3.1	FLORA ROBERTS
17-4	ERWIN PECK
17-5	DOUG SMITH
17-6	ERWIN PECK
17-7	GILBERT EDDY
17-8	RICHARD NAPIORKOWSKI
17-9	ERWIN PECK
17-10	THOMAS JOBS
17-10.1	CHARLES EASTHAM
17-10.2	THOMAS JOBS
17-11	ELIZABETH RICHIE
17-23	MARJORIE STALEY
17-24.1	DAWN HADLEY
17-25	ELIZABETH MENGES
17-26	RICHARD NEFF
17-27	HAMMETT LAND & MINERALS LLC
17-28	ARTHUR PECK
17-29	HAMMETT LAND & MINERALS LLC
17-32	SHALYN MCGRAW
17-33	HAMMETT LAND & MINERALS LLC
17-34	SAMUEL HAMMETT
17-34.1	MANUFACTURERS LIGHT & HEAT CO.
17-34.2	HAMMETT LAND & MINERALS LLC
17-35	SAMUEL HAMMETT
17-36	SAMUEL HAMMETT
17-37	BONNIE HENTHORN
17-37.1	JOHN COOPER
17-49	MARSHA MENGES
17-50	MARSHA MENGES
17-51	JONATHAN COOPER
17-52	ANTERO RESOURCES CORP.
17-53	WILLIAM JAMES
17-54	WANDA PARR
17-57.1	RICHARD WILLIAMS
17-57.2	RICHARD WILLIAMS
17-58	CHRISTOPHER INVESTMENTS INC.
17-59	MICHAEL BEEGLE
17-60	JOHN RAI
17-61	T. E. CUNNINGHAM
17-62	EDNA EDDY
17-63	EDNA ROBERTS
17-64	ANGELA SMITH
17-65	GILBERT EDDY
17-65.1	CHRISTIAN CHURCH
17-66	FLOYD EDDY
17-67	JEREMY NEFF
17-67.1	CYNTHIA EDDY
17-68	JEREMY NEFF
17-69	LARRY HENTHORN
17-70	DALE RICHMOND
17-71	LARRY HENTHORN
17-72	LARRY HENTHORN
23-6	DALE PARR
23-7	DALE PARR
23-9	DALE PARR
23-10	DALE PARR
23-11	JENNIFER WILLIAMS
23-12	TERRY JOY
MCELROY DISTRICT - TYLER COUNTY	
2-3	LLOYD WEEKLEY
2-4	LLOYD WEEKLEY
2-5	RONALD WEEKLEY
2-9	ELDEN NICHOLS
2-9.1	RICHARD BLANKENSHIP
2-9.2	WILLIAM LACY
2-9.3	SANDRA JOCHUM
2-10	WANDA PARR
2-18	MICHAEL SHERWOOD
2-20	ELDEN NICHOLS
2-21	CHARLES HAGAN
2-22	RICHARD THOMASELL

I THE UNDERSIGNED, HEREBY CERTIFY THAT THIS PLAT IS CORRECT TO THE BEST OF MY KNOWLEDGE AND BELIEF AND SHOWS ALL THE INFORMATION REQUIRED BY LAW AND THE RULES ISSUED AND PERSCRIBED BY THE DEPARTMENT OF ENVIRONMENTAL PROTECTION.

JOB #	20-011WA
DRAWING #	MARCELLINA1HAD
SCALE	1" = 2000'
MINIMUM DEGREE OF ACCURACY	SUBMETER
PROVEN SOURCE OF ELEV. SUBMETER MAPPING GRADE GPS	<i>Thomas Summers</i>
STATE OF WEST VIRGINIA DEPARTMENT OF ENERGY DIVISION OF OIL AND GAS	THOMAS SUMMERS P.S. 2109
DATE	10/02/23
OPERATOR'S WELL#	MARCELLINA UNIT #1H



STATE OF WEST VIRGINIA, DIVISION OF ENVIRONMENTAL PROTECTION, OFFICE OF OIL AND GAS

WILLOW LAND SURVEYING PLLC
220 MASONIC AVE. PENNSBORO WEST VIRGINIA 26415

WELL TYPE:	OIL	GAS	X	LIQUID INJECTION	WASTE DISPOSAL	47	095	02829	COUNTY
(IF "GAS") PRODUCTION		X		DEEP	SHALLOW	X			PERMIT
LOCATION:	ELEVATION	1,200' - AS BUILT	WATERSHED	OUTLET MIDDLE ISLAND CREEK	DISTRICT	ELLSWORTH	COUNTY	TYLER	DATE
SURFACE OWNER	CLARA SUZANNE WALLACE & RICKIE WALLACE	ACREAGE	60 ACRES +/-	LEASE ACREAGE	60 ACRES +/-				12/01/2023
OIL & GAS ROYALTY OWNER	PHILLIP K. GEORGE								

PROPOSED WORK:	DRILL	CONVERT	DRILL DEEPER	REDRILL	FRACTURE OR STIMULATE
PLUG OFF OLD FORMATION					OTHER PHYSICAL CHANGE IN WELL (SPECIFY) AS DRILLED
TARGET FORMATION	MARCELLUS	ESTIMATED DEPTH	6,935' TVD 24,079' MD	DESIGNATED AGENT	KEVIN ELLIS
WELL OPERATOR	ANTERO RESOURCES CORP.	ADDRESS	1615 WYNKOOP ST. DENVER, CO 80202	ADDRESS	535 WHITE OAKS BLVD BRIDGEPORT, WV 26330