

WELL NAME: BFT 7H
CENTER POINT, WV

TOTAL DISTANCE BORED
FROM LP TO BH = 11,465'

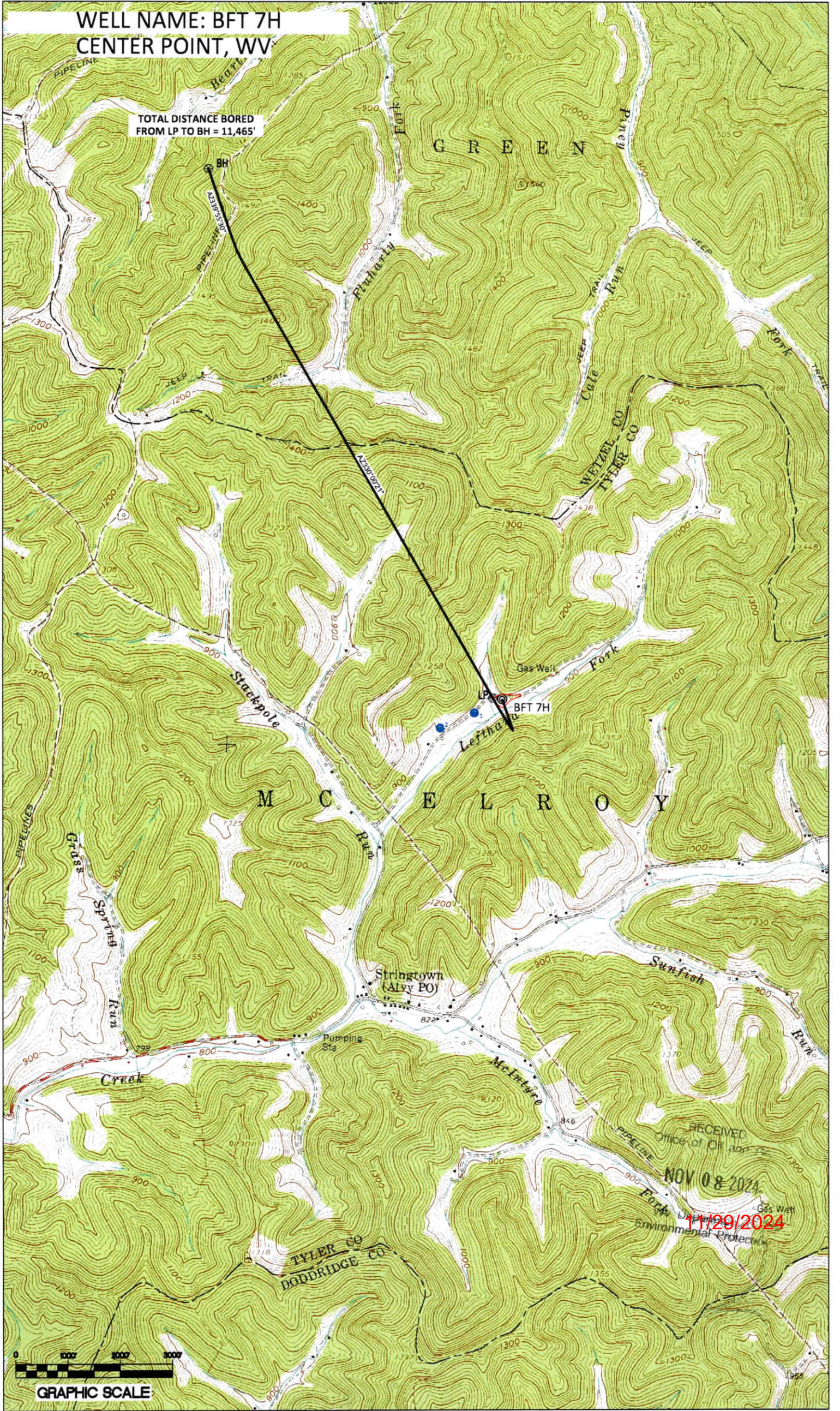

GRAPHIC SCALE

SURFACE HOLE DEC. LONG: 80.689871
SURVEYED LONG: 80° 41' 23.5"

6,550'

Latitude: 39° 30' 00" (NAD27)

Longitude: 80° 40' 00" (NAD27)

TOP HOLE (UTM NAD 83)
N) 4367968.4
E) 526694.8

TOTAL DISTANCE BORED
FROM LP TO BH = 11,465'

NO DWELLINGS FOUND WITHIN 650'
OF THE CENTER OF THE WELL PAD
NO WATER WELLS FOUND WITHIN 250'
OF THE CENTER OF WELL PAD

BOTTOM HOLE (UTM NAD 83)
N) 4371012.8
E) 524929.9

REFERENCES TO
PROPOSED HORIZONTAL
WELLS LOCATIONS

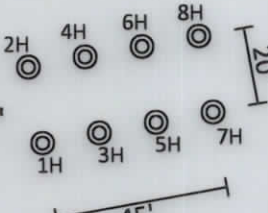

BOTTOM

HOLE
4270' SOUTH
OF LATITUDE
39° 30' 00"
550' WEST
OF LONGITUDE
80° 42' 30"

REFERENCES

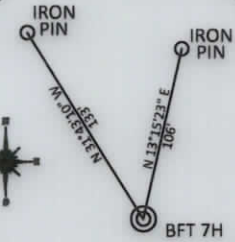

NTS

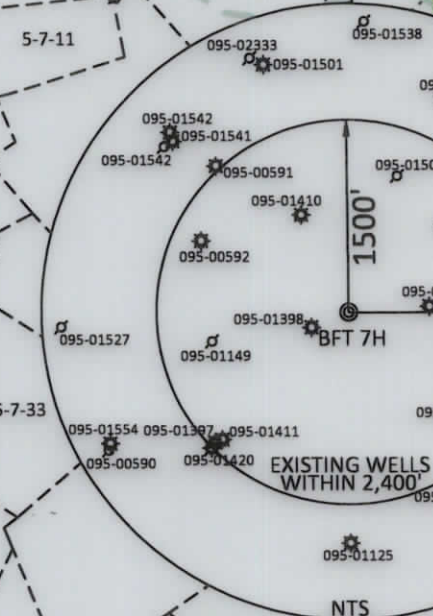

EXISTING WELLS
WITHIN 2,400'

Boundaries as shown taken
from deeds, tax maps and
field locations. A full boundary
survey is not expressed nor implied.
All bearings are based on true north.
Ownership taken from public records
Wetzel County, West Virginia
2024
State Plane Coordinates &
NAD 83 Lat/Long by differential
submeter mapping grade GPS
Drafted by EAK

FILE #: TRB2
DRAWING #: 3080
SCALE: 1" = 1500'
1" = 2000'
MINIMUM DEGREE
OF ACCURACY: 1/200
PROVEN SOURCE SUBMETER MAPPING
OF ELEVATION: GRADE GPS

W1	S 64°04'18" W 607'
W2	S 65°16'40" W 1319'

I, THE UNDERSIGNED, HEREBY CERTIFY THAT THIS
PLAT IS CORRECT TO THE BEST OF MY KNOWLEDGE AND
BELIEF AND SHOWS ALL THE INFORMATION REQUIRED BY
LAW AND THE REGULATIONS ISSUED AND PRESCRIBED BY
THE DEPARTMENT OF ENVIRONMENTAL PROTECTION.

Signed: [Signature]
L.L.S. #2124 : Ernest J. Benchek III

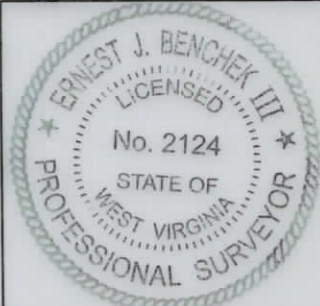

(+) DENOTES LOCATION OF WELL ON
UNITED STATES TOPOGRAPHIC MAPS
WVDEP

OFFICE OF OIL & GAS
601 57TH STREET
CHARLESTON, WV 25304

Well Type: Oil Waste Disposal Production Deep
 Gas Liquid Injection Storage Shallow

DATE: OCTOBER 30, 2024

OPERATOR'S WELL #: BFT 7H

API WELL #: 47 95
STATE COUNTY PERMIT

WATERSHED: OUTLET MIDDLE ISLAND CREEK

AS-BUILT
ELEVATION: 880'

COUNTY/DISTRICT: TYLER / McELROY

QUADRANGLE: CENTER POINT

SURFACE OWNER: WEST VIRGINIA DEPT. OF NATURAL RESOURCES

ACREAGE: 110.00 +/- 11/29/2024

OIL & GAS ROYALTY OWNER: Tribune Resources, LLC, Et Al

ACREAGE: 919.7 +/-

LEASE NUMBERS:

DRILL CONVERT DRILL DEEPER REDRILL FRACTURE OR STIMULATE
PLUG OFF FORMATION PERFORATE NEW FORMATION PLUG & ABANDON
CLEAN OUT & REPLUG OTHER CHANGE (SPECIFY):

TARGET FORMATION: MARCELLUS

ESTIMATED DEPTH: TVD: 6,930' TMD: 18,875'

WELL OPERATOR: TRIBUNE RESOURCES, LLC

DESIGNATED AGENT: HARMAN BROWN

ADDRESS: 3861 AMBASSADOR CAFFERY PARKWAY SUITE 600

ADDRESS: 18396 MOUNTAINEER HIGHWAY

CITY: LAFAYETTE STATE: LA ZIP CODE: 70503

CITY: WILEYVILLE STATE: WV ZIP CODE: 26581

PROPERTY OWNER INDEX	
5-8-8	WV DEPT. OF NATURAL RESOURCES COMMERCE
5-8-6	FRANK A. & MARTHA J. PERRY
5-8-5	ALLEN D. STACKPOLE
5-8-3	MICHAEL PERRY & MARK PERRY
5-8-1	EDWARD G. THOMPSON
5-25-17	WV DIVISION OF NATURAL RESOURCES
5-25-16	COASTAL FOREST RESOURCES CO.
5-25-6	STATE OF WV PUBLIC LAND CORP.
5-8-34	ASCENT RESOURCES MARCELLUS MINERALS LLC
5-8-21	JERRY L WALTERS
5-8-22	WV DEPT OF NATURAL RESOURCES COMMERCE DIVISION

LEASE INDEX			
A	MARC00717-001	G	MARC00727-001
B	MARC00765-000	H	MARC02996-000
C	MARC00713-000	I	MARC00744-000
D	MARC00713-000	J	MARC03689-001
E	MARC03487-000	K	MARC03689-001
F	MARC00727-001	L	MARC01099-001

11/29/2024

FILE #: TRB2

DRAWING #: 3080

SCALE: N/A

DATE: OCTOBER 30, 2024

OPERATOR'S WELL #: BFT 7H

API WELL #: 47 095 2837
STATE COUNTY PERMIT