

Antero Resources Corporation Well No. Cider Run Unit 1H

Table listing landowners in Ellsworth District - Tyler County, including names like Daniel Witschey, Richard Kogher, and others.

NOTES: WELL 1H TOP HOLE INFORMATION: N: 384,451ft E: 1,623,087ft LAT: 39°32'52.24" LON: 80°50'11.96" BOTTOM HOLE INFORMATION: N: 386,748ft E: 1,619,711ft LAT: 39°33'14.72" LON: 80°50'54.86" WEST VIRGINIA COORDINATE SYSTEM OF 1927 NORTH ZONE. ZONE WAS DERIVED FROM MEASUREMENTS TAKEN WITH TRIMBLE GEOXT SUBMETER MAPPING GRADE GPS UNIT. PLAT ORIENTATION, CORNER, AND WELL REFERENCE TIE LINES ARE BASED ON GRID NORTH.

(NAD) 83 (UTM) ZONE 17 COORDS: WELL 1H TOP HOLE INFORMATION: N: 4,377,596m E: 514,050m BOTTOM HOLE INFORMATION: N: 4,378,278m E: 513,009m

(NAD) 27 (UTM) ZONE 17 COORDS: WELL 1H TOP HOLE INFORMATION: N: 14,361,447ft E: 1,686,463ft POINT OF ENTRY INFORMATION: N: 14,361,715ft E: 1,683,727ft BOTTOM HOLE INFORMATION: N: 14,363,687ft E: 1,683,051ft

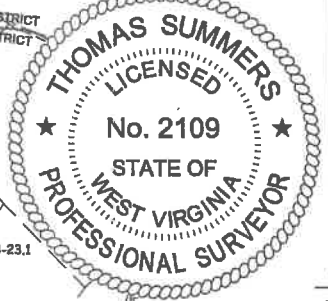

WW NORTH ZONE GRID NORTH

10,681' TO BOTTOM HOLE

12,926'

LONGITUDE 80°50'00"

LONGITUDE 80°50'00"

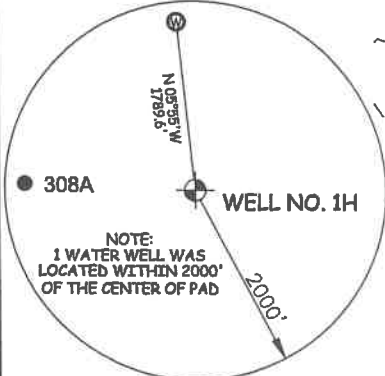

NOTE: NO OCCUPIED DWELLINGS OR BUILDINGS TWO THOUSAND FIVE HUNDRED (2,500) SQUARE FEET OR LARGER USED TO HOUSE OR SHELTER DAIRY CATTLE OR POULTRY HUSBANDRY ARE LOCATED WITHIN SIX HUNDRED TWENTY-FIVE (625) FEET OF THE CENTER OF THE PAD.

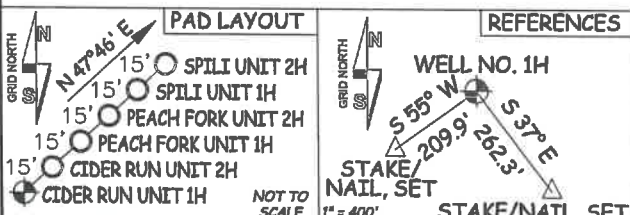

STATE OF WEST VIRGINIA, DIVISION OF ENVIRONMENTAL PROTECTION, OFFICE OF OIL AND GAS. WILLOW LAND SURVEYING PLLC 220 MASONIC AVE. PENNSBORO WEST VIRGINIA 26415

I THE UNDERSIGNED, HEREBY CERTIFY THAT THIS PLAT IS CORRECT TO THE BEST OF MY KNOWLEDGE AND BELIEF AND SHOWS ALL THE INFORMATION REQUIRED BY LAW AND THE RULES ISSUED AND PERSCRIBED BY THE DEPARTMENT OF ENVIRONMENTAL PROTECTION.

JOB # 20-011WA DRAWING # CIDERRUN1HS SCALE 1" = 2000' MINIMUM DEGREE OF ACCURACY SUBMETER PROVEN SOURCE OF ELEV. SUBMETER MAPPING GRADE GPS STATE OF WEST VIRGINIA DEPARTMENT OF ENERGY DIVISION OF OIL AND GAS

LEGEND: Surface Owner Boundary Lines +/-, Adjoining Surface Tracts +/-, Found monument, as noted. THOMAS SUMMERS P.S. 2109 DATE 10/25/22 OPERATOR'S WELL# CIDER RUN UNIT #1H

WELL TYPE: OIL \_\_\_ GAS X LIQUID INJECTION \_\_\_ WASTE DISPOSAL \_\_\_ 47 - 095 - 02839 (IF "GAS") PRODUCTION X STORAGE \_\_\_ DEEP \_\_\_ SHALLOW X STATE COUNTY PERMIT LOCATION: ELEVATION ORIGINAL - 1270.0' PROPOSED - 1233.0' WATERSHED OUTLET MIDDLE ISLAND CREEK QUADRANGLE PORTER FALLS 7.5' DISTRICT ELLSWORTH COUNTY TYLER SURFACE OWNER EDWARD YOST ESTATE ACREAGE 109.06 ACRES +/- LEASE ACREAGE 45.67 AC.±: 17 AC.±: CHARLES RAY JOBS: HERITAGE RESOURCES MINERALS, LLC.; ROSE ENTERPRISES, LLC.; BRC APPALACHIAN MINERALS I LLC.; BRC APPALACHIAN MINERALS I LLC.; 470.5 ±: 81.52 AC.±: 19.84 AC.±: 28.77 AC.±: 15.13 AC.±: DATE 12/23/2022

PROPOSED WORK: DRILL X CONVERT \_\_\_ DRILL DEEPER \_\_\_ REDRILL \_\_\_ FRACTURE OR STIMULATE X PLUG OFF OLD FORMATION \_\_\_ PERFORATE NEW FORMATION X OTHER PHYSICAL CHANGE IN WELL (SPECIFY) PLUG & ABANDON \_\_\_ CLEAN OUT & REPLUG \_\_\_ TARGET FORMATION MARCELLUS ESTIMATED DEPTH 7,200' TVD 12,800' MD WELL OPERATOR ANTERO RESOURCES CORP. DESIGNATED AGENT DIANNA STAMPER - CT CORPORATION SYSTEM ADDRESS 1615 WYNKOOP ST. ADDRESS 5400 D BIG TYLER ROAD DENVER, CO 80202 CHARLESTON, WV 25313 FORM WW-6

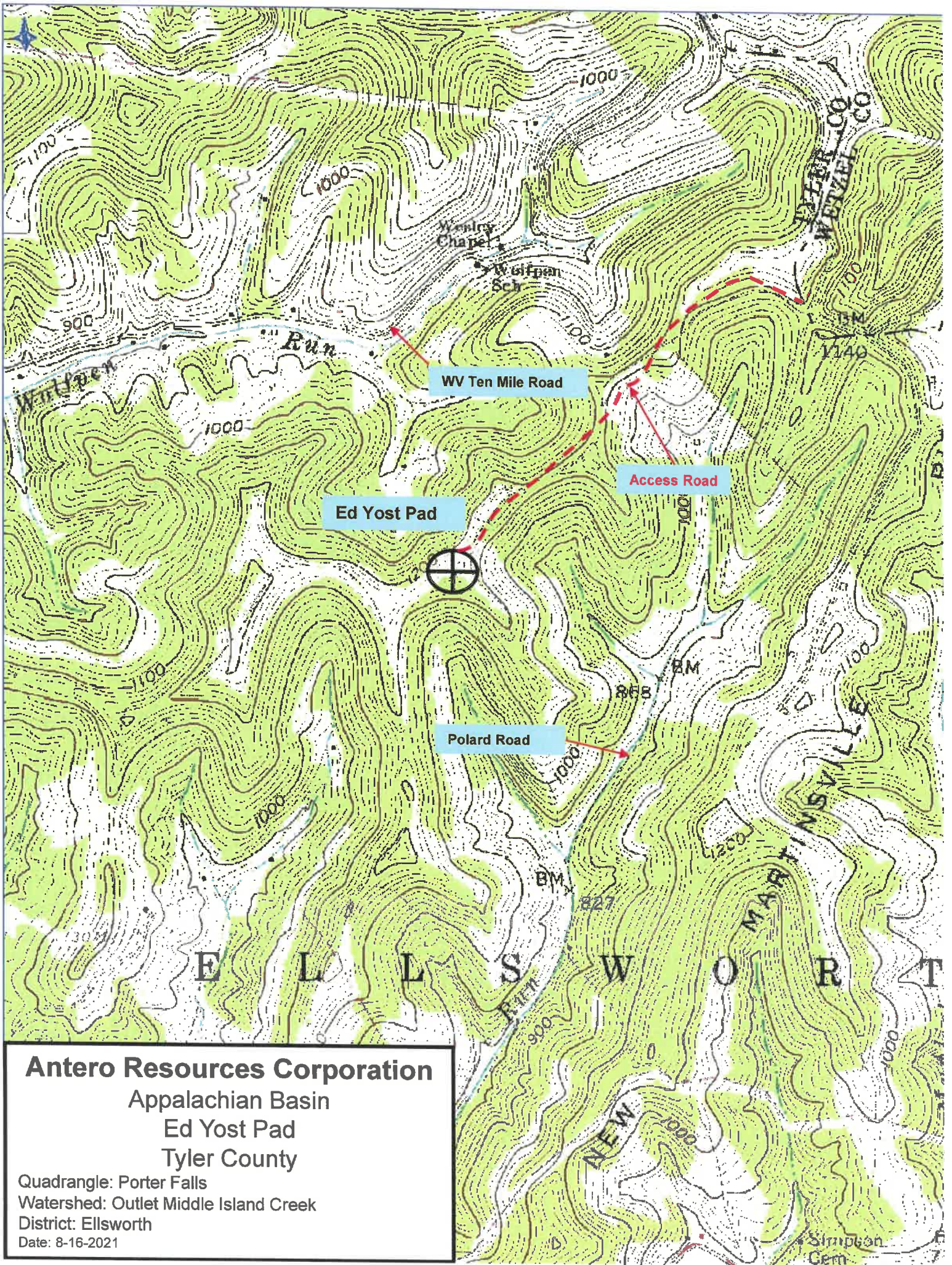

12/23/2022