

LATITUDE 39°35'00" 937'

9,323' TO BOTTOM HOLE

LATITUDE 39°37'30"

11,403' TO BOTTOM HOLE

12,927'

LONGITUDE 80°50'00"

LONGITUDE 80°50'00"

Antero Resources Corporation Well No. Cider Run Unit 1H

Table listing landowners and lease numbers for the Ellsworth District in Tyler County, West Virginia. Includes names like Daniel Witschey, Richard Kocher, and various LLCs.

AS DRILLED DATA: WELL 1H TOP HOLE INFORMATION: N: 384,451ft E: 1,623,086ft... BOTTOM HOLE INFORMATION: N: 401,442ft E: 1,614,951ft... (NAD) 83 (UTM) ZONE 17 COORDS: WELL 1H TOP HOLE INFORMATION: N: 4,377,596m E: 514,049m... (NAD) 27 (UTM) ZONE 17 COORDS: WELL 1H TOP HOLE INFORMATION: N: 14,361,447ft E: 1,686,462ft...

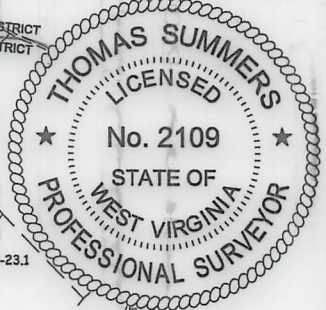

WV NORTH ZONE GRID NORTH

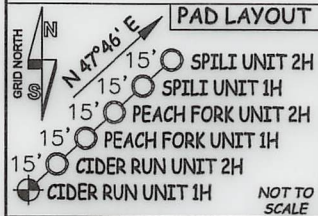
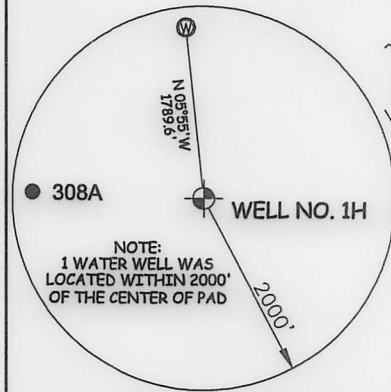

NOTE: 1. NO OCCUPIED DWELLINGS OR BUILDINGS TWO THOUSAND FIVE HUNDRED (2,500) SQUARE FEET OR LARGER USED TO HOUSE OR SHELTER DAIRY CATTLE OR POULTRY HUSBANDRY ARE LOCATED WITHIN SIX HUNDRED TWENTY-FIVE (625) FEET OF THE CENTER OF THE WELL PAD.



STATE OF WEST VIRGINIA, DIVISION OF ENVIRONMENTAL PROTECTION, OFFICE OF OIL AND GAS. WILLOW LAND SURVEYING PLLC, 220 MASONIC AVE. PENNSBORO WEST VIRGINIA 26415.

I THE UNDERSIGNED, HEREBY CERTIFY THAT THIS PLAT IS CORRECT TO THE BEST OF MY KNOWLEDGE AND BELIEF AND SHOWS ALL THE INFORMATION REQUIRED BY LAW AND THE RULES ISSUED AND PERSCRIBED BY THE DEPARTMENT OF ENVIRONMENTAL PROTECTION.

JOB # 20-011WA, DRAWING # CIDERRUN1HAD, SCALE 1" = 2000', MINIMUM DEGREE OF ACCURACY SUBMETER, PROVEN SOURCE OF ELEV. SUBMETER MAPPING GRADE GPS.

LEGEND: Surface Owner Boundary Lines +/-, Interior Surface Tracts +/-, Proposed Well Path, As Drilled Well Path. Signed by Thomas Summers, P.S. 2109, DATE 11/09/23, OPERATOR'S WELL# CIDER RUN UNIT #1H.

WELL TYPE: OIL ___ GAS X LIQUID INJECTION ___ WASTE DISPOSAL ___ 47 - 095 - 02839 (IF "GAS") PRODUCTION X STORAGE ___ DEEP ___ SHALLOW X STATE COUNTY PERMIT LOCATION: ELEVATION 1,233' - AS BUILT WATERSHED OUTLET MIDDLE ISLAND CREEK QUADRANGLE PORTER FALLS 7.5' DISTRICT ELLSWORTH COUNTY TYLER SURFACE OWNER EDWARD YOST ESTATE ACREAGE 109.06 ACRES +/- LEASE ACREAGE 45.67 ACRES± OIL & GAS ROYALTY OWNER FISHER OIL COMPANY

PROPOSED WORK: DRILL ___ CONVERT ___ DRILL DEEPER ___ REDRILL ___ FRACTURE OR STIMULATE ___ PLUG OFF OLD FORMATION ___ PERFORATE NEW FORMATION ___ OTHER PHYSICAL CHANGE IN WELL (SPECIFY) AS DRILLED PLUG & ABANDON ___ CLEAN OUT & REPLUG ___ TARGET FORMATION MARCELLUS ESTIMATED DEPTH 6,677' TVD 25,020' MD WELL OPERATOR ANTERO RESOURCES CORP. DESIGNATED AGENT KEVIN ELLIS ADDRESS 1615 WYNKOOP ST. ADDRESS 535 WHITE OAK BLVD. BRIDGEPORT, WV 26330

COUNTY NAME PERMIT

02/16/2024