

LATITUDE 39°35'00" 915'

7,932' TO BOTTOM HOLE

LATITUDE 39°37'30"

10,163' TO BOTTOM HOLE

12,905'

LONGITUDE 80°50'00"

LONGITUDE 80°50'00"

Antero Resources Corporation Well No. Peach Fork Unit 1H

Table listing landowners in Ellsworth District - Tyler County, including names like Annette Hinkle, Ruby Carroll, Daniel Witschey, etc.

AS DRILLED DATA: WELL 1H TOP HOLE INFORMATION: N: 384,472ft E: 1,623,109ft LAT: 39°32'52.45" LON: 80°50'11.68" BOTTOM HOLE INFORMATION: N: 402,493ft E: 1,616,359ft LAT: 39°35'49.55" LON: 80°51'41.33" WEST VIRGINIA COORDINATE SYSTEM OF 1927 NORTH ZONE. ZONE WAS DERIVED FROM MEASUREMENTS TAKEN WITH TRIMBLE GEOXT SUBMETER MAPPING GRADE GPS UNIT. PLAT ORIENTATION, CORNER, AND WELL REFERENCE TIE LINES ARE BASED ON GRID NORTH.

(NAD) 83 (UTM) ZONE 17 COORDS: WELL 1H TOP HOLE INFORMATION: N: 4,377,602m E: 514,056m BOTTOM HOLE INFORMATION: N: 4,383,058m E: 511,908m

(NAD) 27 (UTM) ZONE 17 COORDS: WELL 1H TOP HOLE INFORMATION: N: 14,361,469ft E: 1,686,485ft POINT OF ENTRY INFORMATION: N: 14,362,264ft E: 1,685,322ft BOTTOM HOLE INFORMATION: N: 14,379,369ft E: 1,679,437ft

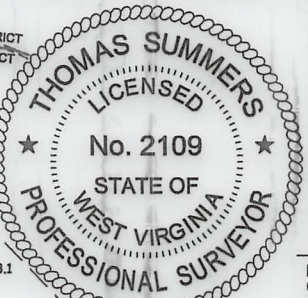

WV NORTH ZONE GRID NORTH

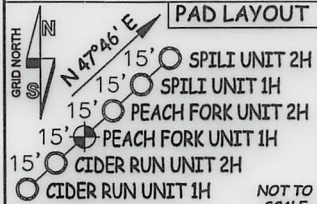
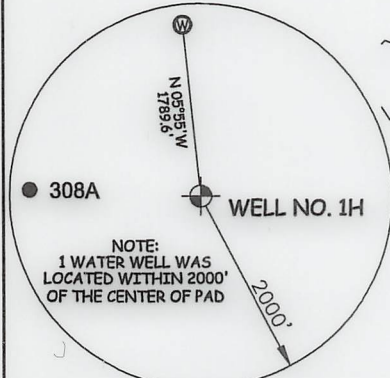

NOTE: 1. NO OCCUPIED DWELLINGS OR BUILDINGS TWO THOUSAND FIVE HUNDRED (2,500) SQUARE FEET OR LARGER USED TO HOUSE OR SHELTER DAIRY CATTLE OR POULTRY HUSBANDRY ARE LOCATED WITHIN SIX HUNDRED TWENTY-FIVE (625) FEET OF THE CENTER OF THE WELL PAD. 2. TOP HOLE DATA SHOWN HEREON WAS PROVIDED BY ANTERO RESOURCES CORPORATION. 3. AS DRILLED DATA WAS PROVIDED BY ANTERO RESOURCES CORPORATION. 4. VLS IS NOT CERTIFYING THE DATA AND INFORMATION PROVIDED LISTED IN NOTES 2 AND 3, ONLY THE RELATIONSHIP TO THE DATA AND INFORMATION PROVIDED TO THE LEASE BOUNDARIES. 5. VLS IS BY NO MEANS RESPONSIBLE FOR ANY ERRORS OR INACCURACIES WITH THE DATA AND INFORMATION THAT HAS BEEN PROVIDED.



STATE OF WEST VIRGINIA, DIVISION OF ENVIRONMENTAL PROTECTION, OFFICE OF OIL AND GAS. WILLOW LAND SURVEYING PLLC, 220 MASONIC AVE. PENNSBORO WEST VIRGINIA 26415

I THE UNDERSIGNED, HEREBY CERTIFY THAT THIS PLAT IS CORRECT TO THE BEST OF MY KNOWLEDGE AND BELIEF AND SHOWS ALL THE INFORMATION REQUIRED BY LAW AND THE RULES ISSUED AND PERSCRIBED BY THE DEPARTMENT OF ENVIRONMENTAL PROTECTION.

JOB # 20-011WA DRAWING # PEACHFORK1HAD SCALE 1" = 2000' MINIMUM DEGREE OF ACCURACY SUBMETER PROVEN SOURCE OF ELEV. SUBMETER MAPPING GRADE GPS

LEGEND: Surface Owner Boundary Lines +/-, Interior Surface Tracts +/-, Proposed Well Path, As Drilled Well Path

STATE OF WEST VIRGINIA DEPARTMENT OF ENERGY DIVISION OF OIL AND GAS

THOMAS SUMMERS P.S. 2109 DATE 11/09/23 OPERATOR'S WELL# PEACH FORK UNIT #1H

WELL TYPE: OIL GAS X LIQUID INJECTION WASTE DISPOSAL 47 095 02841 (IF "GAS") PRODUCTION X STORAGE DEEP SHALLOW X STATE COUNTY PERMIT LOCATION: ELEVATION 1,233' -AS BUILT WATERSHED OUTLET MIDDLE ISLAND CREEK QUADRANGLE PORTER FALLS 7.5' DISTRICT ELLSWORTH COUNTY TYLER SURFACE OWNER EDWARD YOST ESTATE ACREAGE 109.06 ACRES +/- LEASE ACREAGE 45.67 ACRES +/-

PROPOSED WORK: DRILL CONVERT DRILL DEEPER REDRILL FRACTURE OR STIMULATE PLUG OFF OLD FORMATION PERFORATE NEW FORMATION OTHER PHYSICAL CHANGE IN WELL (SPECIFY) AS DRILLED PLUG & ABANDON CLEAN OUT & REPLUG TARGET FORMATION MARCELLUS ESTIMATED DEPTH 6,687' TVD 25,205' MD WELL OPERATOR ANTERO RESOURCES CORP. DESIGNATED AGENT KEVIN ELLIS ADDRESS 1615 WYNKOOP ST. DENVER, CO 80202 ADDRESS 535 WHITE OAK BLVD. BRIDGEPORT, WV 26330