

LATITUDE 39°35'00" 882'

LATITUDE 39°37'30"

5,916' TO BOTTOM HOLE

8,258' TO BOTTOM HOLE

12,875'

LONGITUDE 80°50'00"

LONGITUDE 80°50'00"

COUNTY TYLER

PERMIT

Antero Resources Corporation Well No. Spili Unit 2H

GREEN DISTRICT - WETZEL COUNTY	
6-10	CRISTEL STEELE
6-10.1	LUELLA RABEL
6-10.2	SVEN RABEL
6-15	MICHAEL HURLEY
6-16	MICHAEL HURLEY
ELLSWORTH DISTRICT - TYLER COUNTY	
1-3	DANIEL WITSCHY
1-4	DANIEL WITSCHY
3-1	WITSCHY REALTY INC.
3-7	JOYCE MORRIS
3-7.2	JEFFREY SHADE
3-15	JCW INC.
3-16	JCW INC.
3-17	WITSCHY REALTY INC.
3-23	DAVID MILLER
3-23.1	DAVID MILLER
3-31	ROBERT MCNEEMAR
3-31.1	DANNY TANLEY
3-39	PAUL STRICKLAND
4-1	DEBRA LOY
4-4	GARY LAW
4-7	ROGER ANTILL
4-8	PAUL STRICKLAND
4-9	GARY LAW
4-12	TRUMAN DAWSON
6-46	NANCY MERCER
7-2	NANCY MERCER
7-2.1	NANCY MERCER
7-3	MYRON NOTTINGHAM
7-17	JIMMY SAILOR
7-17.1	GAYLE HARRIS
7-18	LUCILLE GULLEY
7-18.1	LUCILLE GULLEY
7-18.2	LUCILLE GULLEY
7-18.3	LUCILLE GULLEY
7-19	ALBERT RICE
7-20	WASH BEATTY
7-28	EDWARD YOST
7-28.1	GEORGE YOST
7-28.2	ERNEST YOST
7-29	EDWARD YOST
7-30	FLODE YOST
7-31	EDWARD YOST
7-32	ROBERT MERCER
7-33	GARY MIDCAP

AS DRILLED DATA:
 WELL 2H TOP HOLE INFORMATION:
 N: 384,501ft E: 1,623,142ft
 LAT: 39°32'52.74" LON: 80°50'11.26"
 BOTTOM HOLE INFORMATION:
 N: 404,368ft E: 1,618,402ft
 LAT: 39°36'08.39" LON: 80°51'15.59"
 WEST VIRGINIA COORDINATE SYSTEM OF 1927 NORTH ZONE. ZONE WAS DERIVED FROM MEASUREMENTS TAKEN WITH TRIMBLE GEOXT SUBMETER MAPPING GRADE GPS UNIT. PLAT ORIENTATION, CORNER, AND WELL REFERENCE TIE LINES ARE BASED ON GRID NORTH.

(NAD) 83 (UTM) ZONE 17 COORDS:
 WELL 2H TOP HOLE INFORMATION:
 N: 4,377,611m E: 514,066m
 BOTTOM HOLE INFORMATION:
 N: 4,383,640m E: 512,521m

(NAD) 27 (UTM) ZONE 17 COORDS:
 WELL 2H TOP HOLE INFORMATION:
 N: 14,361,499ft E: 1,686,518ft
 POINT OF ENTRY INFORMATION:
 N: 14,362,869ft E: 1,687,720ft
 BOTTOM HOLE INFORMATION:
 N: 14,381,277ft E: 1,681,448ft

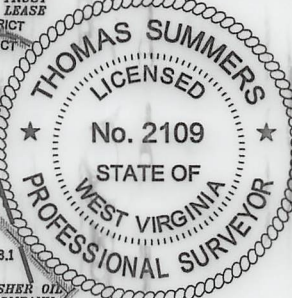

WV NORTH ZONE GRID NORTH

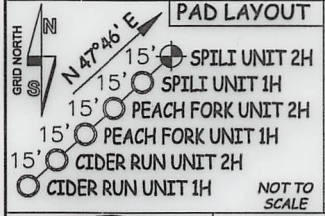
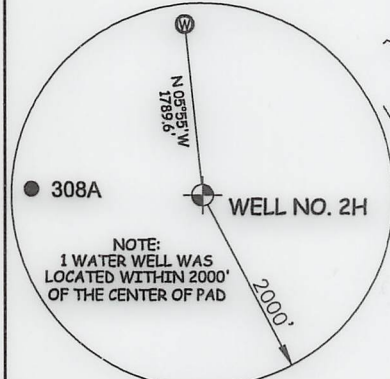

NOTE:
 1. NO OCCUPIED DWELLINGS OR BUILDINGS TWO THOUSAND FIVE HUNDRED (2,500) SQUARE FEET OR LARGER USED TO HOUSE OR SHELTER DAIRY CATTLE OR POULTRY HUSBANDRY ARE LOCATED WITHIN SIX HUNDRED TWENTY-FIVE (625) FEET OF THE CENTER OF THE WELL PAD.
 2. TOP HOLE DATA SHOWN HEREON WAS PROVIDED BY ANTERO RESOURCES CORPORATION.
 3. AS DRILLED DATA WAS PROVIDED BY ANTERO RESOURCES CORPORATION.
 4. WLS IS NOT CERTIFYING THE DATA AND INFORMATION PROVIDED LISTED IN NOTES 2 AND 3, ONLY THE RELATIONSHIP TO THE DATA AND INFORMATION PROVIDED TO THE LEASE BOUNDARIES.
 5. WLS IS BY NO MEANS RESPONSIBLE FOR ANY ERRORS OR INACCURACIES WITH THE DATA AND INFORMATION THAT HAS BEEN PROVIDED.



STATE OF WEST VIRGINIA, DIVISION OF ENVIRONMENTAL PROTECTION, OFFICE OF OIL AND GAS
 WILLLOW LAND SURVEYING PLLC
 220 MASONIC AVE. PENNSBORO WEST VIRGINIA 26415

I THE UNDERSIGNED, HEREBY CERTIFY THAT THIS PLAT IS CORRECT TO THE BEST OF MY KNOWLEDGE AND BELIEF AND SHOWS ALL THE INFORMATION REQUIRED BY LAW AND THE RULES ISSUED AND DESCRIBED BY THE DEPARTMENT OF ENVIRONMENTAL PROTECTION.

JOB # 20-011WA
 DRAWING # SPILIZHAD
 SCALE 1" = 2000'
 MINIMUM DEGREE OF ACCURACY SUBMETER
 PROVEN SOURCE OF ELEV. SUBMETER MAPPING GRADE GPS

LEGEND
 --- Surface Owner Boundary Lines +/-
 - - - Interior Surface Tracts +/-
 ○ Proposed Well Path
 ⊗ As Drilled Well Path

STATE OF WEST VIRGINIA DEPARTMENT OF ENERGY DIVISION OF OIL AND GAS

THOMAS SUMMERS P.S. 2109
 DATE 11/09/23
 OPERATOR'S WELL# SPILI UNIT #2H

WELL TYPE: OIL GAS LIQUID INJECTION WASTE DISPOSAL 47 095 02844
 (IF "GAS") PRODUCTION STORAGE DEEP SHALLOW STATE COUNTY PERMIT
 LOCATION: ELEVATION 1,233' - AS BUILT WATERSHED OUTLET MIDDLE ISLAND CREEK 02/16/2024
 QUADRANGLE PORTER FALLS 7.5' DISTRICT ELLSWORTH COUNTY TYLER
 SURFACE OWNER EDWARD YOST ESTATE ACREAGE 109.06 ACRES +/-
 OIL & GAS ROYALTY OWNER FISHER OIL COMPANY LEASE ACREAGE 45.67 ACRES +/-

PROPOSED WORK: DRILL CONVERT DRILL DEEPER REDRILL FRACTURE OR STIMULATE
 PLUG OFF OLD FORMATION PERFORATE NEW FORMATION OTHER PHYSICAL CHANGE IN WELL
 (SPECIFY) AS DRILLED PLUG & ABANDON CLEAN OUT & REPLUG
 TARGET FORMATION MARCELLUS ESTIMATED DEPTH 6,719' TVD 26,721' MD
 WELL OPERATOR ANTERO RESOURCES CORP. DESIGNATED AGENT KEVIN ELLIS
 ADDRESS 1615 WYNKOOP ST. ADDRESS 535 WHITE OAK BLVD.
 DENVER, CO 80202 BRIDGEPORT, WV 26330